



© 2020 GARVER, LLC  
 THIS DOCUMENT, ALONG WITH THE IDEAS AND DESIGNS CONVEYED HEREIN, SHALL BE CONSIDERED INSTRUMENTS OF PROFESSIONAL SERVICE AND ARE PROPERTY OF GARVER, LLC. ANY USE, REPRODUCTION, OR DISTRIBUTION OF THIS DOCUMENT, ALONG WITH THE IDEAS AND DESIGN CONTAINED HEREIN, IS PROHIBITED UNLESS AUTHORIZED IN WRITING BY GARVER, LLC OR EXPLICITLY ALLOWED IN THE GOVERNING PROFESSIONAL SERVICES AGREEMENT FOR THIS WORK.

8535 E. 21st Street N.  
 Suite 130  
 Wichita, KS 67206  
 (316) 264-8008



REV.	DATE	DESCRIPTION	BY



CITY OF WICHITA  
 WICHITA, KANSAS  
 JACKSON HEIGHTS  
 ADDITION  
 PAVING

PLAN &  
 PROFILE  
 (1 of 3)

JOB NO.: 20T41000  
 DATE: SEPT 2020  
 DESIGNED BY: KWL  
 DRAWN BY: DRS

BAR IS ONE INCH ON ORIGINAL DRAWING  
 0 1" 1"  
 IF NOT ONE INCH ON THIS SHEET, ADJUST SCALES ACCORDINGLY.

DRAWING NUMBER

SHEET NUMBER **6** OF **18**

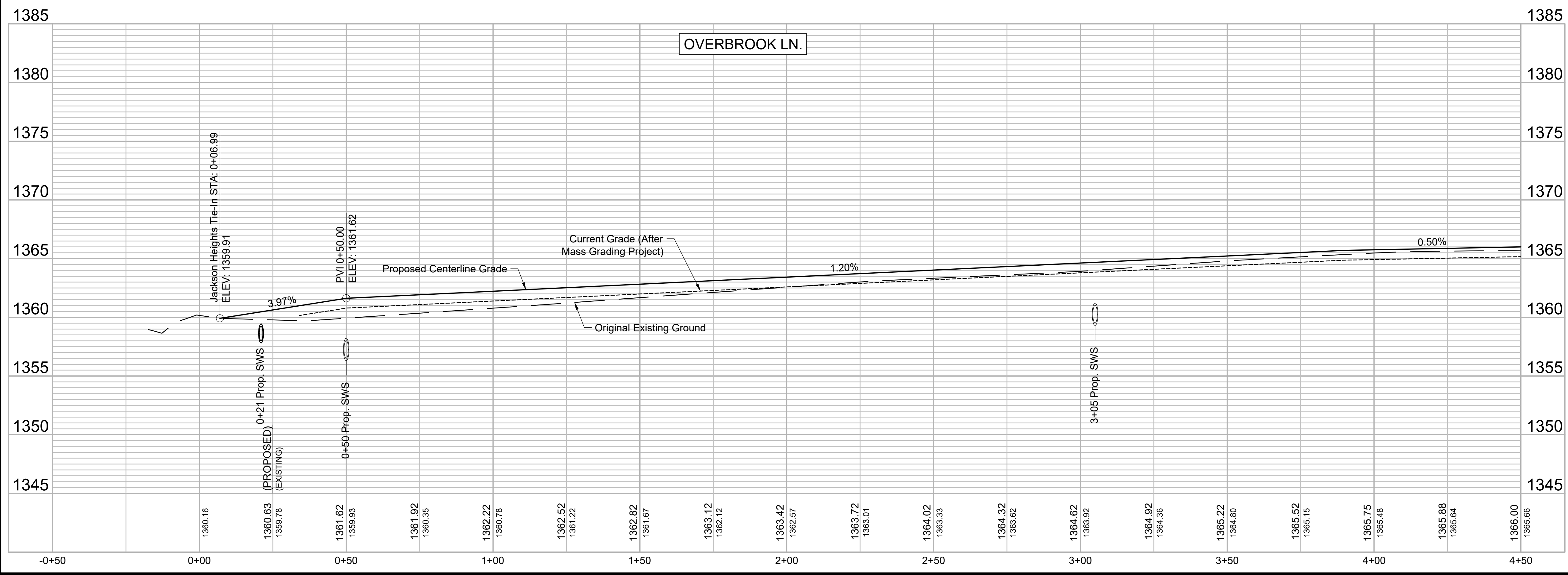
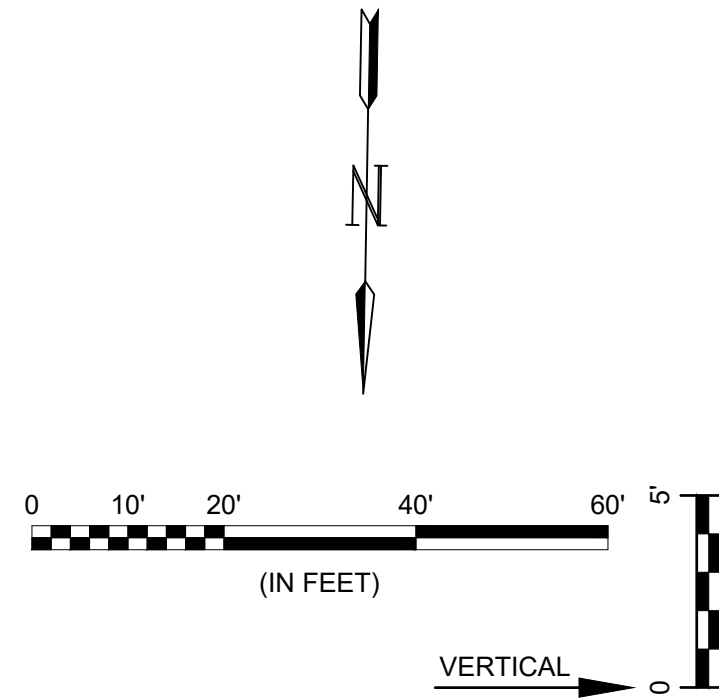
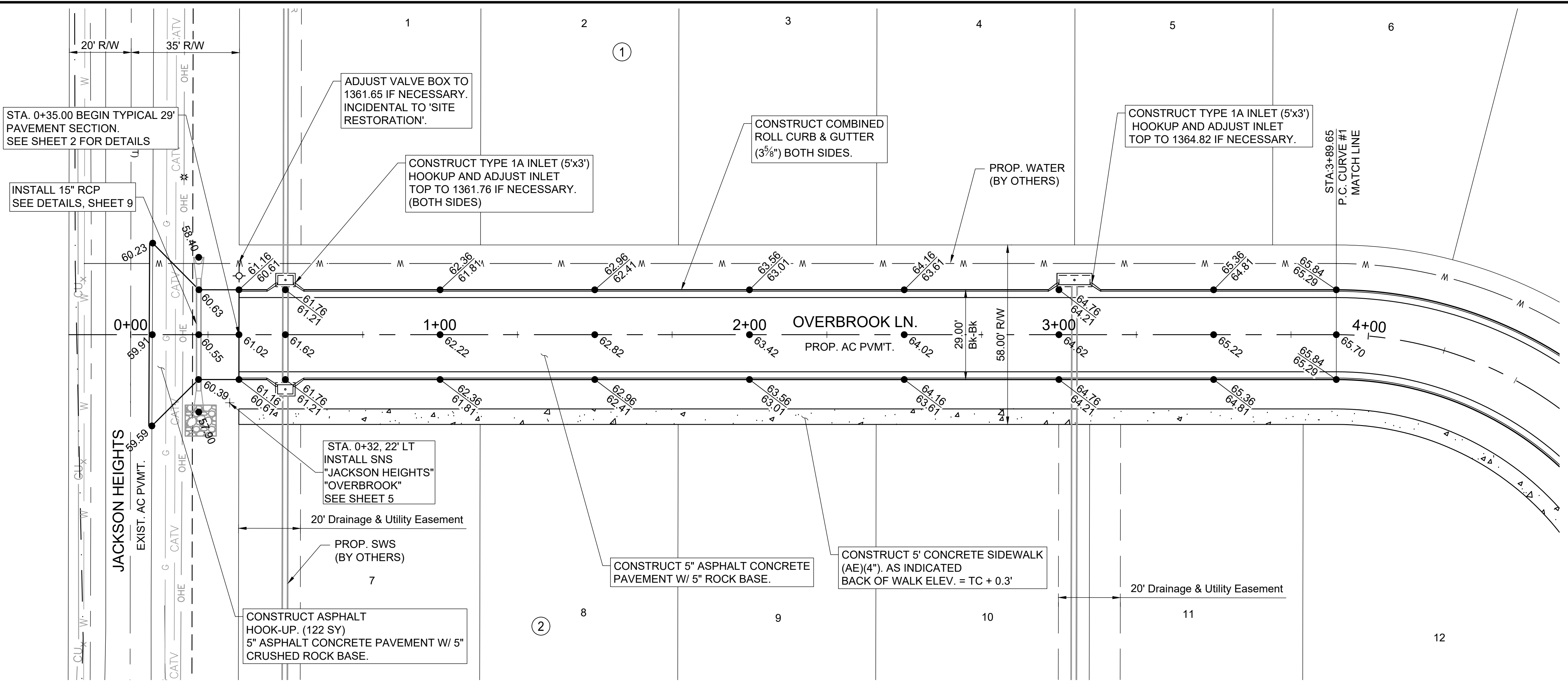

File: L:\2020\20T41000 - Jackson Heights Phase 1\Drawings\C3D\Paving\PLAN & PROFILE 1.dwg Last Save: 9/28/2020 11:08 AM Last saved by: MCarraPiedra  
 Last plotted by: Carraera-Piedra, Mariana Plot Date: 9/28/2020 1:31 PM Plotter used: None