

BENCHMARKS:
 RR spike in asphalt, SW COR., N1/2, SW1/4, Sec. 34, TWP. 26-S, R-2-E.
 Elev. = 1400.59 NAVD88

RR spike in E. face of power pole,
 174± N. of S. line, N1/2, SW1/4 &
 49± E. of W. line, SW1/4,
 Sec. 34, TWP. 26-S, R-2-E.
 Elev. = 1398.64 NAVD88

RR spike in S. face of power pole,
 294± S. of N. line, SW1/4, &
 48± E. of W. line, SW1/4,
 Sec. 34, TWP. 26-S, R-2-E.
 Elev. = 1386.14 NAVD88

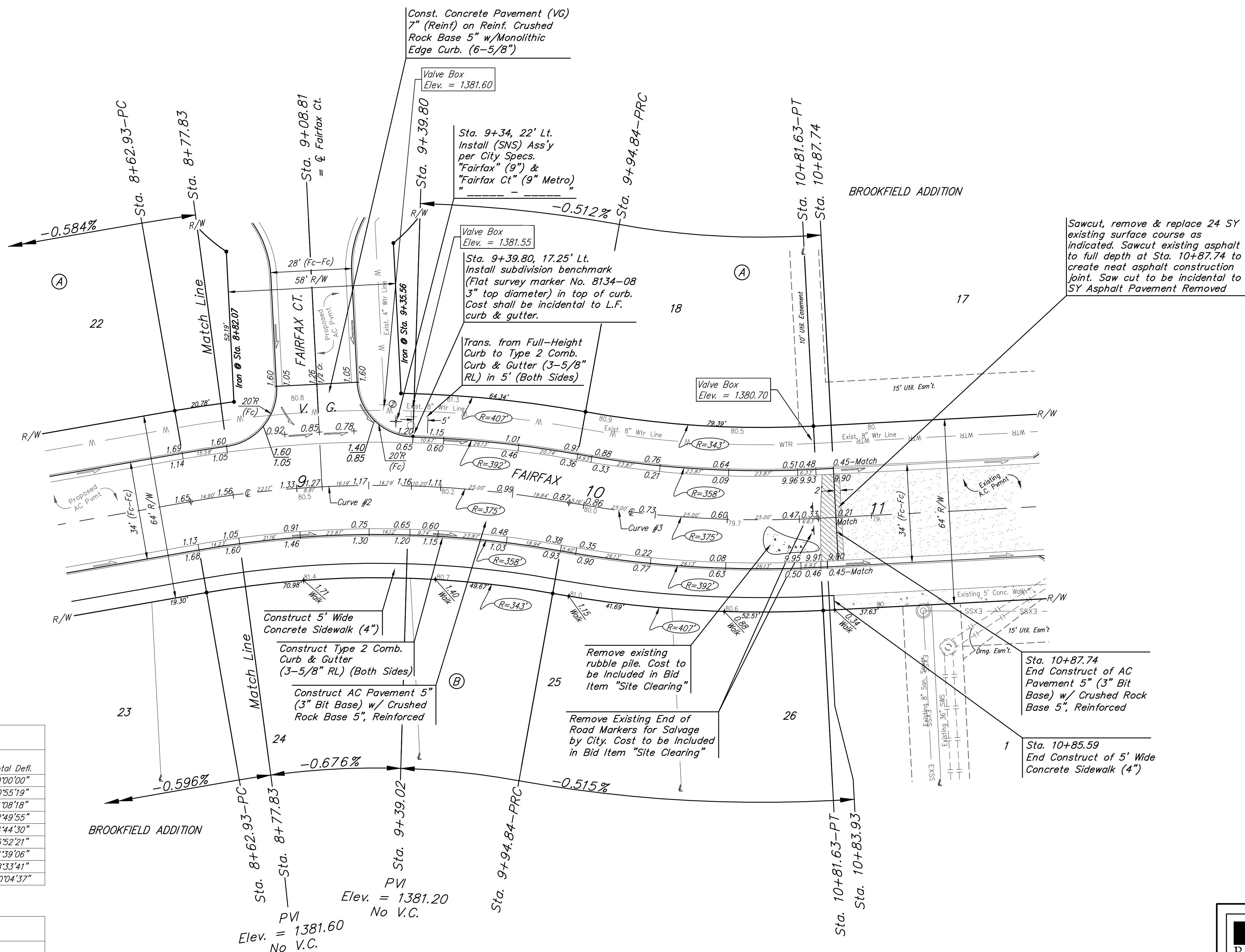
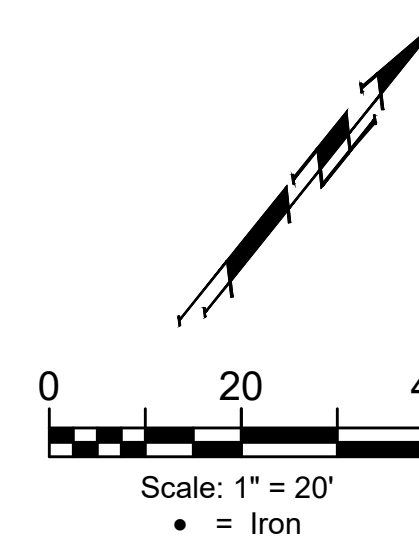

Sawcut, remove & replace 24 SY existing surface course as indicated. Sawcut existing asphalt to full depth at Sta. 10+87.74 to create neat asphalt construction joint. Saw cut to be incidental to SY Asphalt Pavement Removed

Sta. 10+87.74
 End Construct of AC Pavement 5" (3" Bit Base) w/ Crushed Rock Base 5", Reinforced

Sta. 10+85.59
 End Construct of 5' Wide Concrete Sidewalk (4")

Curve #2
 Curve Data Based on Centerline
 Rad. = 375' Delta = 20°09'15" Tangent = 66.64'
 Arc = 131.91' L.C. = 131.23' Def./Ft. = 4.58362 Min.

Station	Arc	Face Chord Lengths		Def.	Total Def.
		8' Left	8' Right		
8+62.93	-	-	-	0°00'00"	0°00'00"
8+75.00	12.07'	12.87'	11.26'	0°55'19"	0°55'19"
8+77.83	2.83'	3.02'	2.64'	0°12'59"	1°08'18"
9+00.00	22.17'	23.64'	20.69'	1°41'37"	2°49'55"
9+25.00	25.00'	26.66'	23.33'	1°54'35"	4°44'30"
9+39.80	14.80'	15.79'	13.81'	1°07'51"	5°52'21"
9+50.00	10.20'	10.88'	9.52'	0°46'45"	6°39'06"
9+75.00	25.00'	26.66'	23.33'	1°54'35"	8°33'41"
9+94.84	19.84'	21.16'	18.51'	1°30'56"	10°04'37"

Curve #3
 Curve Data Based on Centerline
 Rad. = 375' Delta = 13°15'41" Tangent = 43.59'
 Arc = 87.09' L.C. = 86.60' Def./Ft. = 4.56817 Min.

Station	Arc	Face Chord Lengths		Def.	Total Def.
		8' Left	8' Right		
9+94.84	-	-	-	0°00'00"	0°00'00"
10+00.00	5.16'	4.80'	5.49'	0°23'34"	0°23'34"
10+25.00	25.00'	23.25'	26.57'	1°54'13"	2°17'47"
10+50.00	25.00'	23.25'	26.57'	1°54'12"	4°11'59"
10+75.00	25.00'	23.25'	26.57'	1°54'12"	6°06'11"
10+81.93	6.93'	6.45'	7.37'	0°31'39"	6°37'50"

Roll type curb & gutter to be constructed on the pavement on this sheet.
 Top of curb elevation are given for full height curb.

	FAIRFAX Sta. 8+77.83 to Sta. 10+87.74
	Baughman Company, P.A. 315 Ellis St. Wichita, KS 67211 P 316-262-7271 F 316-262-0149 ENGINEERING SURVEYING PLANNING LANDSCAPE ARCHITECTURE
PROJECT NUMBER 472-2020-085623	DESIGN AEG
REVISIONS:	DRAWN JAK
	APPROVED DATE Oct. 19, 2020
	SCALE Noted
	SHEET 10 OF 39