

BENCHMARKS:
 RR spike in asphalt, SW COR., N1/2, SW1/4, Sec. 34, TWP. 26-S, R-2-E.
 Elev. = 1400.59 NAVD88

RR spike in E. face of power pole,
 174± N. of S. line, N1/2, SW1/4 &
 49± E. of W. line, SW1/4,
 Sec. 34, TWP. 26-S, R-2-E.
 Elev. = 1398.64 NAVD88

RR spike in S. face of power pole,
 294± S. of N. line, SW1/4, &
 48± E. of W. line, SW1/4,
 Sec. 34, TWP. 26-S, R-2-E.
 Elev. = 1386.14 NAVD88

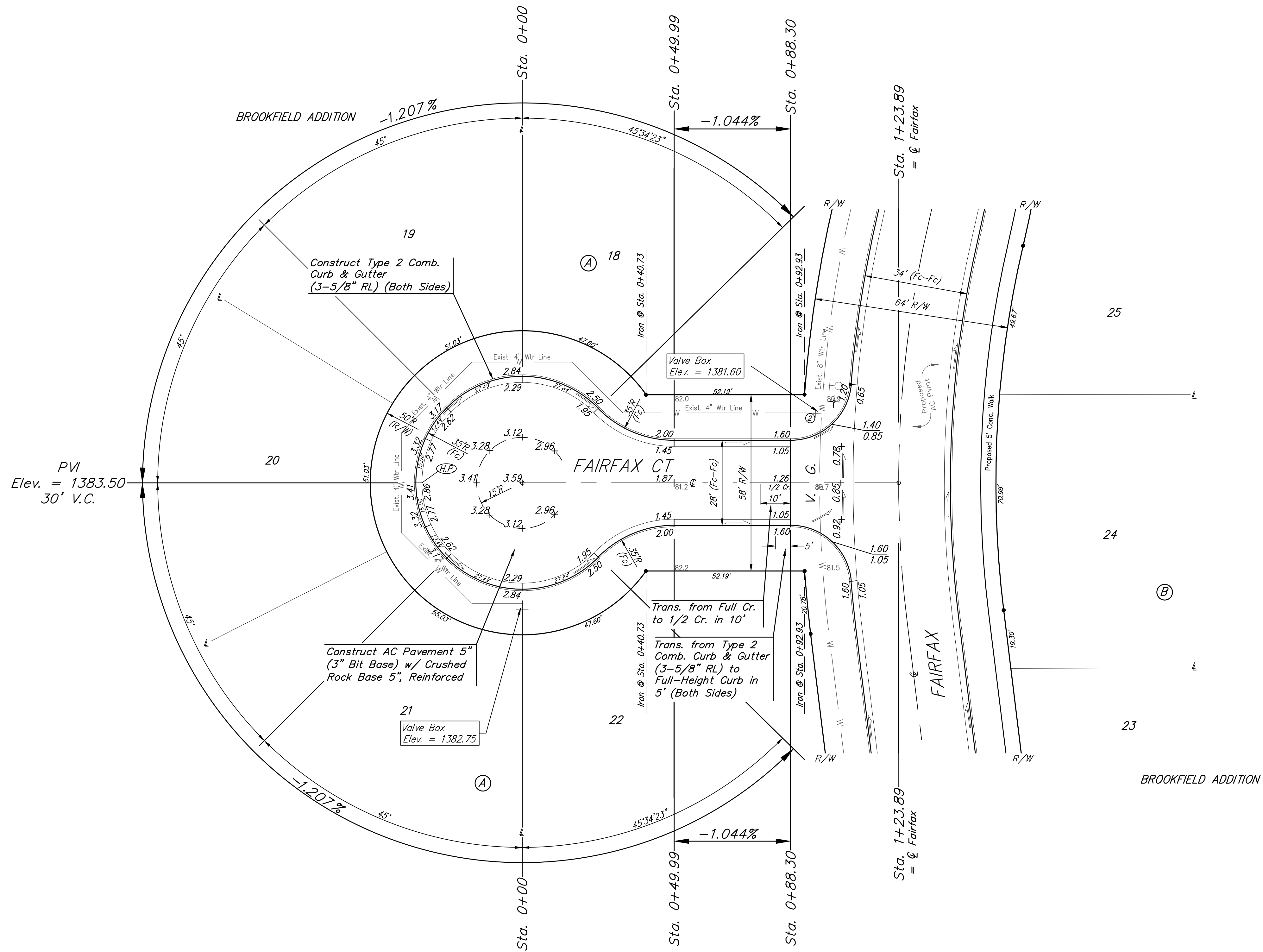
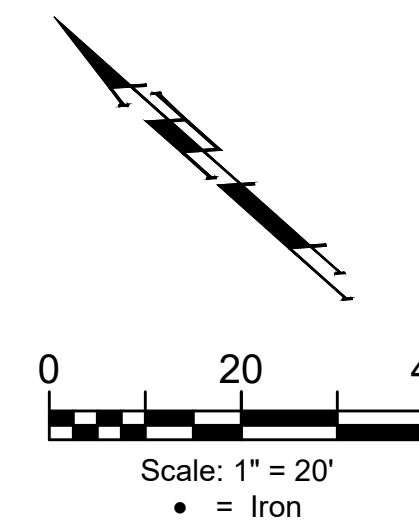

Subdivision Benchmarks

Street & Station	Location Description	Elevation
Fairfax 9+39.82, 17.25' Lt.	Adjacent to Fire Hydrant at the Northeast End of the Northeast Return Fairfax & Fairfax Ct, SE Cor., Lot 18, Blk A, Brookfield Addn.	
Crest Cir 2+40.24, 14.25' Rt.	Adjacent to Fire Hydrant West of the NW Cor., Lot 32, Blk A, Brookfield Addn.	

VALVE LOCATION TABLE

VALVE NUMBER	STREET	BASELINE STATION	OFFSET DISTANCE	OFFSET DIRECTION
1	Crest	6+01.64	28'	Lt.
2	Fairfax	9+30.07	28'	Lt.
3	Brookview Cir	9+77.49	23'	Lt.
4	Winston Cir.	5+85.77	24'	Lt.

Roll type curb & gutter to be constructed on the pavement on this sheet.
 Top of curb elevation are given for full height curb.

	Brookfield Addition - Phase 2A	
	FAIRFAX CT.	
Lot 16 - Lot 22, Block B		
<small>Baughman Company, P.A. 315 Ellis St. Wichita, KS 67211 P 316-262-7271 F 316-262-0149 ENGINEERING SURVEYING PLANNING LANDSCAPE ARCHITECTURE</small>		
PROJECT NUMBER 472-2020-085623	DESIGN AEG	DRAWN JAK
REVISIONS:	APPROVED	DATE Oct. 19, 2020
	SCALE Noted	SHEET 13 OF 39