

BENCHMARKS:

BM #1: "□" Cut in top of curb on south side of 51st St. N., near the NW corner of Lot 1, Valencia Addition.
Elev. = 1329.89 NAVD88

BM #2: COW disc set in curb on west side of Delaware St., near SE corner of Lot 8, Block 1, Valencia Addition.
Elev. = 1322.70 NAVD88

Street & Station	Location Description	Elevation
Delaware 6+53.39, 14.25' Lt.	Adjacent to Fire Hydrant at South End of SW Curb Return of 51st St. N. & Delaware	

WATER VALVE LOCATION TABLE

VALVE NUMBER	STREET	BASELINE STATION	OFFSET DISTANCE	OFFSET DIRECTION
V2	Delaware	6+53.39	23'	Lt.

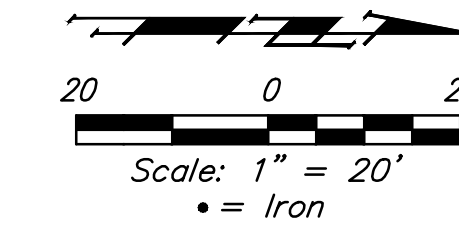

Paving contractor will be responsible to operate all water valves on the project, in the presence of the inspector, to ensure accessibility to the valves, and that all valves (except blowoffs) are left in the "ON" position when the project is completed.

Curve #3					
Curve Data Based on Centerline					
Rad. = 400' Delta = 13°04'36" Tangent = 45.85'					
Arc = 91.29' L.C. = 91.09' Def./Ft. = 4.29729 Min.					
Face Chord Lengths	Station	Arc	8' Left	8' Right	Defl. Total Defl.
	4+06.07	-	-	-	0°00'00" 0°00'00"
	4+25.00	18.93'	19.97'	17.89'	1°21'21" 1°21'21"
	4+50.00	25.00'	26.37'	23.62'	1°47'26" 3°08'47"
	4+75.00	25.00'	26.37'	23.62'	1°47'26" 4°56'13"
	4+97.36	22.36'	23.59'	21.13'	1°36'05" 6°32'18"

Curve #4					
Curve Data Based on Centerline					
Rad. = 400' Delta = 12°31'35" Tangent = 43.90'					
Arc = 87.46' L.C. = 87.28' Def./Ft. = 4.29673 Min.					
Face Chord Lengths	Station	Arc	8' Left	8' Right	Defl. Total Defl.
	5+47.36	-	-	-	0°00'00" 0°00'00"
	5+50.00	2.64'	2.49'	2.78'	0°11'21" 0°11'21"
	5+75.00	25.00'	23.62'	26.37'	1°47'25" 1°58'46"
	6+00.00	25.00'	23.62'	26.37'	1°47'25" 3°46'11"
	6+25.00	25.00'	23.62'	26.37'	1°47'25" 5°33'36"
	6+34.82	9.82'	9.28'	10.36'	0°42'12" 6°15'48"

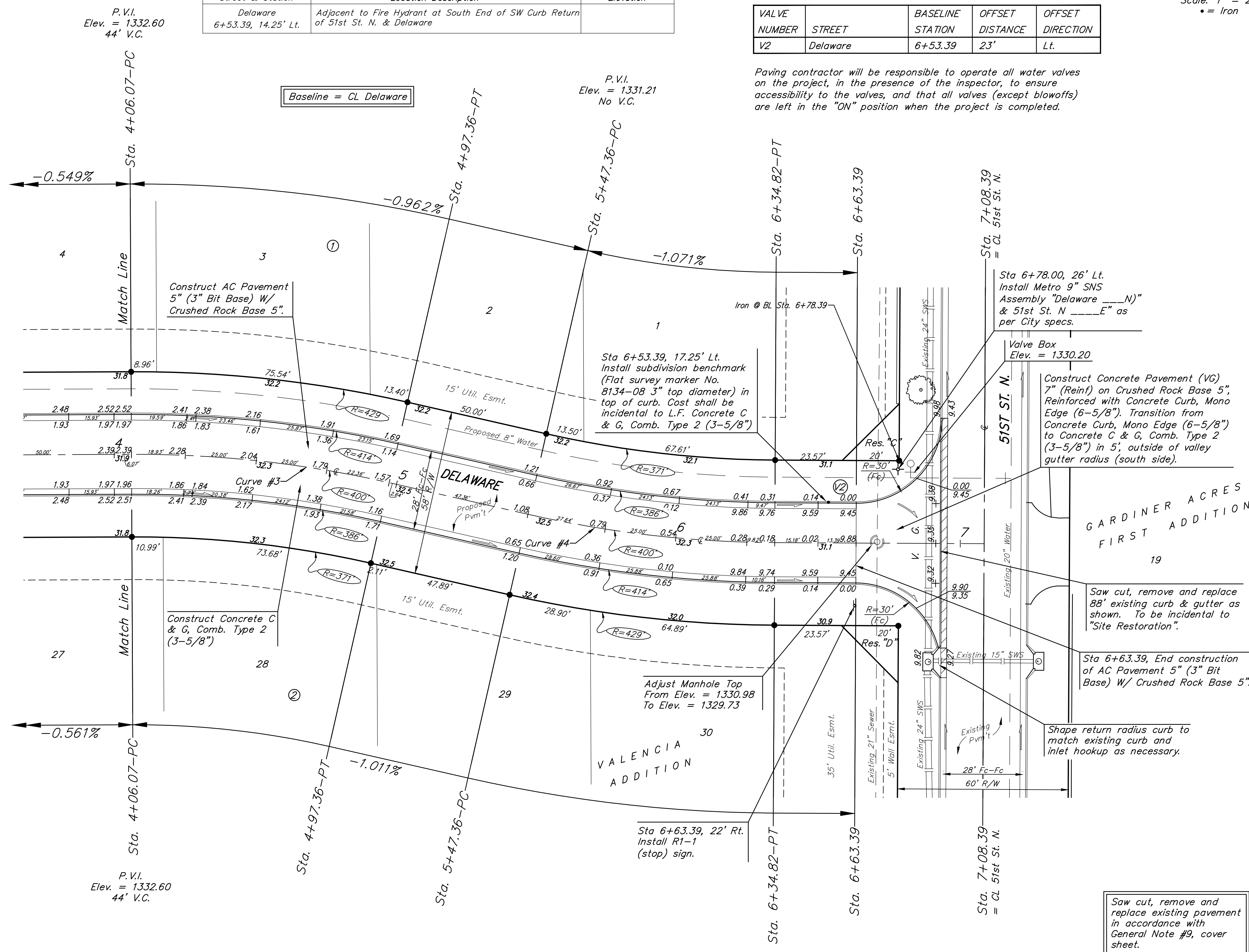

NOTE: ROLL TYPE CURB & GUTTER (TYPE 2) TO BE CONSTRUCTED ON THE PAVEMENT SHOWN ON THIS SHEET. TOP OF CURB ELEVATIONS ARE GIVEN FOR FULL HEIGHT CURB (TYPE 4).

Baughman Company, P.A.
 REGISTERED PROFESSIONAL ENGINEER
 ENGINEERING LICENSE NO. 11532
 CIVIL ENGINEERING
 1000 N. 10TH ST., SUITE 200
 DENVER, CO 80202
 PHONE: 303.733.8800
 FAX: 303.733.8801
 WWW.BAUGHMANCOMPANY.COM

VALENCIA ADDITION - PH. III
DELAWARE
 STREET IMPROVEMENTS