

BENCHMARKS:
 BM #1: Crows foot cut at SE corner of curb inlet south side of Kollmeyer near NE corner of Lot 82, Block A, Edge Water Addition.
 Elev. = 1335.36 NGVD29

BM #2: Square Cut Cross in center of curb inlet top near the Northwest corner of Lot 31, Blk A., Edge Water 3rd Addition.
 Elev. = 1333.65 NGVD29

BM #3: Brass disc in top of curb adjacent to fire hydrant at the Northwest corner of Driftwood and Driftwood Ct. near the Southeast corner of Lot 62, Blk D., Edge Water Addition.
 Elev. = 1336.19 NGVD29

All streets on this sheet are included in Phase 2.

Baseline = CL Kollmeyer Ct.

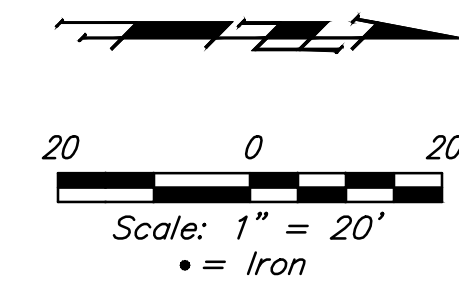

WATER VALVE LOCATION TABLE

VALVE NUMBER	STREET	BASELINE STATION	OFFSET DISTANCE	OFFSET DIRECTION
V7	Kollmeyer Ct.	0+32.39	32.88'	Rt.

Paving contractor will be responsible to operate all water valves on the project, in the presence of the inspector, to ensure accessibility to the valves, and that all valves (except blowoffs) are left in the "ON" position when the project is completed.

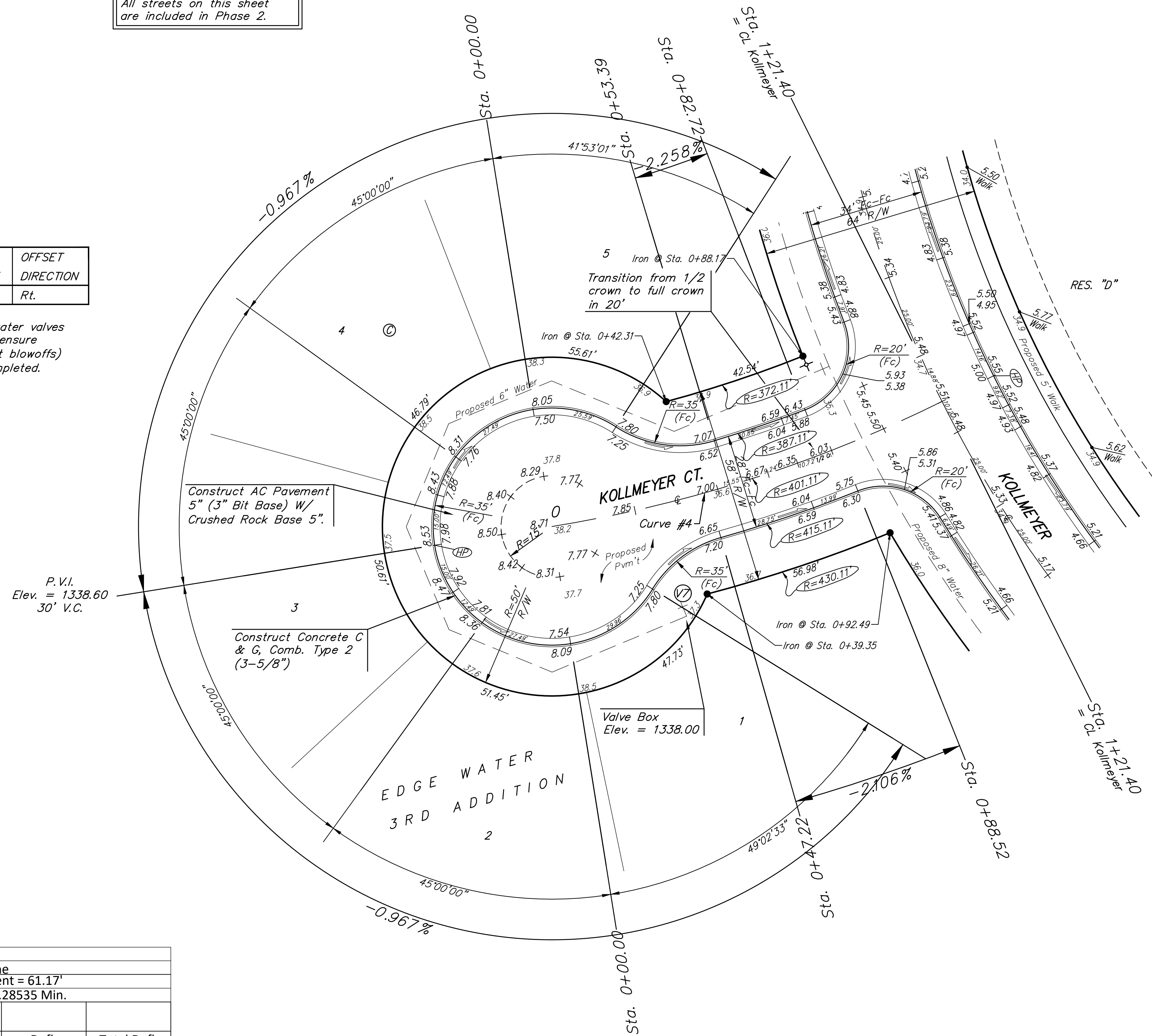

Curve #4					
Curve Data Based on Centerline					
Rad. = 401.11' Delta = 17°20'29" Tangent = 61.17'					
Arc = 121.40' L.C. = 120.94' Def./Ft. = 4.28535 Min.					
Face Chord Lengths	Arc	8' Left	8' Right	Defl.	Total Defl.
Station					
0+00.00	-	-	-	0°00'00"	0°00'00"
0+47.22	47.22'	44.60'	49.78'	3°22'21"	3°22'21"
0+53.39	6.17'	5.83'	6.51'	0°26'27"	3°48'48"
0+75.00	21.61'	20.42'	22.79'	1°32'36"	5°21'24"
0+82.72	7.72'	7.30'	8.14'	0°33'05"	5°54'29"
0+88.52	5.80'	5.48'	6.12'	0°24'51"	6°19'20"
1+21.40	32.88'	31.07'	34.67'	2°20'55"	8°40'15"

NOTE: ROLL TYPE CURB & GUTTER (TYPE 2) TO BE CONSTRUCTED ON THE PAVEMENT SHOWN ON THIS SHEET. TOP OF CURB ELEVATIONS ARE GIVEN FOR FULL HEIGHT CURB (TYPE 4).

Baughman Company, P.A.
 ENGINEERS, ARCHITECTS, PLANNERS, LANDSCAPE ARCHITECTS
 1150 W. WILSON ST. SUITE 100, FORT COLLINS, CO 80504
 (970) 226-1120
 www.baughmancompany.com

EDGE WATER 3RD ADD. - PH. 2.3 & Entrance
KOLLMAYER CT.
 STREET IMPROVEMENTS

SHEET
6
 OF
39