

BENCHMARKS

BM#1 - City of Wichita Bench Mark Disc, Located at the Northwest Corner of Maize Road & 29th Street Intersection, approx 63.4' NW of the Section Corner.
Elev. = 1349.32 MSL (161.92 City Datum)

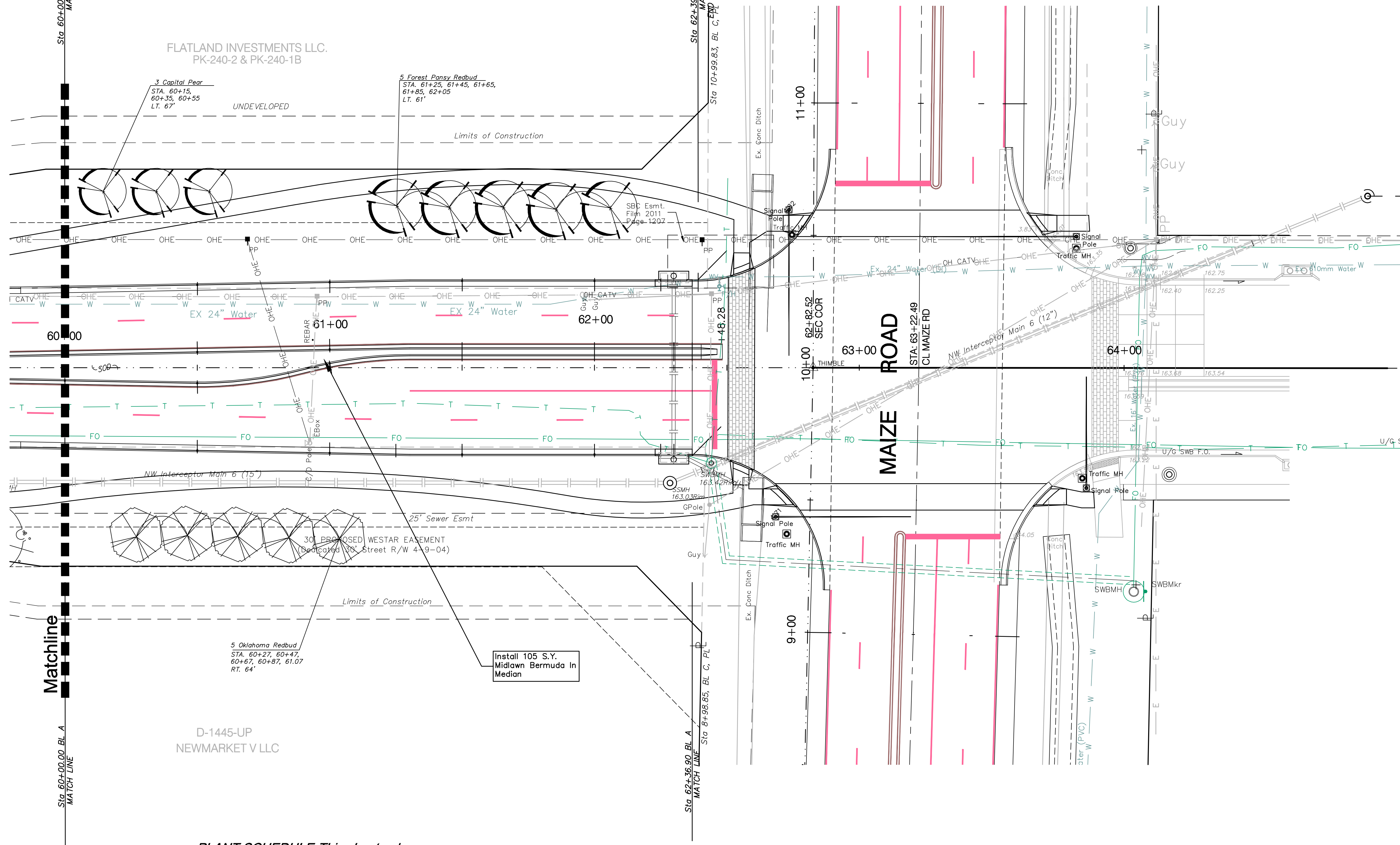

PLANT SCHEDULE-This sheet only

QTY	BOTANICAL NAME	COMMON NAME	SIZE	CONDITION	REMARKS
ORNAMENTAL TREES					
5	<i>Cercis canadensis</i> 'Forest Pansy'	Forest Pansy Redbud	2" Cal.	B&B	Single Stem Only
5	<i>Cercis reniformis</i> 'Oklahoma'	Oklahoma Redbud	2" Cal.	B&B	Single Stem Only
3	<i>Pyrus calleryana</i> 'Capital'	Capital Pear	2" Cal.	B&B	Single Stem Only

Landscape Contractor to Install Hardwood Mulch at a Minimum Depth of 3"

Drawing File: F:\eng\29th (Maize-119th)\Landscape\29th Lscapebase.dwg

Project No. 03-06-601 CAPITAL IMPROVEMENT PROJECT

Design: KTG
Drawn: KTG
Approved: BDT

Scale: 1" = 20'

29th Street Landscape Plan
Sta. 60+00 to Sta. 64+00
29th Street Expansion & Beautification - Maize Road to 119th Street

Baughman Company, P.A.
315 Ellis St. Wichita, KS 67211 P 316-262-7271 F 316-262-0149
ENGINEERING | SURVEYING | PLANNING | LANDSCAPE ARCHITECTURE

June 2007

SHEET

105

OF 135