

RTWA REGION NO.	STATE	PROJECT NO.	FISCAL YEAR	SHEET NO.	TOTAL SHEETS
7	KANSAS	87N-0348-01	2007	79	135

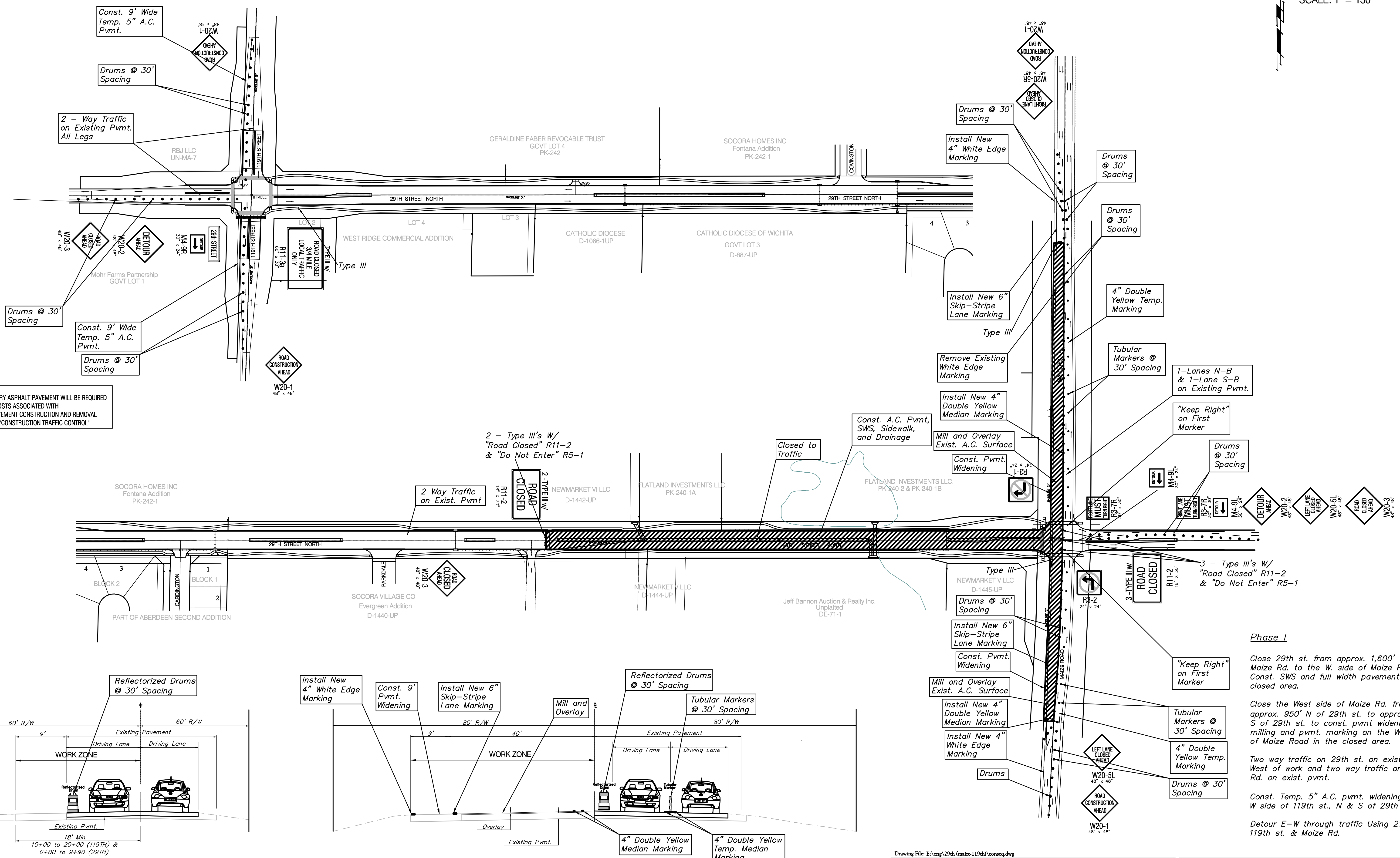
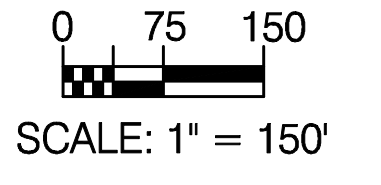

*FOR INFORMATION ONLY
1,575 S.Y. OF 5" TEMPORARY ASPHALT PAVEMENT WILL BE REQUIRED FOR THIS PROJECT. ALL COSTS ASSOCIATED WITH TEMPORARY ASPHALT PAVEMENT CONSTRUCTION AND REMOVAL SHALL BE SUBSIDIARY TO "CONSTRUCTION TRAFFIC CONTROL"

Phase I

Close 29th st. from approx. 1,600' West of Maize Rd. to the W. side of Maize Rd. Const. SWS and full width pavement. in closed area.

Close the West side of Maize Rd. from approx. 950' N of 29th st. to approx. 600' S of 29th st. to const. pvmt widening, cold milling and pvmt. marking on the West side of Maize Road in the closed area.

Two way traffic on 29th st. on exist. pvmt West of work and two way traffic on Maize Rd. on exist. pvmt.

Const. Temp. 5" A.C. pvmt. widening on the W side of 119th st., N & S of 29th st.

Detour E-W through traffic Using 21st st. 119th st. & Maize Rd.

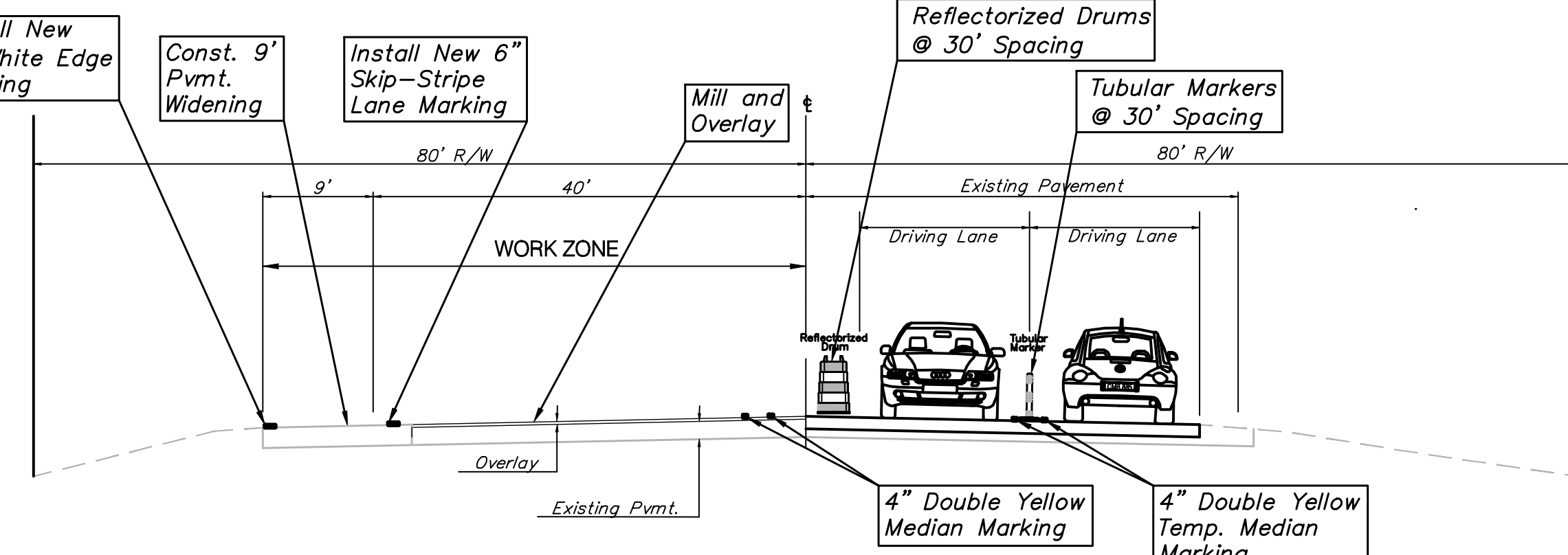
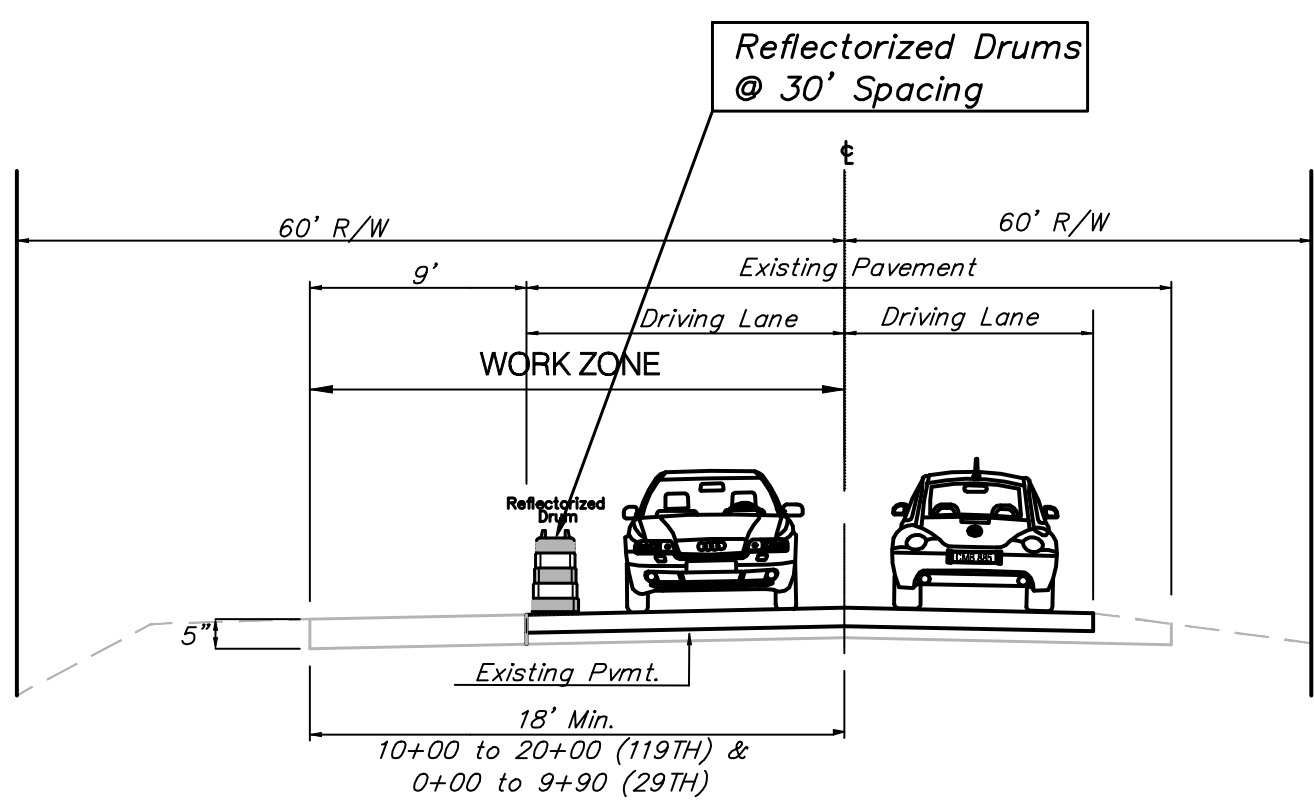

119TH Looking North & 29TH W of 119TH Looking West

PHASE I-Maize Road (Looking North)

CONSTRUCTION ZONE

Drawing File: E:\eng\29th (maize-119th)\conseq.dwg
 Design: AZIERE Project No. 0403-E828 CAPITAL IMPROVEMENT PROJECT
 Drawn: AZIERE
 Approved: JFB
 Scale: NOTED

Phase I
 Construction Sequencing
 29th Street Paving Project - Maize Road to 119th Street

Baughman Company, P.A.
 315 Ellis St. Wichita, KS 67211 P 316-262-7271 F 316-262-0149
 ENGINEERING | SURVEYING | PLANNING | LANDSCAPE ARCHITECTURE

June, 2007
 SHEET 79 OF 135