

**BENCHMARKS**

BM#4 - Small Railroad Spike on South face of the Power Pole,  
 Located at the North Side of 29th Street 2nd Pole East of 119th Street.  
 Elev. = 1368.19 MSL (180.79 City Datum)

PRWA REGION NO.	STATE	PROJECT NO.	FISCAL YEAR	SHEET NO.	TOTAL SHEETS
7	KANSAS	87N-0348-01	2007	97	135

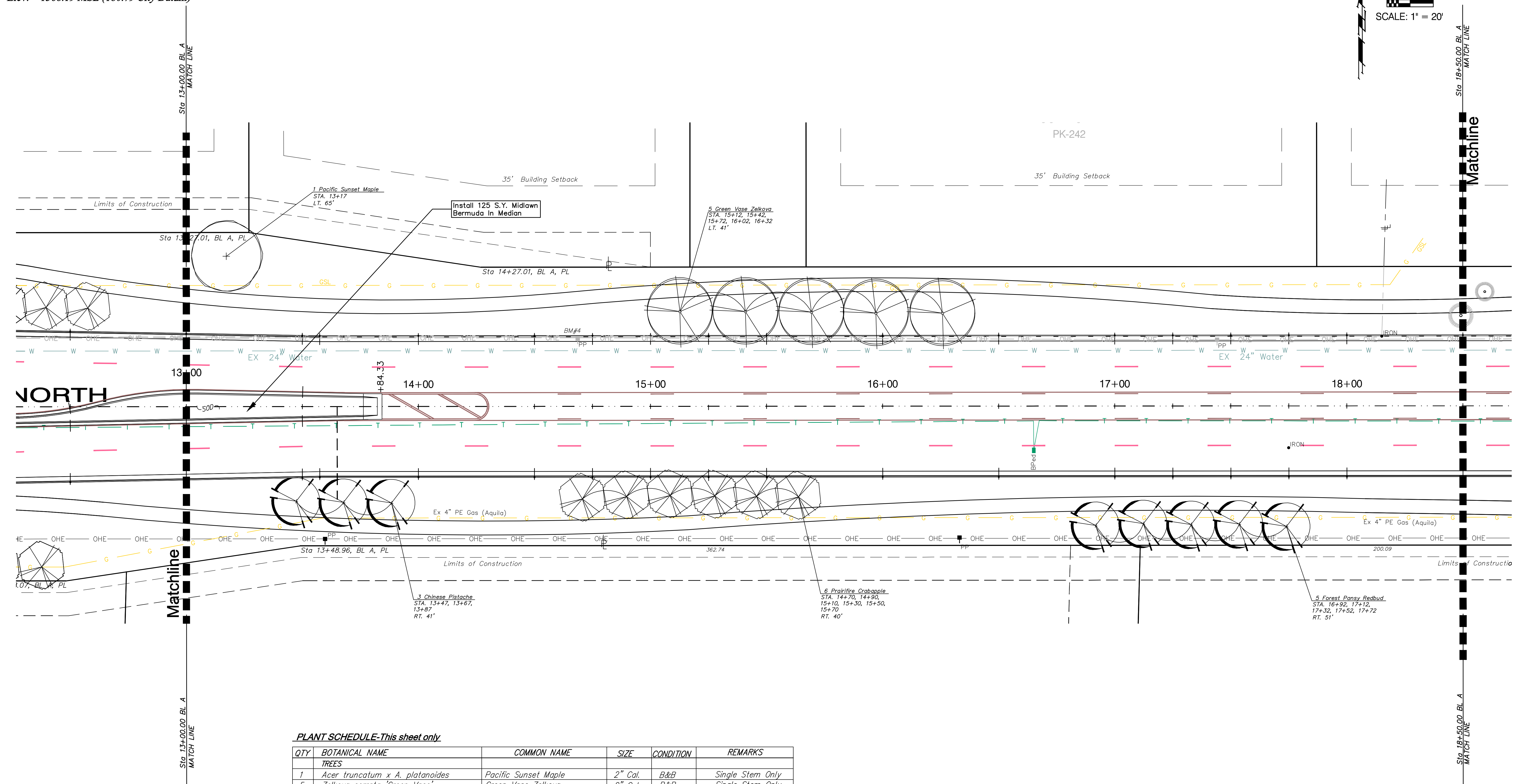
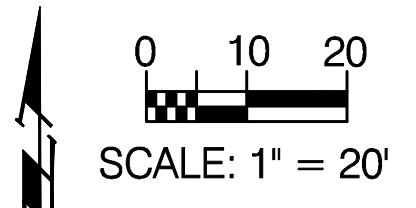

**PLANT SCHEDULE-This sheet only**

QTY	BOTANICAL NAME	COMMON NAME	SIZE	CONDITION	REMARKS
<b>TREES</b>					
1	<i>Acer truncatum x A. platanoides</i>	Pacific Sunset Maple	2" Cal.	B&B	Single Stem Only
5	<i>Zelkova serrata 'Green Vase'</i>	Green Vase Zelkova	2" Cal.	B&B	Single Stem Only
<b>ORNAMENTAL TREES</b>					
5	<i>Cercis canadensis 'Forest Pansy'</i>	Forest Pansy Redbud	2" Cal.	B&B	Single Stem Only
6	<i>Malus 'Prairiefire'</i>	Prairiefire Crabapple	2" Cal.	B&B	Single Stem Only
3	<i>Pistacia chinensis</i>	Chinese Pistache	2" Cal.	B&B	Single Stem Only

Landscape Contractor to Install Hardwood Mulch at a Minimum Depth of 3"

Drawing File: F:\eng\29th (Maine-119th)\Landscape\29th Lscapebase.dwg  
 Design: KTG  
 Drawn: KTG  
 Approved: BDT  
 Scale: 1" = 20'

Project No. 03-06-E601 CAPITAL IMPROVEMENT PROJECT  
**29th Street Landscape Plan**  
 Sta. 13+00 to Sta. 18+50  
 29th Street Expansion & Beautification - Main Road to 119th Street

**Baughman Company, P.A.**  
 315 Ellis St. Wichita, KS 67211 P 316-262-7271 F 316-262-0149  
 ENGINEERING | SURVEYING | PLANNING | LANDSCAPE ARCHITECTURE