

BENCHMARK:

BM#1 - "□" Cut at West End of Median,
SE of Central Avenue & Tyler Road,
5.92'± South and 47.85'± East
of Centerline of Both.
Sta. 10+47.85
Elev. = 145.75 (City Datum)



SCALE: 1" = 20'

WATER VALVE BOX & WATER METER ADJUSTMENTS					
ITEM	STATION	EX. OFFSET	NEW OFFSET	EX. ELEV.	NEW ELEV.
WATER METER	98+97.77	40.5' Rt.	65' Rt.	144.37	145.05
WATER METER	98+99.10	39.0' Rt.	65' Rt.	144.62	145.05
WATER METER	99+23.07	42.0' Rt.	65' Rt.	144.52	145.05
WATER VALVE	99+53.52	39.0' Rt.	-	144.27	144.52
WATER VALVE	99+71.77	56.0' Rt.	-	144.33	144.64

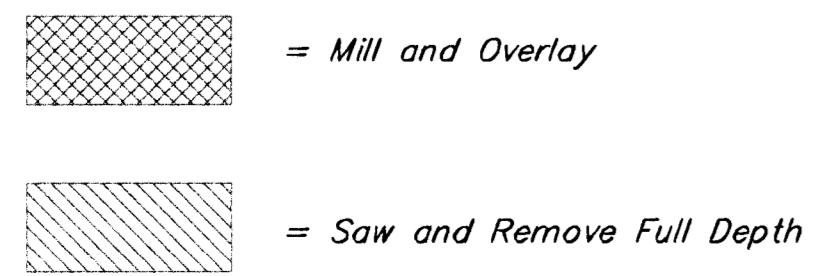
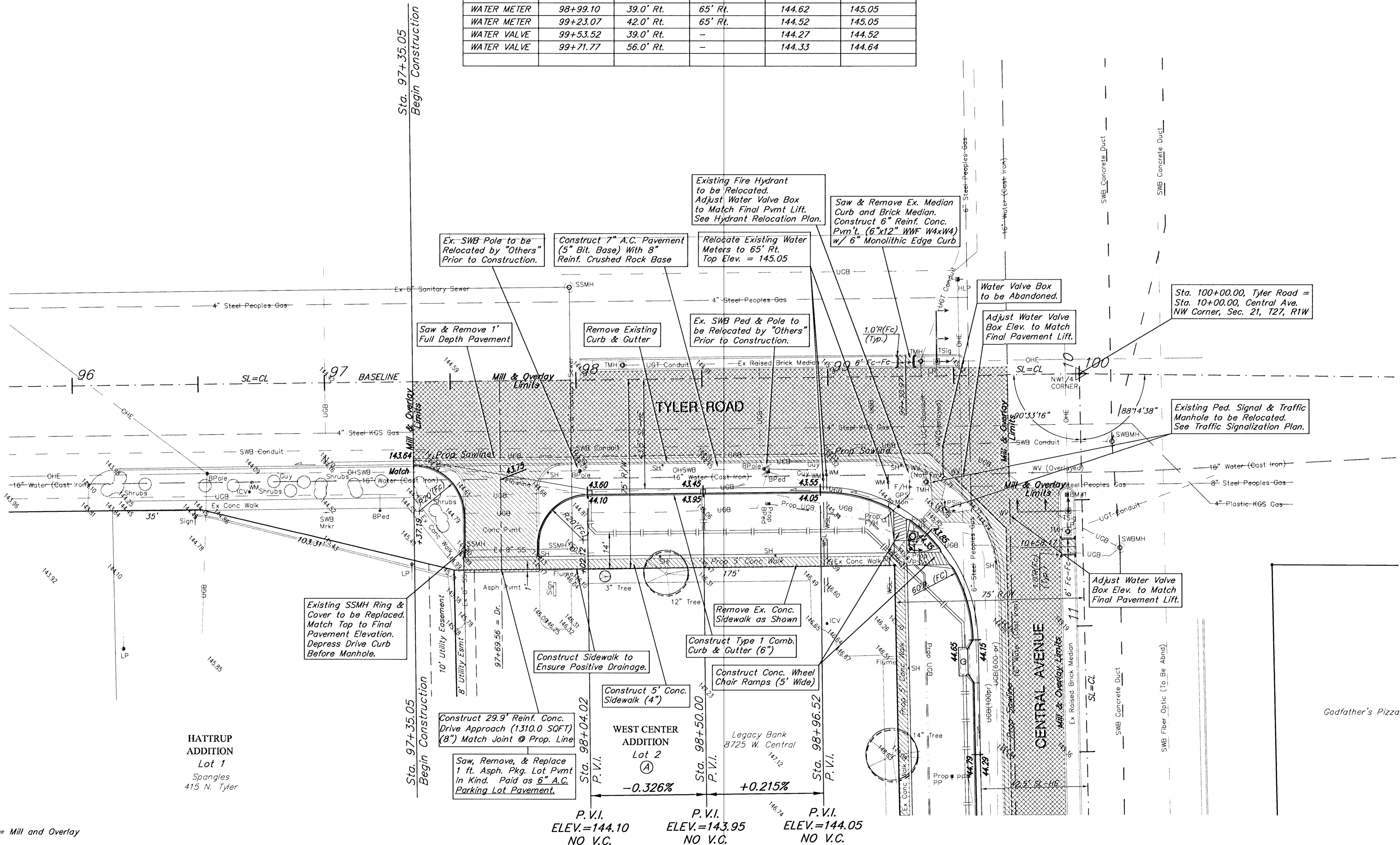

HATRUP
ADDITION
Lot 1
Spangles
415 N. Tyler

Irrigation Systems within Public R/W in Conflict with the New Construction to be Removed and Replaced as Necessary.
Existing Traffic Signal Loops & Appurtenances to be Reinstalled with This Project. See Traffic Signalization Plan.
SWB Poles & Utilities in Conflict to be Relocated by "Others" Prior to Construction.

P. V.I. ELEV.=144.10 NO V.C.
P. V.I. ELEV.=143.95 NO V.C.
P. V.I. ELEV.=144.05 NO V.C.

PROJECT NUMBER City Of Wichita	SHEET NAME PAV01	ENGINEERING DIRECTORY F/CENTRAL/PAV
DESIGN JFB/JMN	DRAWN JMN/KWR	APPROVED
DATE FEB 2002	SCALE NOTED	BAUGHMAN NO 99-09-E463

CAPITAL IMPROVEMENT PROJECT
CENTRAL AVENUE
TYLER to WOODCHUCK
PAVING PLAN - STA. 97+35.05 to 97+96.52

BAUGHMAN COMPANY, P.A.
ENGINEERING, SURVEYING, & PLANNING
316-282-7271 • 315 ELLIS • WICHITA, KANSAS 67211

SHEET 7 OF 42