

PLOTTED: Wednesday, February 03, 2021 @ 01:10PM

J:\PROJECTS\2019\19010\483\_COW WATER MAIN SOUTH OF 17TH\_19483\_1200 CAD\SHOTS\05\_CIVIL\WFR\19483-05-3050.DWG



**CONTROL POINTS**

- ✕ CP #117  
5/8" rebar with MKEC Aluminum Cap  
N = 1696768.813 E = 1662522.375 EL: 1393.055
- ✕ CP #118  
5/8" rebar with MKEC Aluminum Cap  
N = 1696687.829 E = 1661994.856 EL: 1392.870
- ✕ CP #119  
5/8" rebar with MKEC Aluminum Cap  
N = 1696745.835 E = 1661296.579 EL: 1385.395
- ✕ CP #120  
5/8" rebar with MKEC Aluminum Cap  
N = 1696459.592 E = 1661367.498 EL: 1379.315
- ✕ CP #121  
5/8" rebar with MKEC Aluminum Cap  
N = 1696031.657 E = 1661351.340 EL: 1375.915
- ✕ CP #302  
+ Cut  
N = 1696339.066 E = 1662434.966 EL: 1386.110
- ✕ CP #335  
+ Cut  
N = 1696700.159 E = 1662415.279 EL: 1387.510
- ✕ CP #450  
+ Cut  
N = 1696757.099 E = 1661695.253 EL: 1387.835
- ✕ CP #451  
+ Cut  
N = 1696048.759 E = 1661718.465 EL: 1376.875

Horizontal and Vertical Datum:  
  
The Horizontal Datum is based on the Kansas Coordinate System of 1983(2011), South Zone. Coordinates shown have been modified to the ground using a combined adjustment factor of 1.0001200144. State Plane coordinates can be calculated by multiplying the shown values by 0.99988.  
  
Vertical Datum: NAVD 88

**BENCHMARK**

- BM #900  
BM Sq CUT TC on S. return to E. Entrance to The Fieldhouse Bar @ 17th Gentry  
N = 1696630.339 E = 1662382.656 EL: 1386.330
- BM #901  
BM Sq CUT TC on S. return 1st set of parking stalls S. of 17th on E. side Yale  
N = 1696622.560 E = 1661362.041 EL: 1382.115
- BM #902  
BM Sq CUT TC N. side of 16th street 10'+/- west of curb inlet on NW corner of Yale and 16th  
N = 1696070.981 E = 1661304.950 EL: 1376.235

Note:  
All Control Points shown have elevations established using standard surveying procedures and can be used as temporary benchmarks. When using a Control point as a temporary benchmark, it is recommended that cross-checks be made to other control points or benchmarks to confirm elevations prior to use.

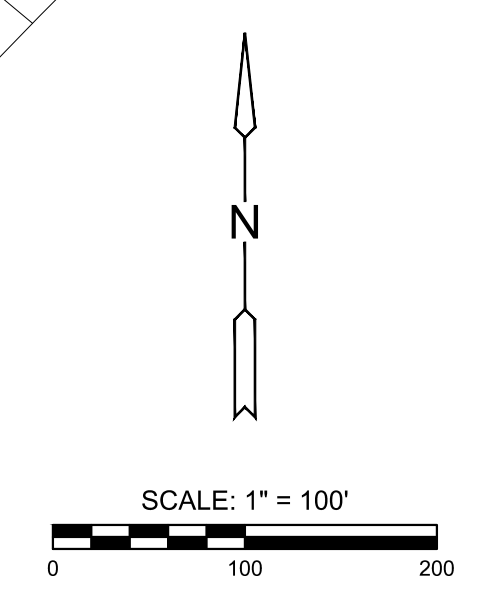

**CONSTRUCTION NOTES**

1. CONTRACTOR TO BEGIN CONSTRUCTION WITH LINE 1 FROM STATION 10+00.00 TO STATION 13+23.08 AND LINE 2 FROM STATION FROM 10+05.00 TO 16+60.28. LINES CONSTRUCTED SHALL BE TESTED AND ACCEPTED. PRIOR TO CONNECTING LINE 2 TO EXISTING 8" MAIN AT 17th STREET, CONTRACTOR SHALL INSTALL ALL SERVICE TAPS FOR LINE 2.
2. CONTRACTOR TO CONSTRUCT LINE 1 FROM STATION 13+23.08 TO STATION 23+88.94 AND LINE 3 FROM STATION FROM 10+05.00 TO 16+86.64. LINES CONSTRUCTED SHALL BE TESTED AND ACCEPTED. PRIOR TO CONNECTING LINE 3 TO EXISTING 8" MAIN AT 17th STREET, CONTRACTOR SHALL INSTALL ALL SERVICE TAPS FOR LINE 3.
3. CONTRACTOR TO VERIFY LOCATION AND ELEVATION OF EXISTING UTILITIES PRIOR TO CONSTRUCTION START.
4. EXISTING WATER LINE DISCONNECTS SHALL BE SCHEDULED AND EXECUTED IN A MANNER THAT MINIMIZES WATER SERVICE DOWN TIME AND DISRUPTION TO TRAFFIC FLOW IN ALL AREAS.
5. THE "ABANDON EXISTING SYSTEM" BID ITEM WILL COVER ALL COSTS FOR TAKING THE EXISTING WATER MAINS OUT OF SERVICE WITH THIS PROJECT. THIS INCLUDES CUTTING AND CAPPING OF EXISTING LINES, VALVE REMOVAL, METER CANS ETC. CALLED OUT IN THE PLANS FOR MAINS AND LINES CONNECTED TO MAINS.
6. WHEN WORKING IN AREAS SURROUNDING EXISTING TREES, THE CONTRACTOR SHALL PROCEED WITH CAUTION AVOIDING DAMAGE TO ROOT STRUCTURES OR LOW-LYING BRANCHES. IT WILL BE THE RESPONSIBILITY OF THE CONTRACTOR TO ADDRESS ANY DAMAGES TO EXISTING TREES PRIOR TO END OF CONSTRUCTION ACTIVITIES ON SITE.
7. IN AREAS WHERE CURB AND GUTTER IS REMOVED OR EXCAVATION TAKES PLACE WITHIN TEN FEET OF THE BACK OF EXISTING CURB, BACK OF CURB PROTECTION SHALL BE REQUIRED.
8. ADDITIONAL PAVEMENT AND OR CURB REMOVAL MAY BE REQUIRED AND SHALL BE SUBSIDIARY TO PROJECT.

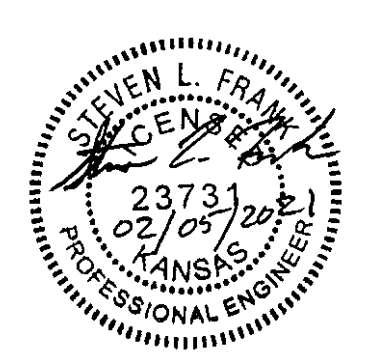

EVERY ATTEMPT HAS BEEN MADE TO INSURE ALL COORDINATE VALUES SHOWN ARE AN ACCURATE AND TRUE REPRESENTATION OF THE CURRENT PLANS. ALL VALUES ARE TO BE CONFIRMED WITH THE FINAL SIGNED PLAN SET BEFORE USE.



WATER LINE REPLACEMENT PLANS FOR  
**WATER LINE IMPROVEMENTS**  
**SOUTH OF 17th STREET**

©2021  
MKEC Engineering  
All Rights Reserved  
www.mkec.com  
These drawings and their contents, including, but not limited to, all concepts, designs, & ideas are the exclusive property of MKEC Engineering (MKEC), and may not be used or reproduced in any way without the express consent of MKEC.

**CONTROL PLAN**

PROJECT NO.	448-2020-027409	
DATE	FEB. 2021	
SCALE	1" = 100'	
DESIGNED	DRAWN	CHECKED
DFL	JWC	SLF
NO.	REVISION	DATE
SHEET NO.		
02 OF 30		