

Scale: 1:200

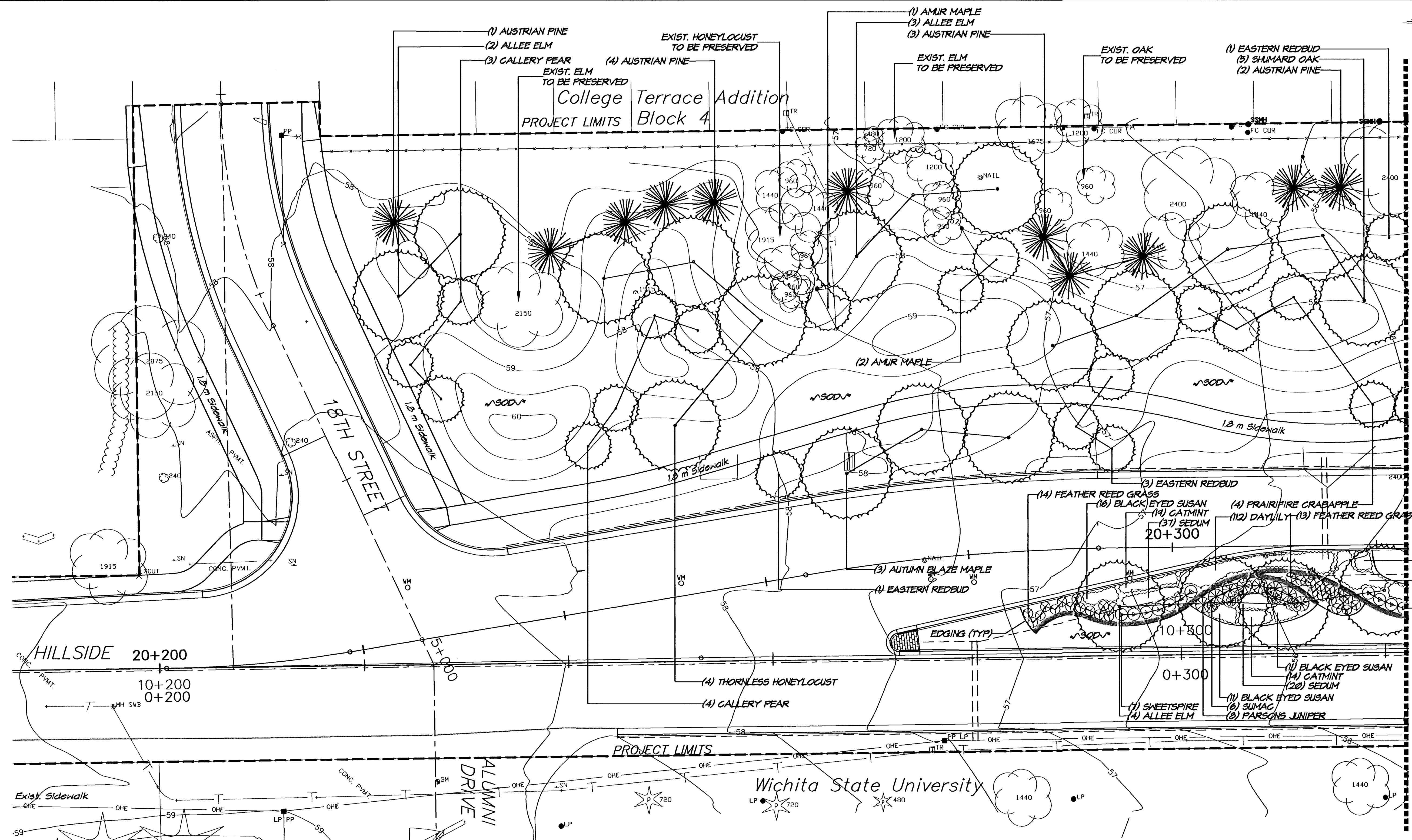

PLANT LIST (THIS SHEET)			
QTY.	COMMON NAME	BOTANICAL NAME	SIZE/COMMENT
LARGE SHADE TREES			
0	PANICLED GOLDENRAIN TREE	<i>Koeleruteria paniculata</i>	2"-2.5" Cal., Balled-in-Burlap
5	SHUMARD OAK	<i>Quercus shumardii</i>	2"-2.5" Cal., Balled-in-Burlap
1	ALLEE ELM	<i>Ulmus parvifolia 'Allee'</i>	3"-3.5" Cal., Balled-in-Burlap
3	AUTUMN BLAZE MAPLE	<i>Acer rubrum x freemanii</i>	2"-2.5" Cal., Balled-in-Burlap
4	THORNLESS HONEYLOCUST	<i>Gleditsia triacanthos var. inermis</i>	2"-2.5" Cal., Balled-in-Burlap
EVERGREENS			
10	AUSTRIAN PINE	<i>Pinus nigra</i>	8'-10' Hgt., Balled-in-Burlap
ORNAMENTAL TREES			
4	PRAIRIFIRE CRABAPPLE	<i>Malus 'Prairifire'</i>	2" Cal., Balled-in-Burlap
5	EASTERN REDBUD	<i>Cercis canadensis</i>	8'-10' Hgt., B4B, Clump
7	GALLERY PEAR	<i>Pyrus calleryana 'Chanticleer'</i>	2" Cal., Balled-in-Burlap
3	AMUR MAPLE	<i>Acer ginnala</i>	8'-10' Hgt., B4B, Clump
0	AUTUMN BRILLIANCE SERVICEBERRY	<i>Amelanchier x grandiflora 'Autumn Brilliance'</i>	8'-10' Hgt., B4B, Clump
ORNAMENTAL GRASSES			
27	FEATHER REED GRASS	<i>Calamagrostis x acutiflora stricta</i>	3 gal., 30" O.C.

PLANT LIST (THIS SHEET CONT.)			
QTY.	COMMON NAME	BOTANICAL NAME	SIZE/COMMENT
PERENNIALS			
30	BLACK EYED SUSAN	<i>Rudbeckia fulgida 'Goldsturm'</i>	1 gal., 24" O.C.
0	GAY FEATHER	<i>Liatris spicata 'Kobold'</i>	1 gal., Cluster as directed
0	'ZAGREB' COREOPSIS	<i>Coreopsis verticillata 'Zagreb'</i>	1 gal., 18" O.C.
24	SALVIA	<i>Salvia x superba 'Mainacht'</i>	1 gal., 24" O.C.
57	AUTUMN JOY STONECROP	<i>Sedum x 'Autumn Joy'</i>	1 gal., 18" O.C., pint 50mm high
112	STELLA D'ORO DAYLILY	<i>Hemerocallis sp.</i>	6" Pot, 18" O.C.
0	PINK CARPET ROSE	<i>Rosa noatrum</i>	2 gal., 24" O.C.
45	CATMINT	<i>Nepeta x faassenii</i>	1 gal., 24" O.C.
SHRUBS			
0	BLUE CHIP JUNIPER	<i>Juniperus horizontalis 'Blue Chip'</i>	5 gal., 5' O.C.
0	PARSONS JUNIPER	<i>Juniperus davurica</i>	5 gal., 5' O.C.
11	HENRY'S GARNET SHEET SPIRE	<i>Itea virginica 'Henry's Garnet'</i>	5 gal., 4' O.C.
6	CUTLEAF SUMAC	<i>Rhus typhina laciniata</i>	3 gal., space as noted
SOD			
SEE SHEET (36)	GARD'N WISE FESCUE/BLUE MIX	<i>Festuca arundinacea</i>	refer to notes and specs.

H:\CIVIL\01053\PAVE\01053LP1.dwg 05/01/03 02:48:24 PM CDT

PLANTING PLAN
 STA. 0+160 TO STA. 0+320
 PROJ. NO. 472-83537 SEDGWICK CO.

MKEC ENGINEERING CONSULTANTS, INC.
 WICHITA, KANSAS

DESIGNED BY: MKEC	CHECKED BY: MKEC
DRAWN BY: B.J.H.	DATE: 04/03 SHEET 32 OF 73