

- LEGEND**
- G = GAS MAIN
  - W = WATER MAIN
  - SS = SANITARY SEWER
  - SWS = STORM WATER SEWER
  - UGE = UNDER GROUND ELECTRIC
  - UGT = UNDER GROUND TELEPHONE
  - B.M. = BENCH MARK
  - TELE. PED. = TELEPHONE PEDESTAL
  - F.H. = FIRE HYDRANT
  - O.A. = OUY ANCHOR
  - G.P. = GUARD POST
  - H.L.P. = HIGH LINE POLE
  - L.P. = LIGHT POLE
  - M.B. = MAIL BOX
  - P.P. = POWER POLE
  - SH = SPRINKLER HEAD
  - S. = SIGN
  - WELL = WATER WELL
  - W.V. = WATER VALVE
  - SS M.H. = SANITARY SEWER MANHOLE

FRIESS ADDITION  
 WICHITA, SEDGWICK COUNTY, KANSAS

**UTILITIES SHOWN REPRESENT THE BEST INFORMATION AVAILABLE FOR DESIGN. ADDITIONAL UTILITIES MAY BE PRESENT ON THIS PROJECT. THE CONTRACTOR SHALL BE RESPONSIBLE FOR DETERMINING THE EXACT LOCATION, DEPTH AND SIZE OF ALL UNDERGROUND UTILITIES PRIOR TO CONSTRUCTION. THE CONTRACTOR SHALL BE LIABLE FOR ANY DAMAGE CAUSED BY THE FAILURE TO DO SO.**

**SURVEY DISCLAIMER:**  
 TOPOGRAPHIC SURVEY AND CONTOUR MAP USED IN PREPARING PLANS WAS PROVIDED BY SAVOY COMPANY, P.A., 535 S. EMPORIA, SUITE 104, WICHITA, KS. ENGINEER DOES NOT GUARANTEE SURVEY ELEVATIONS FOR ACCURACY. CONTRACTOR SHALL VERIFY ELEVATIONS AND NOTIFY ENGINEER OF ANY DISCREPANCIES.

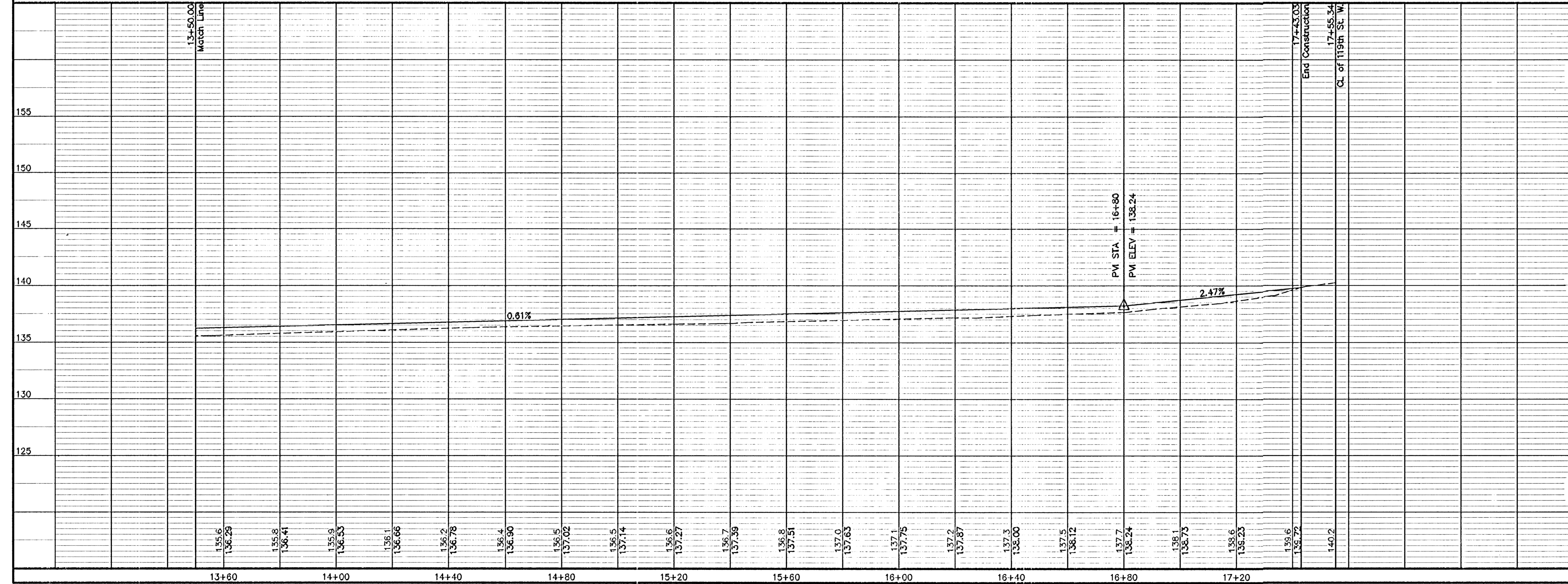

**PAVING PLANS FOR LYNN DALE STREET**  
 WICHITA, SEDGWICK COUNTY, KANSAS  
 CED PROJ. NO.: 20030988

**CERTIFIED ENGINEERING DESIGN, P.A.**  
 810 WEST DOUGLAS, SUITE C  
 WICHITA, KANSAS 67203  
 PH.(316)262-8808 FAX.(316)262-1669

DESIGNED: HDF SCALE: 1"=20' SHEET: 7  
 DRAWN: CKW DATE: 6/03  
 CHECKED: HDF CED FILE: Wheat-Bose.dwg TOTAL: 43