

BENCHMARKS:

BM #1: "□" with cross on curb inlet near the SE corner of Lot 8, Block 4, Cheryl's Hollow 2nd Addition.
Elev. = 1364.97 (NAVD 88).

BM #2: "□" with cross on curb inlet near the SE corner of Lot 9, Block 10, Cheryl's Hollow 2nd Addition.
Elev. = 1363.50 (NAVD 88).

Subdivision Bench Marks		
Street & Station	Location Description	Elevation
Kentucky Ct. 0+39.74, 14.25' Lt.	Adjacent to Fire Hydrant at S. End of SW Curb Return of Kentucky Ln. & Kentucky Ct.	

Baseline = CL Kentucky Ct.

This sheet is all in Phase 4.

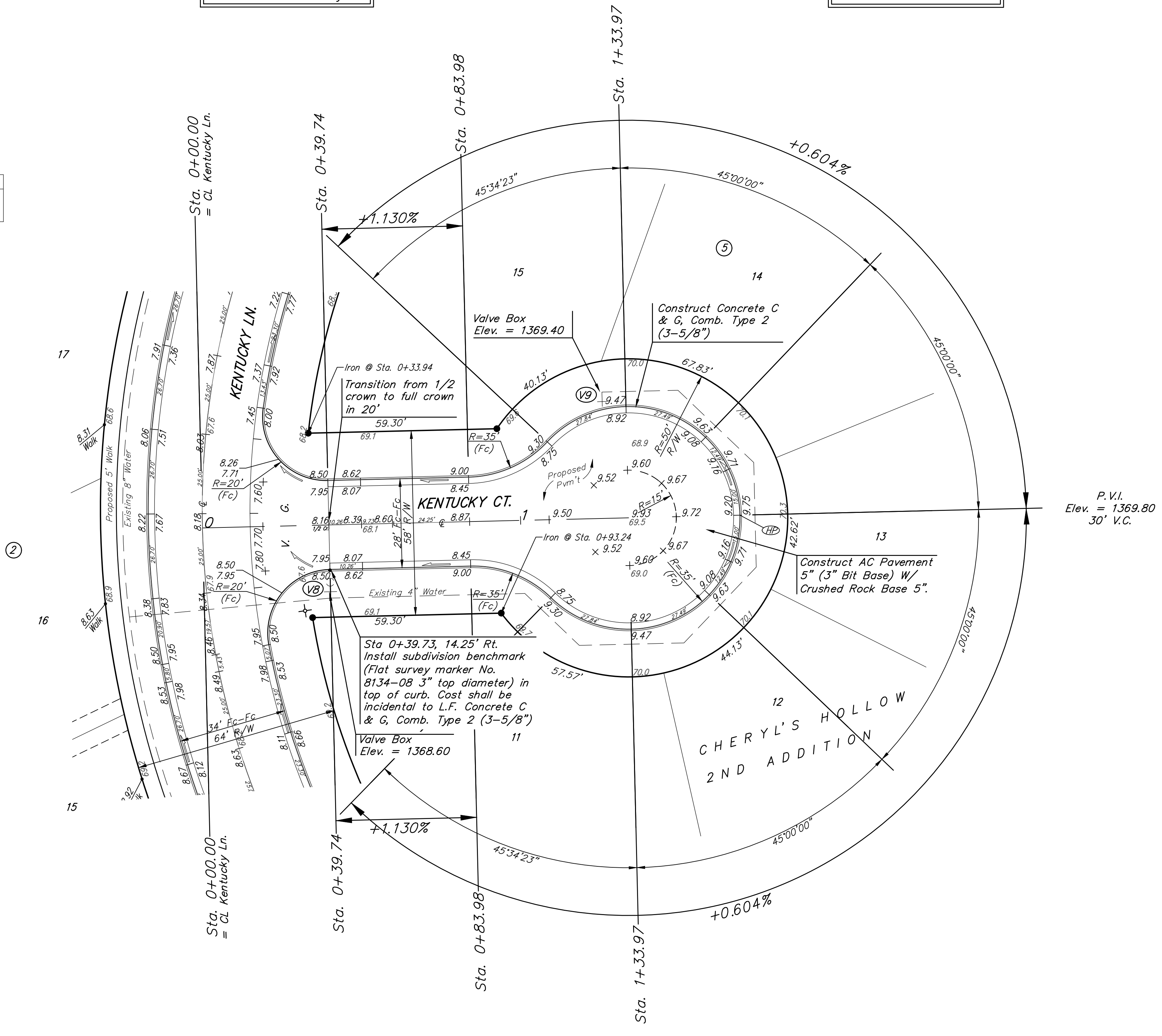
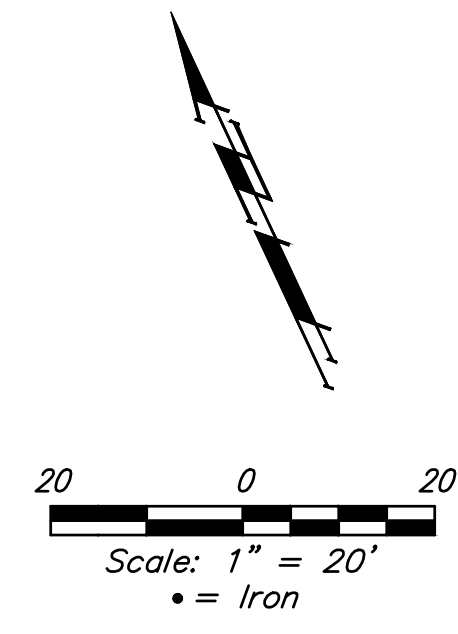

WATER VALVE LOCATION TABLE

VALVE NUMBER	STREET	BASELINE STATION	OFFSET DISTANCE	OFFSET DIRECTION
VB	Kentucky Ct.	0+39.74	23'	Rt.
V9	Kentucky Ct.	1+26.52	39.73'	Lt.

Paving contractor will be responsible to operate all water valves on the project, in the presence of the inspector, to ensure accessibility to the valves, and that all valves (except blowoffs) are left in the "ON" position when the project is completed.

NOTE: ROLL TYPE CURB & GUTTER (TYPE 2) TO BE CONSTRUCTED ON THE PAVEMENT SHOWN ON THIS SHEET. TOP OF CURB ELEVATIONS ARE GIVEN FOR FULL HEIGHT CURB (TYPE 4).

CHERYL'S HOLLOW 2ND ADD. Ph. 3&4
KENTUCKY CT.
 STREET IMPROVEMENTS
 Baughman Company, P.A.
 ENGINEERING ARCHITECTURE
 1100 S. W. 11th St., Ft. Lauderdale, FL 33304
 P.E. #12000, F.L. #12000, F.L. #12000
 APPROVED: [Signature] DATE: 08/20/20