

PIER PILING SUMMARY			
Location	Left Top Elev.	Right Top Elev.	Length
Pier No. 1	1271.72	1271.72	22'
Pier No. 2	1268.66	1268.66	24'
Pier No. 3	1268.56	1268.56	24'
Pier No. 4	1271.51	1271.51	22'

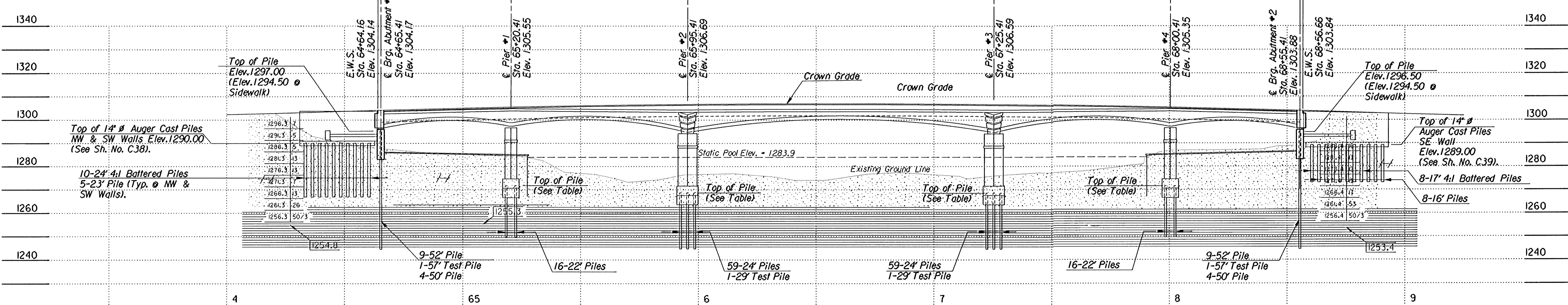

STANDARD		STANDARD		GEOLOGIC		SYMBOLS		GEOLOGIC		PROFILE	
	Clay		Caliche		Weathered Shale		Limestone		Coredrill		Elevation Interpolated or from adjacent soundings
	Silty Clay		Silty Clay Shale		Sandstone		Cherty Limestone		Hand tools		Actual sounding elevation
	Silt		Limy Shale		Shaly Sandstone		Shaly Limestone		Air hammer		Drive started
	Sand		Black or Fissile Shale		Siltstone		Sandy Limestone		Dutch cone penetrometer		Unconfined compression
	Gravel		Sandy Shale		Gypsum		Weathered or Broken Limestone		Standard penetration		Refusal
	Boulders		Gypsiferous Shale						Water level		

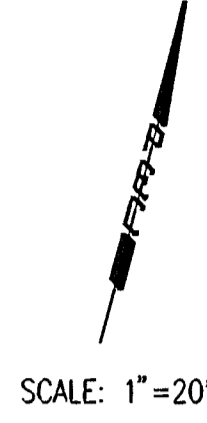
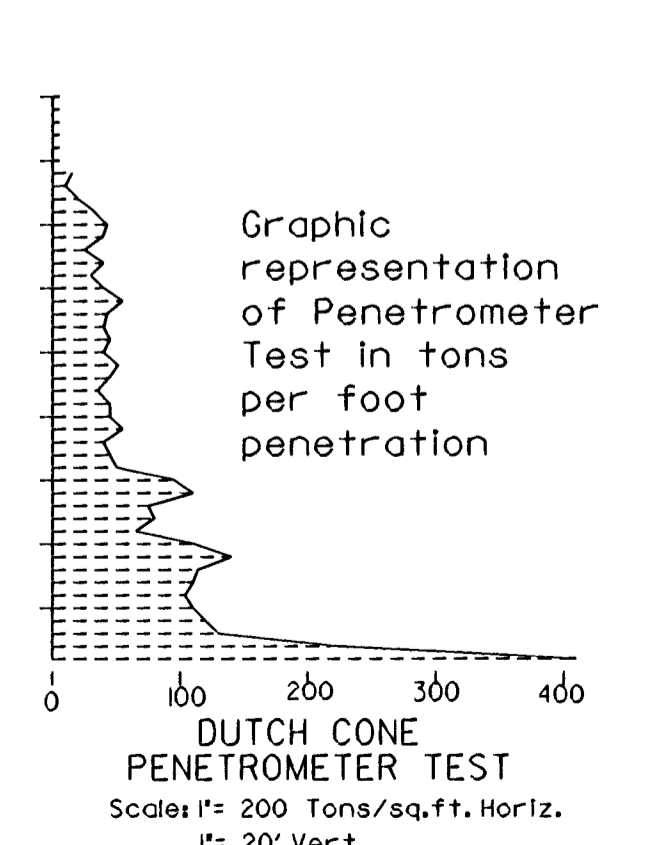
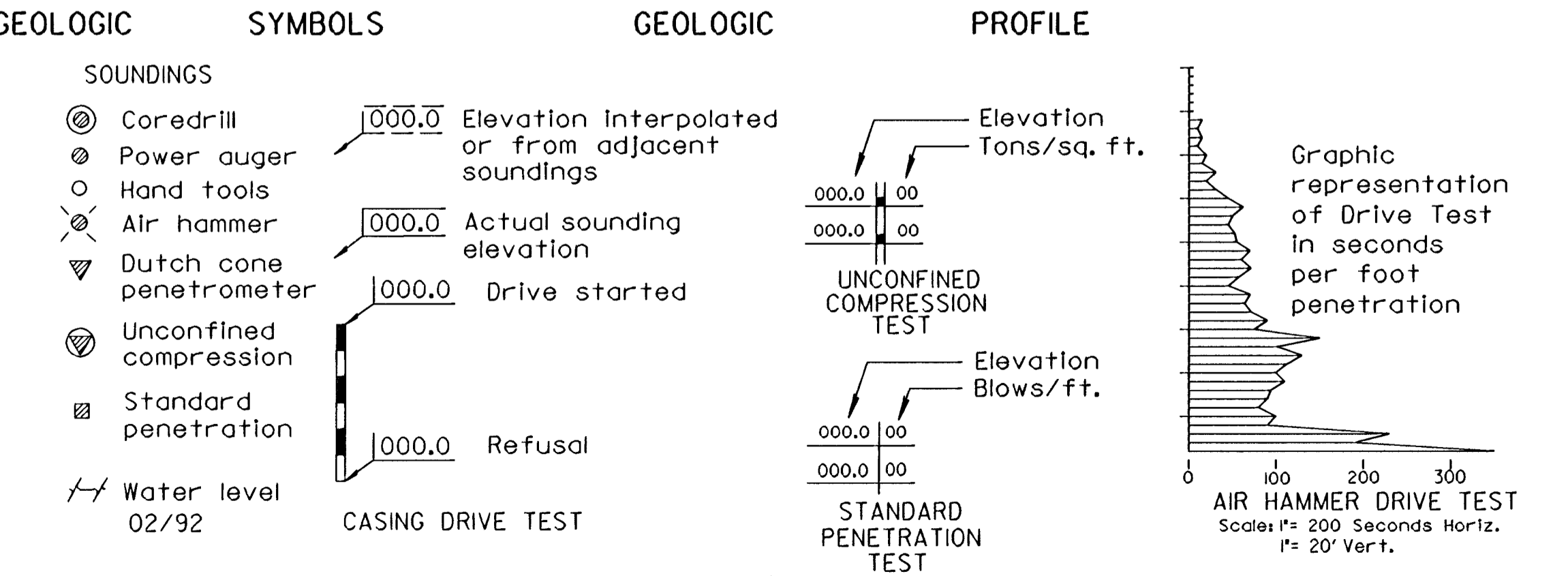

NOTE: The soundings shown on these plans are taken from notes in the field and represent the best information available. The logs of these soundings are in the files of the City of Wichita Public Works Department - Engineering Division and are available at their offices at Wichita, Kansas for inspection by interested and qualified bidders.

Revisions		By	Date
CITY OF WICHITA, KANSAS MICHAEL E. LINDEBAK, P.E.-CITY ENGINEER DOUGLAS AVENUE BRIDGE OVER ARKANSAS RIVER ENGINEERING GEOLOGY CITY OF WICHITA PROJECT NO. 472-82721 PROFESSIONAL ENGINEERING CONSULTANTS, P.A. ENGINEERS WICHITA, KANSAS			
Designed by	R.W.A.	Checked by	R.A.S.
Drawn by	W.L.L.	Date	Sept. 1997
		Job No.	95088-4

ust:\usr\agn\95088\002\geodoug.dgn
 drawn by : wll
 plotted by : ras 9-12-97

SCALE: 1"= 20' Horiz. 1"= 20' Vert.