

**SLAB SECTION**

(Normal to  $\epsilon$  Roadway looking upstation)  
 \*H\* = Top of Surface Course to Top of Web = 11"

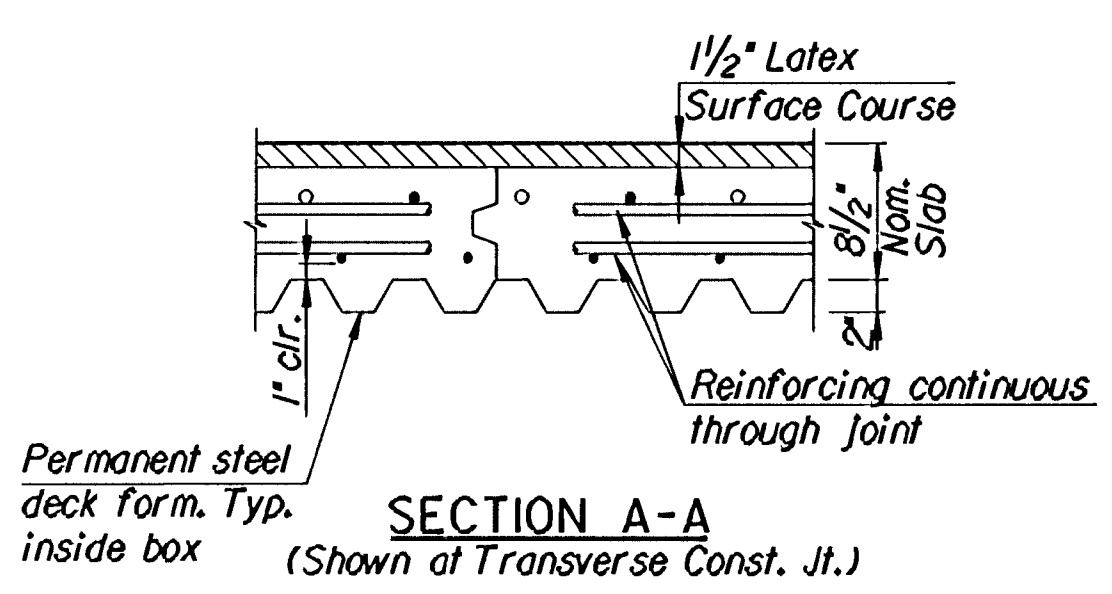

**SECTION A-A**  
 (Shown at Transverse Const. Jt.)

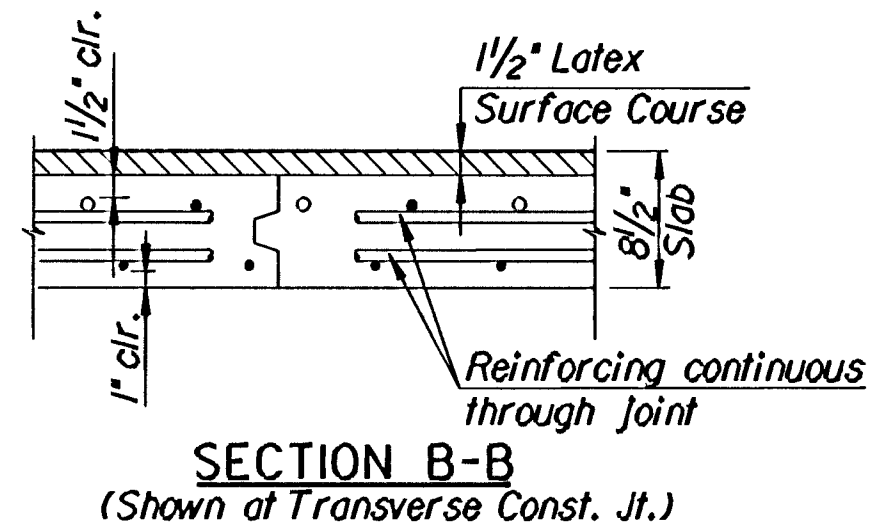

**SECTION B-B**  
 (Shown at Transverse Const. Jt.)

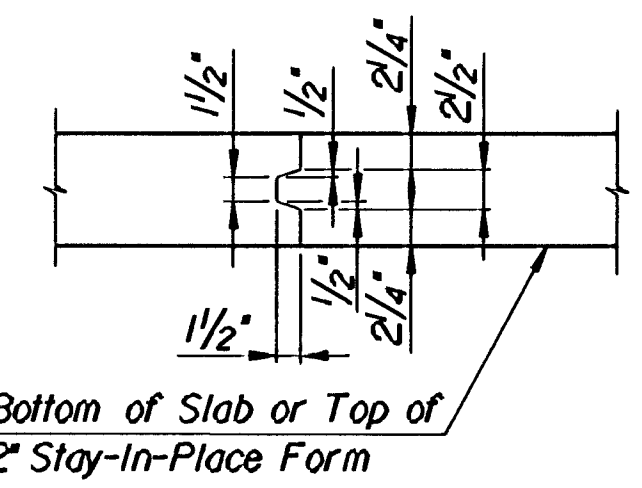

**TYPICAL TRANSVERSE KEYED JOINT**

**SLAB NOTES:**

- All falsework used for the erection of the boxes shall be removed before the concrete for the slab is placed.
- Forms for the slab and barrier rails shall be supported by the boxes.
- Construction joints shall be made only at the locations shown or as approved by the Engineer.
- All debris shall be removed from inside the girder after the slab is in place.
- For Barrier Rail Details, see Sheet C71.
- For details of the Concrete Placing Sequence, see Sheet C54.
- For Shear Connector Detail, see Sheet C48.

**PERMANENT STEEL DECK FORM NOTE:**

Steel deck forms shall be Type I conforming to ASTM A446 and shall be detailed to clear top lateral bracing. Support hangers shall be a non-welded system. No welding will be permitted to any flange. The pay quantity of the concrete slab shall be computed from the nominal slab dimension with no allowances for corrugations. No direct payment will be made for deck forms or any additional concrete. These items will be considered subsidiary to "Class AAA Concrete (AE) (SA)". Permanent steel deck forms shall be used inside the boxes (non-exposed area only).

No.		Revisions		By		Date	
CITY OF WICHITA, KANSAS MICHAEL E. LINDEBAK, P.E.-CITY ENGINEER DOUGLAS AVENUE BRIDGE OVER ARKANSAS RIVER <b>ROADWAY SLAB DETAIL SECTION</b> CITY OF WICHITA PROJECT NO. 472-82721 <b>PROFESSIONAL ENGINEERING CONSULTANTS, P.A.</b> ENGINEERS WICHITA, KANSAS							
Designed by	R.W.A.	Checked by			R.A.S.		
Drawn by	J.G.P.	Date	Sept. 1997	Job No.	95088-4		

i:/1995/95088/douglas/typrdwg.dgn  
 Drawn by: wil  
 Plotted by: wil 11-10-97