

WARNING:
 Existing 36" Dia. Waterline (Extreme care must be exercised during removal).

Note:
 Water Surface is to be lowered during Bridge Removal and Pier Substructure Construction. After static water surface is resumed the leading and trailing edges of causeway to be protected from facia scour at contractors choice (broken concrete, piling, stabilization, etc.). No asphalt is allowed in or on the causeways.

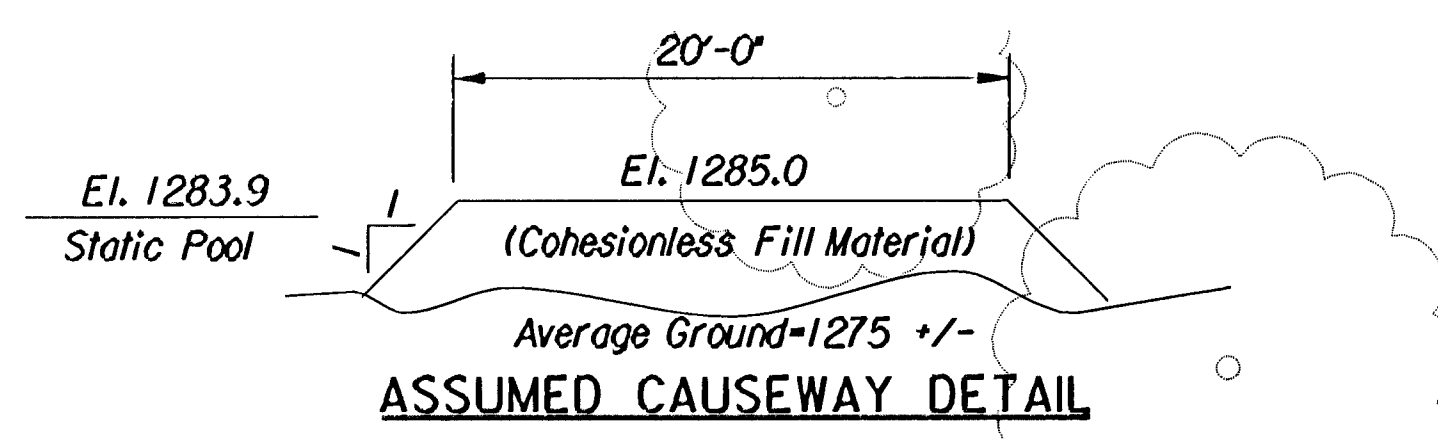

CAUSEWAY: After construction ends the river bottom (existing ground line) must adhere to the general shape as shown in elevation. This may involve either total or partial causeway removal. Causeways are allowed to be phased. Estimated material quantities are for Phase I + Phase II work. Total Approximated at 6000 Cu. Yds.

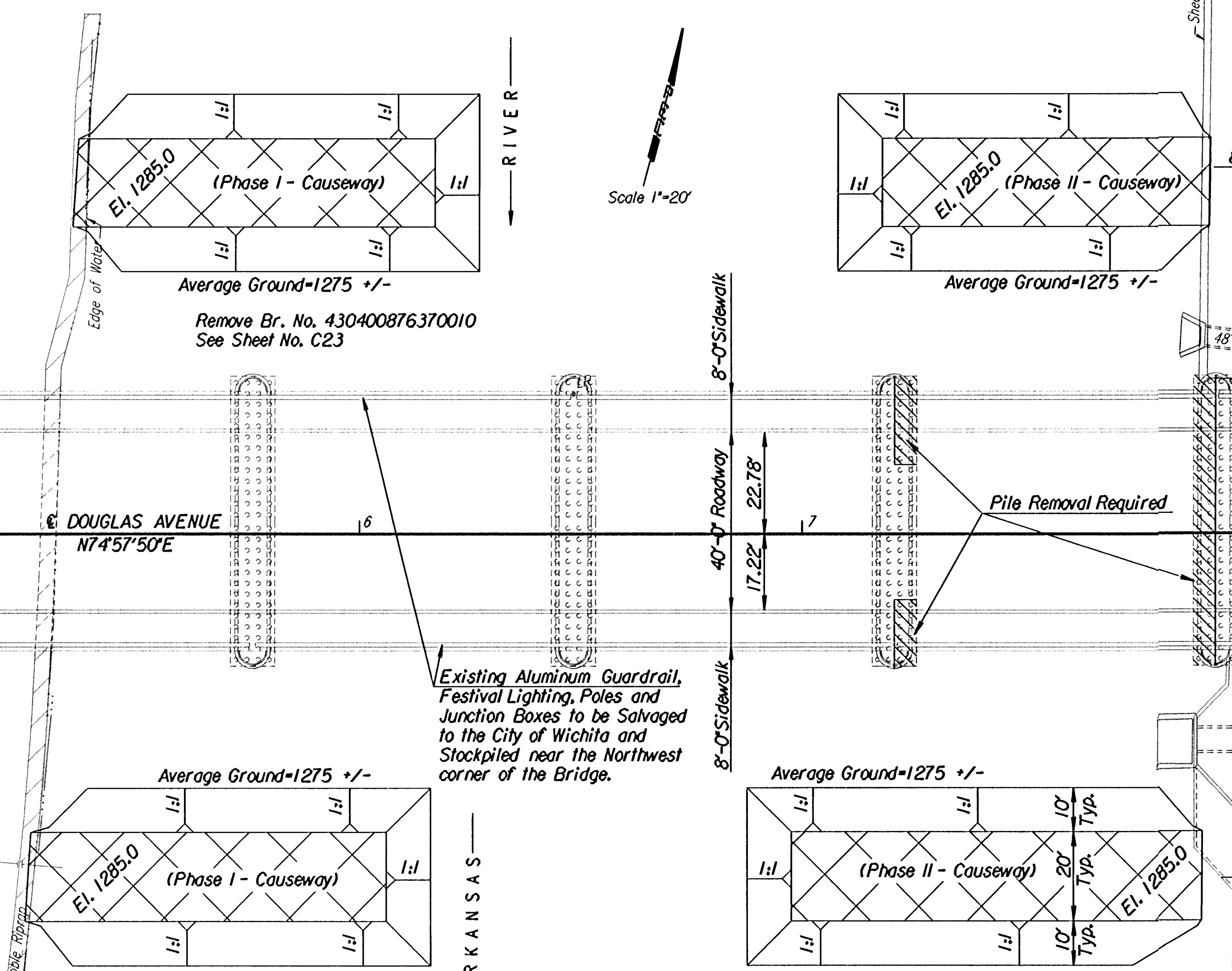

REMOVAL OF EXISTING STRUCTURES: The contractor shall remove the existing structure in accordance with the standard specifications for state road and bridge construction. Concrete, reinforcement and piles from the removal of the existing bridge shall be removed from the site and disposed of at a location approved by the engineer.

Plans for the existing structure are on file in the City of Wichita engineering office and are available for inspection by qualified bidders.

LEGEND
 Pile Removal Required

Retaining Walls to be Removed (Full Depth)
 Water Vault to be Removed

See Sh. No. C79 for Existing Bridge Section.

No.	Revisions	By	Date

CITY OF WICHITA, KANSAS
 MICHAEL E. LINDEBAK, P.E. - CITY ENGINEER
 DOUGLAS AVENUE BRIDGE OVER ARKANSAS RIVER
REMOVAL PLAN
 CITY OF WICHITA PROJECT NO. 472-82721
PROFESSIONAL ENGINEERING CONSULTANTS, P.A.
 ENGINEERS
 WICHITA, KANSAS

Designed by	R.W.A.	Checked by	R.A.S.
Drawn by	J.G.P.	Date	Sept. 1997

Job No. 95088-4