

J:\PROJECTS\2019\1901010483\_COW\_RCB\_TYLER AND HARRY\_190483\_CAD\SHOTS\01\_GENERAL\TITLESHEETS\190483-05-5001.DWG  
 PLOTTED: Thursday, February 11, 2021 @ 03:00PM

# PLANS FOR RCB REPLACEMENT-TYLER & HARRY

CITY OF WICHITA  
 SEDGWICK COUNTY, KANSAS  
 GARY L. JANZEN, P.E. - CITY ENGINEER  
 C.O.W. PROJECT NO. 468-2020-085448  
 C.O.W. OCA NO. 133117  
 SWS #742

### INDEX TO DRAWINGS

SHEET NO.	DESCRIPTION
1	TITLE SHEET
2	GENERAL NOTES
3	TYPICAL SECTIONS
4	PLAN & PROFILE
5-6	PAVING DETAILS
7	MISCELLANEOUS DETAILS
8	WATER LINE
9	CONTOUR MAP
10	BARREL DETAILS
11-14	WING DETAILS
15	PRECAST CONCRETE BOX CULVERT DETAILS
16	RCB AUXILIARY DETAILS (LFDR)
17	BRIDGE EXCAVATION (LRFD)
18	SUPPORTS & SPACERS FOR REINFORCING STEEL
19-24	EROSION CONTROL PLAN
25-27	PAVEMENT MARKING AND SIGNING PLAN
28	CONSTRUCTION SEQUENCE SUMMARY
29-39	TRAFFIC CONTROL PLANS AND DETAILS
40	DRAINAGE MAP
41	CROSS SECTIONS

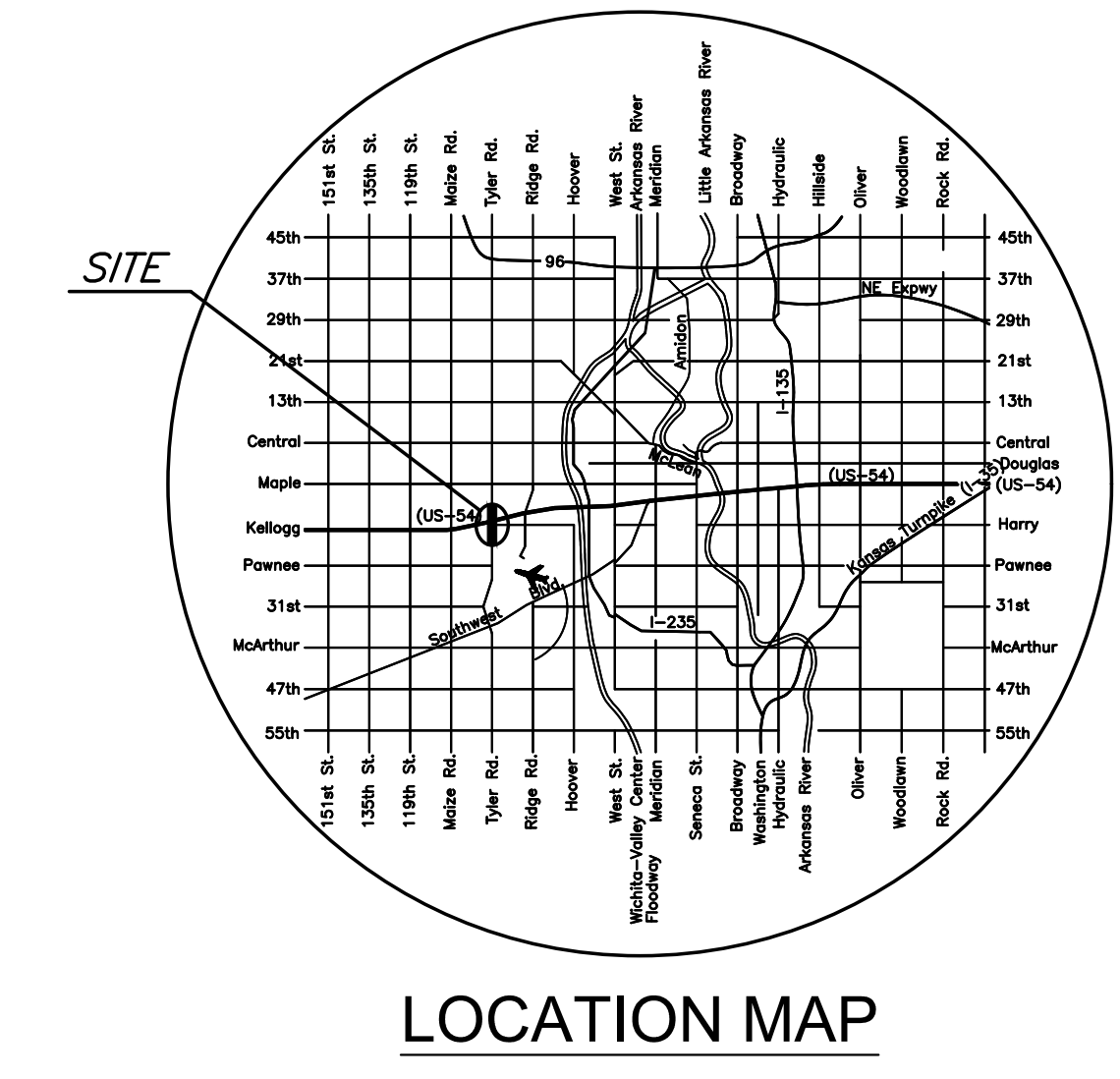

PLANS FOR  
**RCB REPLACEMENT-TYLER & HARRY**  
 CITY OF WICHITA, KANSAS

### PROJECT CONTROL & INFORMATION

**DATUM:**  
 THE HORIZONTAL DATUM IS BASED ON THE KANSAS COORDINATE SYSTEM OF 1983(2011), SOUTH ZONE. COORDINATES SHOWN HAVE BEEN MODIFIED TO THE GROUND USING A COMBINED ADJUSTMENT FACTOR OF 1.0001200144. STATE PLANE COORDINATES CAN BE CALCULATED BY MULTIPLYING THE SHOWN VALUES BY 0.99988.

**ALL ELEVATIONS SHOWN ARE BASED ON THE NAVD 88 VERTICAL DATUM.**

**CONTROL POINTS (GND):**  
 CP 100  
 N:1677873.159 E:1618235.420 EL:1329.43  
 CHISELED "X" TOP OF CURB @ N. RETURN E. SIDE OF TYLER. NE CORNER TYLER AND HARRY.

CP 101  
 N:1677774.165 E:1618400.898 EL:1331.03  
 CHISELED "X" TOP OF WEST HEADWALL @ NORTH END ON RCB SOUTH SIDE OF HARRY. EAST OF TYLER AND HARRY INTERSECTION.

CP 102  
 N:1677774.165 E:1618400.898 EL:1331.03  
 5/8" BY 24" REBAR WITH ALUM MKEC CP CAP

**BENCHMARKS:**  
 BM 100  
 N:1677873.159 E:1618235.420 EL:1329.43  
 +CUT TOP OF CURB @ N. RETURN E. SIDE OF TYLER. NE CORNER TYLER AND HARRY.

BM 101  
 N:1677774.165 E:1618400.898 EL:1331.03  
 +CUT TOP OF WEST HEADWALL @ NORTH END ON RCB SOUTH SIDE OF HARRY. EAST OF TYLER AND HARRY INTERSECTION.

**NOTE:**  
 ALL CONTROL POINTS SHOWN HAVE ELEVATIONS ESTABLISHED USING STANDARD SURVEYING PROCEDURES AND CAN BE USED AS TEMPORARY BENCHMARKS. WHEN USING A CONTROL POINT AS A TEMPORARY BENCHMARK, IT IS RECOMMENDED THAT CROSS-CHECKS BE MADE TO OTHER CONTROL POINTS OR BENCHMARKS TO CONFIRM ELEVATIONS PRIOR TO USE.

**UTILITIES:**  
 THE UNDERGROUND UTILITIES SHOWN HEREON WERE MARKED IN THE FIELD BY THE UTILITY OWNERS IN RESPONSE TO KANSAS ONE CALL TICKET NUMBER: 20115920 & 20115928. THE SURVEYOR MAKES NO GUARANTEE THAT THE UNDERGROUND UTILITIES SHOWN COMPRISE ALL SUCH UTILITIES IN THE AREA, EITHER IN SERVICE OR ABANDONED. THE SURVEYOR FURTHER DOES NOT WARRANT THAT THE UNDERGROUND UTILITIES SHOWN ARE IN THE EXACT LOCATION INDICATED ALTHOUGH HE DOES CERTIFY THAT THEY ARE LOCATED AS ACCURATELY AS POSSIBLE FROM INFORMATION AVAILABLE. THE SURVEYOR HAS NOT PHYSICALLY LOCATED THE UNDERGROUND UTILITIES.

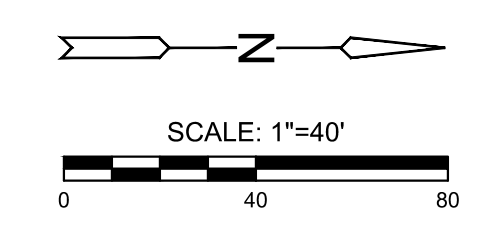
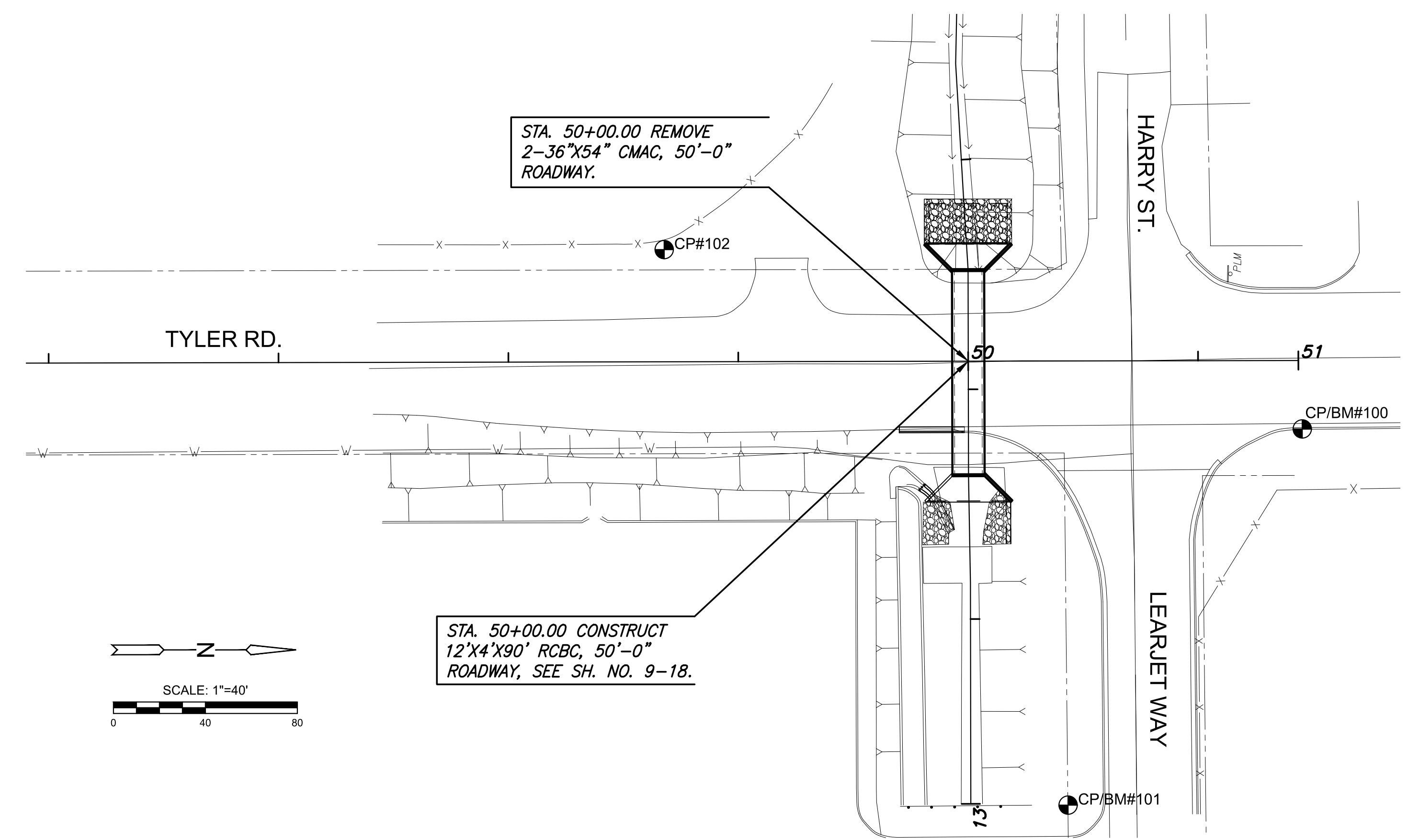

©2021  
 MKEC Engineering  
 All Rights Reserved  
 www.mkec.com  
 These drawings and their contents, including, but not limited to, all concepts, designs, & ideas are the exclusive property of MKEC Engineering (MKEC), and may not be used or reproduced in any way without the express consent of MKEC.

### TITLE SHEET

PROJECT NO.	1901010483	
DATE	FEB. 2021	
SCALE	1" = 40'	
DESIGNED	DRAWN	CHECKED
JRA	RAM	JRA
NO.	REVISION	DATE
SHEET NO.		
1 OF 41		