

PLOTTED: Thursday, February 11, 2021 @ 03:02PM

**CONTROL POINT #100**  
 1. Chiseled "X" top of curb  
 2. STA. 51+45.25 29.8' RT.  
 3. N 1677873.159 E 1618235.420  
 4. ELEV. 1329.43

**CONTROL POINT #101**  
 1. Chiseled "X" top of west headwall  
 2. STA. 50+43.06 193.3' RT.  
 3. N 1677774.165 E 1618400.898  
 4. ELEV. 1331.03

**CONTROL POINT #102**  
 1. 5/8" by 24" Rebar  
 2. STA. 48+67.86 48.8' LT.  
 3. N 1677774.165 E 1618400.898  
 4. ELEV. 1331.03

**BENCHMARK POINT #100**  
 1. +Cut top of curb  
 2. STA. 51+45.25 29.8' RT.  
 3. N 1677873.159 E 1618235.420  
 4. ELEV. 1329.43

**BENCHMARK POINT #101**  
 1. +Cut top of west headwall  
 2. STA. 50+43.06 193.3' RT.  
 3. N 1677774.165 E 1618400.898  
 4. ELEV. 1331.03

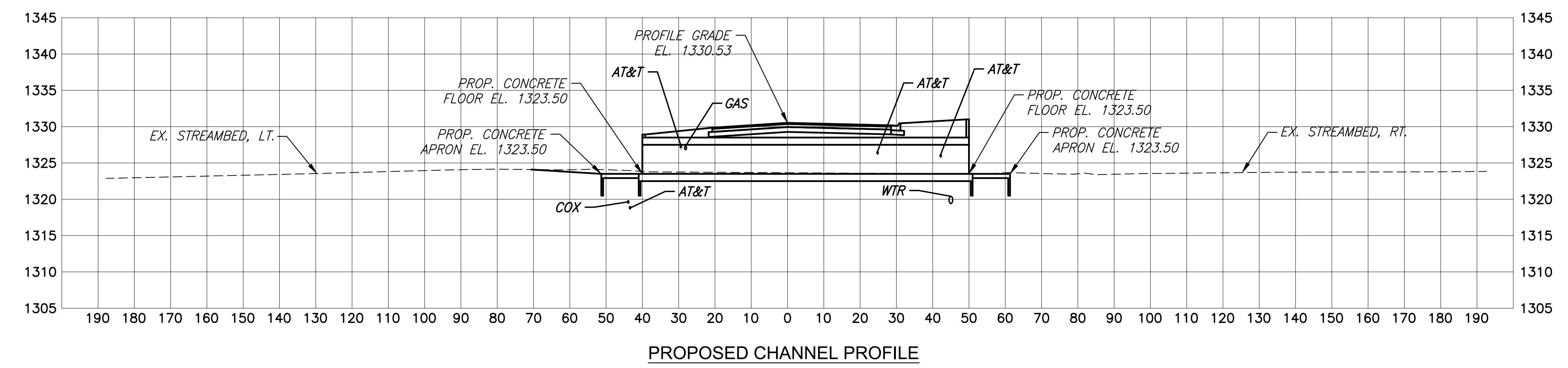
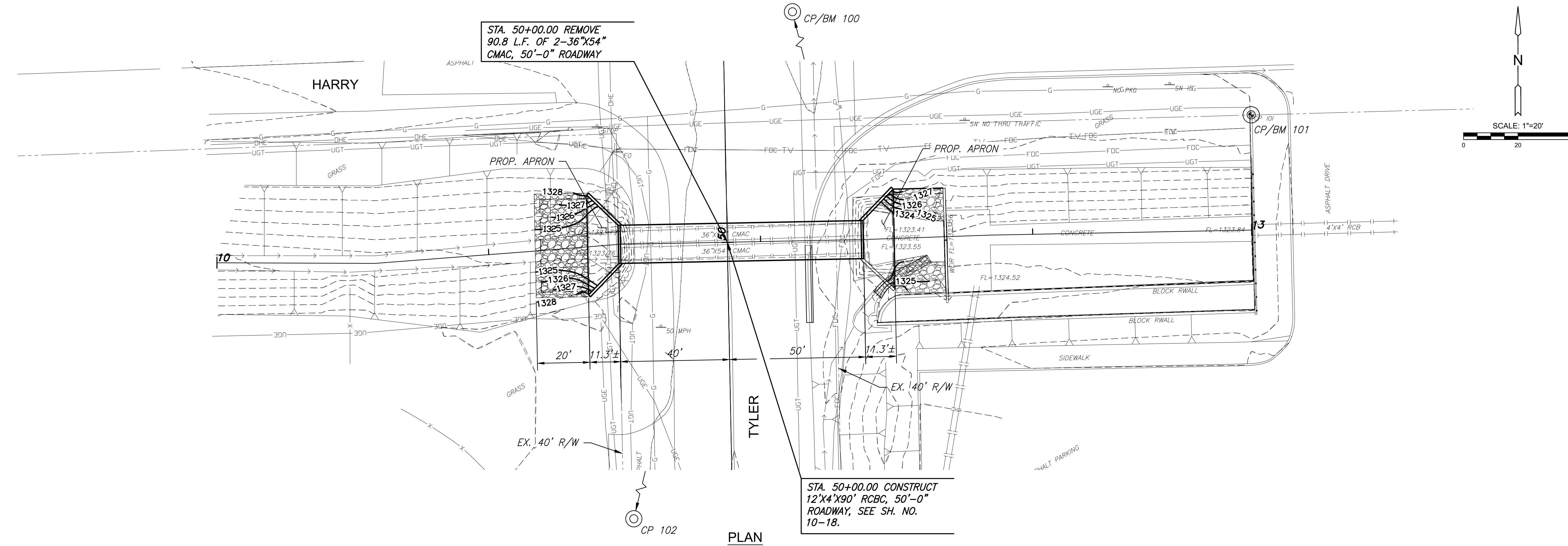

NOTE: ALL UTILITIES INDICATE EXISTING LOCATIONS PRIOR TO RELOCATING. CONTACT THE CITY FOR CURRENT, RELOCATED UTILITIES.



PLANS FOR  
**RCB REPLACEMENT-TYLER & HARRY**  
 CITY OF WICHITA, KANSAS

©2021 MKEC Engineering All Rights Reserved www.mkec.com  
 These drawings and their contents, including, but not limited to, all concepts, designs, & ideas are the exclusive property of MKEC Engineering (MKEC), and may not be used or reproduced in any way without the express consent of MKEC.

**CONTOUR MAP**

PROJECT NO.	1901010483	
DATE	FEB. 2021	
SCALE	1" = 20'	
DESIGNED	DRAWN	CHECKED
JRA	RAM	JRA

NO.	REVISION	DATE

SHEET NO.  
 9 OF 41

J:\PROJECTS\2019\1901010483\_COW\_RCB\_TYLER AND HARRY\_190483\_CADD\SHOTS\06 CIVIL\BRIDGE\190483-05-250.DWG