

BENCH MARK #2: "□" cut on top of curb @ West end of return, NW corner of 2nd St. & Mosley Elev. 111.16

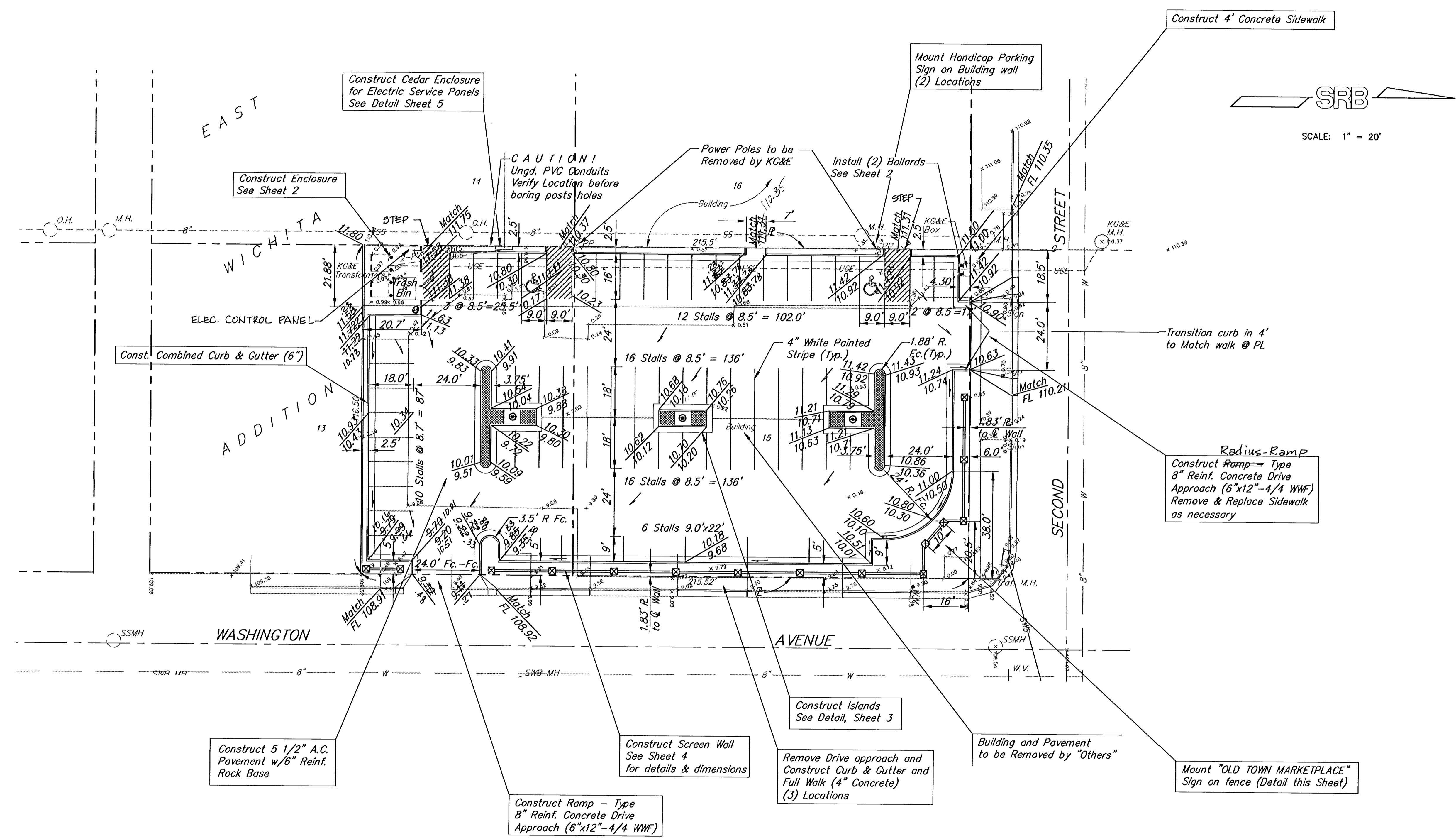

SRB
SCALE: 1" = 20'

Construct 5 1/2" A.C. Pavement w/6" Reinf. Rock Base

Construct Ramp - Type 8" Reinf. Concrete Drive Approach (6"x12"-4/4 WWF)

Construct Screen Wall See Sheet 4 for details & dimensions

Construct Islands See Detail, Sheet 3

Remove Drive approach and Construct Curb & Gutter and Full Walk (4" Concrete) (3) Locations

Building and Pavement to be Removed by "Others"

Mount "OLD TOWN MARKETPLACE" Sign on fence (Detail this Sheet)

Radius-Ramp Construct Ramp - Type 8" Reinf. Concrete Drive Approach (6"x12"-4/4 WWF) Remove & Replace Sidewalk as necessary

Transition curb in 4' to Match walk @ PL

Mount Handicap Parking Sign on Building wall (2) Locations

Construct 4' Concrete Sidewalk

Construct Cedar Enclosure for Electric Service Panels See Detail Sheet 5

Construct Enclosure See Sheet 2

CAUTION! Ungd. PVC Conduits Verify Location before boring posts holes

Power Poles to be Removed by KG&E

Install (2) Bollards See Sheet 2

NOTE:
Dimensions are to face of curb except where noted otherwise.

LEGAL DESCRIPTION:
The North 25 feet of Lot 13 and the South 50 feet of the North 1/2 of Lot 13; and all of Lot 15, in East Wichita Addition, City of Wichita, Sedgwick County, Kansas, on Washington Avenue.

SITE PLAN - PARKING LOT #10 OLD TOWN PARKING DISTRICT			
SRB	841 SOUTH HILLSIDE WICHITA, KANSAS 67211	316-652-7754 FAX 652-7932	REVISION
	SAVOY, RUGGLES & BOHM, P.A. ENGINEERING & SURVEYING		6
PROJECT NUMBER			
DRAWN I. Brooks	DESIGN I. Ruggles	REVIEW	DATE 2-23-94
REVISED 7-11-94 RECORD COPY		UTILITY	SRB JOB 101E
			14

C:\MDCADD\CIVIL\PL10E\PL10E.V11 Wed Feb 23 09:40:12 1994