

**BENCHMARKS:**  
 CUT OFF "T"-POST, DOWN 0.25'  
 13.5' WEST OF POWER POLE  
 30' SOUTH OF FIRE HYDRANT  
 +/- 200' SOUTH OF CENTERLINE  
 DRIVE TO HOUSE # 2816 S MAIZE RD.  
 ELEV. = 1328.386 (NAVD 88)

SQUARE CUT WITH + IN SW WINGWALL  
 OF THE SOUTHERNMOST OF THREE  
 CONCRETE DITCH CHECKS  
 +/- 1125' WEST OF CENTERLINE S.  
 MAIZE RD, BEHIND HOUSE #2951 S  
 MAIZE RD.  
 ELEV. = 1332.383 (NAVD88)

SCHULTE-JOHNSON  
 2ND ADDITION

**POND DATA:**  
 STATIC POOL ELEVATION: 1332.5  
 PROPOSED BOTTOM ELEVATION: 1324.5  
 100-YR ELEVATION: 1335.4

**NOTE:**  
 Contractor to adjust  
 end section as  
 necessary to match  
 pond slope.

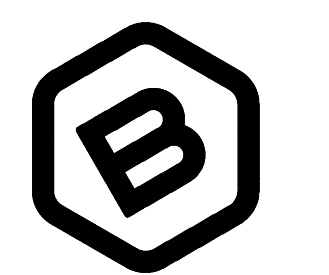
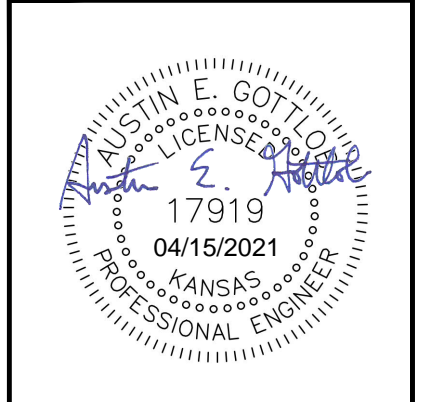
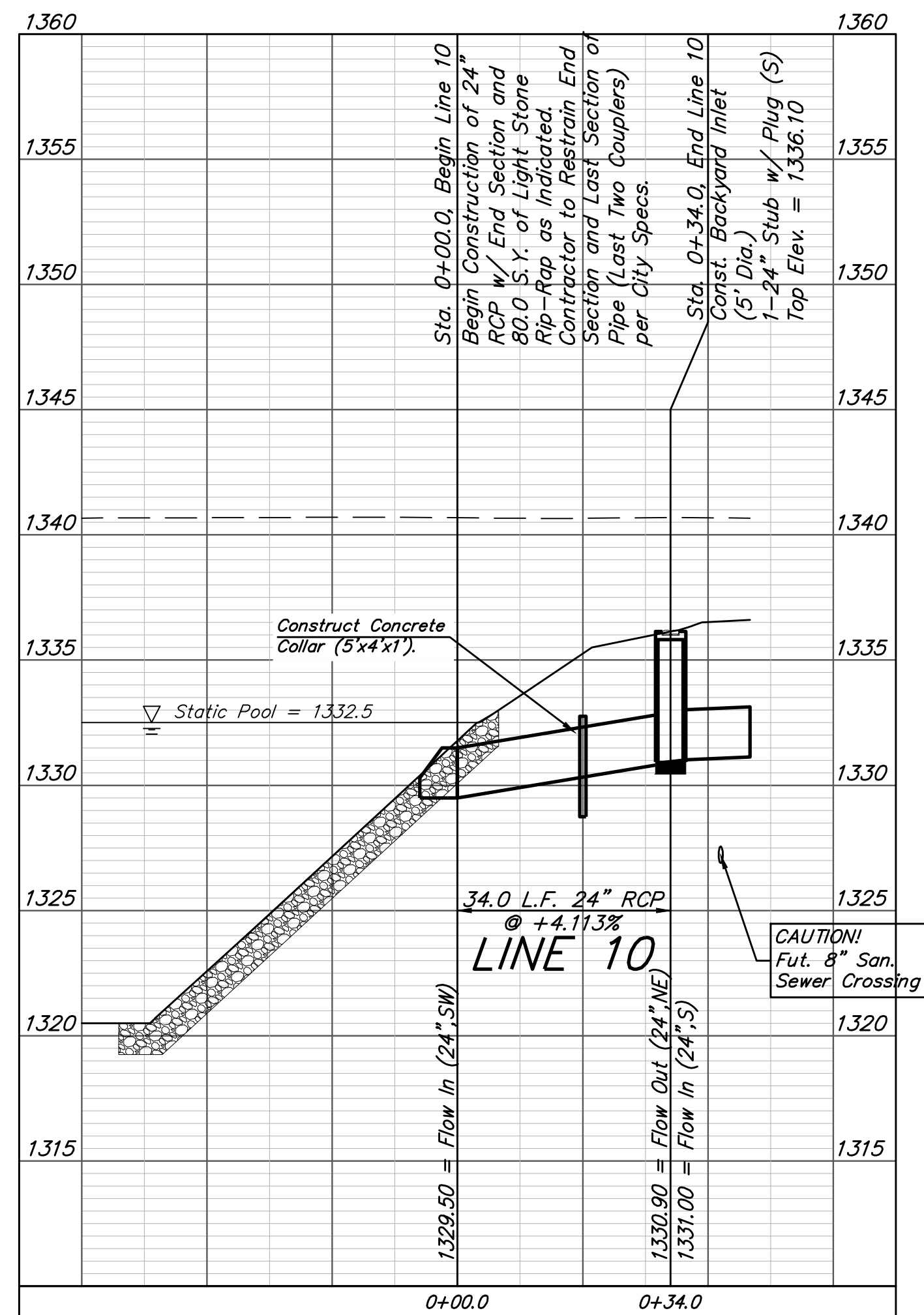
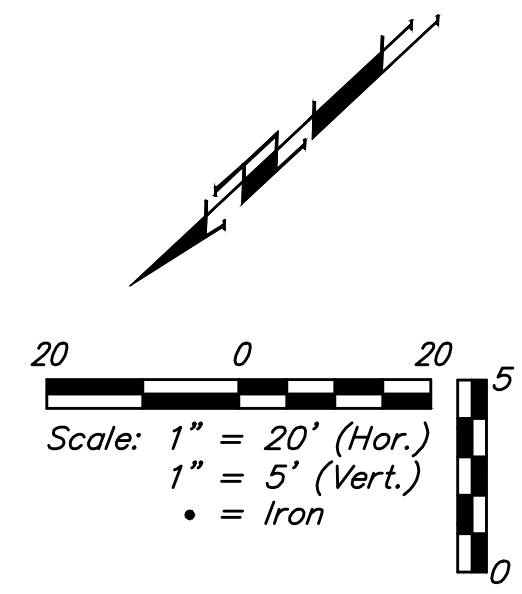
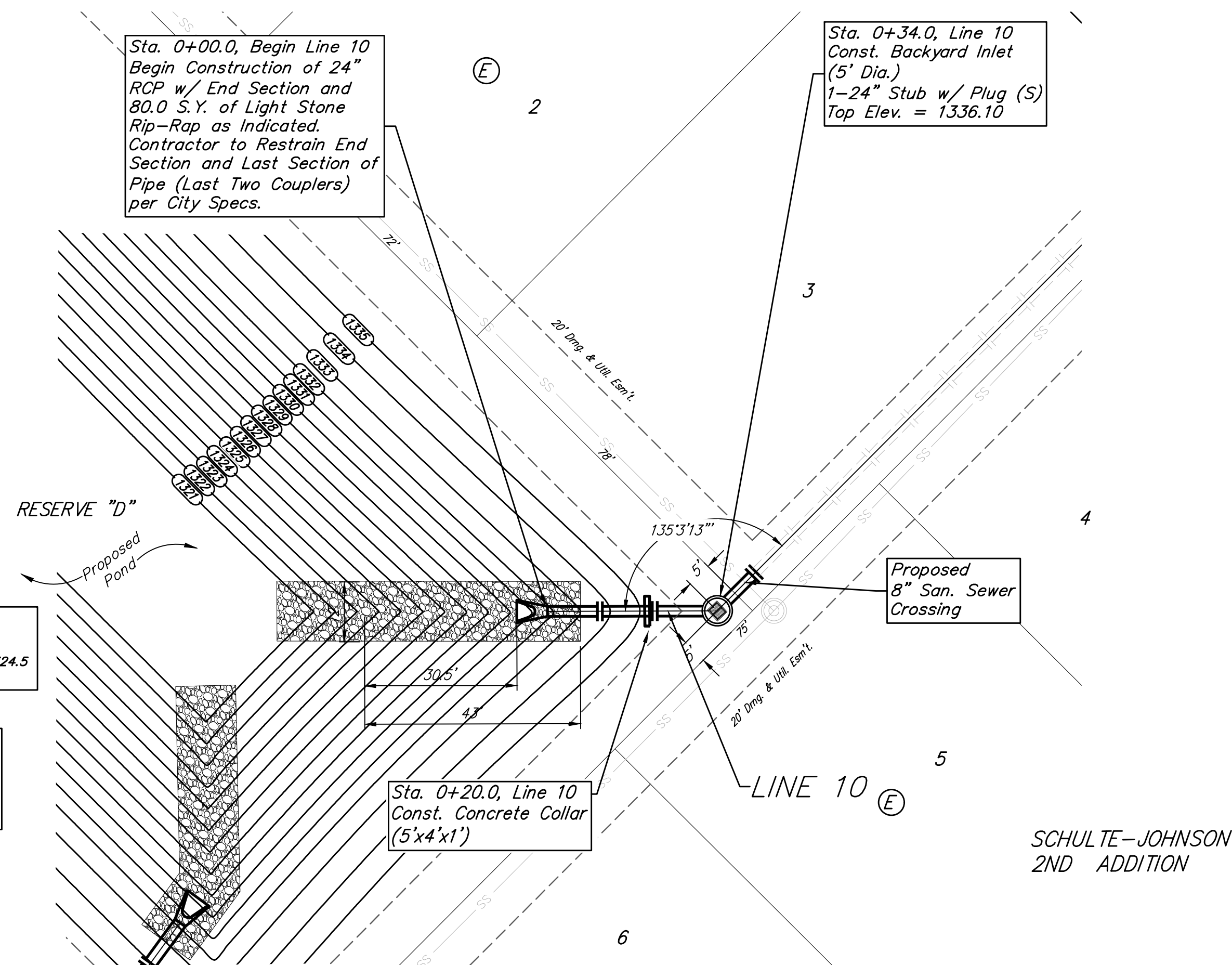

**BAUGHMAN  
 COMPANY**

315 Ellis St.  
 Wichita, KS 67211  
 316-262-7271  
 BaughmanCo.com

SCHULTE-JOHNSON  
 2ND ADDITION

LINE 10

STORMWATER DRAIN  
 IMPROVEMENTS

PROJECT NUMBER:  
 468-2019-085425

DESIGN: AEG DRAWN: HJW

DATE: April 12, 2021

SHEET OF  
 16 37

File: C:\Projects\Schulte-Johnson\2nd Addition\Engineering\SWD\SWS Plans.dwg