

BENCHMARKS:
 CUT OFF "T"-POST, DOWN 0.25'
 13.5' WEST OF POWER POLE
 30' SOUTH OF FIRE HYDRANT
 +/- 200' SOUTH OF CENTERLINE
 DRIVE TO HOUSE # 2816 S MAIZE RD.
 ELEV. = 1328.386 (NAVD 88)

SQUARE CUT WITH + IN SW WINGWALL
 OF THE SOUTHERNMOST OF THREE
 CONCRETE DITCH CHECKS
 +/- 1125' WEST OF CENTERLINE S.
 MAIZE RD, BEHIND HOUSE #2951 S
 MAIZE RD.
 ELEV. = 1332.383 (NAVD88)

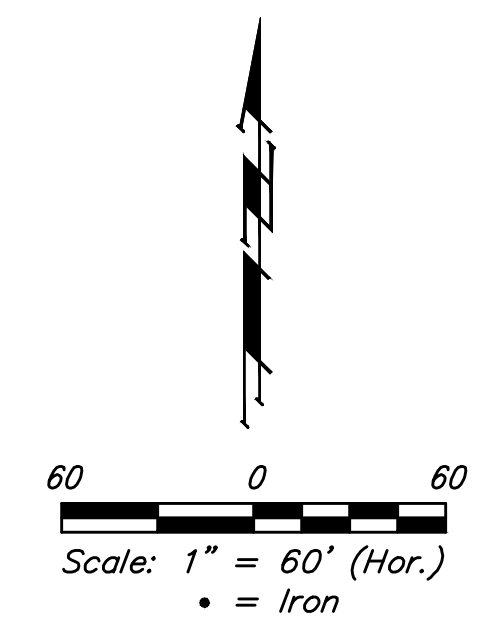
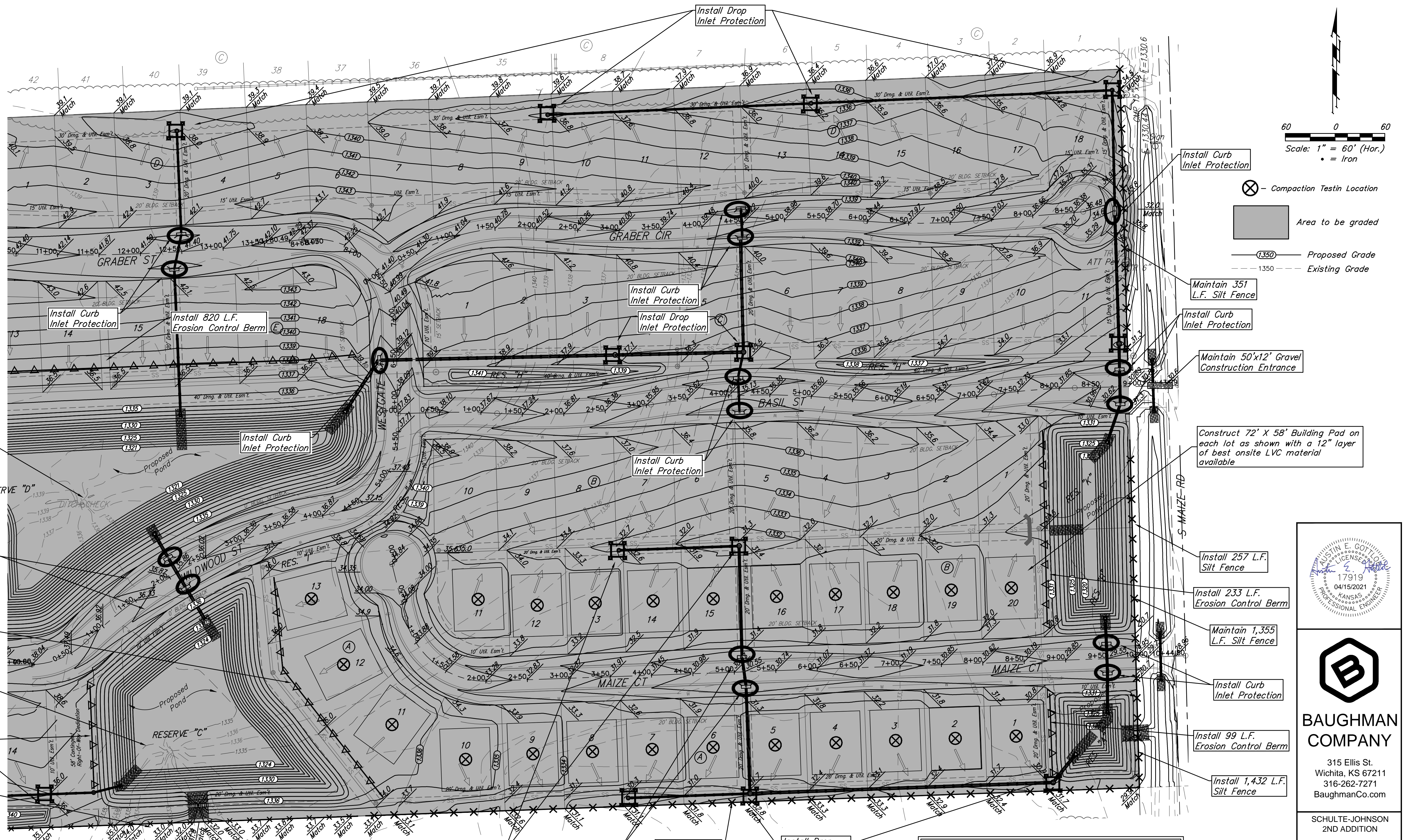
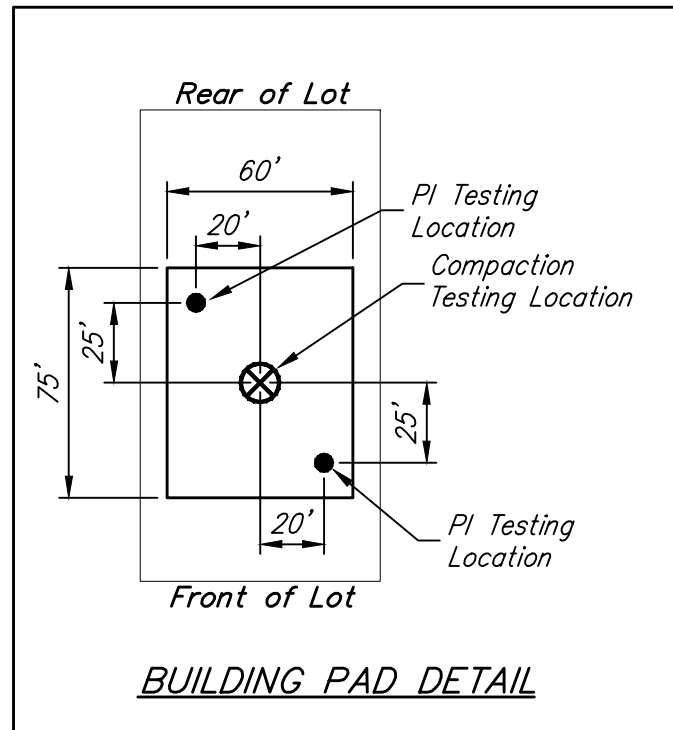

- ⊗ - Compaction Testin Location
- Area to be graded
- (1350) — Proposed Grade
- - - 1350 - - - Existing Grade

Remove Concrete Ditch Check. Incidental to "Site Clearing"

Install Curb Inlet Protection

Install 306 L.F. Erosion Control Berm

Remove Concrete Ditch Check. Incidental to "Site Clearing"

Install 125 L.F. Erosion Control Berm

Install Drop Inlet Protection

Install 2,588 L.F. Silt Fence

Install Curb Inlet Protection

Maintain 351 L.F. Silt Fence

Install Curb Inlet Protection

Maintain 50'x12' Gravel Construction Entrance

Construct 72' X 58' Building Pad on each lot as shown with a 12" layer of best onsite LVC material available

Install 257 L.F. Silt Fence

Install 233 L.F. Erosion Control Berm

Maintain 1,355 L.F. Silt Fence

Install Curb Inlet Protection

Install 99 L.F. Erosion Control Berm

Install 1,432 L.F. Silt Fence

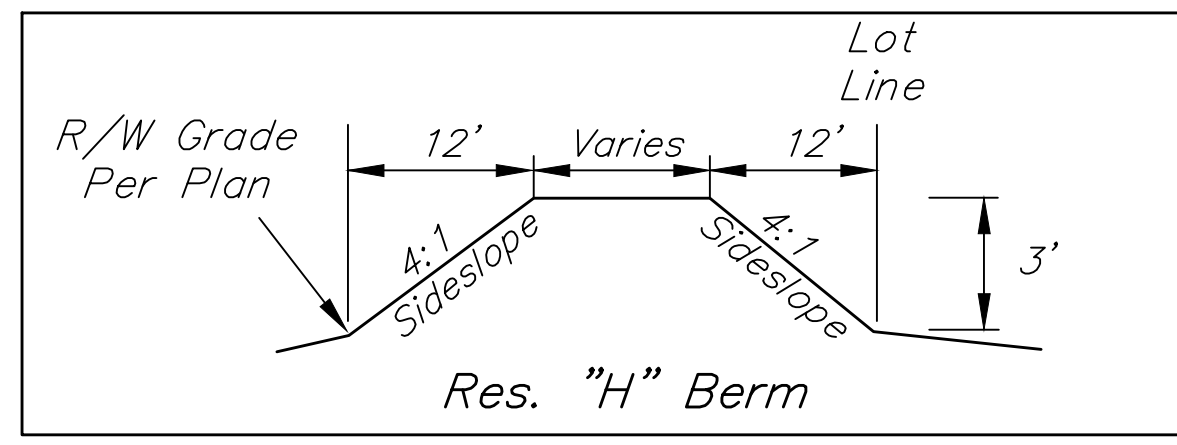
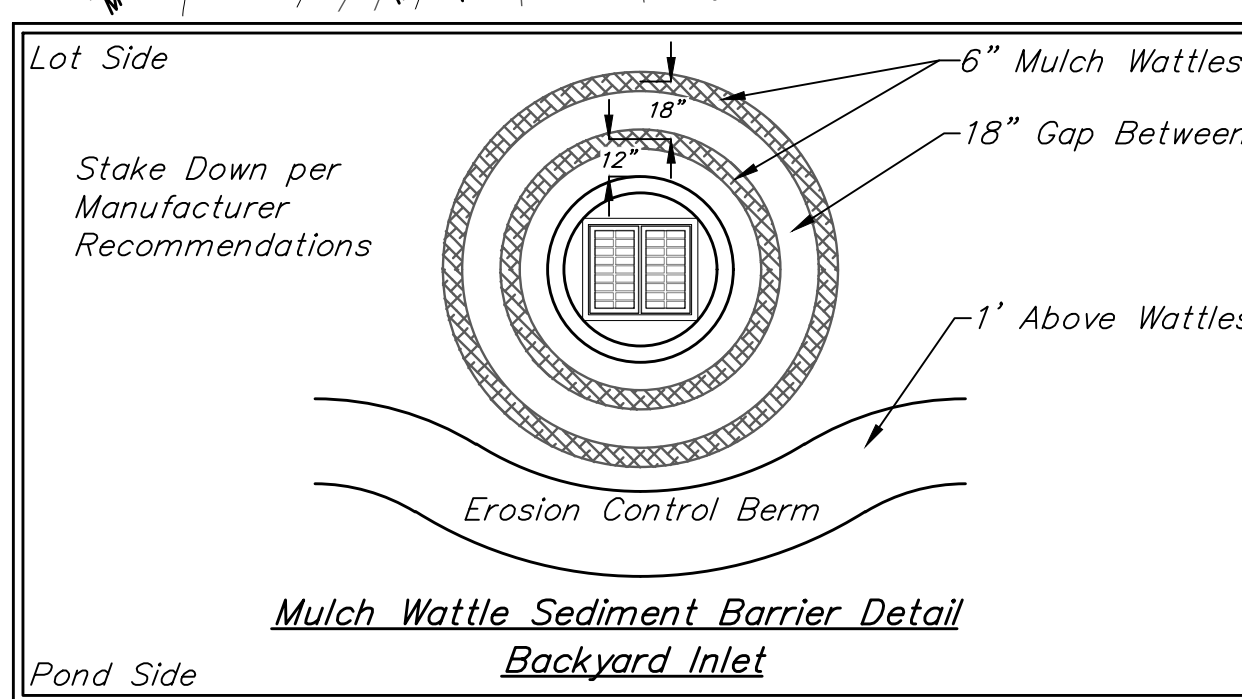

- EROSION CONTROL PLAN LEGEND**
- ⊗ - DROP INLET PROTECTION
 - ⊕ - CURB INLET PROTECTION
 - ⊖ - DITCH CHECKS
 - ⊗ - SILT FENCING
 - △ - EROSION CONTROL BERM

EARTH WORK TOTALS (CY, Unadjusted for shrink/swell) *for information only

	EXCAVATION	FILL
Reserve "A" Pond	1,260	25
Reserve "B" & "K" Pond	3,830	50
Reserve "C" Pond	11,800	150
Reserve "D" Pond	52,500	-
Reserve "E" Pond	6,550	-
Mass Grading	28,560	94,475
Project Totals	104,500	94,700

Earthwork Quantities reflect the best available topography. The Contractor shall satisfy himself with the earthwork quantities as bid for L.S. bid item "Grading, Mass" prior to bidding. No additional payments or change orders for earthwork will be accepted.

NOTE
 The intent of the project is to achieve an earthwork balance. The Contractor shall contact the Engineer prior to finishing pond construction if pond bottoms need adjusted to satisfy the earthwork balance.

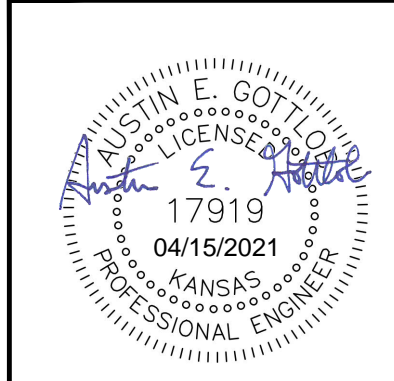

315 Ellis St.
 Wichita, KS 67211
 316-262-7271
 BaughmanCo.com

SCHULTE-JOHNSON
 2ND ADDITION

MASS GRADING

STORMWATER DRAIN IMPROVEMENTS

PROJECT NUMBER:
 468-2019-085425

DESIGN: AEG DRAWN: HJW

DATE: April 12, 2021

SHEET OF
 21 37

File: C:\Projects\Schulte-Johnson 2nd Addition\Engineering\SWD\SWD Plans.dwg