

GOLD & MACARTHUR IMPROVEMENTS (TRAFFIC SIGNALIZATION)

PROJECT NO. 472 83609
OCA # 710216

GENERAL NOTES

- Utility service lines, poles, valve boxes, meters, and et cetera are to be adjusted as necessary by others prior to construction unless the plans specifically call for their adjustment by the Contractor or unless the plans specifically identify a utility to be adjusted by its owner during construction. Existing utilities and their location, as shown on the plans, represent the best information obtainable for design. The Contractor will be required to work around existing utilities within the right-of-way which do not conflict with proposed construction.
- Rubble from the removal of miscellaneous structures and excess excavation which is to be wasted shall be disposed of on sites to be provided by the Contractor. These sites shall be approved by the Engineer as to suitability, appearance and site location. Locations that, in the opinion of the Engineer, will leave an unsightly appearance will not be approved.
- All disposal sites must be approved by the Kansas Department of Health and Environment. Material either stockpiled or disposed of in a flood plain would require a Kansas State Board of Agriculture permit. Any material dumped in waters of the United States or wetlands is subject to U.S. Corps permitting regulations. Any material buried or stockpiled beyond approved of Engineers construction limits would require additional archeological investigations unless buried in a previously approved borrow location.
- Trees and shrubs in public right-of-way which are in direct conflict with proposed new construction shall be removed by the Contractor with the Engineer's approval. Trees and shrubs which are not in direct conflict with proposed new construction shall be saved and protected from damage.
- The Contractor shall be responsible for preserving property irons. The Contractor will be required to re-establish any property irons which are damaged or destroyed by his construction operations. Such irons shall be re-established by a licensed land surveyor in accordance with state laws.
- Contractor will be required to provide a minimum advance notice of twenty-four (24) hours to utility companies prior to starting any excavation as follows:

Kansas One-Call	687-2470
Cox Communications	262-0661
Kansas Gas Service	383-8600
Westar	383-8600
Aquila	1-800-303-0357
Southwestern Bell Telephone Company	1-800-286-8313
City of Wichita Water Department	262-6000
City of Wichita Sewer Maintenance	262-6000
Conoco Pipeline	681-2081, 800-231-2551
Southern Star Pipeline	800-324-9696
- The Contractor must notify the following utility companies in case of an emergency:
- Sprinkler irrigation systems within the project limits which are damaged by Contractor's operations shall be repaired or replaced. Any such repair or replacement cost will be subsidiary to the bid item for site restoration.
- Conduit to be bid as jacked under existing pavement. Any pavement removal and replacement required for conduit or other underground installation to be subsidiary to bid items for conduit.
- Two-way traffic on Gold and on MacArthur to be maintained at all times during construction.
- All traffic signal equipment and wiring shall be installed in accordance with city of Wichita specifications.
- All existing traffic signs shall be stockpiled at the central maintenance facility, 1801 S. McLean.
- All signal faces to be L.E.D.
- The contractor will be responsible for furnishing and installing the complete controller system and for all equipment necessary for the complete and satisfactory operation of the signal system, whether or not said equipment is specifically mentioned. Quantities shown are estimates for information only.

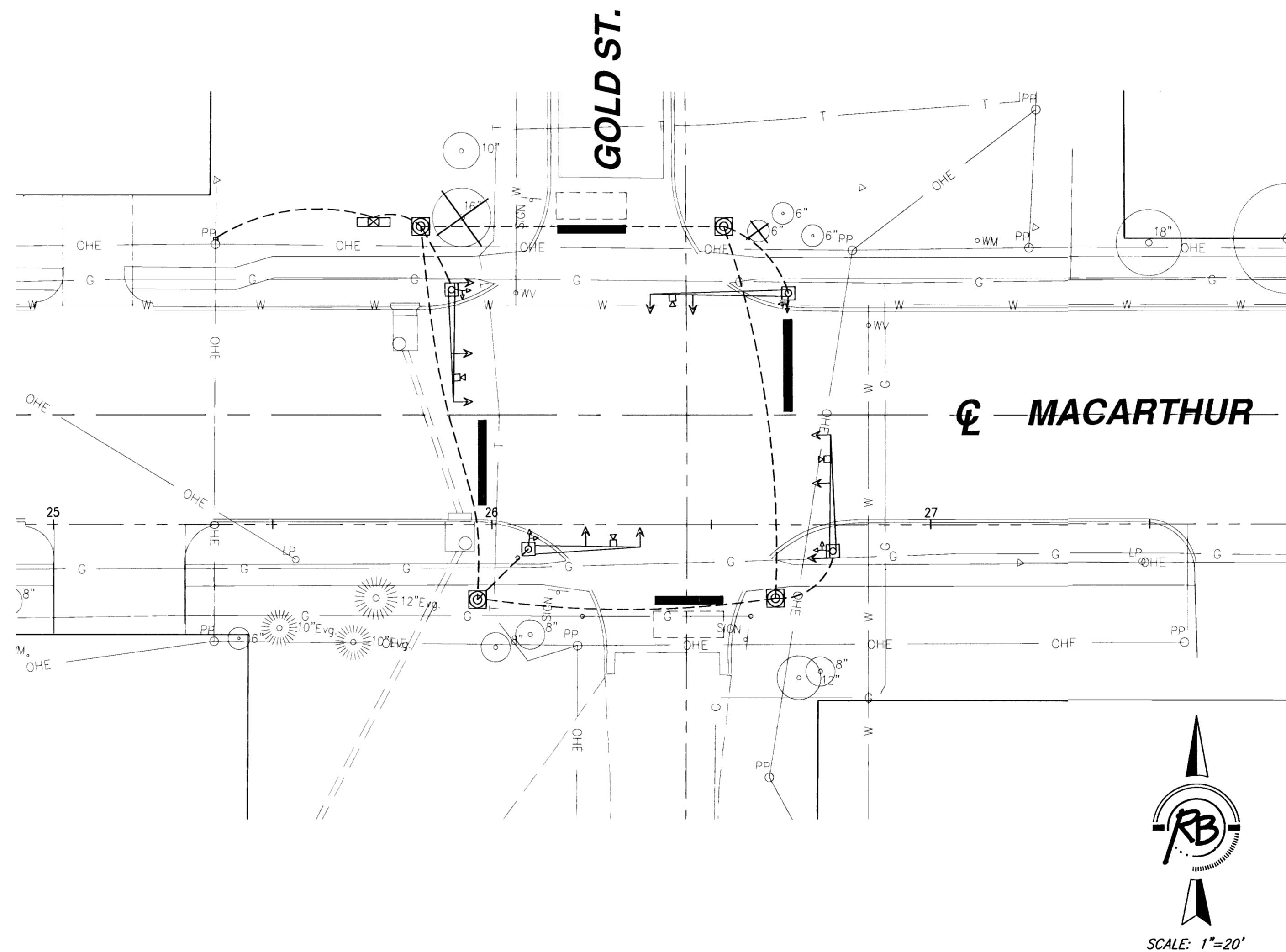

SCALE: 1"=20'

BENCH MARK

C.O.W. DISC 89.80 WEST OF E GOLD & 38.6'
NORTH OF E MACARTHUR ELEV. 1277.20
3/4" I.P. IN THIMBLE N 1/4 COR. SEC. 17-2851E
ELEV. 1276.06

INDEX OF SHEETS

- INDEX SHEET
- SIGNAL PLAN
- WIRING AND SCHEDULES
- PAVEMENT MARKING AND SIGNS
- STANDARD SIGNAL DETAILS
- STANDARD SIGNAL DETAILS
- STANDARD SIGNAL DETAILS
- SIGN DETAILS

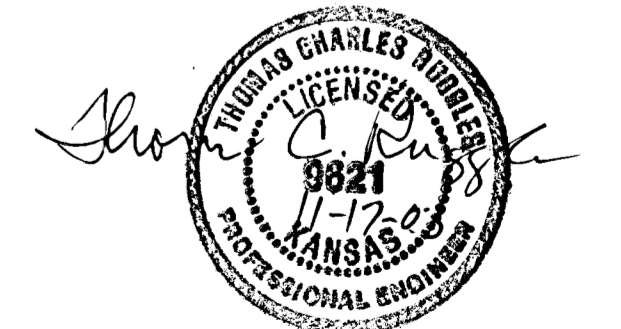
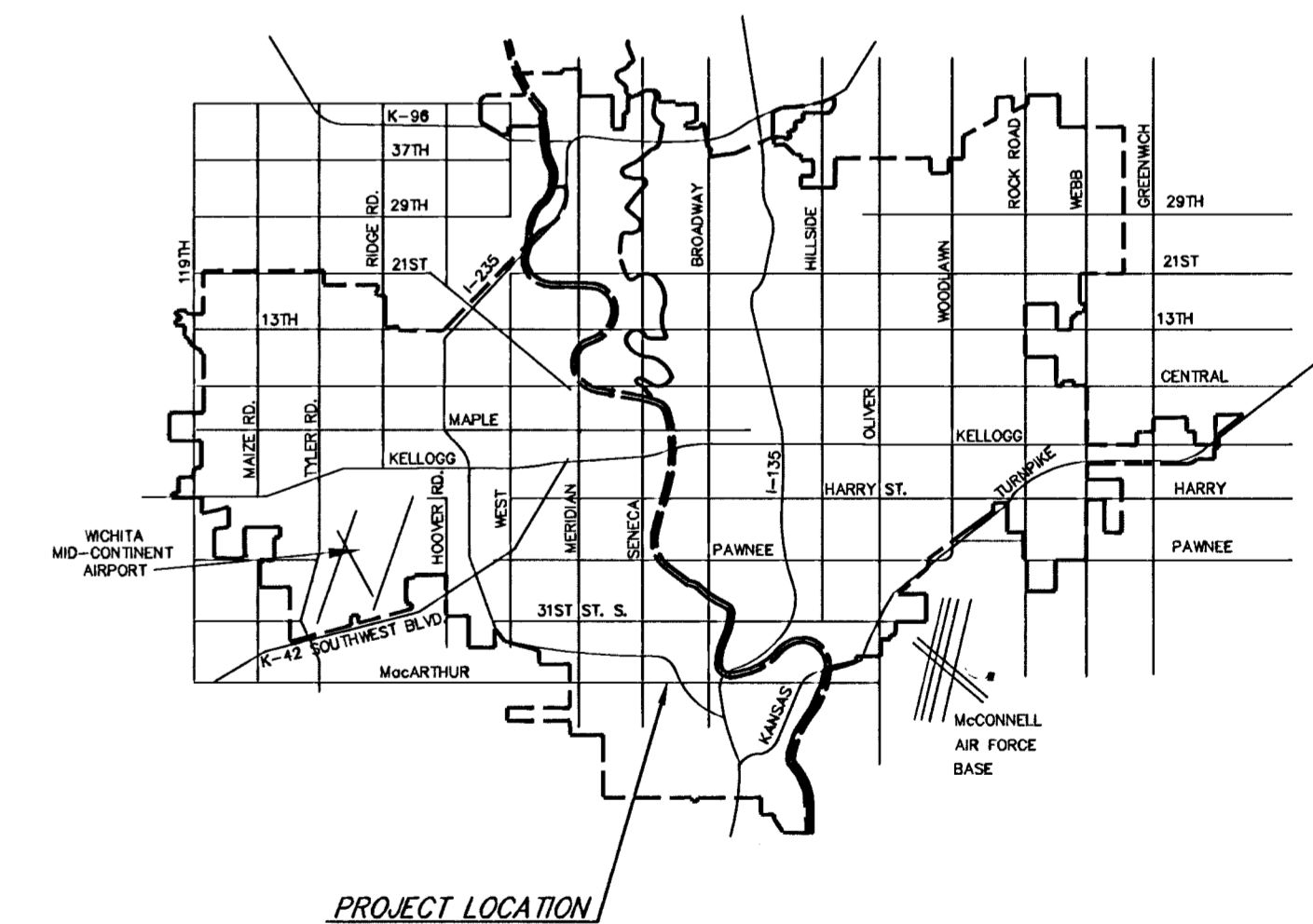

CITY OF WICHITA, KANSAS
NEIL CABLE, P.E. - CITY ENGINEER

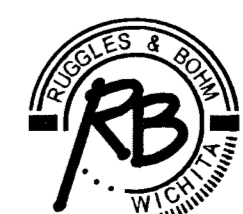

Ruggles & Bohm, P.A.
Engineering, Surveying, Land Planning
924 North Main (316) 264-8008
Wichita, Kansas 67203 (316) 264-4621 fax
www.rbkansas.com E-mail: info@rbkansas.com