

CAUTION!! Prop. WL
CAUTION!! Exist WL

Sta 0+00 SWS Line 1
BL Sta 34+54.62 30.33' Lt.
Connect to Exist Inlet MH
FL(SW)=102.05

WEST
CAUTION!! Exist SWS
WICHITA
CAUTION!! Exist WL
Remove existing Inlets (2)

Existing MH to Remain
Plug Line Westward
Abandon
Ex. SWS to Remain

229.36 L.F. 42" RCP

Sta 2+29.36 SWS Line 1=
Sta 0+00 SWS Line 2
BL 32+25.26 Sta 21.74' Lt.
Install 1-Type 2 Inlet MH
(Sheet CV 3.1)
Top=110.40
FI 42"(NE)=103.06
FI 42"(SW)=103.26
FI 15"(SE)=105.51
FI 4" Stub(NW)=106.65

Sta 4+39.03 SWS Line 1=
Sta 0+00 SWS Line 3=
Sta 0+00 SWS Line 4
BL Sta 30+15.58 21.85' Lt.
Install 1-5" RCMH
(Sheet CV 3.5)
Top=110.86
FI 42"(NE)=104.12
FI 42"(SW)=104.32
FI 15"(SE)=106.57
FI 15"(NW)=106.57

10.97 L.F. 42" RCP

MATCH LINE
Sta 4+50
B.L. Sta 30+04.62

All trench backfill for this project shall be jetted and flushed sand per City of Wichita specifications. Flowable fill is not required.

Existing SWS that will no longer be in use may be removed for utility construction as necessary, and the remainder abandoned in place per City of Wichita Standard Construction Specifications. Cost shall be Subsidiary to storm sewer items.

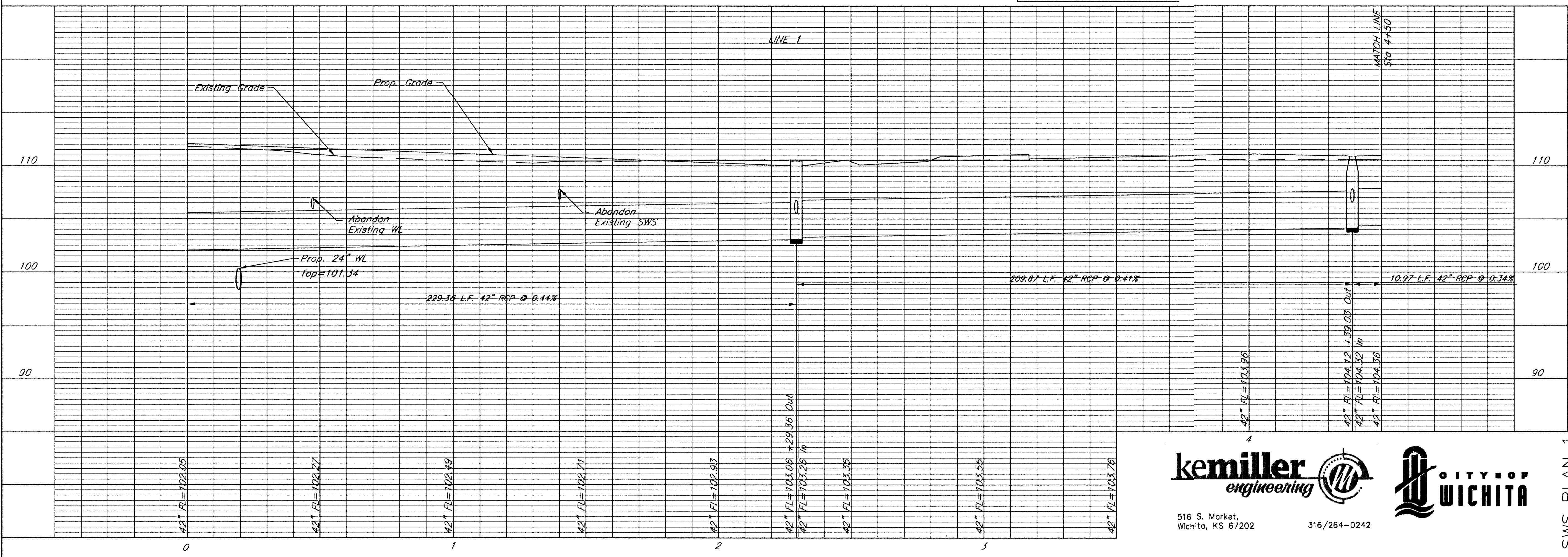

516 S. Market,
Wichita, KS 67202



316/264-0242

ARCHITECTS PLANNERS LANDSCAPE ARCHITECTS
125 S. WASHINGTON WICHITA, KANSAS 67202
P.O. BOX 346 WICHITA, KANSAS 67202
TEL: 316/264-0242 FAX: 316/264-0246

WEST DOUGLAS STREETSCAPE
ARKANSAS RIVER TO SENECA
WICHITA, KANSAS

PROJECT NO. 472 83608 OCA: 706846
MVP PROJECT NO. 101008
DATE: August 7, 2002
REVISED: August 30, 2002

SHEET
CV 2.1

SWS PLAN 1