

FHWA REG. NO.	STATE	PROJECT NO.	YEAR	SHEET NO.	TOTAL SHEETS
7	KANSAS	87N-0196-01	2001	11	55

DATE	
BY	
REFERENCES NOTED	
REFERENCES CHECKED	

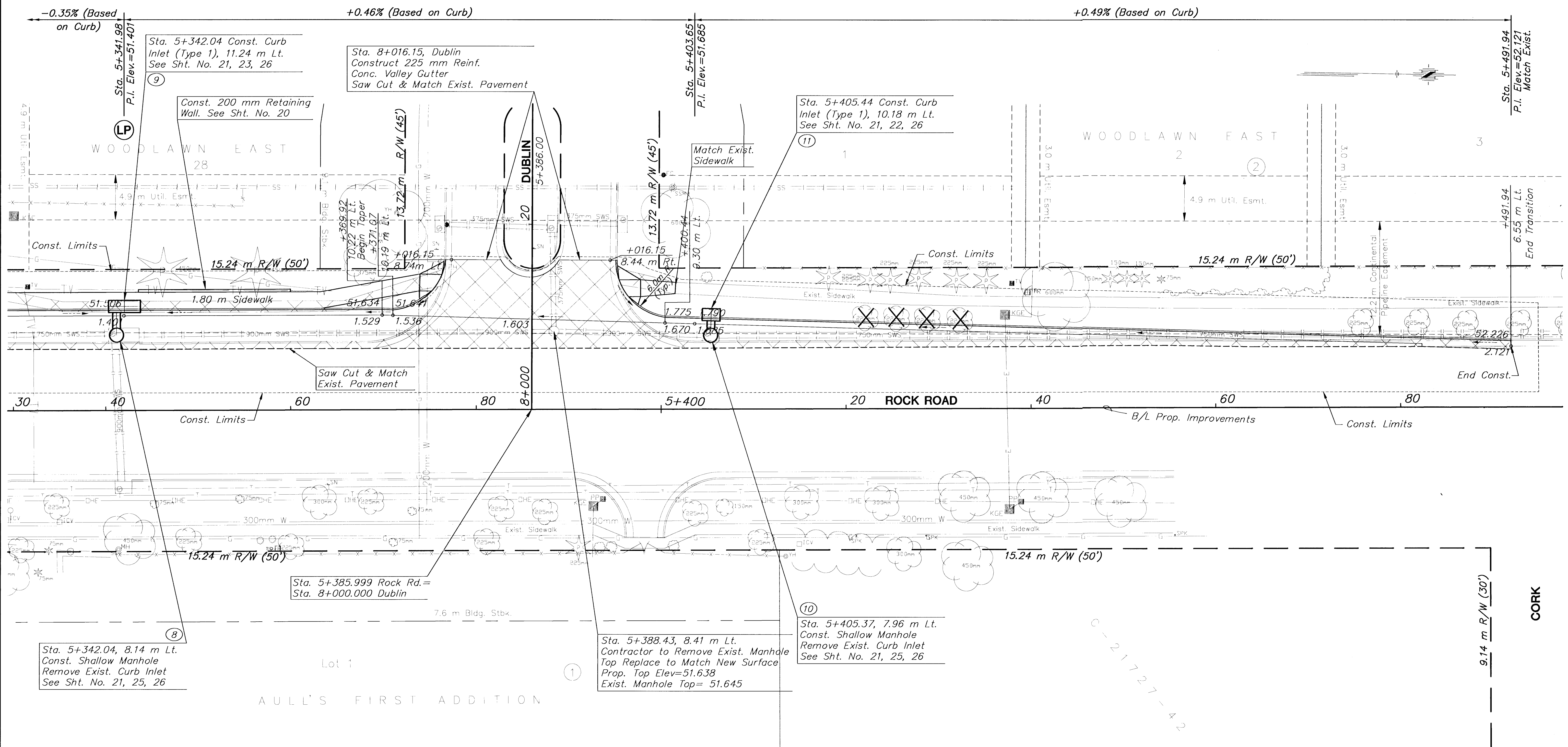

Sta. 5+342.04, 8.14 m Lt.  
Const. Shallow Manhole  
Remove Exist. Curb Inlet  
See Sht. No. 21, 25, 26

Sta. 5+385.999 Rock Rd. =  
Sta. 8+000.000 Dublin

Sta. 5+388.43, 8.41 m Lt.  
Contractor to Remove Exist. Manhole  
Top Replace to Match New Surface  
Prop. Top Elev=51.638  
Exist. Manhole Top= 51.645

Sta. 5+405.37, 7.96 m Lt.  
Const. Shallow Manhole  
Remove Exist. Curb Inlet  
See Sht. No. 21, 25, 26

**Utility Owners**

- Kansas Gas Service 383-8600
- Southwestern Bell Telephone Company 1-800-734-7590
- CATV: Cox Communications 263-2061
- KG&E (Electric) 383-8600
- City of Wichita Water & Sewer Maint. 262-6000
- Jayhawk Pipeline 1-888-542-9575

- Trees to Be Removed
- Pavement, Driveway, and/or Sidewalk Removal

NO.	DATE	REVISIONS	BY	APP'D

KANSAS DEPARTMENT OF TRANSPORTATION  
**CENTRAL & ROCK INTERSECTION**  
**STA. 5+330 TO STA. 5+500**  
 PROJ. NO. 87N-0196-01 SEDGWICK CO.  
**MKEC ENGINEERING CONSULTANTS, INC.**  
 WICHITA, KANSAS

DESIGNED BY: DCH	CHECKED BY: DCH
DRAWN BY: DAG	DATE: APRIL 2001 SHEET 11 OF 55