

FHWA REG NO.	STATE	PROJECT NO.	YEAR	SHEET NO.	TOTAL SHEETS
7	KANSAS	87 N-0196-01	2001	12	55

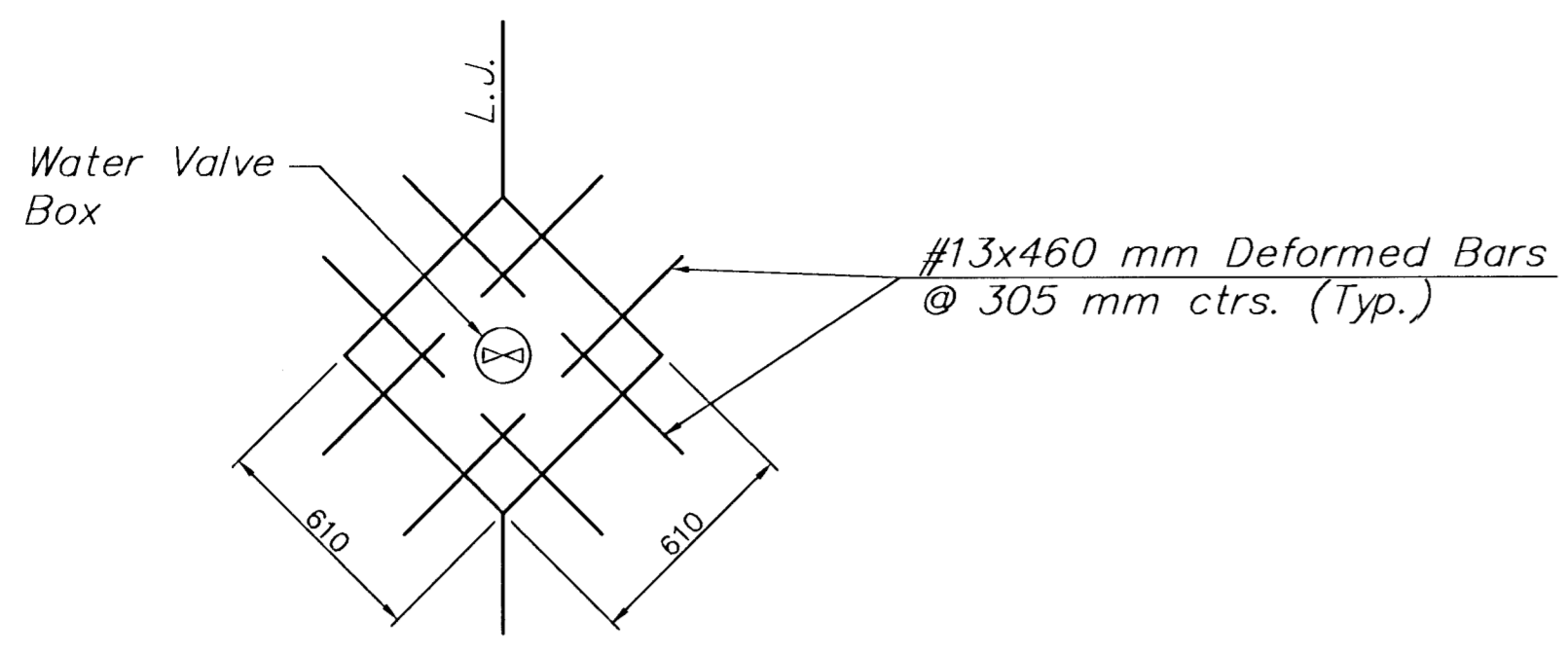

DIAMOND JOINT

Contractor shall cut joints around the Water Valve Box as shown, if the Box lies in the path of the Longitudinal Joint.

1. See separate sheet for Joint Details.
2. Curb Elevations shown are High Edge (0.000) and Top of Curb (00.000).
3. Elevations shown in Paving Brick inlay are for top of pavement: Deduct thickness of Paving Brick and Bedding for elevation at top of concrete.

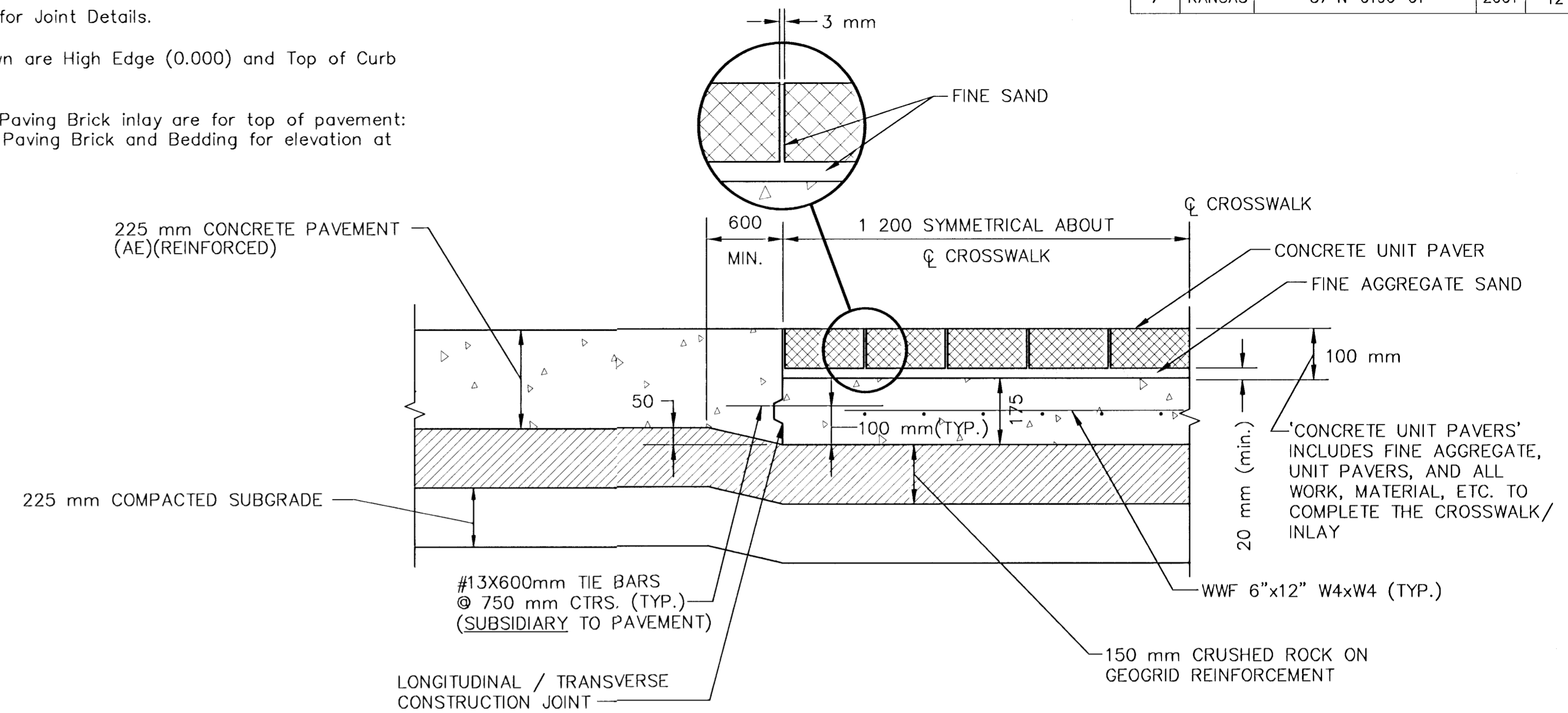

NOTES:

1. CONCRETE UNIT PAVERS SHALL MEET OR EXCEED ASTM C 936. THE STYLE SHALL BE "HOLLAND STONE" (100x200x80) AS MANUFACTURED BY PAVESTONE, INC., OR EQUAL AS APPROVED BY THE ENGINEER. (ALTERNATIVE: CLAY PAVING BRICKS SHALL BE DRY PRESSED BEVEL EDGED STREET PAVERS, DESIGNED FOR HEAVY VEHICLES PER ASTM C 1272, TYPE F APPLICATION PX. SIZE SHALL BE 100x200x76, COMPRESSIVE STRENGTH 5625 Mg/m² MINIMUM, AND ABSORPTION 5% MAXIMUM). COLOR SHALL BE RED AND LAYING PATTERN SHALL BE HERRINGBONE. PAYMENT SHALL BE AT THE CONTRACT BID PRICE PER SQUARE YARD FOR CONCRETE UNIT PAVERS.
2. ADDITIONAL CONCRETE THICKNESS IN TRANSITION TO CROSSWALK AND 175 mm CONCRETE PAVEMENT SHALL BE SUBSIDIARY TO THE BID PRICE FOR 225 mm CONCRETE PAVEMENT (AE)(REINFORCED).
3. SAND BEDDING SHALL MEET THE SPECIFICATION REQUIREMENTS FOR FINE AGGREGATE. AN UNCOMPACTED SAND LAYING COURSE SHALL BE SPREAD EVENLY OVER THE AREA TO BE PAVED AND THEN SCREDED TO A LEVEL OF APPROXIMATELY 20 mm THICKNESS. ONCE SCREDED AND LEVELED TO THE DESIRED ELEVATION, THE SAND LAYING COURSE SHALL NOT BE DISTURBED IN ANY WAY.
4. PAVERS SHALL BE PLACED WITH THE CHAMFERED SIDE UP, AND JOINT SPACES KEPT UNIFORM APPROXIMATELY 3 mm INCH THICK. THE GAPS AT THE EDGE OF THE PAVED SURFACE SHALL BE FILLED WITH PAVERS CUT TO FIT. CUTTING SHALL BE ACCOMPLISHED TO LEAVE A CLEAN EDGE TOWARD THE TRAFFIC SURFACE, USING A MASONRY SAW. WHENEVER POSSIBLE, NO CUTS SHOULD RESULT WITH A PAVER LESS THAN ONE-THIRD OF ITS ORIGINAL DIMENSION.
5. UNIT PAVERS SHALL BE VIBRATED TO THEIR FINAL LEVEL IN THE SAND LAYING COURSE BY TWO OR THREE PASSES OF VIBRATING COMPACTOR CAPABLE OF 1360 TO 2270 kg COMPACTION FORCE WITH THE SURFACE CLEAN AND JOINTS OPEN.
6. AFTER VIBRATION, CLEAN CONCRETE SAND SHALL BE SPREAD OVER THE PAVER SURFACE, ALLOWED TO DRY, AND VIBRATED INTO THE JOINTS WITH ADDITIONAL PASSES OF THE PLATE VIBRATOR SO AS TO COMPLETELY FILL THE JOINTS. A LIGHT COATING OF SAND SHALL BE SWEEPED OVER THE COMPLETED SURFACE AND LEFT TO WEATHER IN.

SCALE: 1:200

CROSSWALK DETAILS

LEGEND

○	TRAFFIC SIGNAL POLE
□	SERVICE BOX
LJ	LONGITUDINAL JOINT
CJ	CONTRACTION JOINT

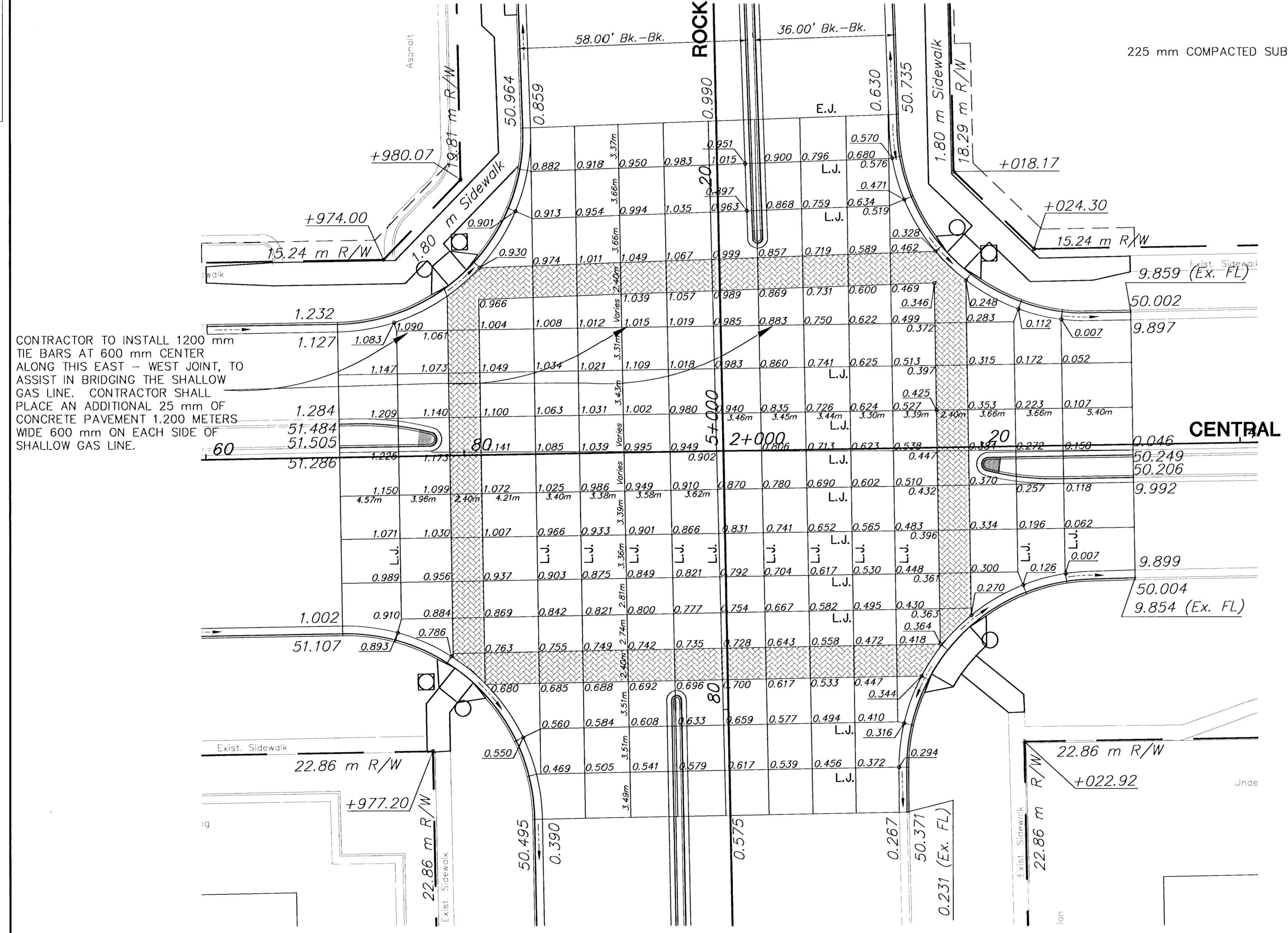

CONTRACTOR TO INSTALL 1200 mm TIE BARS AT 600 mm CENTER ALONG THIS EAST - WEST JOINT, TO ASSIST IN BRIDGING THE SHALLOW GAS LINE. CONTRACTOR SHALL PLACE AN ADDITIONAL 25 mm OF CONCRETE PAVEMENT 1.200 METERS WIDE 600 mm ON EACH SIDE OF SHALLOW GAS LINE.

NO.	DATE	REVISIONS	BY	APP'D
2				
1				

KANSAS DEPARTMENT OF TRANSPORTATION
CENTRAL & ROCK INTERSECTION
CENTRAL & ROCK INTERSECTION PLAN
 PROJ. NO. 87 N-0196-01 SEDGWICK CO.
MKEC ENGINEERING CONSULTANTS, INC.
 WICHITA, KANSAS

DESIGNED BY: DCH	CHECKED BY: DCH
DRAWN BY: DAG	DATE: FEB. 2001 SHEET 12 OF 55