

FHWA REG NO.	STATE	PROJECT NO.	YEAR	SHEET NO.	TOTAL SHEETS
7	KANSAS	87 N-0196-01	2001	30	55

GENERAL NOTES

- Conduit shall be jacked or bored if not installed before placing of new pavement.
- Placement of Service/Junction Boxes, Conduit Runs and Controller are typical and may be adjusted as directed by the Engineer to facilitate installation.
- The Contractor shall contact utility companies which may be affected by the installation of Traffic Signalization prior to any construction.
- KGE Power Pole Baseline Sta. 4+982.0, 46m Lt. Install Meter and Power Disconnect. See Power Pole Details.
- Exact Video Detection Camera locations to be at the direction of the Manufacturer's Representative. Video Camera cable terminations, camera fine tuning, system set-up and programming will be performed by the supplier with the assistance of the contractor.
- The Contractor shall install and operate a Temporary Traffic Signal at the Central and Rock Road intersection (See Detail Sheet). The Contractor shall prepare plans for traffic signals in consultation with the Traffic Engineer and in conformance with the Contractor's Traffic Control Plan. Notify City of Wichita Traffic Maintenance 7 days prior to signal turn-on.
- Install 50mm RGC for future Communication Cable to Sta. 4+763 (S) and Sta. 5+491 (N). Install Junction Box per standard detail at 50m maximum intervals. Alignment and location shall be approved by the Engineer. Payment shall be Subsidiary to Traffic Signal Installation.
- See Signal Pole Details for additional Traffic Signal Structures requirement.
- Salvageable Equipment (Controller, Cabinet, Poles, Lids, etc.) shall be removed and stockpiled. Notify signal supervisor (268-4033) within 24 hours after removal.
- Install 50mm PVC Conduit with pull wire. Payment shall be subsidiary to Traffic Signalization. See additional notes on Signal Summary Sheet.

DATE	
BY	
REFERENCES NOTED	
REFERENCES CHECKED	

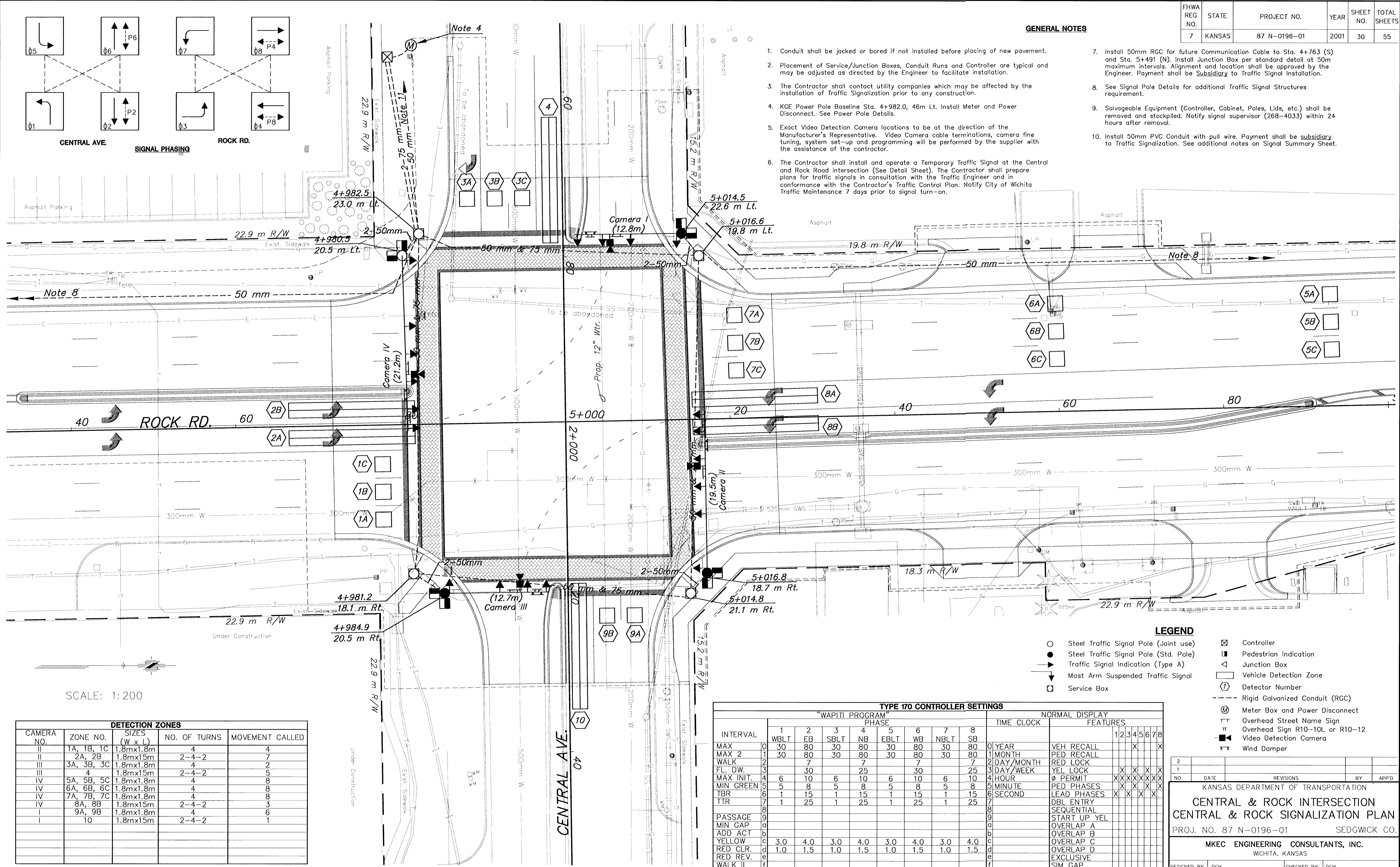

SCALE: 1:200

DETECTION ZONES				
CAMERA NO.	ZONE NO.	SIZES (W x L)	NO. OF TURNS	MOVEMENT CALLED
II	1A, 1B, 1C	1.8mx1.8m	4	4
	2A, 2B	1.8mx1.5m	2-4-2	7
III	3A, 3B, 3C	1.8mx1.8m	4	2
	4	1.8mx1.5m	2-4-2	5
IV	5A, 5B, 5C	1.8mx1.8m	4	8
	6A, 6B, 6C	1.8mx1.8m	4	8
IV	7A, 7B, 7C	1.8mx1.8m	4	8
	8A, 8B	1.8mx1.5m	2-4-2	5
I	9A, 9B	1.8mx1.8m	4	6
	10	1.8mx1.5m	2-4-2	1

"WAPITI PROGRAM" PHASE									NORMAL DISPLAY FEATURES							
INTERVAL	1	2	3	4	5	6	7	8	TIME CLOCK							
	WBLT	EB	SBLT	NB	EBLT	WB	NBLT	SB	1	2	3	4	5	6	7	8
MAX	0	30	80	30	80	30	80	30	0	YEAR	VEH RECALL					
MAX 2	1	30	80	30	80	30	80	30	1	MONTH	PED RECALL					
WALK	2		7		7		7		2	DAY/MONTH	RED LOCK					
FL. DW.	3		30		25		30		3	DAY/WEEK	YEL LOCK	X	X	X	X	X
MAX INIT.	4	6	10	6	10	6	10	6	4	HOUR	Ø PERMIT	X	X	X	X	X
MIN GREEN	5	5	8	5	8	5	8	5	5	MINUTE	PED PHASES	X	X	X	X	X
TBR	6	1	15	1	15	1	15	1	6	SECOND	LEAD PHASES	X	X	X	X	X
TTR	7	1	25	1	25	1	25	1	7		DBL ENTRY					
PASSAGE	8								8		SEQUENTIAL					
MIN GAP	9								9		START UP YEL					
ADD ACT	a								a		OVERLAP A					
YELLOW	b	3.0	4.0	3.0	4.0	3.0	4.0	3.0	b		OVERLAP B					
RED CLR.	c	1.0	1.5	1.0	1.5	1.0	1.5	1.0	c		OVERLAP C					
RED REV.	d								d		OVERLAP D					
WALK II	e								e		EXCLUSIVE					
	f								f		SIM GAP					

LEGEND

- Steel Traffic Signal Pole (Joint use)
- Steel Traffic Signal Pole (Std. Pole)
- ◁ Traffic Signal Indication (Type A)
- ⬇ Mast Arm Suspended Traffic Signal
- Service Box
- ⊠ Controller
- ⊞ Pedestrian Indication
- ◁ Junction Box
- ▭ Vehicle Detection Zone
- Ⓢ Detector Number
- Rigid Galvanized Conduit (RGC)
- ⊞ Meter Box and Power Disconnect
- ⊞ Overhead Street Name Sign
- ⊞ Overhead Sign R10-10L or R10-12
- ⊞ Video Detection Camera
- ⊞ Wind Damper

DESIGNED BY: DCH CHECKED BY: DCH
 DRAWN BY: DAG DATE: FEB. 2001 SHEET 30 OF 55

KANSAS DEPARTMENT OF TRANSPORTATION
CENTRAL & ROCK INTERSECTION
CENTRAL & ROCK SIGNALIZATION PLAN
 PROJ. NO. 87 N-0196-01 SEDGWICK CO.
MKEC ENGINEERING CONSULTANTS, INC.
 WICHITA, KANSAS

H:\CIVIL\98166\METRIC\SIGNAL\98166SG1.DWG 10/24/2000 08:15:22 AM CST