

BENCHMARKS:
 Brass benchmark disc in top of curb, east of wheelchair ramp NE cor. of Funston and Lynnrae Elev. = 1343.69 NAVD88

Brass benchmark disc in top of curb, north of wheelchair ramp NW cor. of Funston and Herrington Elev. = 1344.71 NAVD88

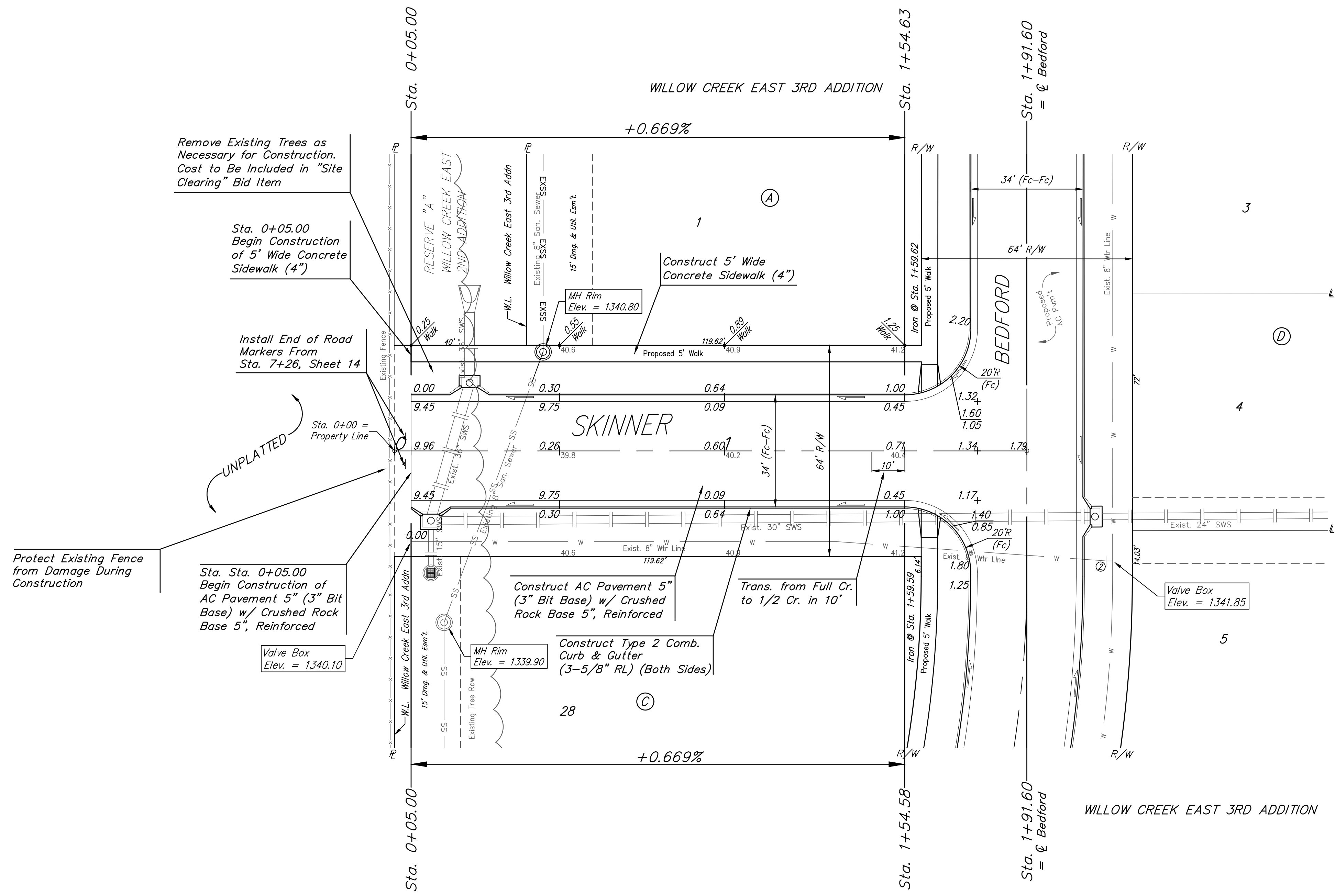
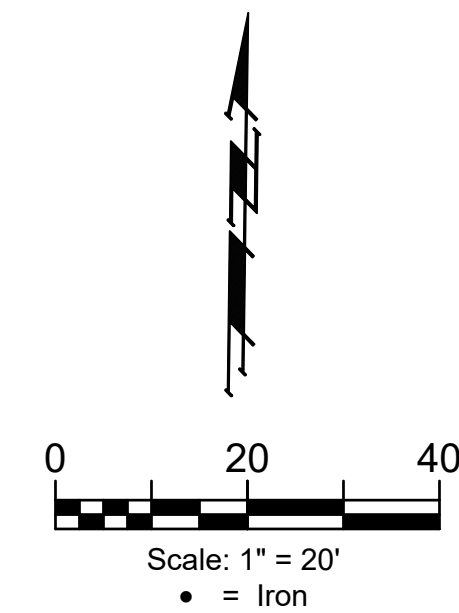

VALVE LOCATION TABLE

VALVE NUMBER	STREET	BASELINE STATION	OFFSET DISTANCE	OFFSET DIRECTION
1	Bedford	1+72.94	23.75'	Rt.
2	Bedford	5+11.48	24'	Rt.
3	Bedford	7+36.65	26'	Rt.
4	Mt. Vernon	2+70.20	28'	Lt.
5	Mt. Vernon	4+42.20	26'	Lt.
6	Stephanie	7+37.00	23'	Lt.

SUBDIVISION BENCHMARKS

Street & Station	Location Description	Elevation
Bedford 3+03.19, 17.25' Rt.	Adjacent to Fire Hydrant West of the NW Cor., Lot 8, Blk B, Willow Creek 3rd Addn.	
Bedford 6+64.65, 17.25' Rt.	Adjacent to Fire Hydrant West of the NW Cor., Lot 3, Blk B, Willow Creek 3rd Addn.	
Mt. Vernon 3+27.20, 17.25' Lt.	Adjacent to Fire Hydrant at the South End of the East Return Mt. Vernon & Stephanie, SW Cor., Lot 9, Blk E, Willow Creek 3rd Addn.	
Stephanie 3+50.00, 14.25' Lt.	Adjacent to Fire Hydrant East of the NE Cor., Lot 13, Blk D, Willow Creek 3rd Addn.	

Roll type curb & gutter to be constructed on the pavement on this sheet.
 Top of curb elevation are given for full height curb.



BAUGHMAN COMPANY

315 Ellis St.
 Wichita, KS 67211
 316-262-7271
 BaughmanCo.com

WILLOW CREEK EAST 3RD ADDITION - PHASE II

SKINNER

Sta. 0+05.00 to Sta. 1+54.63
 Street Paving Improvements

PROJECT NUMBER:
 472-85507

DESIGN: DMV DRAWN: JAK
 DATE: 6/21/21

SHEET **11** OF **27**

File: E:\Projects\Willow Creek East 3rd Addition_17-04-P283\Engineering\Phase 2\STR_20-10-E742\STR PLANS.dwg