

**BENCHMARKS:**  
 Brass benchmark disc in top of curb, east of wheelchair ramp  
 NE cor. of Funston and Lynnae  
 Elev. = 1343.69 NAVD88

Brass benchmark disc in top of curb, north of wheelchair ramp  
 NW cor. of Funston and Herrington  
 Elev. = 1344.71 NAVD88

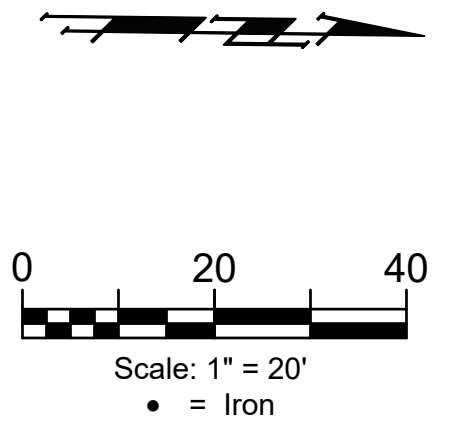

WILLOW CREEK EAST 3RD ADDITION

18

17

16

MOUNT VERNON

STEPHANIE

WILLOW CREEK EAST 3RD ADDITION

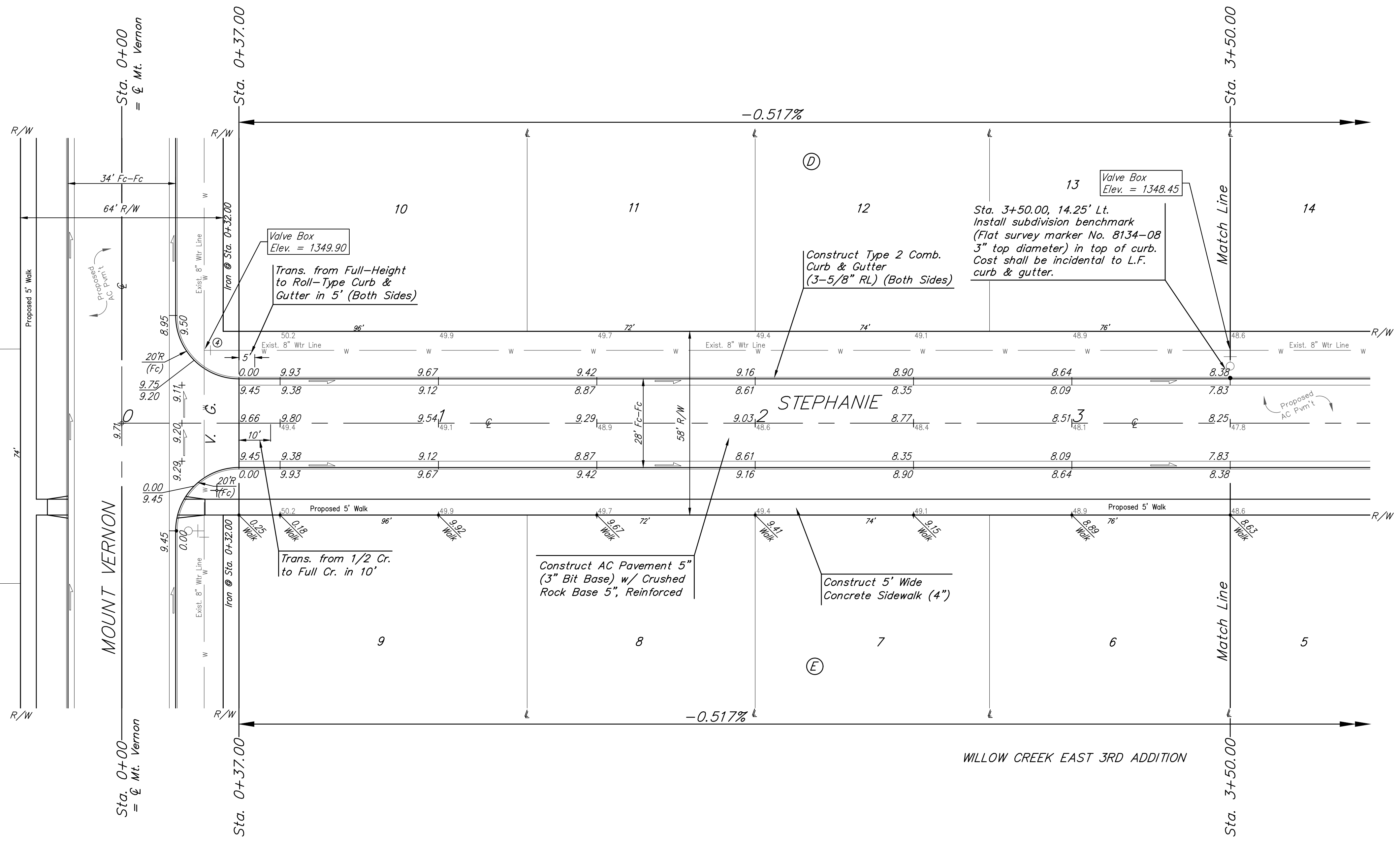

Roll type curb & gutter to be constructed on the pavement on this sheet.  
 Top of curb elevation are given for full height curb.



**BAUGHMAN COMPANY**

315 Ellis St.  
 Wichita, KS 67211  
 316-262-7271  
 BaughmanCo.com

---

WILLOW CREEK EAST 3RD ADDITION - PHASE II

---

**STEPHANIE**

---

Sta. 0+37.00 to Sta. 3+50.00  
 Street Paving Improvements

PROJECT NUMBER:  
 472-85507

DESIGN: DMV DRAWN: JAK  
 DATE: 6/21/21

SHEET 12 OF 27

File: E:\Projects\Willow Creek East 3rd Addition\_17-04-P283\Engineering\Phase 2\STR\_20-10-E742\STR PLANS.dwg