

BENCHMARKS:
 Brass benchmark disc in top of curb, east of wheelchair ramp
 NE cor. of Funston and Lynrae
 Elev. = 1343.69 NAVD88

Brass benchmark disc in top of curb, north of wheelchair ramp
 NW cor. of Funston and Herrington
 Elev. = 1344.71 NAVD88

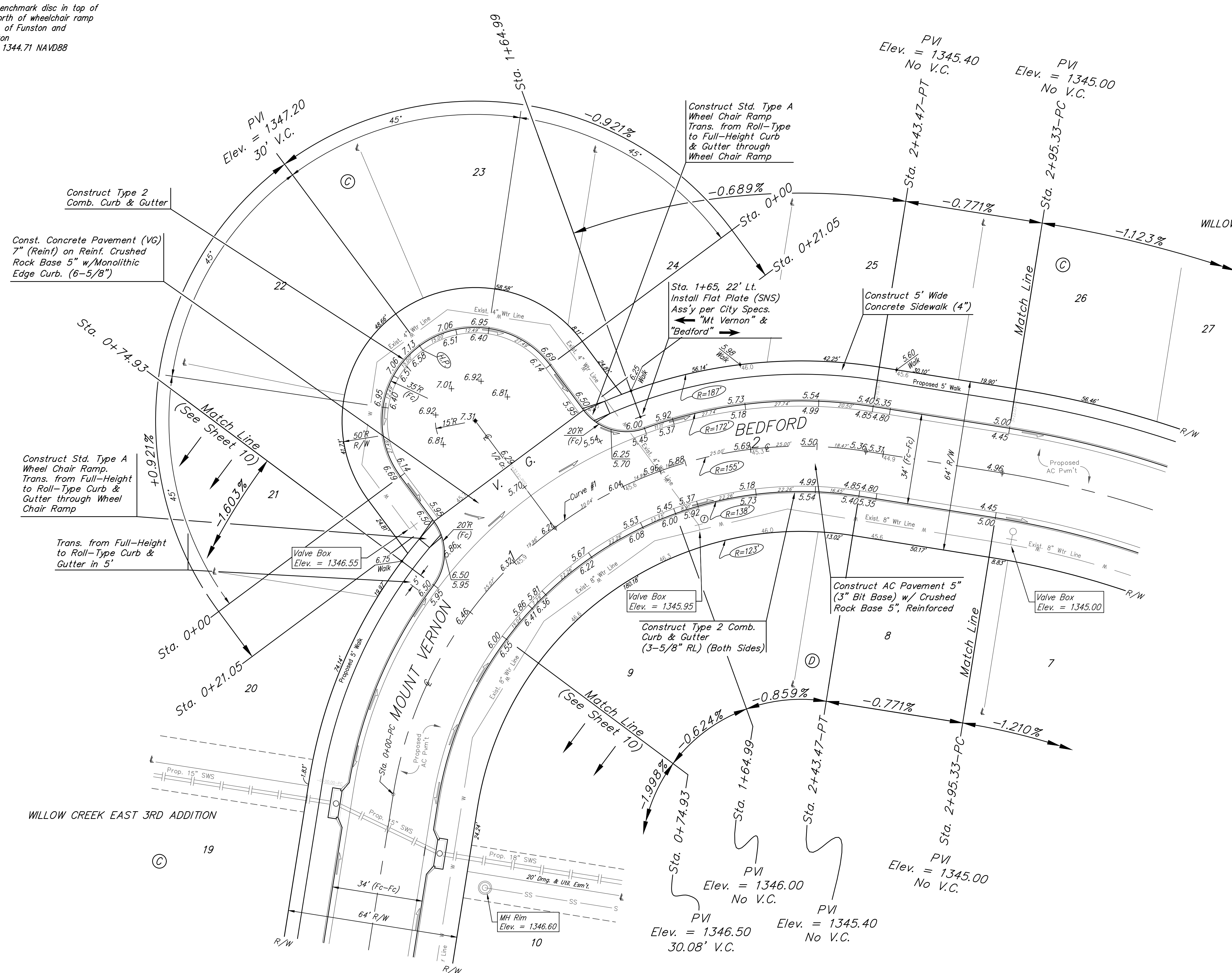
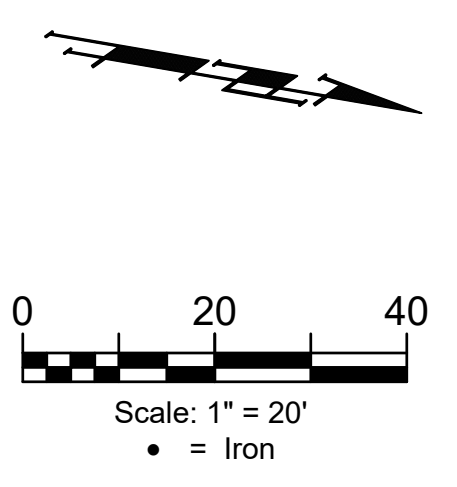

Curve #1
 Curve Data Based on Centerline
 Rad. = 155' Delta = 90°00'00" Tangent = 155.00'
 Arc = 243.47' L.C. = 219.20' Def./Ft. = 11.08966 Min.

| Station | Arc | Face Chord Lengths | | Defl. | Total Defl. |
|---------|--------|--------------------|----------|----------|-------------|
| | | 8' Left | 8' Right | | |
| 0+00.00 | - | - | - | 0°00'00" | 0°00'00" |
| 0+25.00 | 25.00' | 29.00' | 20.95' | 4°37'14" | 4°37'14" |
| 0+50.00 | 25.00' | 29.00' | 20.95' | 4°37'15" | 9°14'29" |
| 0+74.93 | 24.93' | 28.92' | 20.89' | 4°36'28" | 13°50'57" |
| 1+00.00 | 25.07' | 29.08' | 21.00' | 4°38'01" | 18°28'58" |
| 1+25.00 | 25.00' | 29.00' | 20.95' | 4°37'14" | 23°06'12" |
| 1+50.00 | 25.00' | 29.00' | 20.95' | 4°37'15" | 27°43'27" |
| 1+64.99 | 14.99' | 17.40' | 12.57' | 2°46'14" | 30°29'41" |
| 1+75.00 | 10.01' | 11.62' | 8.39' | 1°51'00" | 32°20'41" |
| 2+00.00 | 25.00' | 29.00' | 20.95' | 4°37'15" | 36°57'56" |
| 2+25.00 | 25.00' | 29.00' | 20.95' | 4°37'14" | 41°35'10" |
| 2+43.47 | 18.47' | 21.44' | 15.48' | 3°24'50" | 45°00'00" |

Roll type curb & gutter to be constructed on the pavement on this sheet.
 Top of curb elevation are given for full height curb.



BAUGHMAN COMPANY

315 Ellis St.
 Wichita, KS 67211
 316-262-7271
 BaughmanCo.com

WILLOW CREEK EAST 3RD ADDITION - PHASE II

BEDFORD

Sta. 0+74.93 to Sta. 2+95.33
 Street Paving Improvements

PROJECT NUMBER:
 472-85507

DESIGN: DMV DRAWN: JAK
 DATE: 6/21/21

SHEET **7** OF **27**

File: E:\Projects\Willow Creek East 3rd Addition_17-04-P283\Engineering\Phase 2\STR_20-10-E742\STR PLANS.dwg