

INDEX OF DRAWINGS

SHEET NO.	DESCRIPTION
1	Title Sheet
2	Site Plan and General Notes
3	Existing Plan and Profile
4	Concrete Pavement Approach Details and Quantities
5	Concrete Transition Rail Details
6	Expansion Joint Details
7	Bridge Quantities and General Notes
8	Demolition Plans
9	Hydrodemolition and Deck Patching Details
10	Abutment Rehabilitation Details
11	Abutment Strip Drain Details
12	Water Line Hanger Details
13	Bill of Reinforcing Steel and Bending Diagram
14	Guard Fence Plan
15-16	Guard Fence Details
17	Summary of Quantity Sheet
18	Pavement Marking
19-23	Traffic Control

37TH STREET BRIDGE OVER THE LITTLE ARKANSAS RIVER

PROJ. NO. 472-82736

CITY OF WICHITA, KANSAS
MICHAEL E. LINDEBAK, CITY ENGINEER

MAY 1998

BRIDGE INDEX NO. 715409
WATER LINE INDEX NO. 635078

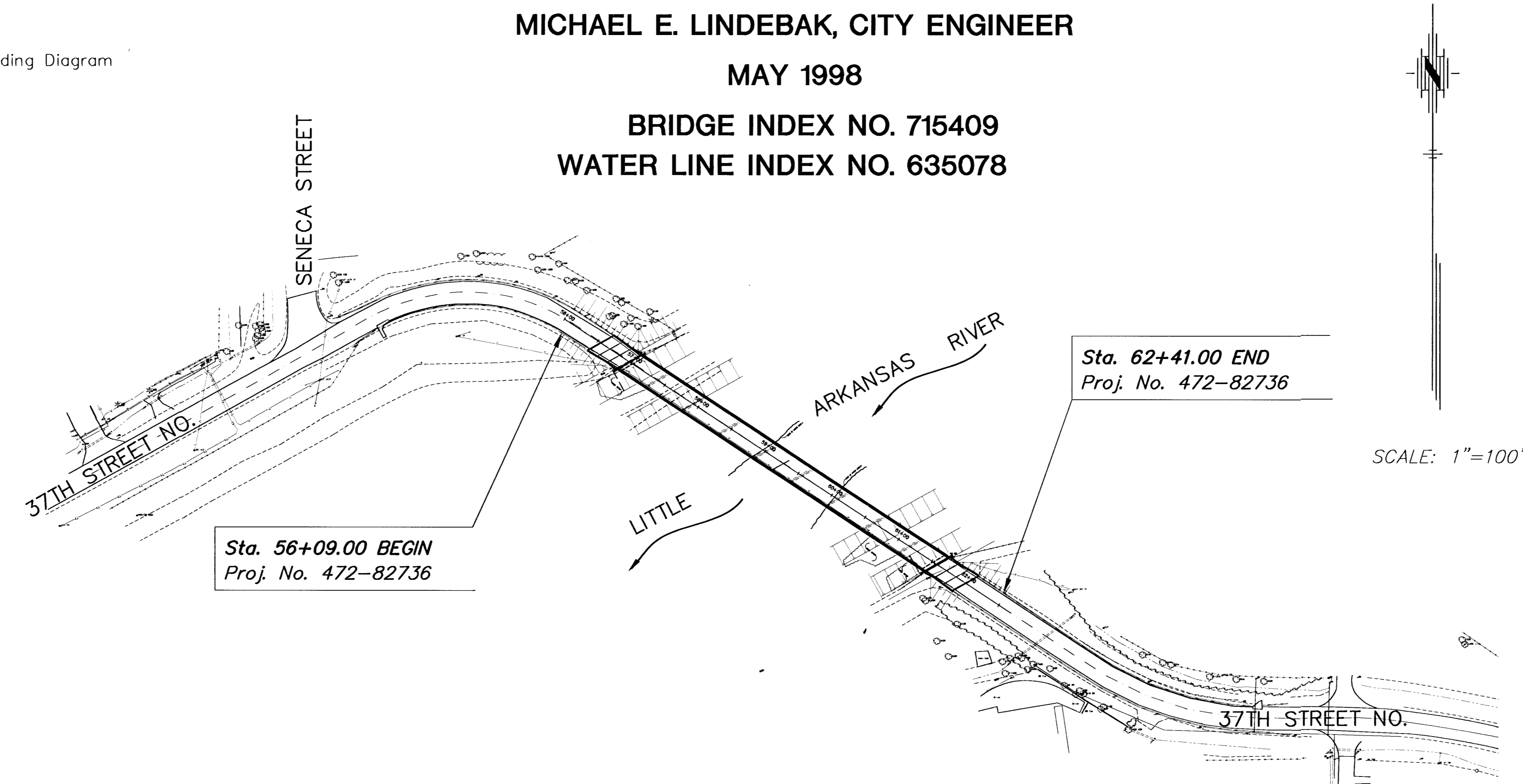

BENCH MARKS

- BM #1 C.O.W. Bench Mark, top concrete wing on southeast corner bridge over Big Ditch @ 37th St. N. and approx. Seneca St. Elev. 1332.14
- BM #2 Square cut on S.E. corner of S.W. wingwall at bridge over Big Ditch Elev. 1331.98
- BM #3 3-Nail spike at 2nd HLP west of Seneca and south of 37th St. No. Elev. 1318.69

DESIGN DESIGNATION

AADT (1998)	=	3,420
AADT (2018)	=	4,600
DHV	=	10
D	=	60%
T	=	12%
V	=	40 MPH
C OF A	=	NONE

CONVENTIONAL SIGNS

COUNTY LINE	_____	CENTER LINE OF PROJECT	_____
CITY LIMITS	_____	TERRACE	_____
STATE OR NATIONAL LINE	_____	CULVERTS	_____
TOWNSHIP, SECTION or GRANT LINE	_____	DROP INLET & STORM SEWER	_____
PROPERTY LINE	_____	ACCESS CONTROL	_____
HIGHWAY FENCE	_____	POWER POLE	_____
EXISTING FENCE	_____	TELEPHONE POLE	_____
GUARD FENCE	_____	MARSH	_____
CONSTRUCTION LIMITS	_____	HEDGE	_____
RIGHT OF WAY LINE	_____	TREES	_____
TRAVELED WAY	_____	PROFILE ELEVATION	_____
RAILROADS	_____	STREAM or CREEK	_____

GROSS LENGTH OF PROJECT	860.50	FT.	0.163	MILES
EXCEPTIONS	NONE			
ADDITIONS	NONE			
NET LENGTH OF PROJECT	860.50	FT.	0.163	MILES
NET LENGTH OF BRIDGES	794.50	FT.	0.150	MILES
NET LENGTH OF ROAD	66.00	FT.	0.0125	MILES

NOTE: PROJECT TO BE CLOSED TO TRAFFIC DURING CONSTRUCTION

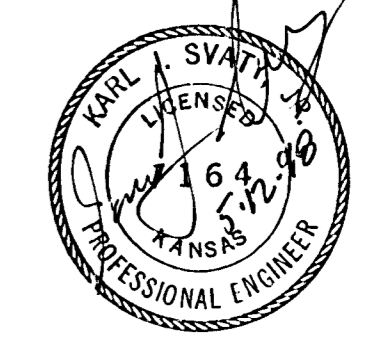
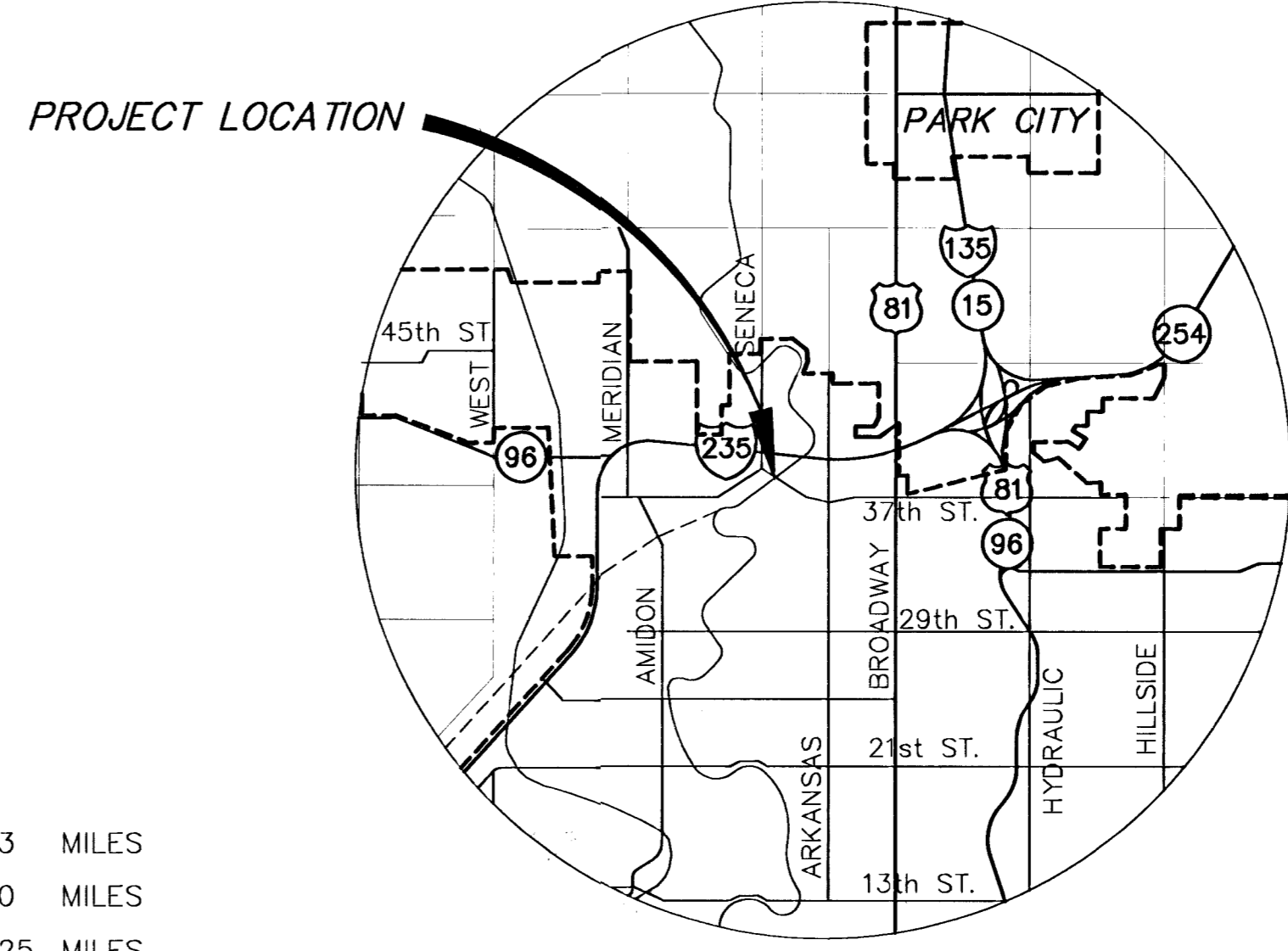

PREPARED AND SUBMITTED BY
MID-KANSAS ENGINEERING CONSULTANTS, INC.
WICHITA, KANSAS

RECOM. FOR APPROVAL-DATE _____

WICHITA CITY ENGINEER
MICHAEL E. LINDEBAK, P.E.