

**KELLOGG CROSSING ADDITION**  
 PHASE 2 - GILBERT  
 PAVING & INCIDENTAL DRAINAGE FOR

SUBDIVISION BENCH MARKS				
NO.	STREET AND STATION	FROM CL	DESCRIPTION	ELEVATIONS
1	GILBERT, STA. 31+40.36	17.5' LT	TOP OF CURB	

NOTE: CONTRACTOR SHALL INSTALL SUBDIVISION BENCH MARKS ("FLAT SURVEY MARKERS NO. 8134-08 3" TOP DIAMETER" PROVIDED BY KANSAS BLUE PRINT CO., INC.) COSTS TO BE CONSIDERED SUBSIDIARY TO CONSTRUCTION OF COMBINED CURB AND GUTTER.

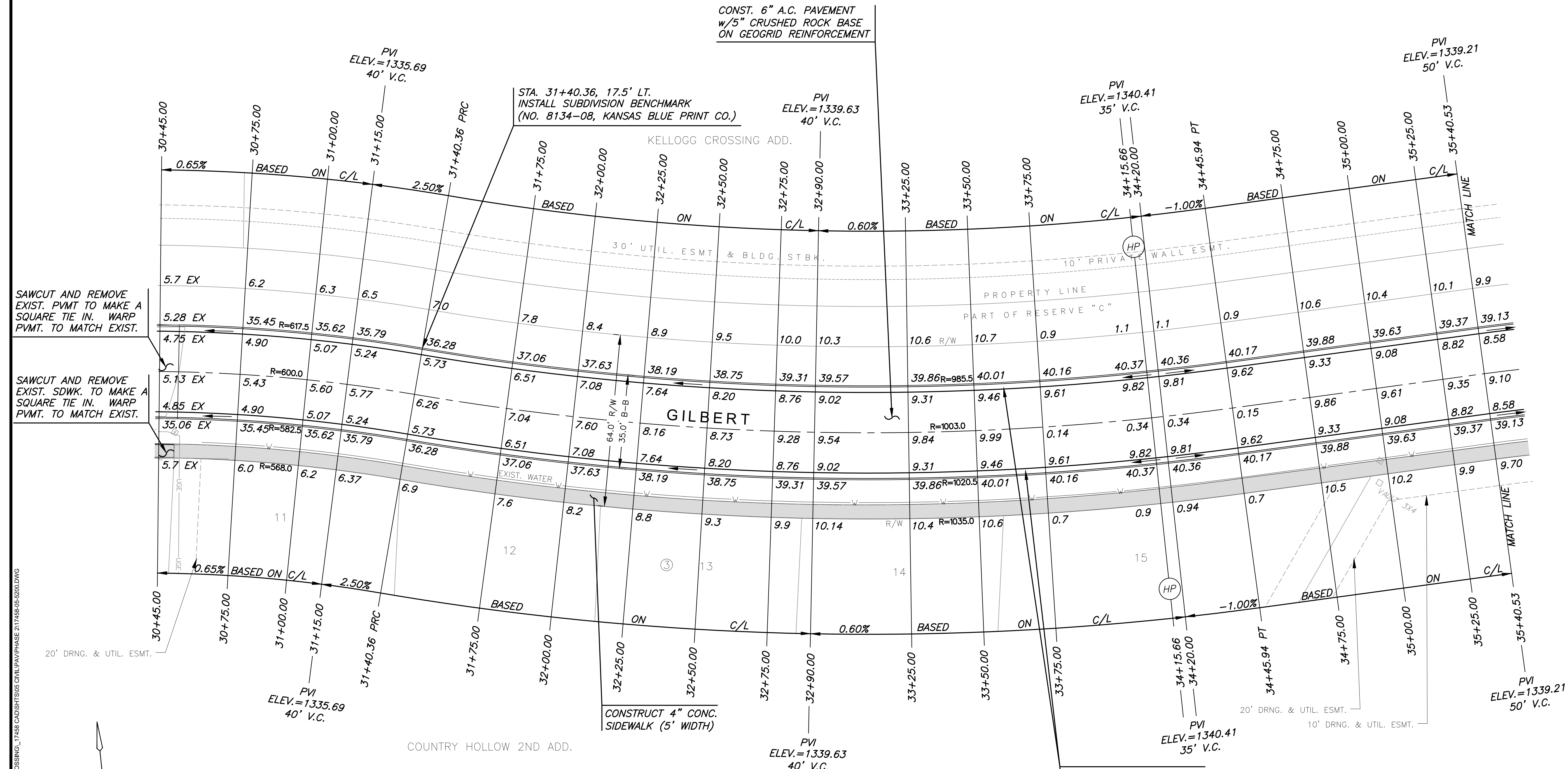

- NOTES:
- TOP OF CURB ELEVATIONS SHOWN ARE FOR FULL CURB. CONSTRUCT CURB AND GUTTER AS NOTED.
  - REMOVE TREES AS NEEDED FOR CONSTRUCTION.
  - ELECTRIC BOXES ARE IN CONFLICT W/ PROP. SIDEWALK. EVERY IS AWARE OF THE NEED TO RELOCATE AND INTENDS TO MOVE THEIR UTILITY ALONG WITH AT&T AND COX INTO A COMMON TRENCH WITHIN THE PLATTED 10' UTILITY ESMT. CONTRACTOR TO CONSTRUCT GILBERT AND THEN CALL EVERY, AT&T, AND COX TO RE-LOCATE ELECTRIC BOXES. AFTER ELECTRIC BOXES HAVE BEEN ADJUSTED, CONSTRUCT SIDEWALK AND INSTALL RESTORATION.

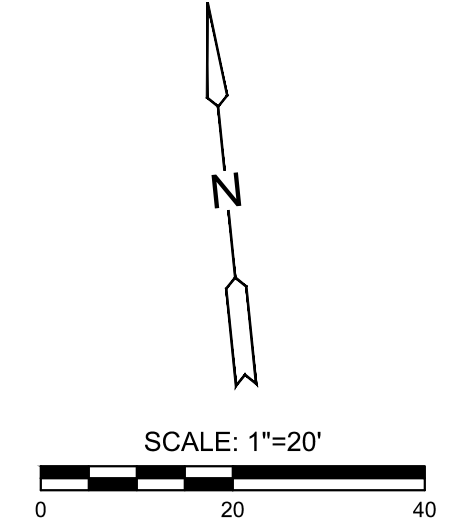

**LEGEND**

	STREET SIGN & SIGN LOCATION (SEE SIGN ASSEMBLY TABLE FOR TYPE & STATION OF SIGN)
	5' TRANSITION FROM FULL TO ROLL CURB

©2021  
MKEC Engineering  
All Rights Reserved  
www.mkec.com  
These drawings and their contents, including, but not limited to, all concepts, designs, & ideas are the exclusive property of MKEC Engineering (MKEC), and may not be used or reproduced in any way without the express consent of MKEC.

GILBERT		
PROJECT NO.	472-2019-085526	
DATE	JUNE 2021	
SCALE	1"=20'	
DESIGNED	CRM	
DRAWN	CRM	
CHECKED	DFL	
NO.	REVISION	DATE
SHEET NO. 04 OF 24		

J:\PROJECTS\2017\171010485\_KELLOGG CROSSING\_17485\_CAD\SITE\505\_CIVIL\PAVPHASE 2\17485-05-2020.DWG  
 PLOTTED: Thursday, June 17, 2021 @ 04:36PM