

**ADD ALTERNATE #2**

REMOVE & REPLACE THE NET TIE DOWN.  
 REMOVE & REPLACE THE NET POSTS.  
 MILL, PATCH & PAINT THE CENTER CRACK.  
 CLEAN, CRACK SEAL THE EDGES & PAINT.

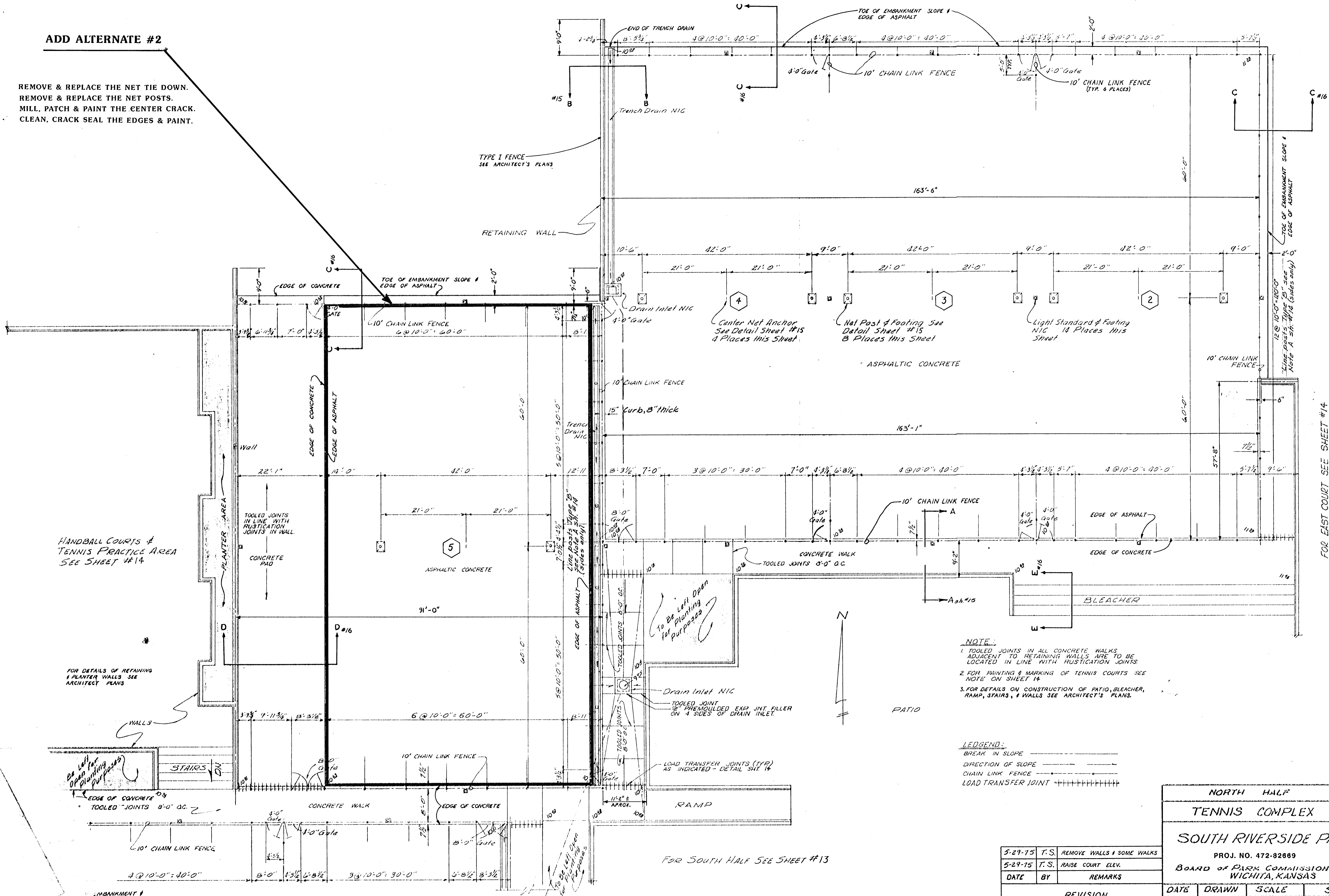

HANDBALL COURTS &  
 TENNIS PRACTICE AREA  
 SEE SHEET #14

FOR DETAILS OF RETAINING  
 & PLANTER WALLS SEE  
 ARCHITECT PLANS

Be Left Open  
 for Planting  
 Purposes

To Be Left Open  
 for Planting  
 Purposes

FOR SOUTH HALF SEE SHEET #13

- NOTE:**
- TOOLED JOINTS IN ALL CONCRETE WALKS ADJACENT TO RETAINING WALLS ARE TO BE LOCATED IN LINE WITH RUSTICATION JOINTS.
  - FOR PAINTING & MARKING OF TENNIS COURTS SEE NOTE ON SHEET 14
  - FOR DETAILS ON CONSTRUCTION OF PATIO, BLEACHER, RAMP, STAIRS, & WALLS SEE ARCHITECT'S PLANS.

- LEGEND:**
- BREAK IN SLOPE
  - DIRECTION OF SLOPE
  - CHAIN LINK FENCE
  - LOAD TRANSFER JOINT

DATE	BY	REMARKS
5-29-75	T.S.	REMOVE WALLS & SOME WALKS
5-29-75	T.S.	RAISE COURT ELEV.

DATE	DRAWN	SCALE	SHEET
2-28-75	TRF/DJ	1"=10'-0"	4 of 6

NORTH HALF  
 TENNIS COMPLEX  
 SOUTH RIVERSIDE PARK  
 PROJ. NO. 472-82889  
 BOARD OF PARK COMMISSIONERS  
 WICHITA, KANSAS

FOR EAST COURT SEE SHEET #14