

FHWA REGION NO.	STATE	PROJECT NUMBER	FISCAL YEAR	SHEET NUMBER	TOTAL SHEETS
7	KANSAS	87N-0127-01	1999	7	90

BY	DATE

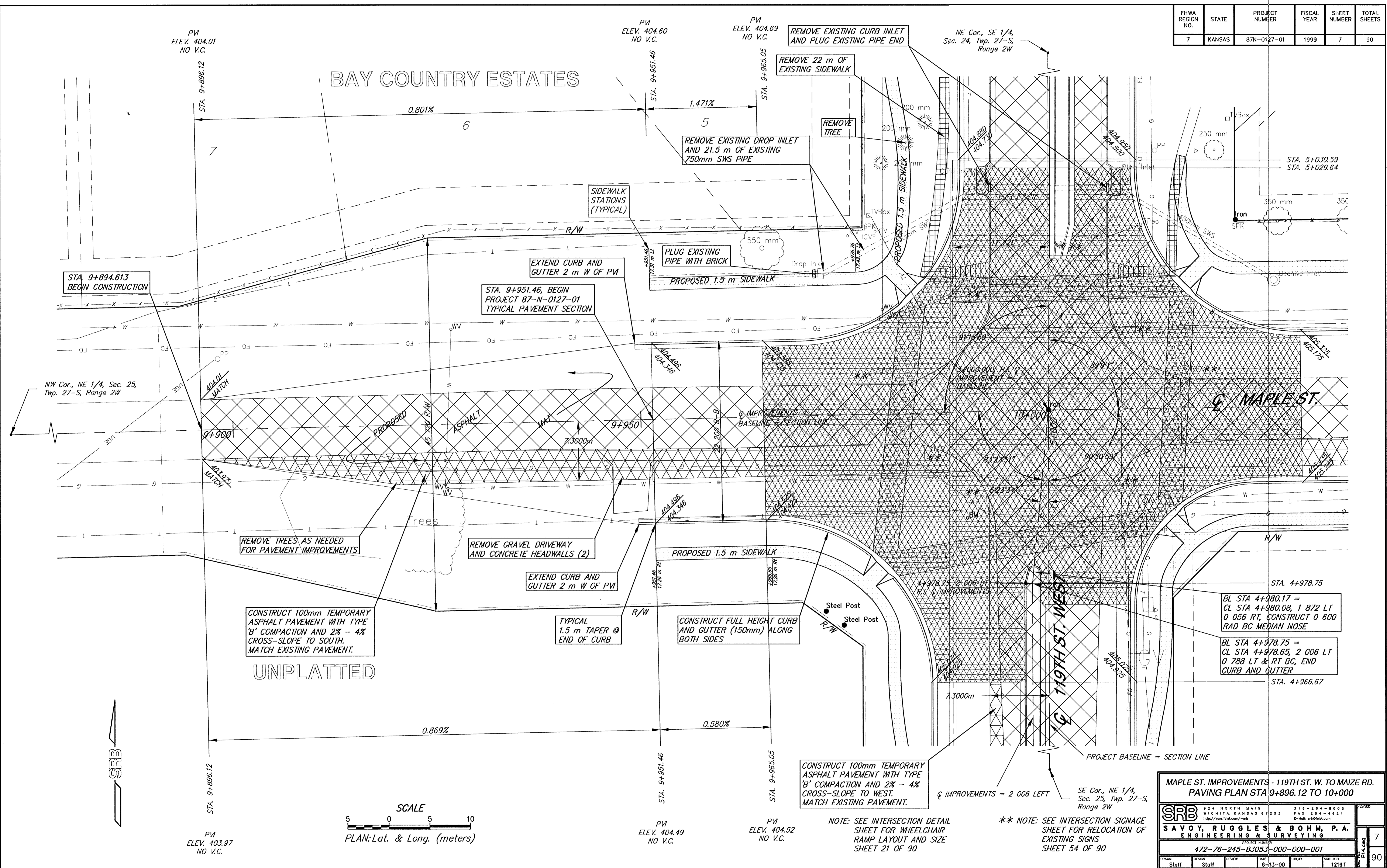

NW Cor., NE 1/4, Sec. 25, Twp. 27-S, Range 2W

NE Cor., SE 1/4, Sec. 24, Twp. 27-S, Range 2W

MAPLE ST.

119TH ST. WEST

UNPLATTED

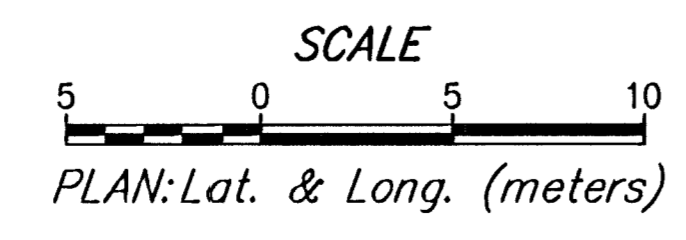

BL STA 4+980.17 =
CL STA 4+980.08, 1 872 LT
0 056 RT, CONSTRUCT 0 600
RAD BC MEDIAN NOSE

BL STA 4+978.75 =
CL STA 4+978.65, 2 006 LT
0 788 LT & RT BC, END
CURB AND GUTTER

CONSTRUCT 100mm TEMPORARY ASPHALT PAVEMENT WITH TYPE 'B' COMPACTION AND 2% - 4% CROSS-SLOPE TO WEST. MATCH EXISTING PAVEMENT.

** NOTE: SEE INTERSECTION SIGNAGE SHEET FOR RELOCATION OF EXISTING SIGNS SHEET 54 OF 90

NOTE: SEE INTERSECTION DETAIL SHEET FOR WHEELCHAIR RAMP LAYOUT AND SIZE SHEET 21 OF 90

MAPLE ST. IMPROVEMENTS - 119TH ST. W. TO MAIZE RD.
PAVING PLAN STA 9+896.12 TO 10+000

SRB		924 NORTH MAIN WICHITA, KANSAS 67203 http://www.srb.com/~srw	316-264-8008 FAX 264-4621 E-Mail: sr@srb.com
SAVOY, RUGGLES & BOHM, P.A. ENGINEERING & SURVEYING			
PROJECT NUMBER 472-78-245-83053-000-000-001			
DRAWN Staff	DESIGN Staff	REVIEW DATE 8-13-00	UTILITY SRB JOB 1218T