

FHWA REGION NO.	STATE	PROJECT NUMBER	FISCAL YEAR	SHEET NUMBER	TOTAL SHEETS
7	KANSAS	87N-0127-01	1999	9	90

BY	DATE

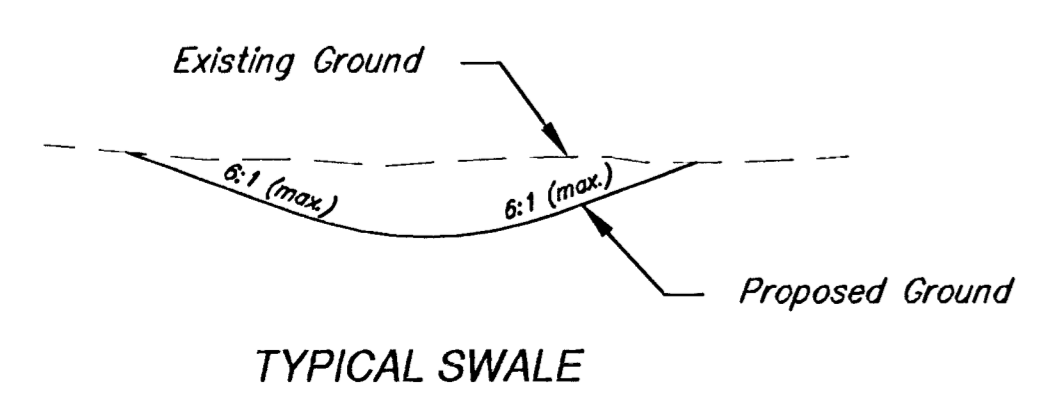
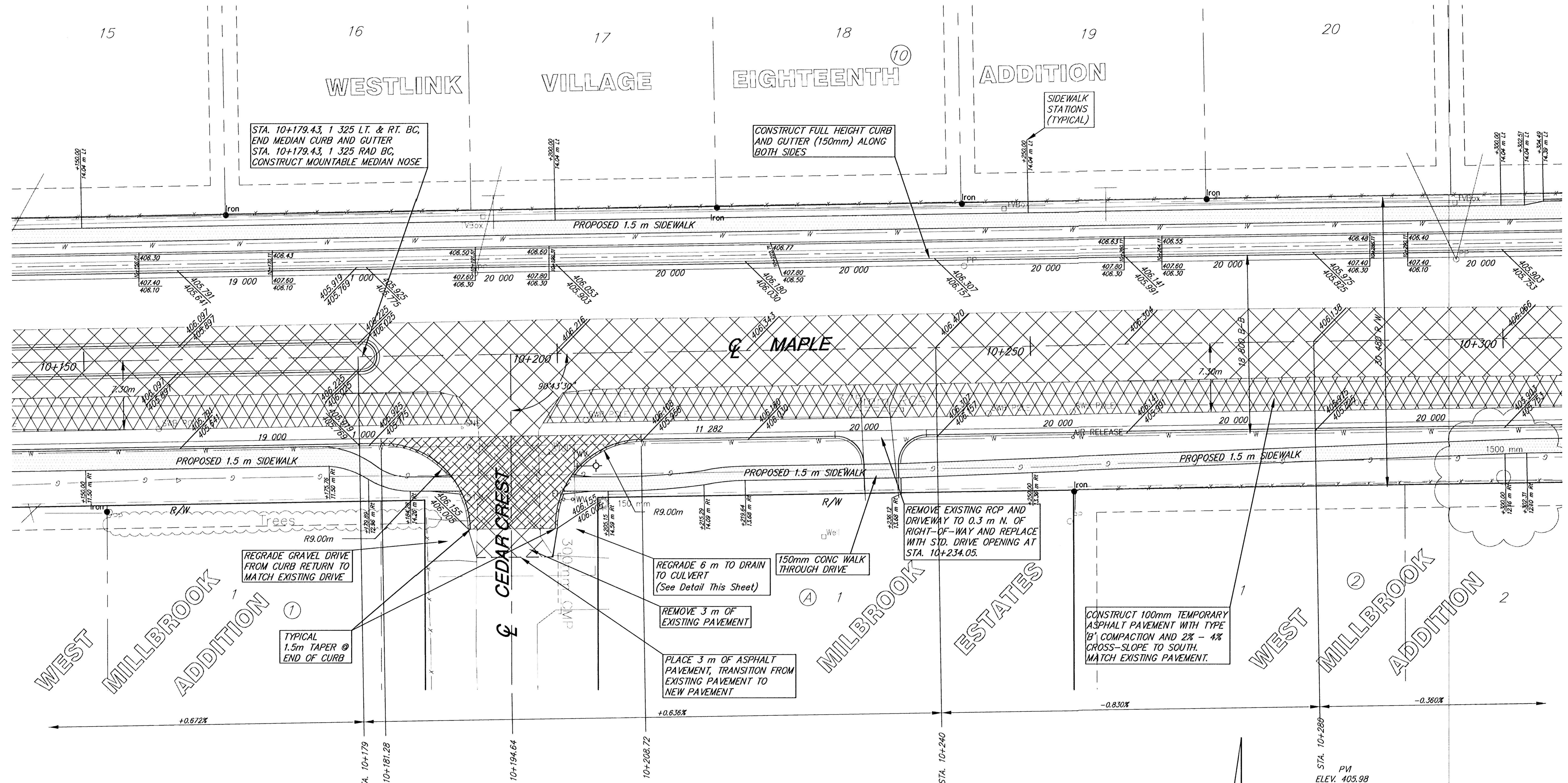

STA. 10+179.43, 1 325 LT. & RT. BC, END MEDIAN CURB AND GUTTER
 STA. 10+179.43, 1 325 RAD BC, CONSTRUCT MOUNTABLE MEDIAN NOSE

CONSTRUCT FULL HEIGHT CURB AND GUTTER (150mm) ALONG BOTH SIDES

SIDEWALK STATIONS (TYPICAL)

REGRADE GRAVEL DRIVE FROM CURB RETURN TO MATCH EXISTING DRIVE

REGRADE 6 m TO DRAIN TO CULVERT (See Detail This Sheet)

REMOVE EXISTING RCP AND DRIVEWAY TO 0.3 m N. OF RIGHT-OF-WAY AND REPLACE WITH STD. DRIVE OPENING AT STA. 10+234.05.

CONSTRUCT 100mm TEMPORARY ASPHALT PAVEMENT WITH TYPE 'B' COMPACTION AND 2% - 4% CROSS-SLOPE TO SOUTH. MATCH EXISTING PAVEMENT.

TYPICAL 1.5m TAPER @ END OF CURB

PLACE 3 m OF ASPHALT PAVEMENT, TRANSITION FROM EXISTING PAVEMENT TO NEW PAVEMENT

RETAINING WALL ELEVATIONS

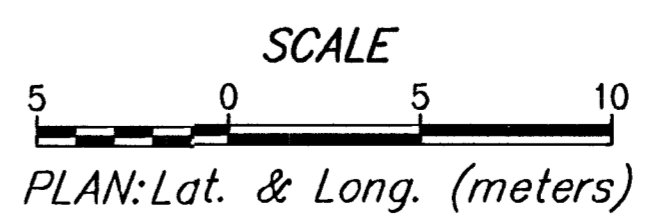
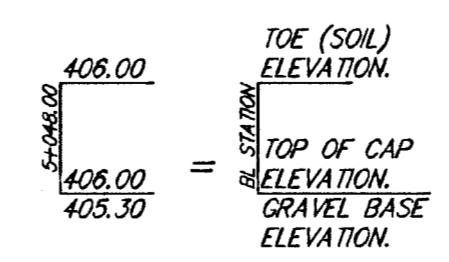

MAPLE ST. IMPROVEMENTS - 119TH ST. W. TO MAIZE RD. PAVING PLANS STA 10+150 TO 10+300

SRB 924 NORTH MAIN WICHITA, KANSAS 67203
 316-264-8006 FAX 264-4621
 http://www.srb.com E-Mail: srb@srbc.com

SAVOY, RUGGLES & BOHM, P. A.
 ENGINEERING & SURVEYING

PROJECT NUMBER: 472-76-245-83053-000-000-001

DESIGN	REVIEW	DATE	UTILITY	SRB JOB
Staff	Staff	8-3-00		1216T