

PHASE DIAGRAM

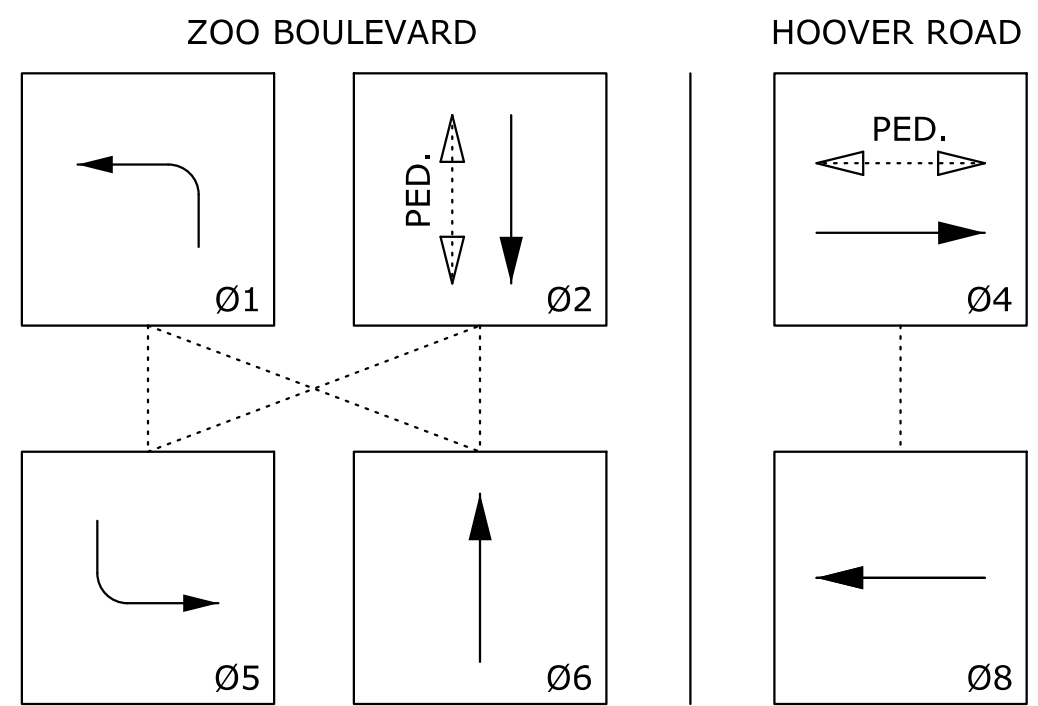

NOTE: DOTTED LINES CONNECTING PHASES INDICATE PHASES THAT CAN OCCUR CONCURRENTLY. PEDESTRIAN PHASE TO ONLY OCCUR AFTER PUSH BUTTON ACTIVATION. FOR RAILROAD PREEMPTION, SEE SHEET 20

SIGNAL FACES

NOTE: ALL LENSES SHALL BE 12" L.E.D. PEDESTRIAN LENSES SHALL BE 16" AND BE COUNTDOWN SIGNALS.

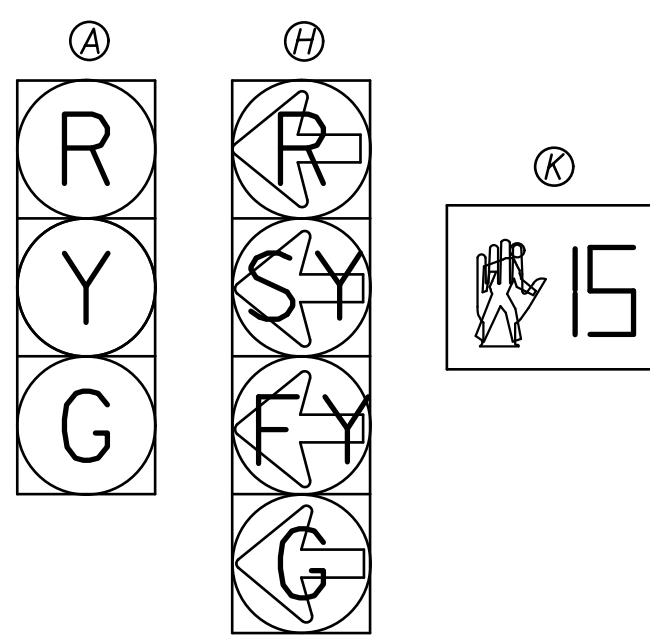

BLANK OUT SIGN

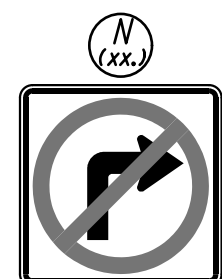

BLANK OUT SIGN (36"X36") ARROW MAY BE ORIENTED LEFT OR RIGHT DEPENDING ON LOCATION

LEGEND

- LUMINAIRE
- TRAFFIC SIGNAL POLE
- TRAFFIC SIGNAL PEDESTAL
- TRAFFIC SIGNAL HEAD W/TYPE DESIGNATION
- TRAFFIC SIGNAL HEAD W/TYPE DESIGNATION & BACKPLATE
- PEDESTRIAN SIGNAL & PUSHBUTTON
- PAD MOUNTED CONTROLLER
- SERVICE BOX
- SECONDARY SERVICE POINT
- PEDESTRIAN PUSH BUTTON
- DETECTION ZONE
- 3" CONDUIT
- 2" CONDUIT
- 1 1/2" CONDUIT
- SIGN ON 1 POST
- SIGN ON 2 POSTS
- RADAR DETECTION (ADVANCE OR STOP BAR)
- DETECTOR NUMBER
- POLE/PEDESTAL NUMBER
- SERVICE BOX NUMBER

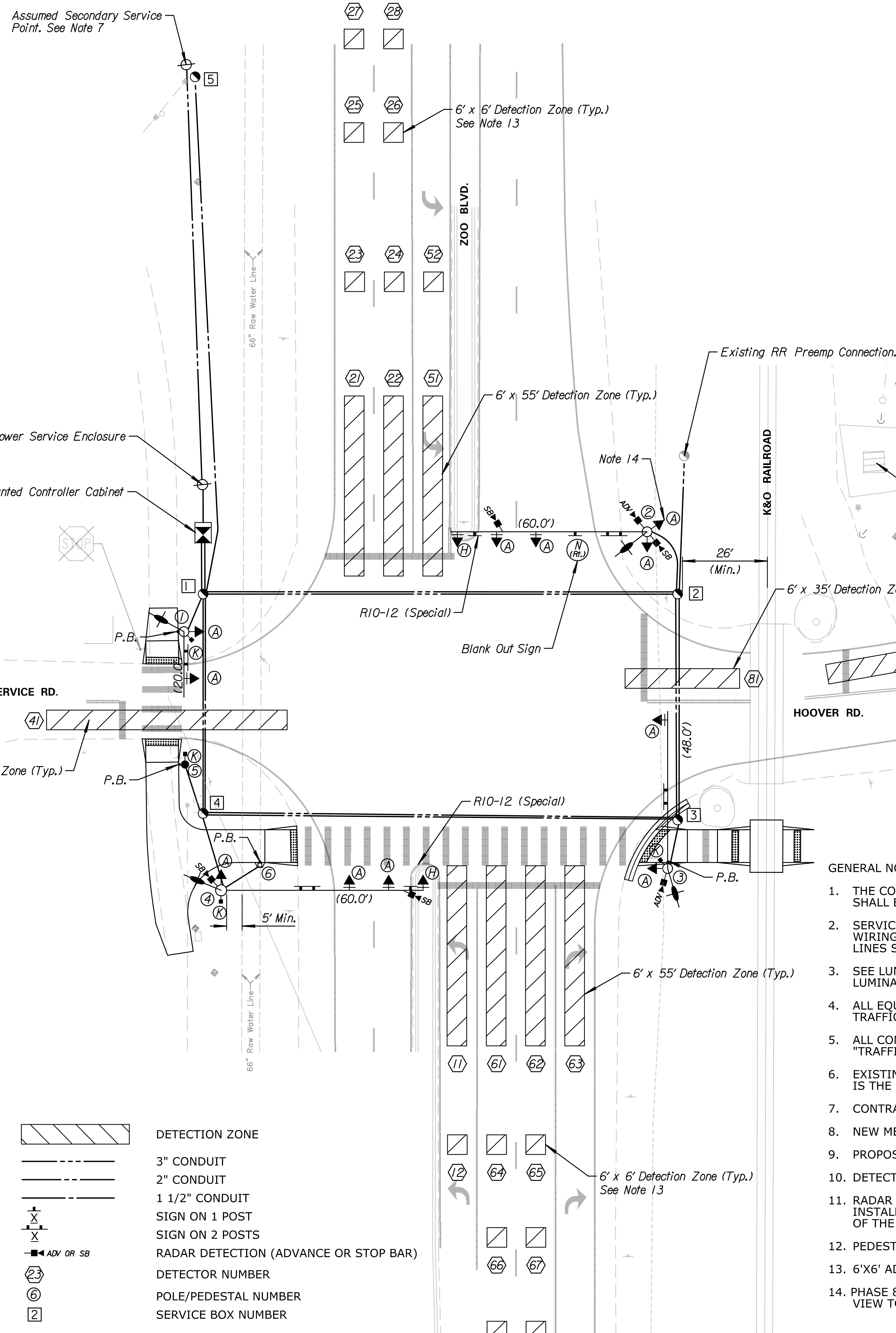

POLE, PEDESTAL & CONTROLLER LOCATIONS				
POLE NO.	STATION	OFFSET	NORTHING	EASTING
1	100+09.15	70.50 LT	1,698,120.23	1,628,266.29
2	101+50.64	101.02 LT	1,698,235.45	1,628,353.90
3	101+56.93	1.82 RT	1,698,161.44	1,628,425.58
4	100+20.50	8.50 RT	1,698,067.62	1,628,326.30
5	100+09.46	29.93 LT	1,698,089.62	1,628,292.91
6	100+51.48	3.29 RT	1,698,091.73	1,628,346.44
Meter	100+14.79	115.41 LT	1,698,158.01	1,628,241.36
Cont.	100+15.00	100.00 LT	1,698,146.44	1,628,251.55

SERVICE BOX LOCATIONS				
BOX NO.	STATION	OFFSET	NORTHING	EASTING
1	100+15.00	82.00 LT	1,698,132.77	1,628,263.25
2	101+60.00	82.00 LT	1,698,227.10	1,628,373.38
3	101+60.00	13.00 LT	1,698,174.69	1,628,418.27
4	100+15.00	15.00 LT	1,698,081.89	1,628,306.84
5	100+12.57	239.96 LT	1,698,251.17	1,628,158.65

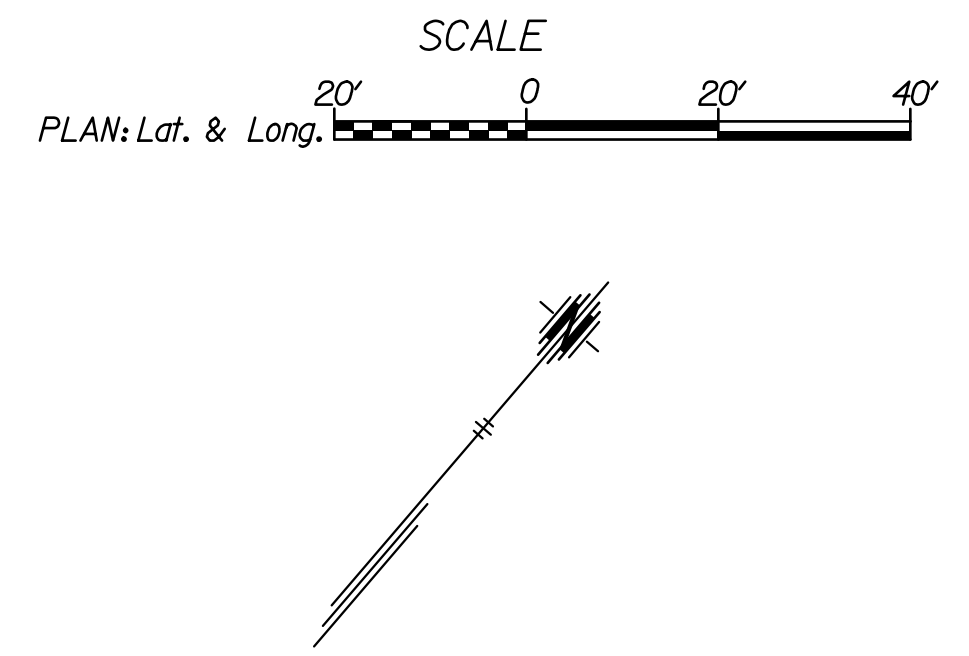

LUMINAIRE MOUNTING DIAGRAM

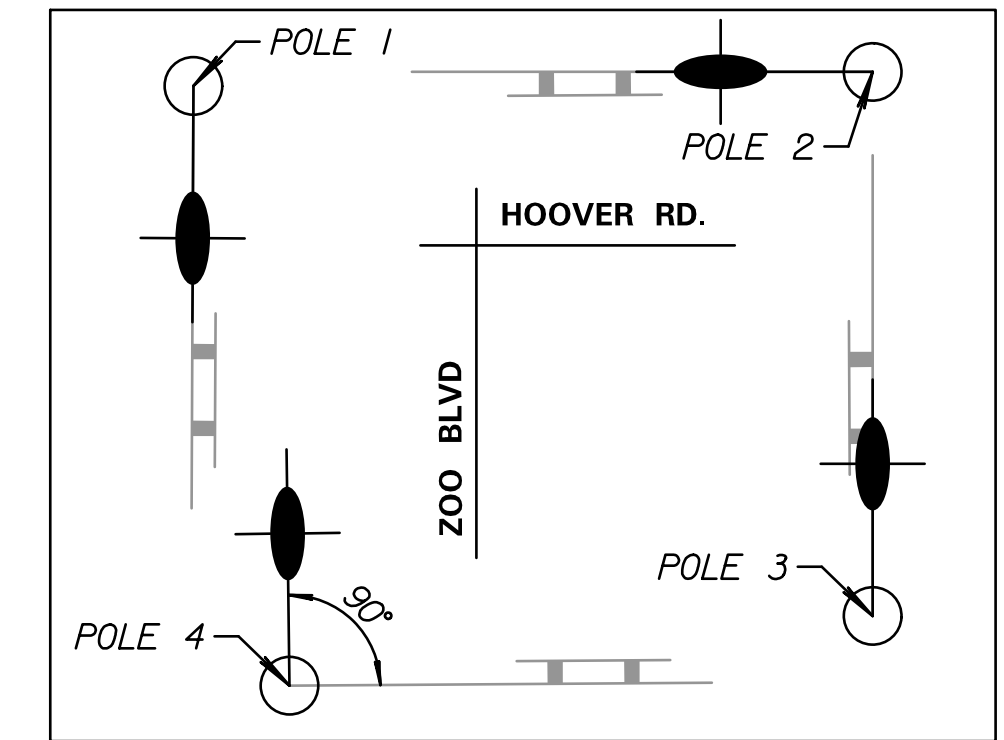

- POLE 4 LUMINAIRE ARM SHALL BE 90° TO MAST ARM & ORIENTED OVER PATH.
- ALL OTHER LUMINAIRES SHALL BE MOUNTED OVER THE MAST ARMS

- GENERAL NOTES:
- THE CONTRACTOR SHALL STAKE LOCATIONS WHERE POLES, BOXES, AND THE CONTROLLER ARE TO BE INSTALLED. STAKED LOCATIONS SHALL BE REVIEWED AND APPROVED BY THE ENGINEER PRIOR TO CONTRACTOR STRUCTURE PLACEMENT.
 - SERVICE BOXES AND CONDUIT RUNS ARE APPROXIMATE AND MAY BE FIELD ADJUSTED TO CLEAR OBSTRUCTIONS AND FACILITATE WIRING, AS APPROVED BY THE ENGINEER. ALL CONDUIT RUNS SHALL BE STRAIGHT BETWEEN BOXES AND/OR FOUNDATIONS. CURVED LINES SHOWN ON PLAN FOR CLARITY ONLY.
 - SEE LUMINAIRE MOUNTING DIAGRAM (THIS SHEET). OTHERS (EVERGY) WILL MOUNT THE LUMINAIRES. CONTRACTOR SHALL INSTALL LUMINAIRE ARMS AND WIRING AS SHOWN IN THE WIRING DIAGRAM.
 - ALL EQUIPMENT SHALL BE NEW UNLESS SHOWN OTHERWISE ON THE PLANS. SIGNAL HEADS OR TRAFFIC SIGNS THAT CONFLICT WITH THE TRAFFIC CONTROL, SHALL BE COVERED OR REMOVED.
 - ALL CONDUIT SHALL BE BORED UNDER EXISTING PAVEMENT AND SIDEWALK. THIS WORK SHALL BE SUBSIDIARY TO THE BID ITEM "TRAFFIC SIGNAL".
 - EXISTING FEATURES AND UTILITIES ARE SHOWN FROM AVAILABLE INFORMATION AND SHOULD BE CONSIDERED APPROXIMATE ONLY. IT IS THE RESPONSIBILITY OF THE CONTRACTOR TO VERIFY UTILITIES AND THEIR EXACT LOCATION PRIOR TO CONSTRUCTION.
 - CONTRACTOR SHALL COORDINATE POWER HOOK-UP WITH EVERGY.
 - NEW METER ADDRESS IS XXXX ZOO BLVD, WICHITA, KS, 667XX.
 - PROPOSED & EXISTING PAVEMENT MARKINGS ARE SCREENED FOR CLARITY. SEE PAVEMENT MARKING SHEETS FOR MORE INFORMATION.
 - DETECTOR ZONES AT INTERSECTION SHALL BE APPROXIMATELY 5 FEET IN FRONT OF 24" STOP BARS.
 - RADAR UNITS SHALL BE INSTALLED PER MANUFACTURE'S RECOMMENDATIONS INCLUDING HEIGHT, LOCATION, AND ORIENTATION. INSTALLATION OF THE DETECTORS SHALL INCLUDE EQUIPMENT, MATERIAL, AND LABOR NECESSARY FOR THE SATISFACTORY OPERATION OF THE TRAFFIC SIGNAL SYSTEM.
 - PEDESTRIAN "K" SIGNALS SHALL BE ORIENTED TOWARDS CROSSWALK.
 - 6'X6' ADVANCED DETECTION ZONES ON ZOO BLVD. ARE LOCATED 320', 210' & 92' FROM STOP LINE ON PHASES 2 & 6.
 - PHASE 8 SUPPLEMENTAL TRAFFIC SIGNAL HEAD SHALL BE MOUNTED TO POLE 2 & AIMED AT A POINT SO THAT IT HAS AN UNOBSTRUCTED VIEW TO SB HOOVER ROAD TRAFFIC A MINIMUM OF 270 FEET PRIOR TO THE INTERSECTION.

Tran Systems
 245 NORTH WACO
 SUITE 222
 WICHITA, KANSAS 67202
 PHONE: 316-303-3000
 FAX: 316-462-5629

CONSULTANTS:

HOOVER ROAD MULTI-USE PATH & TRAFFIC SIGNAL
 ZOO BLVD. TO 29TH STREET NORTH
 WICHITA, KANSAS

REVISIONS:	DESCRIPTION	MARK	DATE

PROJ NO: 472-85394
 SCALE: 1"=20'
 DATE: 9/30/2020
 DESIGNED BY: MCG
 DRAWN BY: MCG
 CHECKED BY: CCB

SHEET TITLE:
TRAFFIC SIGNAL PLAN

SHEET NO.
19
 SHEET 19 OF 44

c:\banka 9/30/2020 8:32:43 PM - c:\tran\systems\paw_ban\tran\systems\paw_ban\banka\07732111C-SIG-M01-101.dgn

IF THIS DRAWING IS LESS THAN 22" X 36" IT IS A REDUCED SIZE DRAWING