



LEGEND

-  Proposed Sign
-  Existing Sign to be Removed
-  Single Post Sign

Note:
All pavement markings for asphalt pavement shall be thermoplastic. At the option of the Contractor, pavement markings for concrete may be epoxy or cold plastic. Pavement markings shall be installed per manufacturer's recommendations. Full traffic may not be restored (and substantial project completion achieved) until all pavement markings are in place. Should construction timing be such that restoration of traffic becomes necessary during temperatures prohibiting the installation of pavement markings, the Contractor shall install and maintain temporary markings until such time that pavement markings may be properly install. Except for the material requirement, temporary pavement markings shall be placed equivalent, in every manner (i.e. dimension, frequency, spacing, etc.), to the permanent marking layout. The cost for temporary pavement markings will not be paid for directly, but shall be considered SUBSIDIARY to the bid item 'Pavement Marking'.

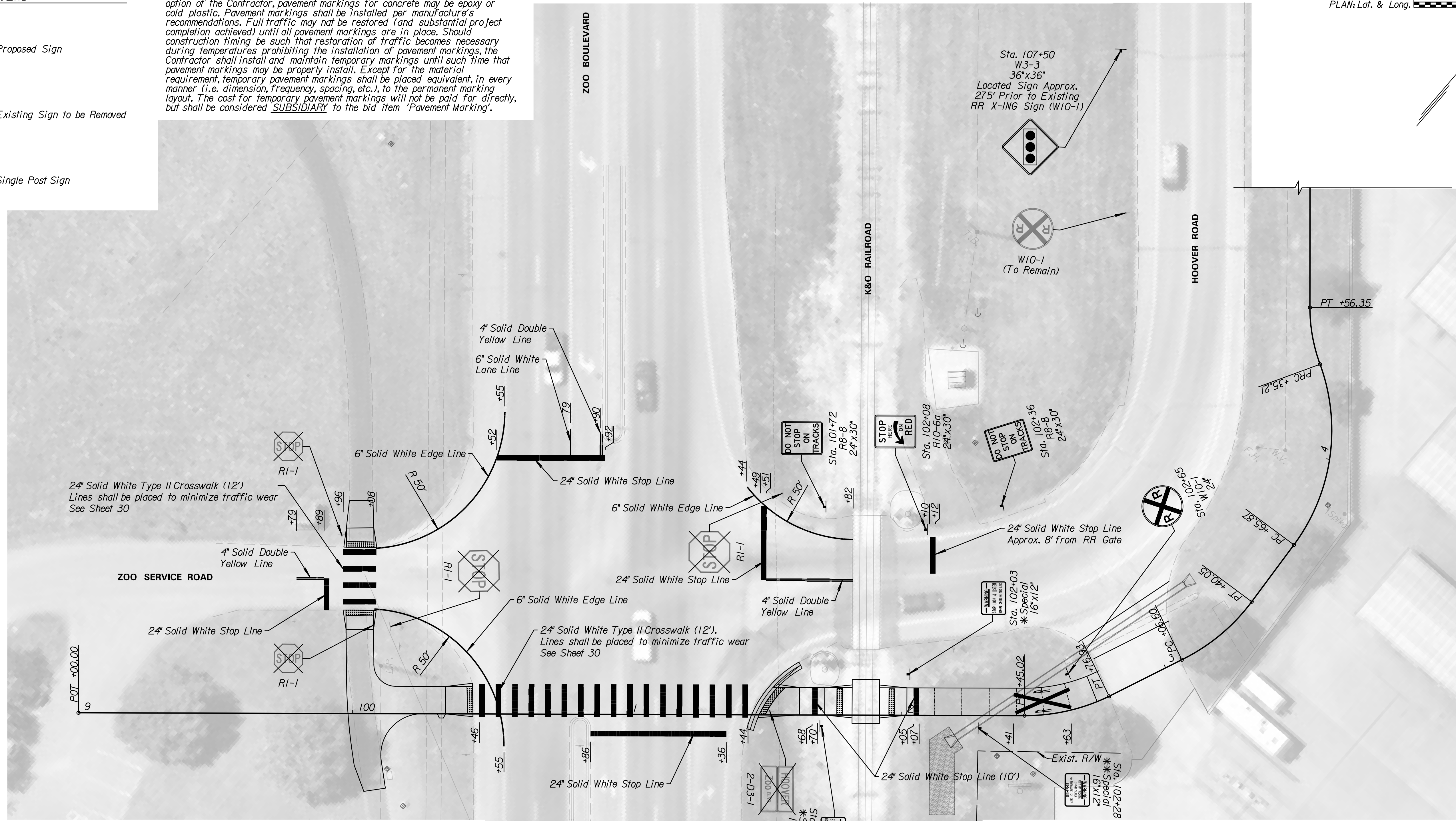
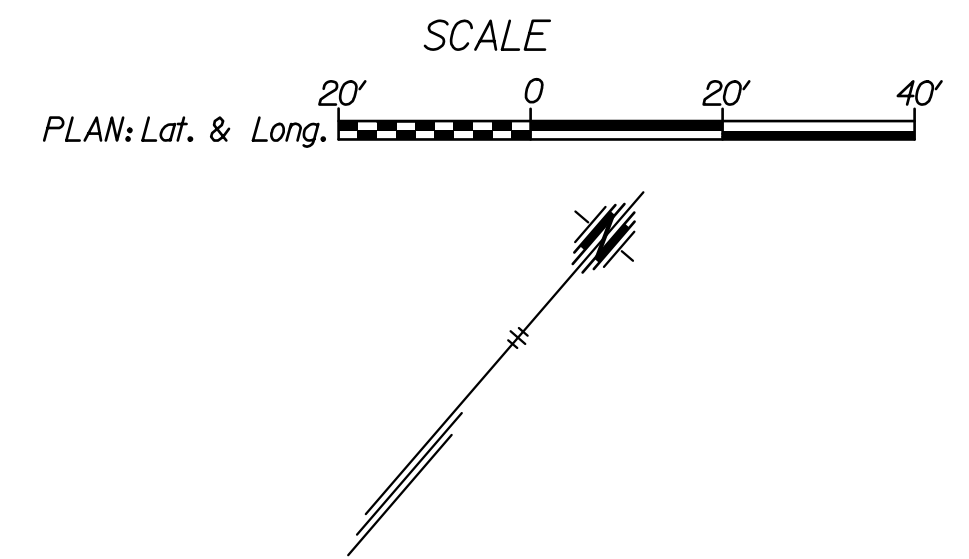

BIKE PATH SIGNING

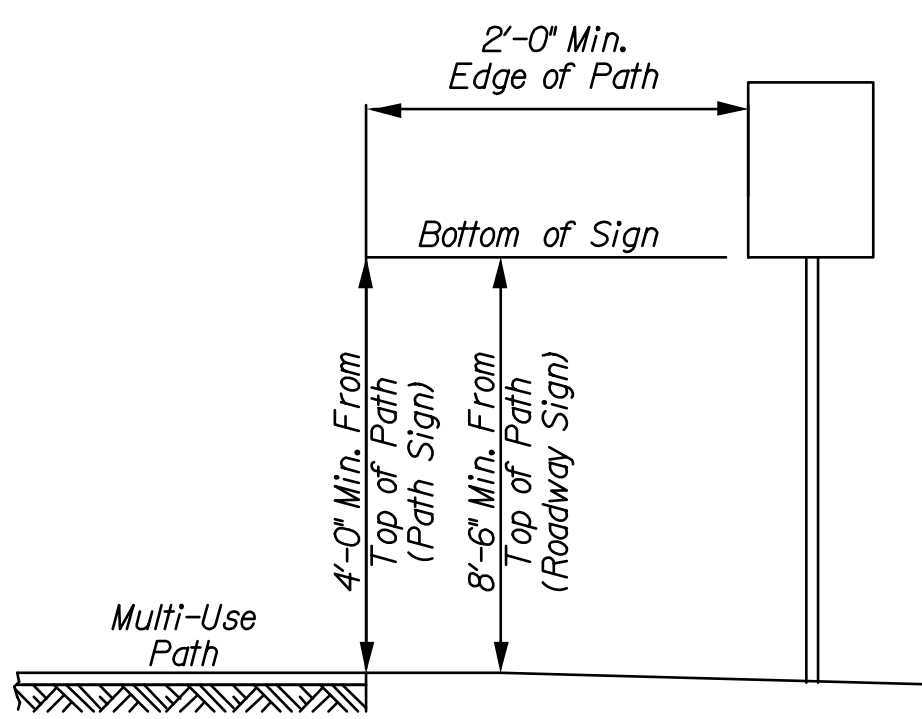

- URBAN**
- Ground-mounted signs shall be mounted at a minimum height of 4' measured from the bottom of sign to the top edge of the path for Bike Path signs and 8'-6" for roadway signs within 2' from path.
 - Permanent sign supports should not be located on sidewalks or areas designated for pedestrian or bicycle traffic.
 - Signing shall meet requirements per the MUTCD and AASHTO Guide for the Development of Bicycle Facilities, latest editions.

ADJUSTMENTS

Signs may be moved laterally or longitudinally if it will improve the visibility of the sign or other signs and if it will protect the sign more.



Storm sewer shall be marked at existing right-of-way with the following:
 1) Name and address - City of Wichita, 455 N. Main, Wichita, KS 67202
 2) Contents of Pipe - Storm Sewer
 3) Pressure in Pipe - No Pressure
 4) Pipe Depth Below Grade at Point of Sign - 12"
 5) Emergency Telephone Number - 316-268-4555

Sign shall be green with white lettering and approved by the Engineer. At the Contractor's option and at no additional cost, a domed utility mark may be used (green) that contains the information above.

Tran Systems
 245 NORTH WACO
 SUITE 222
 WICHITA, KANSAS 67202
 PHONE: 316-303-3000
 FAX: 316-462-5629

CONSULTANTS:

HOOVER ROAD MULTI-USE PATH
 & TRAFFIC SIGNAL
 ZOO BLVD. TO 29TH STREET NORTH
 WICHITA, KANSAS

REVISIONS:	DESCRIPTION	MARK	DATE

PROJ NO: 472-85394
 SCALE: 1"=20'
 DATE: 9/30/2020
 DESIGNED BY: MCG
 DRAWN BY: MCG
 CHECKED BY: CCB

SHEET TITLE:
**PAVEMENT MARKING
 & SIGNING**
 STA. 100+00.00
 TO
 STA. 105+00.00

SHEET NO.
32
 SHEET 32 OF 44