

- NOTES:**
1. Dashed lines between signal phasing boxes indicate phases that may time concurrently.
 2. Pedestrian intervals to occur only after push button actuation.
 3. Once terminated, the left turn arrows (Phase 1, 3, 5 & 7) shall not be allowed to return during the through phases.
 4. Conduit shall be jacked or bored if not installed before placing of new concrete pavement.
 5. Placement of signal poles, service/junction boxes, conduit runs and controller are typical, and may be adjusted as directed by the engineer to facilitate installation.
 6. The contractor shall contact all utility companies which may be affected by the installation of traffic signalization prior to any construction.
 7. Signalization timing to be done by the City of Wichita, Traffic Engineering.

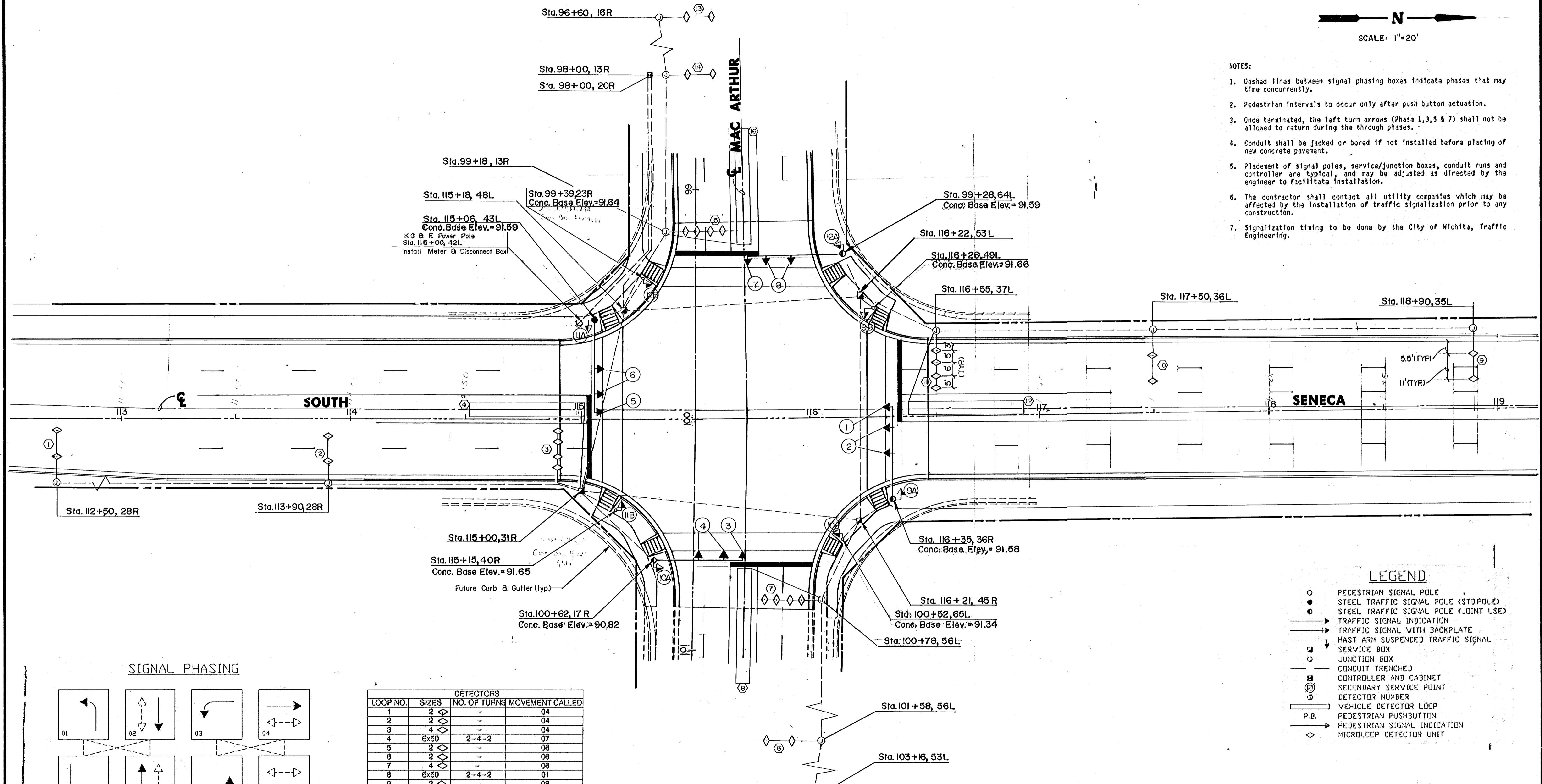

LEGEND

- PEDESTRIAN SIGNAL POLE
- STEEL TRAFFIC SIGNAL POLE (STD. POLE)
- STEEL TRAFFIC SIGNAL POLE (JOINT USE)
- TRAFFIC SIGNAL INDICATION
- TRAFFIC SIGNAL WITH BACKPLATE
- MAST ARM SUSPENDED TRAFFIC SIGNAL
- SERVICE BOX
- JUNCTION BOX
- CONDUIT TRENCHED
- CONTROLLER AND CABINET
- SECONDARY SERVICE POINT
- DETECTOR NUMBER
- VEHICLE DETECTOR LOOP
- P.B. PEDESTRIAN PUSHBUTTON
- PEDESTRIAN SIGNAL INDICATION
- ◇ MICROLOOP DETECTOR UNIT

SIGNAL PHASING

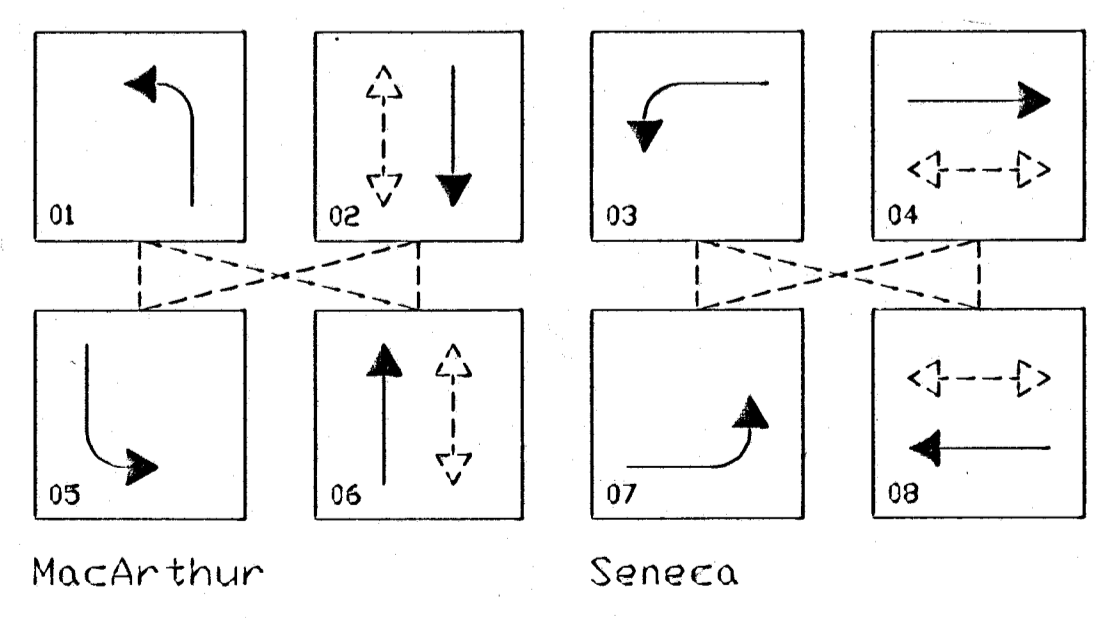

LOOP NO.	DETECTORS		MOVEMENT CALLED
	SIZES	NO. OF TURNS	
1	2 ◇	-	04
2	2 ◇	-	04
3	4 ◇	-	04
4	6x50	2-4-2	07
5	2 ◇	-	08
6	2 ◇	-	08
7	4 ◇	-	08
8	6x50	2-4-2	01
9	2 ◇	-	08
10	2 ◇	-	08
11	4 ◇	-	08
12	6x50	2-4-2	03
13	2 ◇	-	02
14	2 ◇	-	02
15	4 ◇	-	02
16	6x50	2-4-2	05

MK
E/C

**SOUTH SENECA
IMPROVEMENTS**

**TRAFFIC
SIGNALIZATION PLAN**

48TH ST. SO. TO MAC ARTHUR RD.

Design
Drawn by
WNJ
Checked by
Date
Job no.

MID-KANSAS ENGINEERING CONSULTANTS PA
3500 NORTH ROCK ROAD
BUILDING 1800
WICHITA, KANSAS 67226

Sheet **18**
of **41**