

LEGEND

-  = EXIST. SIDEWALK
-  = CONST. CONC. DRIVE
-  = EXIST. PARKING
-  = CONST. ASPH. PVMT.
-  = CONST. 6' SIDEWALK

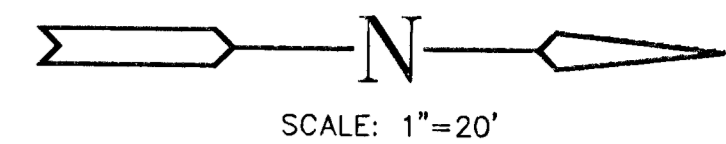

SCALE: 1"=20'

ST. STA. 11+16.00, 38.89' LT. (@ MH TO @)
 REMOVE EXIST. INLET
 CONST. SPECIAL SHALLOW TYPE 'B' MH
 MH DIA. = 4.0'
 MH TOP = 213.08
 FL IN = 209.74 15" RCP W.
 FL IN = 209.64 EXIST. 15" N.
 FL OUT = 209.64 EXIST. 15" S.
 NOTE LOCATION OF BURIED UTILITIES

ST. STA. 11+15.97, 48.58' LT. (@ MH TO @)
 CONST. STD. C.O.W. TYPE 1-A CURB INLET
 W = 4'-6", L = 6'-4"
 INLET TOP = 213.30
 FL OUT = 209.78 15" RCP E.

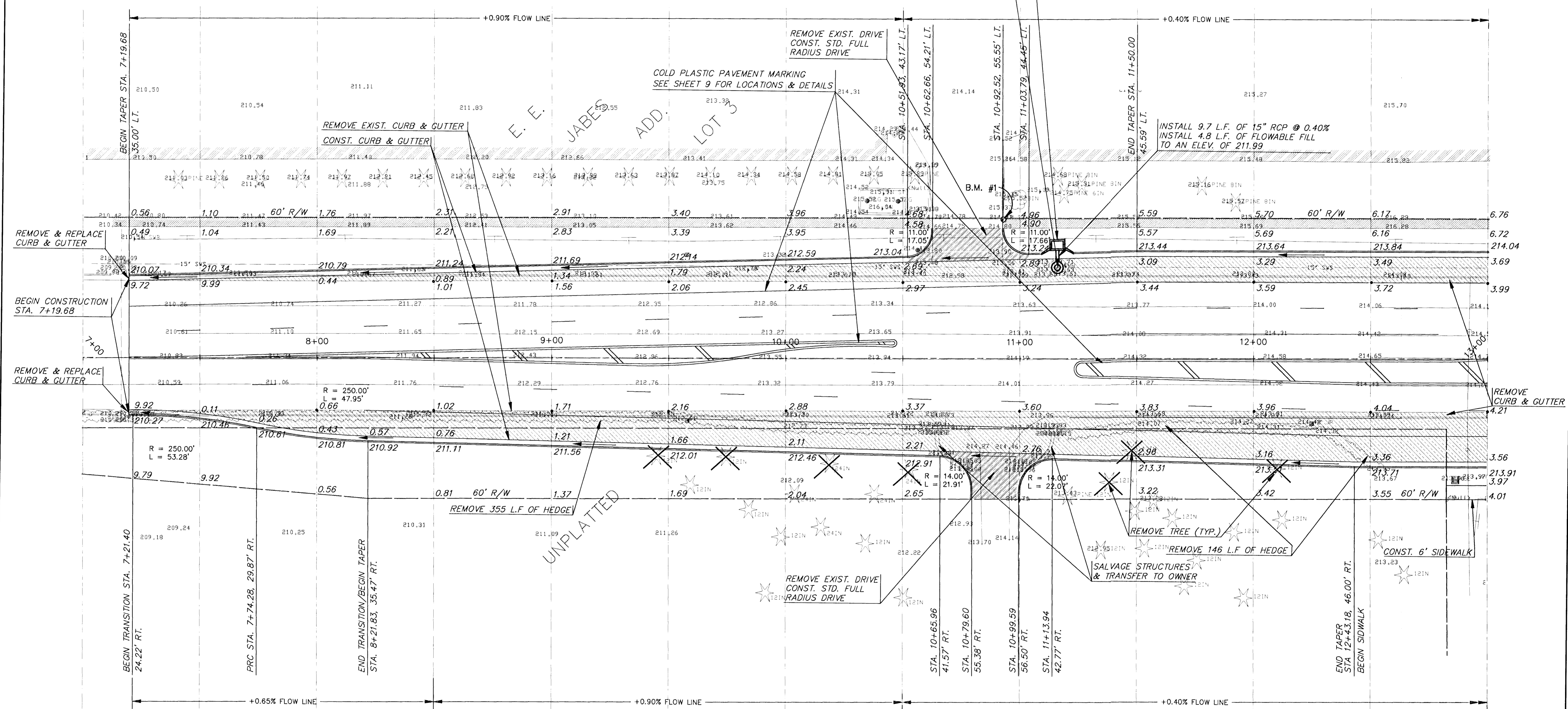

NOTES

ALL STATIONING, RADII, PAVEMENT WIDTHS AND OFFSETS ARE MEASURED TO THE FACE OF CURB, UNLESS NOTED OTHERWISE. ELEVATIONS ARE THE HIGH EDGE AND TOP OF CURB.

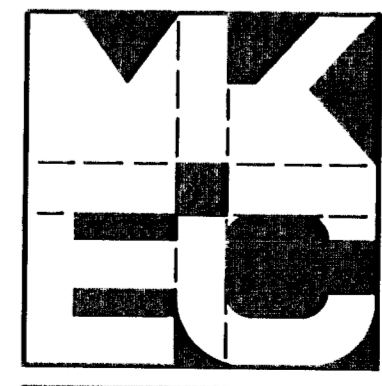
	BRADLEY FAIR NORTH ROCK ROAD STREET IMPROVEMENTS STA. 7+00 TO 13+00	Design JTC Drawn by JTC Checked by KHB Date JUNE/94 Job no. 93092
	MID-KANSAS ENGINEERING CONSULTANTS INC. 3500 NORTH ROCK ROAD BUILDING #800 WICHITA, KANSAS 67226	
	(316) 636-5566	
	Sheet 5 of 12	