

STREET	STATION	OFFSET	PROPOSED ELEVATION
WILD ROSE	18+02	26" RT.	143.7
WILD ROSE	18+53	24" RT.	143.2

SCALE: 1"=20'

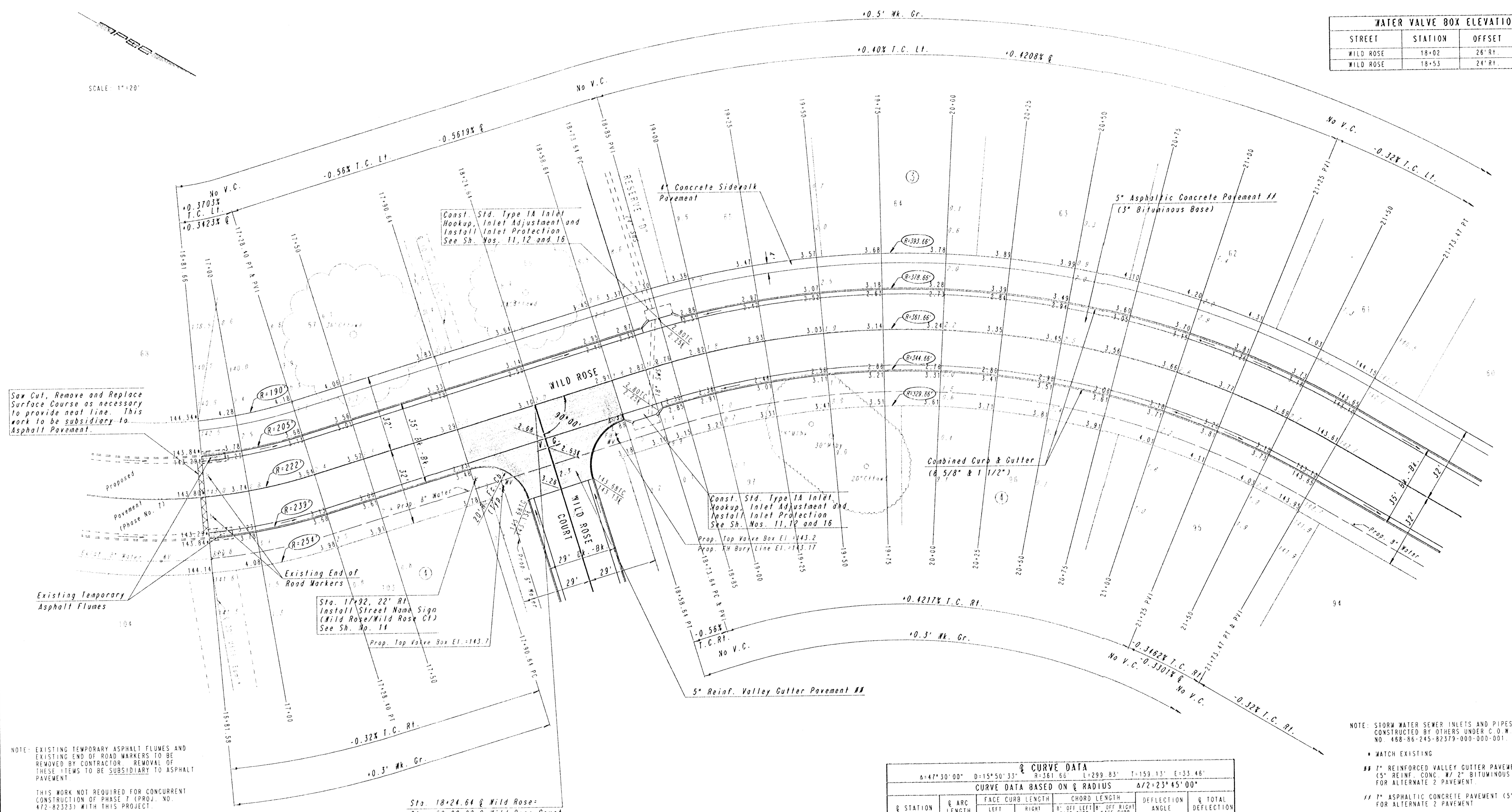

PLAN	SUBMITTED	DATE
ADJ. BOOKPLOTTER	BY	
NO. OF REVISIONS	DATE	
NO. OF REVISIONS	DATE	
NO. OF REVISIONS	DATE	

Saw Cut, Remove and Replace Surface Course as necessary to provide neat line. This work to be subsidiary to Asphalt Pavement.

NOTE: EXISTING TEMPORARY ASPHALT FLUMES AND EXISTING END OF ROAD MARKERS TO BE REMOVED BY CONTRACTOR. REMOVAL OF THESE ITEMS TO BE SUBSIDIARY TO ASPHALT PAVEMENT.

THIS WORK NOT REQUIRED FOR CONCURRENT CONSTRUCTION OF PHASE 7 (PROJ. NO. 472-82323) WITH THIS PROJECT.

Sta. 18+24.64 @ Wild Rose  
Sta. 50+00.00 @ Wild Rose Court

Q STATION	Q ARC LENGTH	FACE CURB LENGTH	CHORD LENGTH	DEFLECTION ANGLE	Q TOTAL DEFLECTION
15+48.86				0°00'00"	0°00'00"
16+81.58 RT	132.72'			17°07'36" RT	17°07'36" RT
16+81.66 LT	132.80'			17°08'13" LT	17°08'13" LT
17+00 RT	18.42'	19.83'	20.49'	2°22'37" RT	19°30'13" RT
17+00 LT	18.34'	16.94'	16.27'	2°22'00" LT	17°30'13" LT
17+25	25.00'	23.09'	22.17'	2°13'34"	19°43'47"
17+28.40	3.40'	3.13'	3.02'	0°26'16"	20°10'06"
TOTAL	179.54'	43.16'	50.40'		

ITEM	QUANTITY
113.33 S.Y. 5" Asphaltic Concrete Pavement (5" Bit. Base)	
99.86 S.Y. 5" Reinforced Valley Gutter Pavement	
62.83 L.F. Monolithic Edge Curb (6 5/8")	
219.82 S.Y. 5" Crushed Rock Base	

Q STATION	Q ARC LENGTH	FACE CURB LENGTH	CHORD LENGTH	DEFLECTION ANGLE	Q TOTAL DEFLECTION
18+73.64				0°00'00"	0°00'00"
18+75	1.36'	1.40'	1.32'	1.45'	1.27'
18+85	10.00'	10.47'	9.53'	10.69'	9.31'
19+00	15.00'	15.71'	14.29'	16.03'	13.96'
19+25	25.00'	26.18'	23.82'	26.72'	23.27'
19+50	25.00'	26.18'	23.82'	26.72'	23.27'
19+75	25.00'	26.18'	23.82'	26.72'	23.27'
20+00	25.00'	26.18'	23.82'	26.72'	23.27'
20+25	25.00'	26.18'	23.82'	26.72'	23.27'
20+50	25.00'	26.18'	23.82'	26.72'	23.27'
20+75	25.00'	26.18'	23.82'	26.72'	23.27'
21+00	25.00'	26.18'	23.82'	26.72'	23.27'
21+25	25.00'	26.18'	23.82'	26.72'	23.27'
21+50	25.00'	26.18'	23.82'	26.72'	23.27'
21+73.47	23.47'	24.54'	22.39'	25.09'	21.84'
TOTAL	299.83'	313.92'	285.73'		

NOTE: STORM WATER SEWER INLETS AND PIPES TO BE CONSTRUCTED BY OTHERS UNDER C.O.W. PROJECT NO. 468-86-245-82379-000-000-001.

- \* MATCH EXISTING
- \*\* 7" REINFORCED VALLEY GUTTER PAVEMENT (5" REINF. CONC. W/ 2" BITUMINOUS BASE) FOR ALTERNATE 2 PAVEMENT.
- \*\*\* 7" ASPHALTIC CONCRETE PAVEMENT (5" BIT. BASE) FOR ALTERNATE 2 PAVEMENT.

FOREST LAKES  
PHASE NO. 8

## WILD ROSE

STA. 16+81.58 TO STA. 21+73.47

PROFESSIONAL ENGINEERING CONSULTANTS, P.A.  
ENGINEERS  
WICHITA, KANSAS

Designed by: WMB, GDD  
Checked by: DEP  
Date: FEB., 1994  
Job No. 93695

DRAWING NAME: 32-53895 WILD ROSE  
LOCATION: 25+81.115  
DATE: 02/15/94  
DATE LAST WORKED ON:  
DRAWN BY: DUNN