

RISER/MANHOLE COORDINATES		
POINT NAME	NORTHING	EASTING
MH-14	1735154	1610977
MH-15	1734377	1611600
MH-16	1733505	1612030
MH-17	1732550	1612327
MH-18	1731986	1612541
MH-19	1731220	1613168
R-31	1735210	1610903
R-32	1734930	1611179
R-33	1734636	1611444
R-34	1734297	1611647
R-35	1733594	1612001
R-36	1733217	1612120
R-37	1732840	1612237
R-38	1732462	1612355
R-39	1732036	1612514
R-40	1731744	1612677
R-41	1731434	1612922
R-42	1731178	1613223

RISER/MANHOLE COORDINATES AND TOE-DRAIN PIPE INVERT ELEVATIONS ARE BASED LIDAR TOPOGRAPHIC DATA AND MAY REQUIRE MINOR HORIZONTAL AND VERTICAL ADJUSTMENTS TO BE MADE IN THE FIELD. ANY FIELD CHANGES TO THE TOE-DRAIN ALIGNMENT OR PIPE INVERTS SHALL BE APPROVED BY THE CITY OF WICHITA'S STORMWATER ENGINEER.

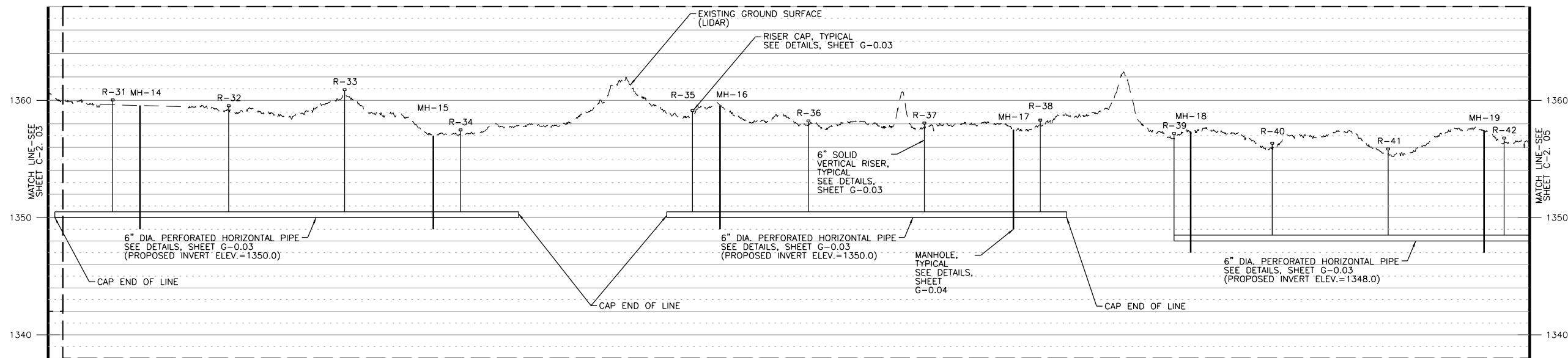

LEVEE C

PROFILE SCALE (40:1 EXAGGERATION):  
HORIZONTAL: 1"=200'  
VERTICAL: 1"=5'

DATE	APPR.
DESCRIPTION	MARK

**ameco**  
AMEC Earth & Environmental, Inc.  
1129 SW Winemaker  
Topeka, Kansas 66604  
Phone: (785) 272-6830  
Fax: (785) 272-6878



UPPER LEVEE TOE DRAIN INSTALLATION  
WICHITA-VALLEY CENTER LOCAL  
FLOOD PROTECTION PROJECT  
WICHITA, KANSAS

PREPARED FOR  
**THE CITY OF WICHITA, KANSAS**  
455 N. Main  
Wichita, KS 67202



DESIGNED BY: Larry Sample, PE	DATE: 08-13-2012
DWN BY: RES	CKD BY: LBK
APP BY: L. SAMPLE	
FILE NAME: 10_C-2.dwg	
AMEC PROJ. NO. 5-6150-0001	

LEVEE TOE DRAIN PLAN  
AND PROFILE  
**C-2.04**  
SHEET 13 OF 24