

PAVING & DRAINAGE FOR
BOTANICA GARDENS PARKING LOT
WICHITA, KANSAS

©2021 MKEC Engineering All Rights Reserved www.mkec.com
These drawings and their contents, including, but not limited to, all concepts, designs, & ideas are the exclusive property of MKEC Engineering (MKEC), and may not be used or reproduced in any way without the express consent of MKEC.

SURFACING PLAN 1

PROJECT NO. 482-11034

DATE JULY 2021

SCALE 1"=20'

DESIGNED DRAWN CHECKED
JAG CRM GJA

NO. REVISION DATE

SHEET NO.

10 OF 31

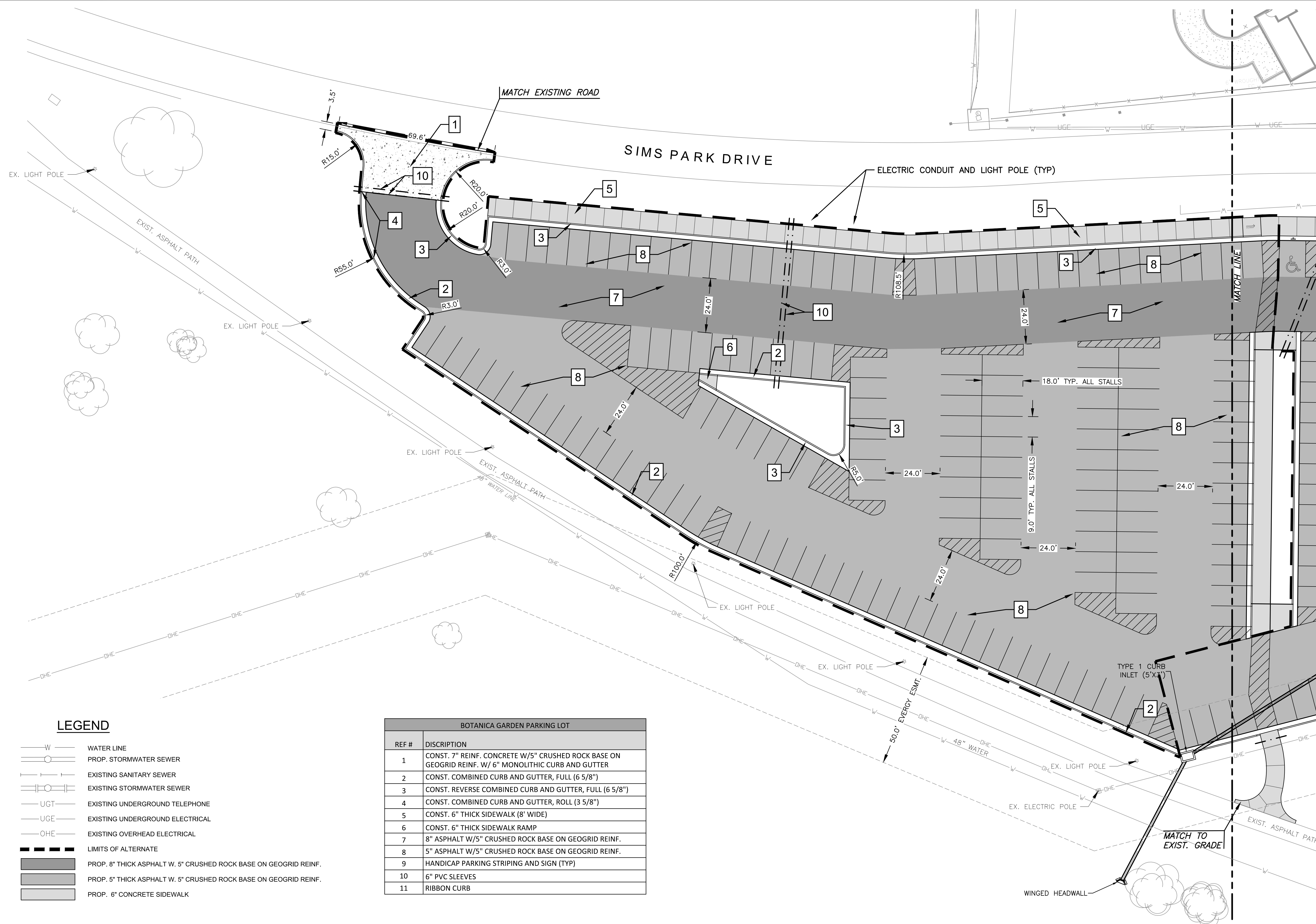

LEGEND

- W — WATER LINE
- ○ — PROP. STORMWATER SEWER
- — — EXISTING SANITARY SEWER
- — — EXISTING STORMWATER SEWER
- UGT — EXISTING UNDERGROUND TELEPHONE
- UGE — EXISTING UNDERGROUND ELECTRICAL
- OHE — EXISTING OVERHEAD ELECTRICAL
- — — LIMITS OF ALTERNATE
- PROP. 8" THICK ASPHALT W. 5" CRUSHED ROCK BASE ON GEOGRID REINF.
- PROP. 5" THICK ASPHALT W. 5" CRUSHED ROCK BASE ON GEOGRID REINF.
- PROP. 6" CONCRETE SIDEWALK

| BOTANICA GARDEN PARKING LOT | |
|-----------------------------|---|
| REF # | DISCRIPTION |
| 1 | CONST. 7" REINF. CONCRETE W/5" CRUSHED ROCK BASE ON GEOGRID REINF. W/ 6" MONOLITHIC CURB AND GUTTER |
| 2 | CONST. COMBINED CURB AND GUTTER, FULL (6 5/8") |
| 3 | CONST. REVERSE COMBINED CURB AND GUTTER, FULL (6 5/8") |
| 4 | CONST. COMBINED CURB AND GUTTER, ROLL (3 5/8") |
| 5 | CONST. 6" THICK SIDEWALK (8' WIDE) |
| 6 | CONST. 6" THICK SIDEWALK RAMP |
| 7 | 8" ASPHALT W/5" CRUSHED ROCK BASE ON GEOGRID REINF. |
| 8 | 5" ASPHALT W/5" CRUSHED ROCK BASE ON GEOGRID REINF. |
| 9 | HANDICAP PARKING STRIPING AND SIGN (TYP) |
| 10 | 6" PVC SLEEVES |
| 11 | RIBBON CURB |

PLOTTED: Thursday, July 15, 2021 @ 11:24AM
 J:\PROJECTS\2019\10010483_COW_BOTANICA PARKING EXPANSION_190483 CAD\SHOTS\05 CIVIL\PAV\190483-05-2020.DWG