

BENCHMARKS:
BRASS DISC ON TOP OF CURB
EAST END OF CURB RETURN,
NORTH OF THE NW COR., LOT 49,
BLOCK C, ANGEL FIRE ADDITION.
ELEV. = 94.37 CITY DATUM
ELEV. = 1282.23 NAVD88

BRASS DISC ON TOP OF CURB
NORTH END OF CURB RETURN,
WEST OF THE SW COR., LOT 1,
BLOCK B, ANGEL FIRE ADDITION.
ELEV. = 94.82 CITY DATUM
ELEV. = 1282.68 NAVD88

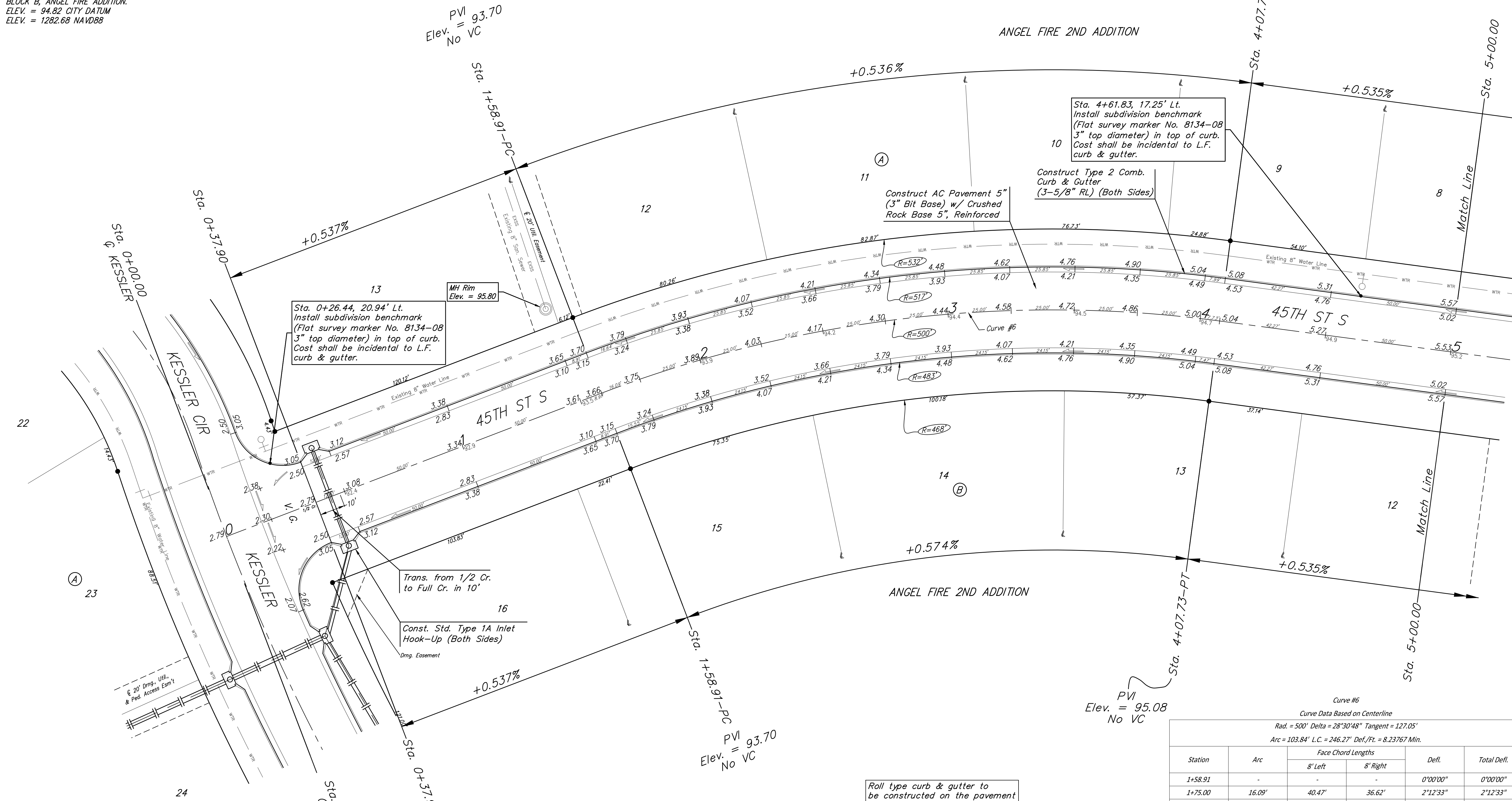
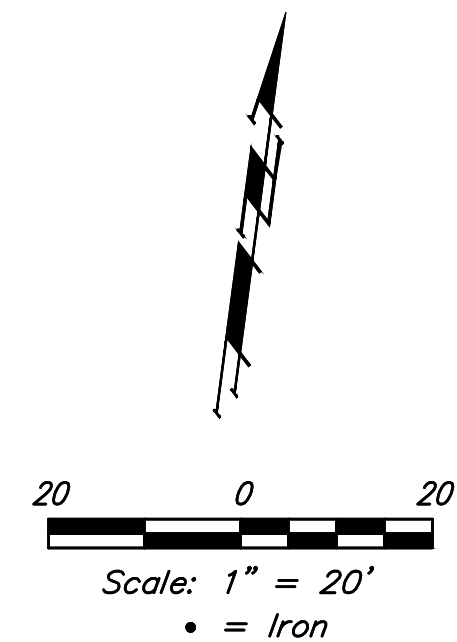

Sta. 0+26.44, 20.94' Lt.
Install subdivision benchmark
(Flat survey marker No. 8134-08
3" top diameter) in top of curb.
Cost shall be incidental to L.F.
curb & gutter.

Sta. 4+61.83, 17.25' Lt.
Install subdivision benchmark
(Flat survey marker No. 8134-08
3" top diameter) in top of curb.
Cost shall be incidental to L.F.
curb & gutter.

Construct AC Pavement 5"
(3" Bit Base) w/ Crushed
Rock Base 5", Reinforced

Construct Type 2 Comb.
Curb & Gutter
(3-5/8" RL) (Both Sides)

Trans. from 1/2 Cr.
to Full Cr. in 10'

Const. Std. Type 1A Inlet
Hook-Up (Both Sides)

Roll type curb & gutter to
be constructed on the pavement
on this sheet.
Top of curb elevation are given
for full height curb.

Subdivision Benchmarks

Street & Station	Location Description	Elevation
45TH ST S 0+26.44, 20.94' Lt.	Adjacent to Fire Hydrant in Center of the North Return Kessler & 45th St S, S. Cor., Lot 13, Blk A	
45TH ST S 4+61.83, 17.25' Lt.	Adjacent to Fire Hydrant at the South corner of the common lot line of 8 & 9, Blk A	

Curve #6
Curve Data Based on Centerline
Rad. = 500' Delta = 28°30'48" Tangent = 127.05'
Arc = 103.84' L.C. = 246.27' Def./Ft. = 8.23767 Min.

Station	Arc	Face Chord Lengths		Defl.	Total Defl.
		8' Left	8' Right		
1+58.91	-	-	-	0'00"00"	0'00"00"
1+75.00	16.09'	40.47'	36.62'	2'12'33"	2'12'33"
2+00.00	25.00'	62.86'	56.88'	3'25'56"	5'38'29"
2+25.00	25.00'	62.86'	56.88'	3'25'57"	9'04'26"
2+50.00	25.00'	62.86'	56.88'	3'25'56"	12'30'22"
2+75.00	25.00'	62.86'	56.88'	3'25'57"	15'56'19"
3+00.00	25.00'	62.86'	56.88'	3'25'56"	19'22'15"
3+25.00	25.00'	62.86'	56.88'	3'25'57"	22'48'12"
3+50.00	25.00'	62.86'	56.88'	3'25'56"	26'14'08"
3+75.00	25.00'	62.86'	56.88'	3'25'57"	29'40'05"
4+00.00	25.00'	62.86'	56.88'	3'25'56"	33'06'01"
4+07.73	7.73'	19.45'	17.60'	1'03'41"	34'09'42"

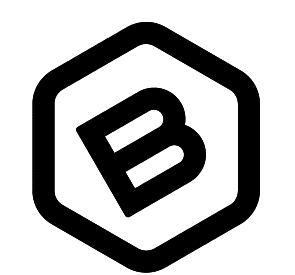
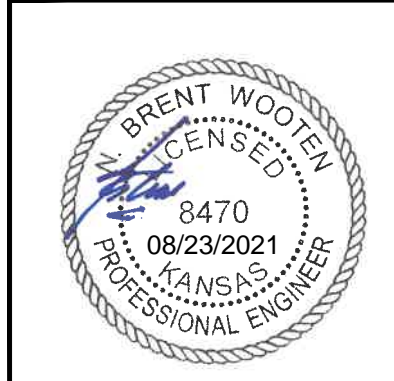

**BAUGHMAN
COMPANY**

315 Ellis St.
Wichita, KS 67211
316-262-7271
BaughmanCo.com

ANGEL FIRE
2ND ADDITION

45TH ST S

Sta. 0+00 to Sta. 5+00

PROJECT NUMBER:
472-2021-085714

DESIGN: NBW DRAWN: CDW

DATE: August 20, 2021

SHEET OF
13 44

File: E:\Projects\Angel Fire 2nd Addition_11-03-P197\Engineering\Phase 1\Str. 21-02-E849\STR PLANS.dwg