

BENCHMARKS:  
 BRASS DISC ON TOP OF CURB  
 EAST END OF CURB RETURN,  
 NORTH OF THE NW COR., LOT 49,  
 BLOCK C, ANGEL FIRE ADDITION.  
 ELEV. = 94.37 CITY DATUM  
 ELEV. = 1282.23 NAVD88

BRASS DISC ON TOP OF CURB  
 NORTH END OF CURB RETURN,  
 WEST OF THE SW COR., LOT 1,  
 BLOCK B, ANGEL FIRE ADDITION.  
 ELEV. = 94.82 CITY DATUM  
 ELEV. = 1282.68 NAVD88

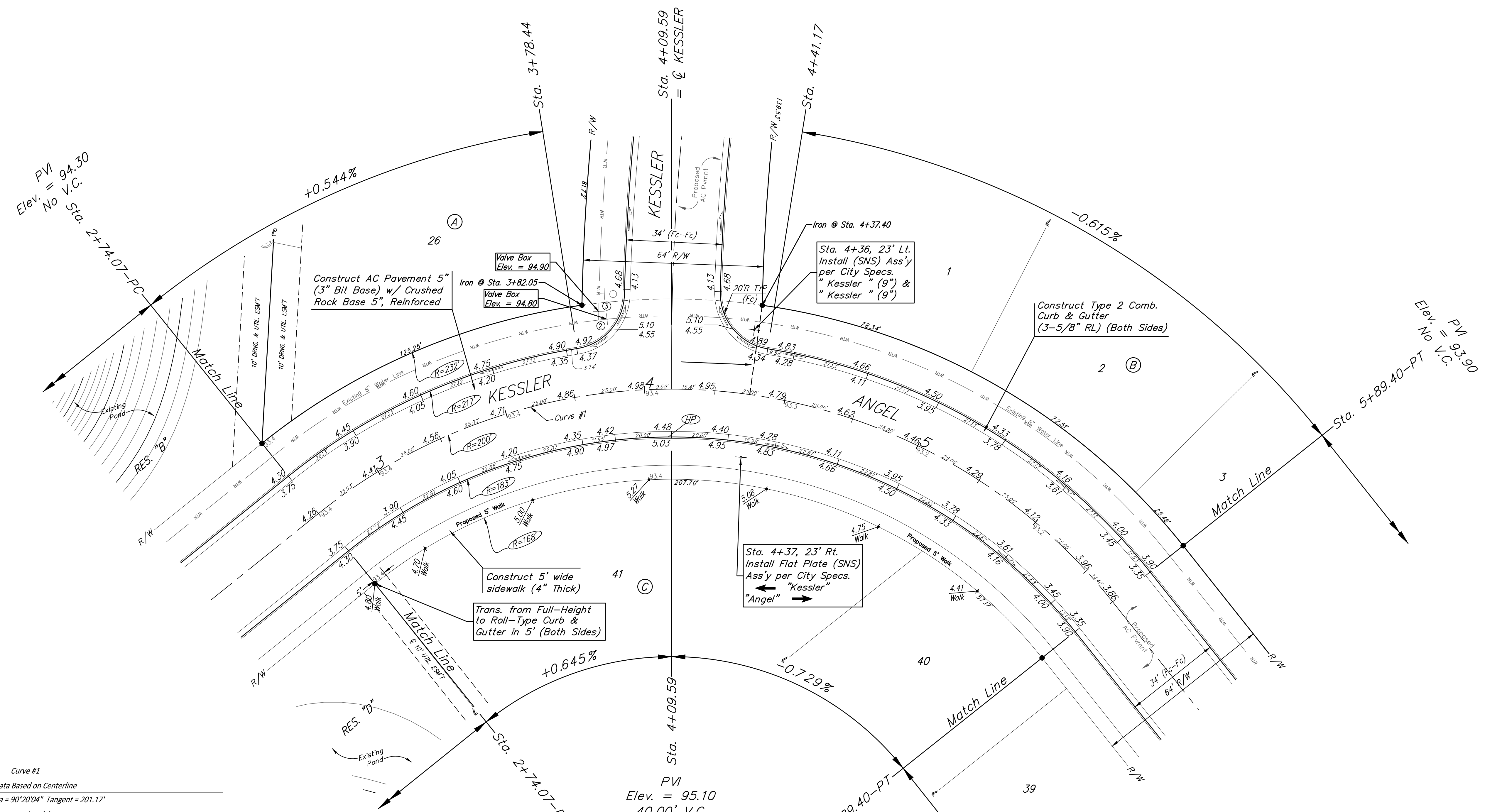
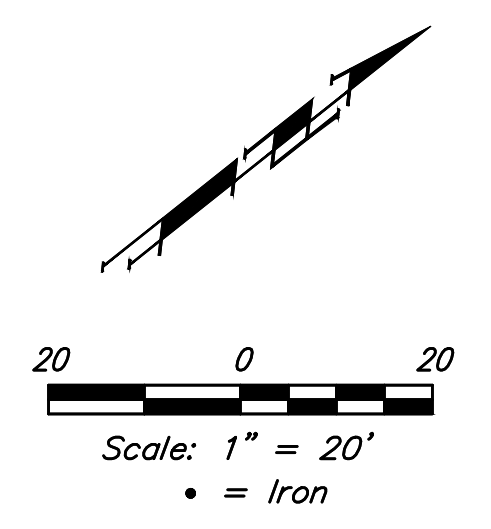

Curve #1  
 Curve Data Based on Centerline

Rad. = 200' Delta = 90°20'04" Tangent = 201.17'  
 Arc = 103.84' L.C. = 283.67' Def./Ft. = 26.09816 Min.

Station	Arc	Face Chord Lengths		Defl.	Total Defl.
		8' Left	8' Right		
2+74.07	-	-	-	0°00'00"	0°00'00"
2+75.00	0.93'	3.18'	2.47'	0°24'16"	0°24'16"
3+00.00	25.00'	84.89'	66.03'	10°52'28"	11°16'44"
3+25.00	25.00'	84.89'	66.03'	10°52'27"	22°09'11"
3+50.00	25.00'	84.89'	66.03'	10°52'27"	33°01'38"
3+75.00	25.00'	84.89'	66.03'	10°52'27"	43°54'05"
4+00.00	25.00'	84.89'	66.03'	10°52'28"	54°46'33"
4+25.00	25.00'	84.89'	66.03'	10°52'27"	65°39'00"
4+50.00	25.00'	84.89'	66.03'	10°52'27"	76°31'27"
4+75.00	25.00'	84.89'	66.03'	10°52'27"	87°23'54"
5+00.00	25.00'	84.89'	66.03'	10°52'27"	98°16'21"
5+25.00	25.00'	84.89'	66.03'	10°52'28"	109°08'49"
5+50.00	25.00'	84.89'	66.03'	10°52'27"	120°01'16"
5+75.00	25.00'	84.89'	66.03'	10°52'27"	130°53'43"
5+89.40	14.40'	49.10'	38.19'	6°15'49"	137°09'32"

VALVE LOCATION TABLE

VALVE NUMBER	STREET	BASELINE STATION	OFFSET DISTANCE	OFFSET DIRECTION
2	KESSLER	3+89.24	26.0'	Lt.

Roll type curb & gutter to be constructed on the pavement on this sheet.  
 Top of curb elevation are given for full height curb.



**BAUGHMAN COMPANY**  
 315 Ellis St.  
 Wichita, KS 67211  
 316-262-7271  
 BaughmanCo.com

ANGEL FIRE  
 2ND ADDITION

**KESSLER & ANGEL**

Sta. 2+74.07 to Sta. 5+89.40

PROJECT NUMBER:  
 472-2021-085714

DESIGN: NBW DRAWN: CDW  
 DATE: August 20, 2021

SHEET OF  
**7 44**

File: E:\Projects\Angel Fire 2nd Addition\_11-03-P197\Engineering\Phase 1\Str. 21-02-EB49\STR PLANS.dwg