

# PLANEVIEW SUBDIVISION No 1

BEING A SUBDIVISION IN SECTION 2, TOWNSHIP 28 SOUTH, RANGE 1, EAST OF 6TH PRINCIPAL MERIDIAN, IN SEDGEWICK COUNTY, KANSAS.

### DEDICATION

Know all men by these presents, that the United States of America, acting by and through the Public Housing Administration, by Hugo C. Schwartz, Chief of Office Director, Chicago Field Office, as proprietor, has caused the land embraced in the annexed plat to be surveyed, laid out, and platted to be known as "PLANEVIEW SUBDIVISION No. 1", being a subdivision in Section 2, Township 28 South, Range 1, East of the 6th. Principal Meridian, in Sedgewick County, Kansas, and that all streets, roadways, alleys and parking areas as shown on said plat, are dedicated to the public. Also, Blocks U, V and W as shown are dedicated to and for the use of the public. Easements as shown are hereby granted as indicated for the construction and maintenance of all public utilities. All driveway easements as shown on said plat are dedicated for the benefit of all adjoining lots as shown on said plat and that no permanent structures are to be erected within the lines of said easements.

In the event any public utility easements have inadvertently been omitted from the plat, the undersigned hereby grants an 8 foot easement on each side of each existing utility line, provided said easement does not impede the removal of any building.

Witness my hand and the seal of the Public Housing Administration at Chicago, Illinois, this 27th day of August, 1955.

William J. Miller  
Chicago Field Office

Hugo C. Schwartz  
Chicago Field Office

### ACKNOWLEDGEMENT

State of Illinois, )  
County of Cook, ) SS.

On this 3 day of July 1955, before me, a Notary Public in and for said County, appeared Hugo C. Schwartz to me personally known, who, being by me duly sworn, did say that he is the Chief of Office Director of the Public Housing Administration and that said Dedication was signed in behalf of the United States of America by authority of law and the said Hugo C. Schwartz acknowledged said Dedication to be the free act and deed of the United States of America.

My Commission expires: 4-27-56

Rouis J. Goven  
Notary Public

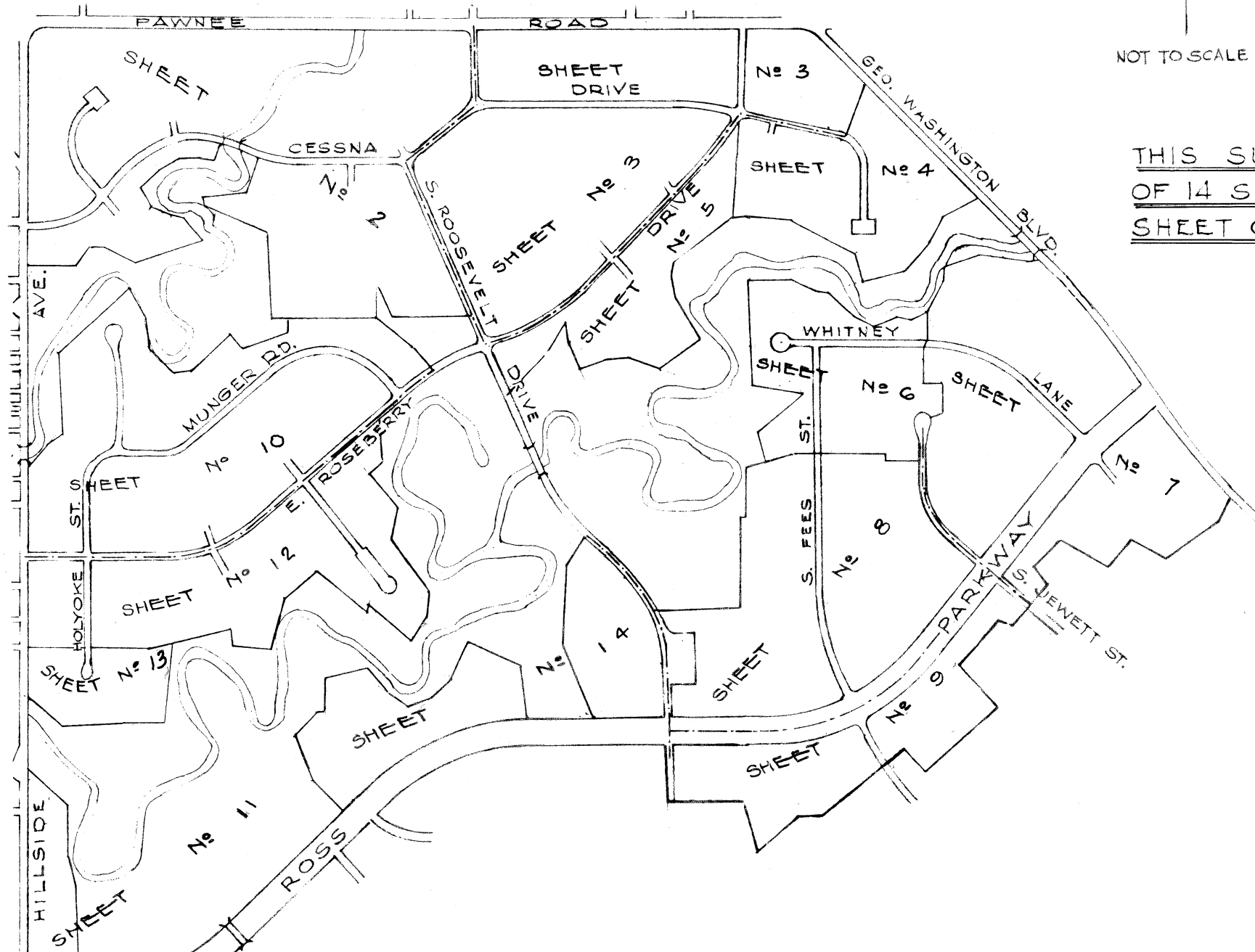

THIS SURVEY CONSISTS OF 14 SHEETS.....THIS IS SHEET ONE.

This plat of "PLANEVIEW" has been submitted to and considered by the City Planning Commission of the City of Wichita, Kansas, and is hereby transmitted to the Board of Commissioners of the City of Wichita, Kansas, with the recommendation that such plat be approved as proposed.

Dated this 2 day of August 1955.  
The City Planning Commission of the City of Wichita, Kansas.  
By: Charles W. Wood Chairman  
J. J. Schmitt Secretary

Approved by the Board of City Commissioners this 9 day of August 1955.  
Charles W. Wood Mayor  
J. J. Schmitt City Clerk

Approved by the Board of County Commissioners this 24th day of August 1955.  
J. J. Schmitt County Clerk

Entered on transfer record this 27th day of August 1955

State of Kansas, )  
County of Sedgewick, ) ss

This is to certify that this instrument was filed for record in the Register of Deeds Office on the 30 day of August 1955 at 2:41 o'clock and is duly recorded.

Wm. J. Deering  
Register of Deeds  
Deputy

I, Lewis D. Suhr, licensed Professional Engineer No. 3096 in the State of Kansas, do hereby certify that I have surveyed and subdivided the following described property....That part of Section 2, Township 28 South, Range 1, East of the 6th. Principal Meridian, Sedgewick County, Kansas, described in 43 courses as follows:....Course 1: Commencing at the NW corner of Sec. 2, aforesaid; thence S 89°39'36" E. along the north line of Sec. 2 aforesaid; 2884.33 feet to the center line of George Washington Blvd; Course 2: thence S 44°51'36" E. along the center line of George Washington Blvd; 1234.22 feet to a point of curve; Course 3: thence S 87°15'24" W. along a curve convex to the NE, radius 2864.21 feet, a distance of 465.0 feet to a point of tangency; Course 4: thence S 35°22'36" E. 250.45 feet to a point of curve; Course 5: thence S 87°15'24" W. along a curve convex to the NW, radius 2112.20 feet, for a distance of 138.35 feet; Course 6: thence S 47°14'24" W. 447.85 feet; Course 7: thence S 30°32'36" E. 203.46 feet; Course 8: thence S 43°42'24" W. 141.33 feet; Course 9: thence N 56°44'36" W. 206.46 feet; Course 10: thence S 40°53'24" W. 159.21 feet; Course 11: thence N 49°47'36" W. 150.47 feet; Course 12: thence S 29°30'24" W. 74.43 feet; Course 13: thence S 46°00'24" W. 171.0 feet; Course 14: thence N 50°08'36" W. 83.24 feet; Course 15: thence S 40°08'36" W. 155.35 feet; Course 16: thence S 50°08'36" E. 113.40 feet; Course 17: thence S 39°56'24" W. 61.33 feet; Course 18: thence S 53°25'36" E. 46.07 feet; Course 19: thence S 40°08'36" W. 80.23 feet; Course 20: thence S 48°04'33" W. 04'33" W. 19.15 feet; Course 21: thence S 89°01'33" W. 28.36 feet; Course 22: thence S 48°04'33" W. 04'33" W. 19.15 feet; Course 23: thence S 38°34'27" W. 59.58 feet; Course 24: thence N 81°00'27" W. 24.55 feet; Course 25: thence S 81°28'33" W. 169.72 feet; Course 26: thence S 63°11'33" W. 42.33 feet; Course 27: thence N 37°02'27" W. 86.40 feet; Course 28: thence S 34°28'33" W. 81.78 feet; Course 29: thence N 44'48" E. 106.50 feet; Course 30: thence S 34°28'33" W. 81.78 feet; Course 31: thence N 89°55'27" W. 44'48" E. 106.50 feet; Course 32: thence N 00°53'33" E. 30 feet; Course 33: thence N 89°55'27" W. 256.66 feet to the center line of S. Roosevelt Ave; Course 34: thence N 00°53'33" E. 30 feet; Course 35: thence N 89°55'27" W. 256.66 feet to the center line of S. Roosevelt Ave; Course 36: thence N 00°53'33" E. 30 feet; Course 37: thence S 89°55'27" W. on the center line of Ross Parkway, 448.48 feet; Course 38: thence S 87°15'24" W. along a curve convex to the NW, radius 1000 feet, a distance of 758.39 feet; Course 39: thence S 46°40'12" W. 670 feet to a point of curve; Course 40: thence S 87°15'24" W. along a curve convex to the SE, radius 700 feet a distance of 543.45 feet; Course 41: thence N 89°55'27" W. 272.88 feet to the SE, radius 700 feet a distance of 543.45 feet; Course 42: thence N 01°12'03" E. on the west line of Sec. 2 aforesaid; 114.40 feet to the NW corner of Sec. 2 aforesaid; Course 43: thence N 00°53'33" E. 30 feet to the west line of Sec. 2 aforesaid; 2701.33 feet more or less to a point of curve; Course 44: thence N 89°55'27" W. 272.88 feet to the NW corner of Sec. 2 aforesaid; Course 45: thence N 89°55'27" W. 272.88 feet to the NW corner of Sec. 2 aforesaid; Course 46: thence N 89°55'27" W. 272.88 feet to the NW corner of Sec. 2 aforesaid; Course 47: thence N 89°55'27" W. 272.88 feet to the NW corner of Sec. 2 aforesaid; Course 48: thence N 89°55'27" W. 272.88 feet to the NW corner of Sec. 2 aforesaid; Course 49: thence N 89°55'27" W. 272.88 feet to the NW corner of Sec. 2 aforesaid; Course 50: thence N 89°55'27" W. 272.88 feet to the NW corner of Sec. 2 aforesaid; Course 51: thence N 89°55'27" W. 272.88 feet to the NW corner of Sec. 2 aforesaid; Course 52: thence N 89°55'27" W. 272.88 feet to the NW corner of Sec. 2 aforesaid; Course 53: thence N 89°55'27" W. 272.88 feet to the NW corner of Sec. 2 aforesaid; Course 54: thence N 89°55'27" W. 272.88 feet to the NW corner of Sec. 2 aforesaid; Course 55: thence N 89°55'27" W. 272.88 feet to the NW corner of Sec. 2 aforesaid; Course 56: thence N 89°55'27" W. 272.88 feet to the NW corner of Sec. 2 aforesaid; Course 57: thence N 89°55'27" W. 272.88 feet to the NW corner of Sec. 2 aforesaid; Course 58: thence N 89°55'27" W. 272.88 feet to the NW corner of Sec. 2 aforesaid; Course 59: thence N 89°55'27" W. 272.88 feet to the NW corner of Sec. 2 aforesaid; Course 60: thence N 89°55'27" W. 272.88 feet to the NW corner of Sec. 2 aforesaid; Course 61: thence N 89°55'27" W. 272.88 feet to the NW corner of Sec. 2 aforesaid; Course 62: thence N 89°55'27" W. 272.88 feet to the NW corner of Sec. 2 aforesaid; Course 63: thence N 89°55'27" W. 272.88 feet to the NW corner of Sec. 2 aforesaid; Course 64: thence N 89°55'27" W. 272.88 feet to the NW corner of Sec. 2 aforesaid; Course 65: thence N 89°55'27" W. 272.88 feet to the NW corner of Sec. 2 aforesaid; Course 66: thence N 89°55'27" W. 272.88 feet to the NW corner of Sec. 2 aforesaid; Course 67: thence N 89°55'27" W. 272.88 feet to the NW corner of Sec. 2 aforesaid; Course 68: thence N 89°55'27" W. 272.88 feet to the NW corner of Sec. 2 aforesaid; Course 69: thence N 89°55'27" W. 272.88 feet to the NW corner of Sec. 2 aforesaid; Course 70: thence N 89°55'27" W. 272.88 feet to the NW corner of Sec. 2 aforesaid; Course 71: thence N 89°55'27" W. 272.88 feet to the NW corner of Sec. 2 aforesaid; Course 72: thence N 89°55'27" W. 272.88 feet to the NW corner of Sec. 2 aforesaid; Course 73: thence N 89°55'27" W. 272.88 feet to the NW corner of Sec. 2 aforesaid; Course 74: thence N 89°55'27" W. 272.88 feet to the NW corner of Sec. 2 aforesaid; Course 75: thence N 89°55'27" W. 272.88 feet to the NW corner of Sec. 2 aforesaid; Course 76: thence N 89°55'27" W. 272.88 feet to the NW corner of Sec. 2 aforesaid; Course 77: thence N 89°55'27" W. 272.88 feet to the NW corner of Sec. 2 aforesaid; Course 78: thence N 89°55'27" W. 272.88 feet to the NW corner of Sec. 2 aforesaid; Course 79: thence N 89°55'27" W. 272.88 feet to the NW corner of Sec. 2 aforesaid; Course 80: thence N 89°55'27" W. 272.88 feet to the NW corner of Sec. 2 aforesaid; Course 81: thence N 89°55'27" W. 272.88 feet to the NW corner of Sec. 2 aforesaid; Course 82: thence N 89°55'27" W. 272.88 feet to the NW corner of Sec. 2 aforesaid; Course 83: thence N 89°55'27" W. 272.88 feet to the NW corner of Sec. 2 aforesaid; Course 84: thence N 89°55'27" W. 272.88 feet to the NW corner of Sec. 2 aforesaid; Course 85: thence N 89°55'27" W. 272.88 feet to the NW corner of Sec. 2 aforesaid; Course 86: thence N 89°55'27" W. 272.88 feet to the NW corner of Sec. 2 aforesaid; Course 87: thence N 89°55'27" W. 272.88 feet to the NW corner of Sec. 2 aforesaid; Course 88: thence N 89°55'27" W. 272.88 feet to the NW corner of Sec. 2 aforesaid; Course 89: thence N 89°55'27" W. 272.88 feet to the NW corner of Sec. 2 aforesaid; Course 90: thence N 89°55'27" W. 272.88 feet to the NW corner of Sec. 2 aforesaid; Course 91: thence N 89°55'27" W. 272.88 feet to the NW corner of Sec. 2 aforesaid; Course 92: thence N 89°55'27" W. 272.88 feet to the NW corner of Sec. 2 aforesaid; Course 93: thence N 89°55'27" W. 272.88 feet to the NW corner of Sec. 2 aforesaid; Course 94: thence N 89°55'27" W. 272.88 feet to the NW corner of Sec. 2 aforesaid; Course 95: thence N 89°55'27" W. 272.88 feet to the NW corner of Sec. 2 aforesaid; Course 96: thence N 89°55'27" W. 272.88 feet to the NW corner of Sec. 2 aforesaid; Course 97: thence N 89°55'27" W. 272.88 feet to the NW corner of Sec. 2 aforesaid; Course 98: thence N 89°55'27" W. 272.88 feet to the NW corner of Sec. 2 aforesaid; Course 99: thence N 89°55'27" W. 272.88 feet to the NW corner of Sec. 2 aforesaid; Course 100: thence N 89°55'27" W. 272.88 feet to the NW corner of Sec. 2 aforesaid; Course 101: thence N 89°55'27" W. 272.88 feet to the NW corner of Sec. 2 aforesaid; Course 102: thence N 89°55'27" W. 272.88 feet to the NW corner of Sec. 2 aforesaid; Course 103: thence N 89°55'27" W. 272.88 feet to the NW corner of Sec. 2 aforesaid; Course 104: thence N 89°55'27" W. 272.88 feet to the NW corner of Sec. 2 aforesaid; Course 105: thence N 89°55'27" W. 272.88 feet to the NW corner of Sec. 2 aforesaid; Course 106: thence N 89°55'27" W. 272.88 feet to the NW corner of Sec. 2 aforesaid; Course 107: thence N 89°55'27" W. 272.88 feet to the NW corner of Sec. 2 aforesaid; Course 108: thence N 89°55'27" W. 272.88 feet to the NW corner of Sec. 2 aforesaid; Course 109: thence N 89°55'27" W. 272.88 feet to the NW corner of Sec. 2 aforesaid; Course 110: thence N 89°55'27" W. 272.88 feet to the NW corner of Sec. 2 aforesaid; Course 111: thence N 89°55'27" W. 272.88 feet to the NW corner of Sec. 2 aforesaid; Course 112: thence N 89°55'27" W. 272.88 feet to the NW corner of Sec. 2 aforesaid; Course 113: thence N 89°55'27" W. 272.88 feet to the NW corner of Sec. 2 aforesaid; Course 114: thence N 89°55'27" W. 272.88 feet to the NW corner of Sec. 2 aforesaid; Course 115: thence N 89°55'27" W. 272.88 feet to the NW corner of Sec. 2 aforesaid; Course 116: thence N 89°55'27" W. 272.88 feet to the NW corner of Sec. 2 aforesaid; Course 117: thence N 89°55'27" W. 272.88 feet to the NW corner of Sec. 2 aforesaid; Course 118: thence N 89°55'27" W. 272.88 feet to the NW corner of Sec. 2 aforesaid; Course 119: thence N 89°55'27" W. 272.88 feet to the NW corner of Sec. 2 aforesaid; Course 120: thence N 89°55'27" W. 272.88 feet to the NW corner of Sec. 2 aforesaid; Course 121: thence N 89°55'27" W. 272.88 feet to the NW corner of Sec. 2 aforesaid; Course 122: thence N 89°55'27" W. 272.88 feet to the NW corner of Sec. 2 aforesaid; Course 123: thence N 89°55'27" W. 272.88 feet to the NW corner of Sec. 2 aforesaid; Course 124: thence N 89°55'27" W. 272.88 feet to the NW corner of Sec. 2 aforesaid; Course 125: thence N 89°55'27" W. 272.88 feet to the NW corner of Sec. 2 aforesaid; Course 126: thence N 89°55'27" W. 272.88 feet to the NW corner of Sec. 2 aforesaid; Course 127: thence N 89°55'27" W. 272.88 feet to the NW corner of Sec. 2 aforesaid; Course 128: thence N 89°55'27" W. 272.88 feet to the NW corner of Sec. 2 aforesaid; Course 129: thence N 89°55'27" W. 272.88 feet to the NW corner of Sec. 2 aforesaid; Course 130: thence N 89°55'27" W. 272.88 feet to the NW corner of Sec. 2 aforesaid; Course 131: thence N 89°55'27" W. 272.88 feet to the NW corner of Sec. 2 aforesaid; Course 132: thence N 89°55'27" W. 272.88 feet to the NW corner of Sec. 2 aforesaid; Course 133: thence N 89°55'27" W. 272.88 feet to the NW corner of Sec. 2 aforesaid; Course 134: thence N 89°55'27" W. 272.88 feet to the NW corner of Sec. 2 aforesaid; Course 135: thence N 89°55'27" W. 272.88 feet to the NW corner of Sec. 2 aforesaid; Course 136: thence N 89°55'27" W. 272.88 feet to the NW corner of Sec. 2 aforesaid; Course 137: thence N 89°55'27" W. 272.88 feet to the NW corner of Sec. 2 aforesaid; Course 138: thence N 89°55'27" W. 272.88 feet to the NW corner of Sec. 2 aforesaid; Course 139: thence N 89°55'27" W. 272.88 feet to the NW corner of Sec. 2 aforesaid; Course 140: thence N 89°55'27" W. 272.88 feet to the NW corner of Sec. 2 aforesaid; Course 141: thence N 89°55'27" W. 272.88 feet to the NW corner of Sec. 2 aforesaid; Course 142: thence N 89°55'27" W. 272.88 feet to the NW corner of Sec. 2 aforesaid; Course 143: thence N 89°55'27" W. 272.88 feet to the NW corner of Sec. 2 aforesaid; Course 144: thence N 89°55'27" W. 272.88 feet to the NW corner of Sec. 2 aforesaid; Course 145: thence N 89°55'27" W. 272.88 feet to the NW corner of Sec. 2 aforesaid; Course 146: thence N 89°55'27" W. 272.88 feet to the NW corner of Sec. 2 aforesaid; Course 147: thence N 89°55'27" W. 272.88 feet to the NW corner of Sec. 2 aforesaid; Course 148: thence N 89°55'27" W. 272.88 feet to the NW corner of Sec. 2 aforesaid; Course 149: thence N 89°55'27" W. 272.88 feet to the NW corner of Sec. 2 aforesaid; Course 150: thence N 89°55'27" W. 272.88 feet to the NW corner of Sec. 2 aforesaid; Course 151: thence N 89°55'27" W. 272.88 feet to the NW corner of Sec. 2 aforesaid; Course 152: thence N 89°55'27" W. 272.88 feet to the NW corner of Sec. 2 aforesaid; Course 153: thence N 89°55'27" W. 272.88 feet to the NW corner of Sec. 2 aforesaid; Course 154: thence N 89°55'27" W. 272.88 feet to the NW corner of Sec. 2 aforesaid; Course 155: thence N 89°55'27" W. 272.88 feet to the NW corner of Sec. 2 aforesaid; Course 156: thence N 89°55'27" W. 272.88 feet to the NW corner of Sec. 2 aforesaid; Course 157: thence N 89°55'27" W. 272.88 feet to the NW corner of Sec. 2 aforesaid; Course 158: thence N 89°55'27" W. 272.88 feet to the NW corner of Sec. 2 aforesaid; Course 159: thence N 89°55'27" W. 272.88 feet to the NW corner of Sec. 2 aforesaid; Course 160: thence N 89°55'27" W. 272.88 feet to the NW corner of Sec. 2 aforesaid; Course 161: thence N 89°55'27" W. 272.88 feet to the NW corner of Sec. 2 aforesaid; Course 162: thence N 89°55'27" W. 272.88 feet to the NW corner of Sec. 2 aforesaid; Course 163: thence N 89°55'27" W. 272.88 feet to the NW corner of Sec. 2 aforesaid; Course 164: thence N 89°55'27" W. 272.88 feet to the NW corner of Sec. 2 aforesaid; Course 165: thence N 89°55'27" W. 272.88 feet to the NW corner of Sec. 2 aforesaid; Course 166: thence N 89°55'27" W. 272.88 feet to the NW corner of Sec. 2 aforesaid; Course 167: thence N 89°55'27" W. 272.88 feet to the NW corner of Sec. 2 aforesaid; Course 168: thence N 89°55'27" W. 272.88 feet to the NW corner of Sec. 2 aforesaid; Course 169: thence N 89°55'27" W. 272.88 feet to the NW corner of Sec. 2 aforesaid; Course 170: thence N 89°55'27" W. 272.88 feet to the NW corner of Sec. 2 aforesaid; Course 171: thence N 89°55'27" W. 272.88 feet to the NW corner of Sec. 2 aforesaid; Course 172: thence N 89°55'27" W. 272.88 feet to the NW corner of Sec. 2 aforesaid; Course 173: thence N 89°55'27" W. 272.88 feet to the NW corner of Sec. 2 aforesaid; Course 174: thence N 89°55'27" W. 272.88 feet to the NW corner of Sec. 2 aforesaid; Course 175: thence N 89°55'27" W. 272.88 feet to the NW corner of Sec. 2 aforesaid; Course 176: thence N 89°55'27" W. 272.88 feet to the NW corner of Sec. 2 aforesaid; Course 177: thence N 89°55'27" W. 272.88 feet to the NW corner of Sec. 2 aforesaid; Course 178: thence N 89°55'27" W. 272.88 feet to the NW corner of Sec. 2 aforesaid; Course 179: thence N 89°55'27" W. 272.88 feet to the NW corner of Sec. 2 aforesaid; Course 180: thence N 89°55'27" W. 272.88 feet to the NW corner of Sec. 2 aforesaid; Course 181: thence N 89°55'27" W. 272.88 feet to the NW corner of Sec. 2 aforesaid; Course 182: thence N 89°55'27" W. 272.88 feet to the NW corner of Sec. 2 aforesaid; Course 183: thence N 89°55'27" W. 272.88 feet to the NW corner of Sec. 2 aforesaid; Course 184: thence N 89°55'27" W. 272.88 feet to the NW corner of Sec. 2 aforesaid; Course 185: thence N 89°55'27" W. 272.88 feet to the NW corner of Sec. 2 aforesaid; Course 186: thence N 89°55'27" W. 272.88 feet to the NW corner of Sec. 2 aforesaid; Course 187: thence N 89°55'27" W. 272.88 feet to the NW corner of Sec. 2 aforesaid; Course 188: thence N 89°55'27" W. 272.88 feet to the NW corner of Sec. 2 aforesaid; Course 189: thence N 89°55'27" W. 272.88 feet to the NW corner of Sec. 2 aforesaid; Course 190: thence N 89°55'27" W. 272.88 feet to the NW corner of Sec. 2 aforesaid; Course 191: thence N 89°55'27" W. 272.88 feet to the NW corner of Sec. 2 aforesaid; Course 192: thence N 89°55'27" W. 272.88 feet to the NW corner of Sec. 2 aforesaid; Course 193: thence N 89°55'27" W. 272.88 feet to the NW corner of Sec. 2 aforesaid; Course 194: thence N 89°55'27" W. 272.88 feet to the NW corner of Sec. 2 aforesaid; Course 195: thence N 89°55'27" W. 272.88 feet to the NW corner of Sec. 2 aforesaid; Course 196: thence N 89°55'27" W. 272.88 feet to the NW corner of Sec. 2 aforesaid; Course 197: thence N 89°55'27" W. 272.88 feet to the NW corner of Sec. 2 aforesaid; Course 198: thence N 89°55'27" W. 272.88 feet to the NW corner of Sec. 2 aforesaid; Course 199: thence N 89°55'27" W. 272.88 feet to the NW corner of Sec. 2 aforesaid; Course 200: thence N 89°55'27" W. 272.88 feet to the NW corner of Sec. 2 aforesaid; Course 201: thence N 89°55'27" W. 272.88 feet to the NW corner of Sec. 2 aforesaid; Course 202: thence N 89°55'27" W. 272.88 feet to the NW corner of Sec. 2 aforesaid; Course 203: thence N 89°55'27" W. 272.88 feet to the NW corner of Sec. 2 aforesaid; Course 204: thence N 89°55'27" W. 272.88 feet to the NW corner of Sec. 2 aforesaid; Course 205: thence N 89°55'27" W. 272.88 feet to the NW corner of Sec. 2 aforesaid; Course 206: thence N 89°55'27" W. 272.88 feet to the NW corner of Sec. 2 aforesaid; Course 207: thence N 89°55'27" W. 272.88 feet to the NW corner of Sec. 2 aforesaid; Course 208: thence N 89°55'27" W. 272.88 feet to the NW corner of Sec. 2 aforesaid; Course 209: thence N 89°55'27" W. 272.88 feet to the NW corner of Sec. 2 aforesaid; Course 210: thence N 89°55'27" W. 272.88 feet to the NW corner of Sec. 2 aforesaid; Course 211: thence N 89°55'27" W. 272.88 feet to the NW corner of Sec. 2 aforesaid; Course 212: thence N 89°55'27" W. 272.88 feet to the NW corner of Sec. 2 aforesaid; Course 213: thence N 89°55'27" W. 272.88 feet to the NW corner of Sec. 2 aforesaid; Course 214: thence N 89°55'27" W. 272.88 feet to the NW corner of Sec. 2 aforesaid; Course 215: thence N 89°55'27" W. 272.88 feet to the NW corner of Sec. 2 aforesaid; Course 216: thence N 89°55'27" W. 272.88 feet to the NW corner of Sec. 2 aforesaid; Course 217: thence N 89°55'27" W. 272.88 feet to the NW corner of Sec. 2 aforesaid; Course 218: thence N 89°55'27" W. 272.88 feet to the NW corner of Sec. 2 aforesaid; Course 219: thence N 89°55'27" W. 272.88 feet to the NW corner of Sec. 2 aforesaid; Course 220: thence N 89°55'27" W. 272.88 feet to the NW corner of Sec. 2 aforesaid; Course 221: thence N 89°55'27" W. 272.88 feet to the NW corner of Sec. 2 aforesaid; Course 222: thence N 89°55'27" W. 272.88 feet to the NW corner of Sec. 2 aforesaid; Course 223: thence N 89°55'27" W. 272.88 feet to the NW corner of Sec. 2 aforesaid; Course 224: thence N 89°55'27" W. 272.88 feet to the NW corner of Sec. 2 aforesaid; Course 225: thence N 89°55'27" W. 272.88 feet to the NW corner of Sec. 2 aforesaid; Course 226: thence N 89°55'27" W. 272.88 feet to the NW corner of Sec. 2 aforesaid; Course 227: thence N 89°55'27" W. 272.88 feet to the NW corner of Sec. 2 aforesaid; Course 228: thence N 89°55'27" W. 272.88 feet to the NW corner of Sec. 2 aforesaid; Course 229: thence N 89°55'27" W. 272.88 feet to the NW corner of Sec. 2 aforesaid; Course 230: thence N 89°55'27" W. 272.88 feet to the NW corner of Sec. 2 aforesaid; Course 231: thence N 89°55'27" W. 272.88 feet to the NW corner of Sec. 2 aforesaid; Course 232: thence N 89°55'27" W. 272.88 feet to the NW corner of Sec. 2 aforesaid; Course 233: thence N 89°55'27" W. 272.88 feet to the NW corner of Sec. 2 aforesaid; Course 234: thence N 89°55'27" W. 272.88 feet to the NW corner of Sec. 2 aforesaid; Course 235: thence N 89°55'27" W. 272.88 feet to the NW corner of Sec. 2 aforesaid; Course 236: thence N 89°55'27" W. 272.88 feet to the NW corner of Sec. 2 aforesaid; Course 237: thence N 89°55'27" W. 272.88 feet to the NW corner of Sec. 2 aforesaid; Course 238: thence N 89°55'27" W. 272.88 feet to the NW corner of Sec. 2 aforesaid; Course 239: thence N 89°55'27" W. 272.88 feet to the NW corner of Sec. 2 aforesaid; Course 240: thence N 89°55'27" W. 272.88 feet to the NW corner of Sec. 2 aforesaid; Course 241: thence N 89°55'27" W. 272.88 feet to the NW corner of Sec. 2 aforesaid; Course 242: thence N 89°55'27" W. 272.88 feet to the NW corner of Sec. 2 aforesaid; Course 243: thence N 89°55'27" W. 272.88 feet to the NW corner of Sec. 2 aforesaid; Course 244: thence N 89°55'27" W. 272.88 feet to the NW corner of Sec. 2 aforesaid; Course 245: thence N 89°55'27" W. 272.88 feet to the NW corner of Sec. 2 aforesaid; Course 246: thence N 89°55'27" W. 272.88 feet to the NW corner of Sec. 2 aforesaid; Course 247: thence N 89°55'27" W. 272.88 feet to the NW corner of Sec. 2 aforesaid; Course 248: thence N 89°55'27" W. 272.88 feet to the NW corner of Sec. 2 aforesaid; Course 249: thence N 89°55'27" W. 272.88 feet to the NW corner of Sec. 2 aforesaid; Course 250: thence N 89°55'27" W. 272.88 feet to the NW corner of Sec. 2 aforesaid; Course 251: thence N 89°55'27" W. 272.88 feet to the NW corner of Sec. 2 aforesaid; Course 252: thence N 89°55'27" W. 272.88 feet to the NW corner of Sec. 2 aforesaid; Course 253: thence N 89°55'27" W. 272.88 feet to the NW corner of Sec. 2 aforesaid; Course 254: thence N 89°55'27" W. 272.88 feet to the NW corner of Sec. 2 aforesaid; Course 255: thence N 89°55'27" W. 272.