

**GENERAL NOTES:**

- The Contractor shall comply with all applicable safety regulations. All construction shall be completed following current City Standard Specifications and Special Provisions.
- Contractor will be required to provide notice to utility companies a minimum of seventy-two (72) hours prior to any excavation, as follows:  
  
Kansas One-Call 687-2470  
  
The Contractor must notify the following in case of an emergency:  
  
AT&T 1-800-246-8464  
Black Hills Energy 1-800-694-8989  
City of Wichita Water & Sewer Dept. 1-316-219-8921  
City of Wichita Stormwater 1-316-268-4090  
City of Wichita Traffic 1-316-268-4034  
Cox Communications 1-888-249-3530  
Eergy 1-800-544-4857  
Kansas Gas Service 1-888-482-4950
- Utility service lines, poles, etc. are to be adjusted as necessary by others prior to construction unless the plans specifically call for their adjustment by the Contractor or unless the plans specifically identify a utility to be adjusted by its owner during construction. Existing utilities and their location, as shown on the plans, represent the best information obtainable for design. The Contractor will be required to work around existing utilities within the right-of-way which do not conflict with proposed construction.
- Rubble from the removal of miscellaneous structures and excess excavation which is to be wasted shall be disposed of on sites to be provided by the Contractor. These sites shall be approved by the Engineer as to suitability, appearance and site location. Locations, in the opinion of the Engineer, that will leave an unsightly appearance will not be approved. All disposal sites must be approved by the Kansas Department of Health and Environment. Material either stockpiled or disposed of in a flood plain will require a Kansas State Board of Agriculture permit. Any material dumped in waters of the United States or wetlands is subject to U.S. Corps. of Engineers permitting regulations. Any material buried or stockpiled beyond approved construction limits will require additional archaeological investigations unless buried in a previously approved borrow location.
- Trees and shrubs in public right-of-way which are in direct conflict with proposed new construction shall be removed by the Contractor with the Engineer's approval. Trees and shrubs which are not in direct conflict with proposed new construction shall be saved and protected from damage.
- The Contractor shall give all property owners and/or tenants of developed property abutting the construction of this project a minimum of ten (10) days notice prior to start of construction.
- The Contractor shall be responsible for preserving property irons. The Contractor will be required to re-establish any property irons which are damaged or destroyed by his construction operations. Such irons shall be re-established by a licensed land surveyor in accordance with state laws.
- The Water Distribution Division shall field locate water valves one time during construction when requested by the Contractor. It shall be the Contractor's responsibility to preserve such field locations during the construction process. Water valves, valve boxes or fire hydrants damaged during construction shall be repaired by Contractor at his own expense. Valve boxes and water meters within the project limits shall be adjusted to match field grades.
- The Contractor shall notify the consultant engineer and Tom Mason at 316-268-4574 with the City of Wichita with the anticipated construction start date and notify them of project completion. Staking and inspection for this project will be the responsibility of the Contractor.
- If traffic will be impacted by construction, a traffic control plan must be submitted and approved by the City Traffic Engineer, at [traffic@wichita.gov](mailto:traffic@wichita.gov) before construction can begin. The Contractor shall be responsible for all traffic control measures to facilitate construction. All construction zone markings and signage shall conform to the latest version of the Manual on Uniform Traffic Control Devices (MUTCD) as published by the US Dept. of Transportation, Federal Highway Administration. All costs associated with construction markings and signage shall be the Contractors responsibly.

- All elevations shown are NAVD 88.
- All areas disturbed during construction that will not be under proposed pavement shall be restored to match existing conditions.
- All stubs and plugged pipes shall be located with green plastic tape in the same manner as risers.
- Connecting to Existing Manholes:  
  
Prior to laying sewer lines using existing stubs in existing manholes, the Contractor shall expose and verify the elevation, grade and alignment of existing stubs and notify the Engineer of any deviation from the plans. Where connection to an existing manhole that does not have an existing stub or the stub is unusable due to elevation grade or alignment, the Contractor shall bore cut into existing manhole wall to make connection using approved water stop gasket, and reshape the existing manhole invert to provide smooth flow. The cost to connecting to existing manholes is incidental to the project.
- Contractor shall limit the extent of trench openings overnight and weekends to less than 50 feet.
- Contractor shall provide positive drainage away from all manhole covers.
- The Contractor shall prevent any construction debris from entering the existing sanitary sewer during construction.
- The Contractor shall be responsible for maintaining continuous flow of sewage through construction. Contractors proposed method for maintaining sewage flow shall be submitted and approved by the Sewer Maintenance Division (316-268-4073) prior to starting and by-passing of sewage flows.
- Any over excavation from manhole and/or pipe removal shall be backfilled and compacted in accordance with the Standard Specifications.
- City Maintenance of sanitary sewer mains ends at right-of-way or easement line.
- Any sidewalk, drive approach, curb, or street pavement removed to construct project must have a pavement cut permit and be replaced by the City contractor. Permits can be obtained by calling 316-268-4501 or 316-268-4480.
- The Contractor shall protect from damage and support existing utilities through constructions as approved by the utility owner and the Engineer at the contractors expense.
- No shrink or swell factors have been applied to the earthwork quantities shown on this project. All earthwork quantities are based on raw surface volume comparisons.
- Excess dirt generated from installation of underground utilities is to remain on site and be distributed around the grass area northwest of the Taxilane A-3 Extension.
- Contractor shall contact Dawnita Reinhardt with the City of Wichita prior to the start of construction.

**Benchmarks**

BENCHMARK:  
POINT #1  
CAPPED REBAR IN GRASS EAST OF NORTH JABARA ROAD, USED FOR COLLECTING STATIC DATA  
ELEVATION = 1424.56 (NAVD88)

BENCHMARK:  
POINT #2  
CHISELED SQUARE WITH DIVOT ON THE TOP OF CURB, EAST SIDE OF NORTH WEBB ROAD  
ELEVATION = 1427.29 (NAVD88)

# SANITARY SEWER EXTENSION to serve COL. JAMES JABARA AIRPORT CITY OF WICHITA, KANSAS

Gary Janzen, P.E. City Engineer  
Project Number A1001  
2021-009447 PPS (53030982)

*D. Reinhardt - City of Wichita, Inspector  
Release Date: 10/6/2021  
: apr 10/7/2021*

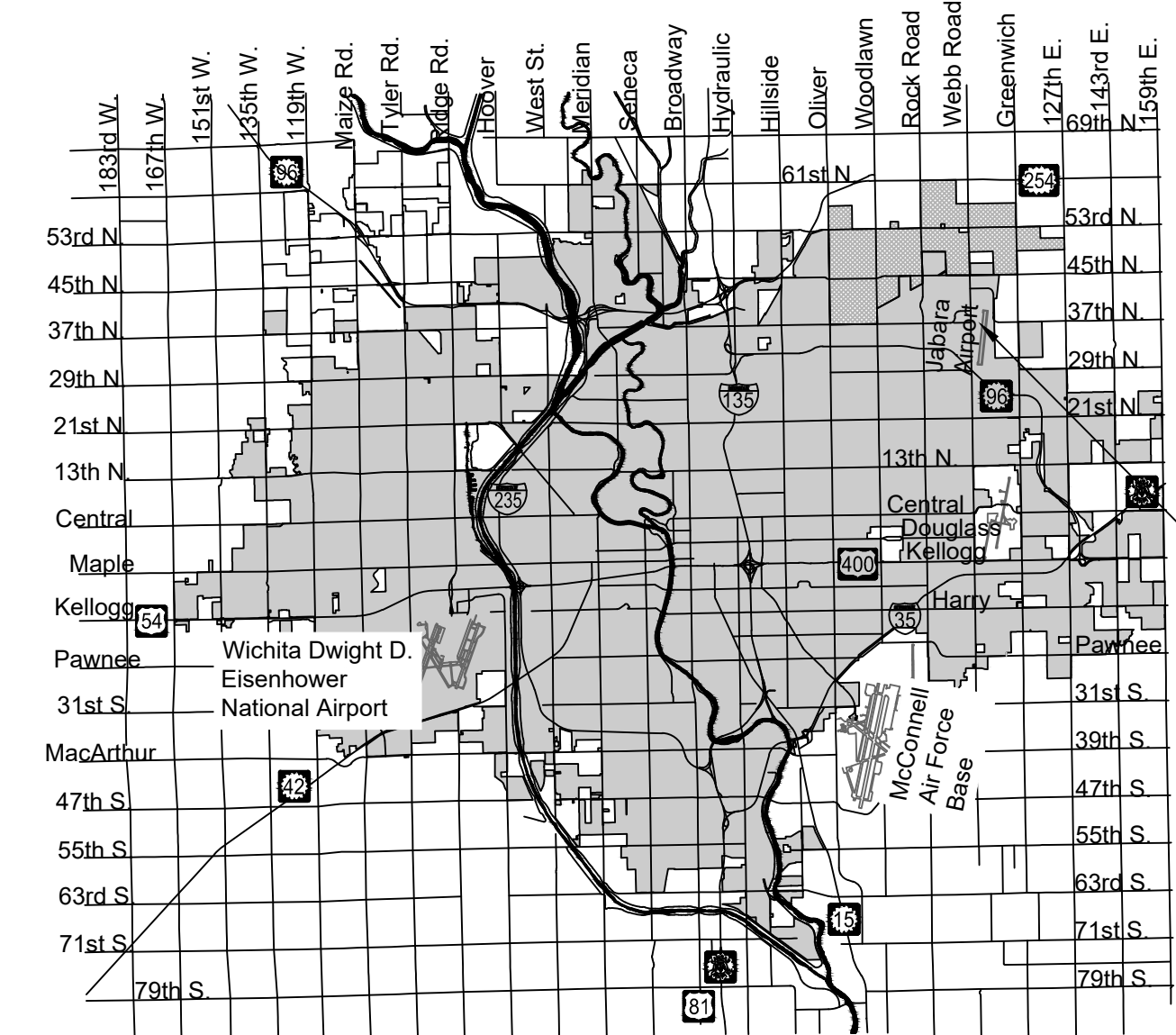

**PROJECT LOCATION**

Vicinity Map

**Sheet Index**

- TITLE SHEET
- SANITARY SEWER PLAN AND PROFILE
- SANITARY SEWER DETAILS I
- SANITARY SEWER DETAILS II
- EROSION CONTROL PLAN
- 10. EROSION CONTROL DETAILS

APPROVED AS NOTED  
BY WICHITA PUBLIC WORKS  
ENGINEERING DIVISION

Engineering Shawn Mellies 03/31/2021  
  
Utilities \_\_\_\_\_

**NOTE TO CONTRACTORS**

Installation, inspection and testing for this project is to be provided by a Licensed Consulting Engineering Firm under contract with the Owner/Developer. Said Inspection to be in accordance with the City of Wichita standard construction engineering practices and certified by a Licensed Professional Engineer in the state of Kansas. No work shall be performed by the Contractor without such inspection nor shall any work be commenced without written authorization by the City Engineering. All Construction and Materials shall comply with the current City of Wichita Specifications and Standards and Special Provisions. (on file and available at [Wichita.gov](http://Wichita.gov)).

An approved copy of these plans signed by City staff are required on-site.

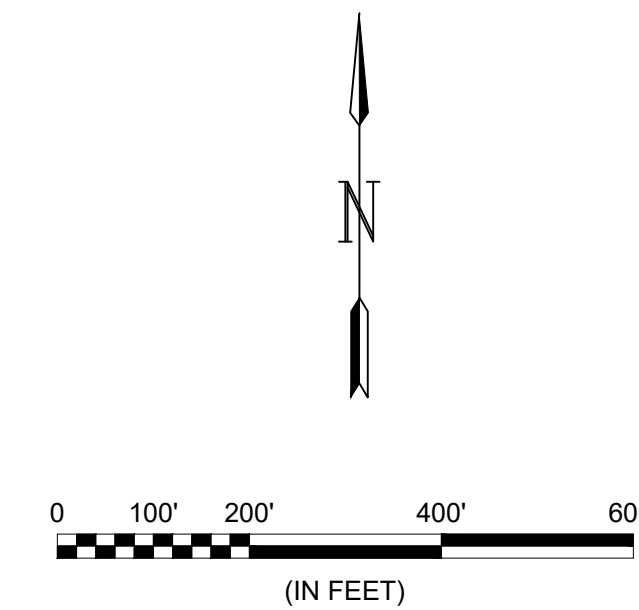

**IMPROVEMENT AREA**

**RECORD DRAWINGS**  
Client: City of Wichita  
Contractor: Pearson Construction  
Superintendent: Steve Trotter  
Inspector: Levi C. Turner  
Inspection Firm: Garver  
Final Completion: 9/17/2021

**MARCH 2021**

PLANS PREPARED BY



GARVER  
1995 Midfield Road  
Wichita, KS 67209  
(316) 264-8008  
[www.GarverUSA.com](http://www.GarverUSA.com)  
Project No. 19A17000

NOTE: All coordinates listed are modified NAD83 Kansas State Plane Zone South unless otherwise noted. To convert listed coordinates to NAD83 Kansas State Plane Zone South coordinates multiply the northing and easting by the project scale factor of 0.99987868. Elevation datum is NAVD88 Geoid 12B unless otherwise noted.



© 2021 GARVER, LLC  
 THIS DOCUMENT, ALONG WITH THE IDEAS AND DESIGNS CONVEYED HEREIN, SHALL BE CONSIDERED INSTRUMENTS OF PROFESSIONAL SERVICE AND ARE PROPERTY OF GARVER, LLC. ANY USE, REPRODUCTION, OR DISTRIBUTION OF THIS DOCUMENT, ALONG WITH THE IDEAS AND DESIGN CONTAINED HEREIN, IS PROHIBITED UNLESS AUTHORIZED IN WRITING BY GARVER, LLC OR EXPLICITLY ALLOWED IN THE GOVERNING PROFESSIONAL SERVICES AGREEMENT FOR THIS WORK.

1995 Midfield Rd.  
 Wichita, KS 67209  
 (316) 264-8008

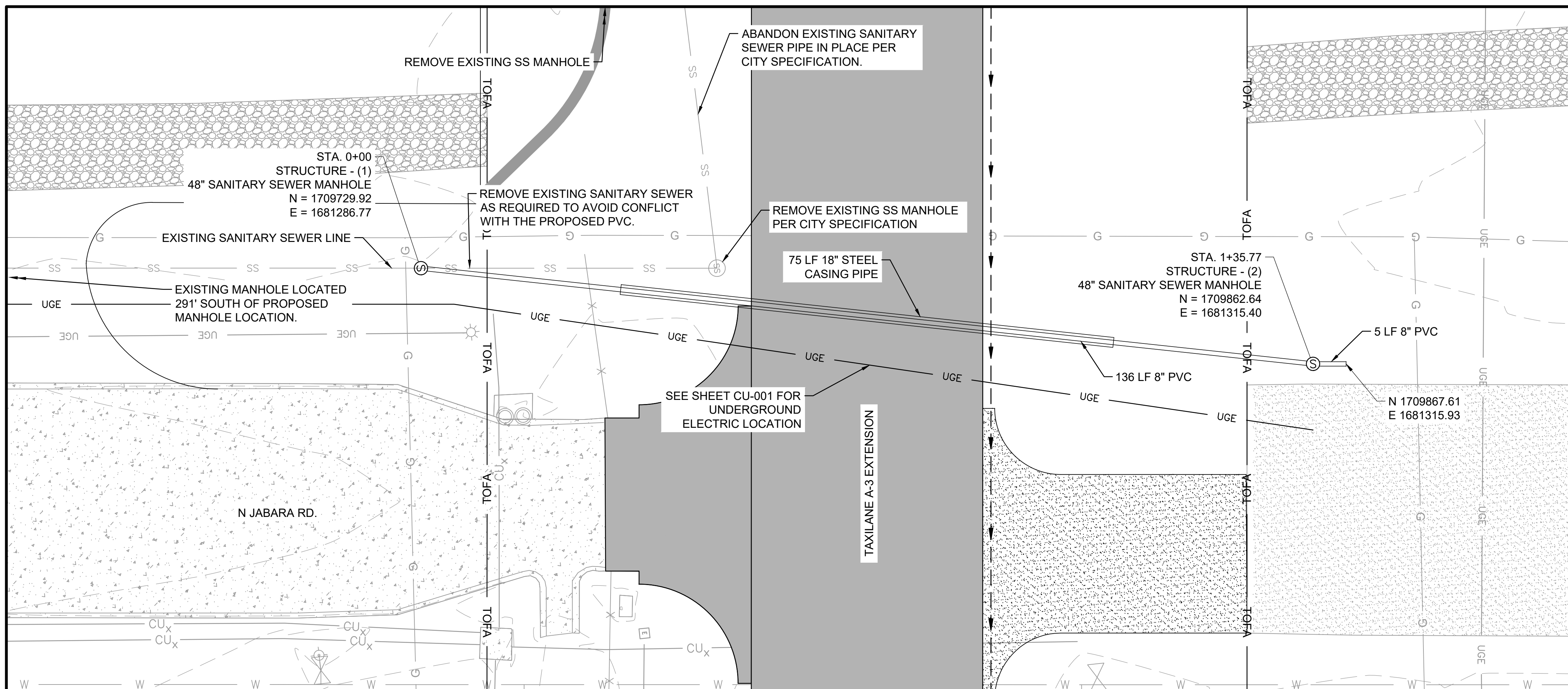
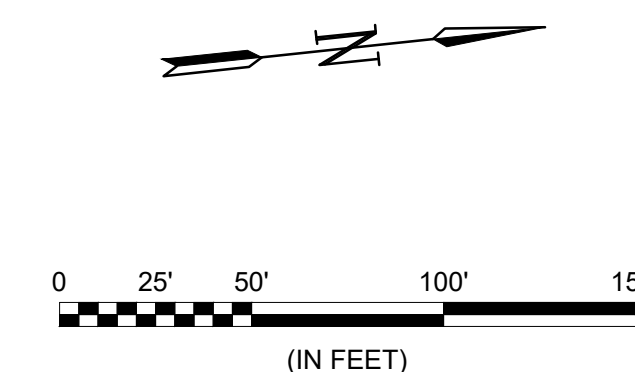

LEGEND	
TOFA	TAXIWAY OBJECT FREE AREA
PROPOSED SANITARY SEWER LINE	PROPOSED SANITARY SEWER LINE
PROPOSED SANITARY SEWER MANHOLE	PROPOSED SANITARY SEWER MANHOLE
PROPOSED CONCRETE PAVEMENT	PROPOSED CONCRETE PAVEMENT
EXISTING CONCRETE PAVEMENT	EXISTING CONCRETE PAVEMENT
PROPOSED ASPHALT PAVEMENT	PROPOSED ASPHALT PAVEMENT
EXISTING ASPHALT PAVEMENT	EXISTING ASPHALT PAVEMENT
EXISTING GRAVEL PATH	EXISTING GRAVEL PATH
EXISTING FENCE	EXISTING FENCE
EXISTING INLET/MANHOLE	EXISTING INLET/MANHOLE
EXISTING STORM SEWER	EXISTING STORM SEWER
PROPOSED UNDERDRAIN	PROPOSED UNDERDRAIN
EXISTING UNDERDRAIN	EXISTING UNDERDRAIN
EXISTING SANITARY SEWER	EXISTING SANITARY SEWER
EXISTING WATER LINE	EXISTING WATER LINE
EXISTING UNDERGROUND ELECTRIC	EXISTING UNDERGROUND ELECTRIC
EXISTING UNDERGROUND COMMUNICATION	EXISTING UNDERGROUND COMMUNICATION
EXISTING UNDERGROUND GAS LINE	EXISTING UNDERGROUND GAS LINE

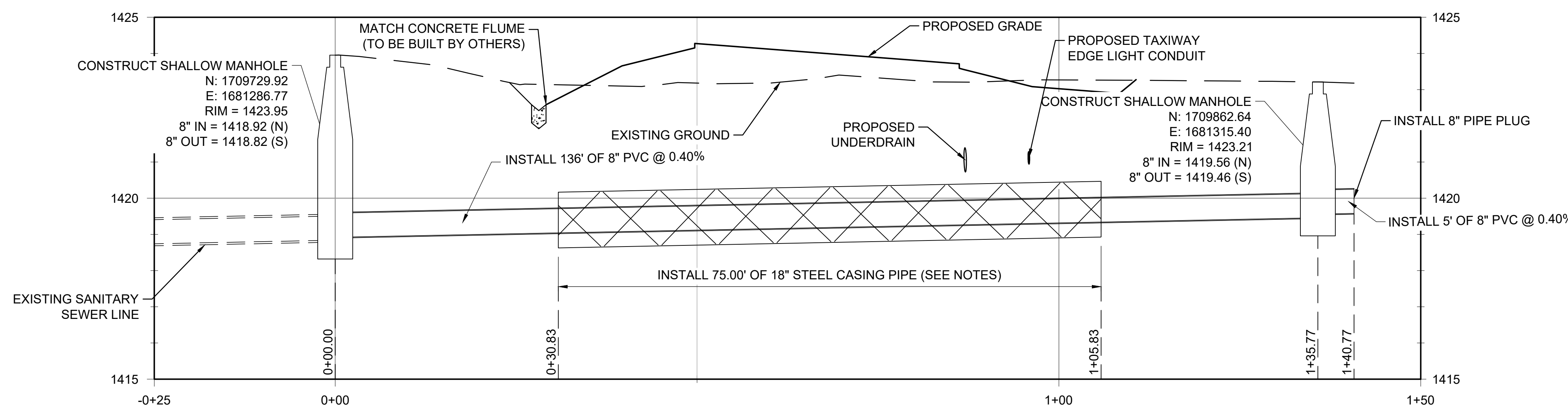

- NOTES:
- CONTRACTOR TO PROVIDE APPROPRIATE END SEALS AND CASING SPACERS. THOSE ITEMS SHALL BE SUBSIDIARY TO THE STEEL CASING.
  - CASING TO BE 18" DIAMETER SMOOTH STEEL CASING WITH A WALL THICKNESS OF 1/4" (0.250"). CASING MATERIALS AND INSTALLATION SHALL BE IN ACCORDANCE WITH CITY OF WICHITA STANDARD SPECIFICATION 802.
  - THE ANNULAR SPACE BETWEEN THE STEEL CASING AND THE CARRYING PIPE SHALL NOT BE FILLED WITH SAND.
  - PIPE BEDDING FOR BOTH PVC SEWER AND STEEL CASING PIPE SHALL BE TYPE I (ASTM C-33, GRADATION NO. 67) UP TO 12" ABOVE THE TOP OF THE PIPE/CASING.

**RECORD DRAWINGS**  
 Client: City of Wichita  
 Contractor: Pearson Construction  
 Superintendent: Steve Trotter  
 Inspector: Levi C. Turner  
 Inspection Firm: Garver  
 Final Completion: 9/17/2021

REV.	DATE	DESCRIPTION	BY



COLONEL JAMES JABARA AIRPORT  
 WICHITA, KS

TAXILANE A-3 EXTENSION

UTILITY RELOCATION - SANITARY SEWER

JOB NO.: 19A17000  
 DATE: MARCH 2021  
 DESIGNED BY: CRC  
 DRAWN BY: CGB

BAR IS ONE INCH ON ORIGINAL DRAWING  
 IF NOT ONE INCH ON THIS SHEET, ADJUST SCALES ACCORDINGLY.

DRAWING NUMBER  
**CU-002**

SHEET NUMBER  
**2**

File: L:\2019\19A17000 - AAO Taxiway A-3 Extension\Drawings\AAO\_TWA-3\_EXT-CU-002.dwg, Last Save: 3/25/2021 10:35 AM, Last saved by: CGBohm  
 Last plotted by: Bohm, Christian G. (Gunnar), Plot Style: ---, Plot Scale: 1:2,59459, Plot Date: 3/25/2021 10:35 AM, Plotter used: None