

SCALE:

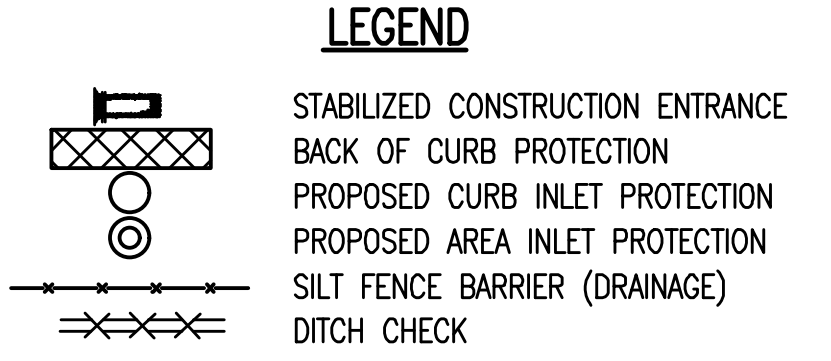
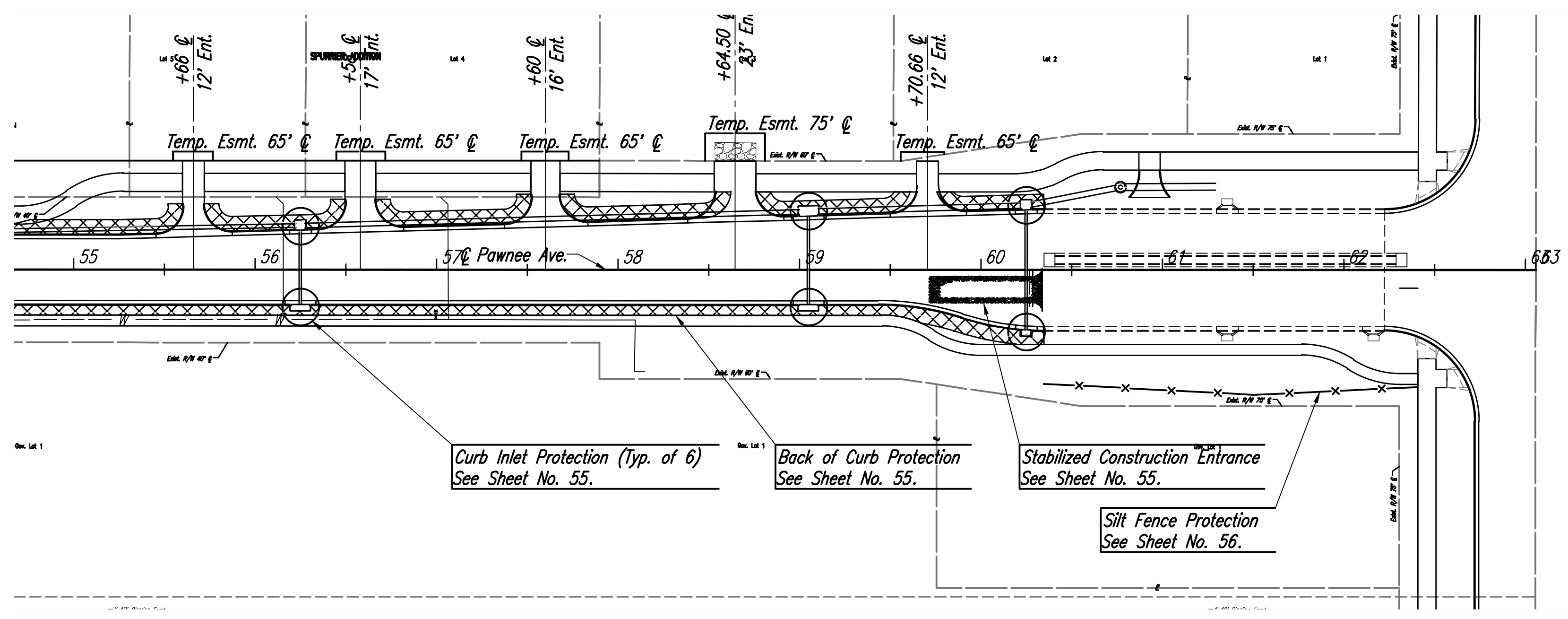
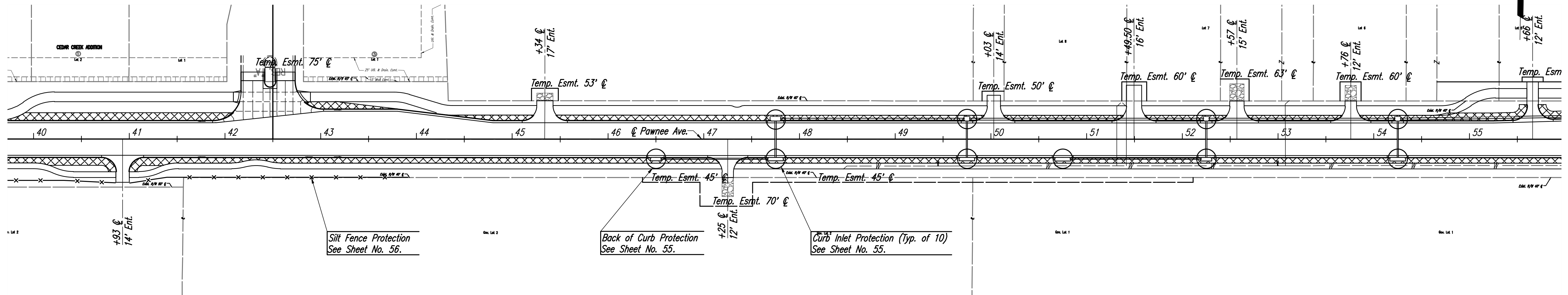

**LEGEND**

- STABILIZED CONSTRUCTION ENTRANCE
- BACK OF CURB PROTECTION
- PROPOSED CURB INLET PROTECTION
- PROPOSED AREA INLET PROTECTION
- SILT FENCE BARRIER (DRAINAGE)
- DITCH CHECK

**SEEDING NOTES**

TEMPORARY PROJECT SEEDING: CONTRACTOR SHALL APPLY TEMPORARY SEED AND MULCH TO ALL GRASSED AREA DISTURBED BY CONSTRUCTION ACTIVITIES, EXCEPT AS NOTED BELOW. SEED SHALL BE ANNUAL RYE APPLIED PER SPECIFICATIONS.

TEMPORARY SEEDING SHALL BE APPLIED WITHIN 14 DAYS AFTER THE AREA TO BE SEEDDED HAS BEEN DISTURBED. TEMPORARY SEEDING MAY BE OMITTED IN AREAS WHERE PERMANENT SEEDING IS REQUIRED AND IS IN SEASON FOR IMMEDIATE PLANTING.

PERMANENT PROJECT SEEDING: CONTRACTOR SHALL APPLY SEED, FERTILIZER, AND MULCH TO ALL GRASSED AREA DISTURBED BY CONSTRUCTION ACTIVITIES. SEED SHALL BE BUFFALO GRASS APPLIED PER SPECIFICATIONS.

**SEEDING QUANTITIES (FOR INFORMATION ONLY)**

TEMPORARY SEEDING	5.2 - ACRES
BUFFALO SOD	15,330 - S.Y.
BUFFALO SEED	9,651 - S.Y.

**GENERAL NOTES**

- CONTRACTOR SHALL INSTALL AND MAINTAIN EROSION PROTECTION THROUGHOUT THE ENTIRE PROJECT. THE FOLLOWING QUANTITIES ARE PROVIDED FOR INFORMATION ONLY:  

PAWNEE AVENUE PAVING INCIDENTAL DRAINAGE (31-171395-001):	
CURB INLET PROTECTION	46 EACH
AREA INLET PROTECTION	4 EACH
BACK OF CURB PROTECTION	8,912 L.F.
SILT FENCE BARRIER	2,282 L.F.
CONSTRUCTION ENTRANCE	2 EACH
DITCH CHECK	8 EACH
- THE EROSION CONTROL DEVICES SHOWN ON THIS SHEET ARE CONSIDERED MINIMUM STANDARDS. WHENEVER SEDIMENT ENTERS THE STREETS, STORM SEWERS, DITCHES, OR PONDS, CONTRACTOR WILL INSTALL ADDITIONAL DEVICES, AS NEEDED, TO CORRECT THE PROBLEM.
- THE EROSION CONTROL DEVICES SHOWN HEREON MUST BE IN PLACE AT ALL TIMES DURING CONSTRUCTION UNTIL SUCH TIME AS THE SITE IS REESTABLISHED WITH PAVING OR GRASS. TEMPORARY OR PERMANENT SEEDING AND MULCH WILL BE INSTALLED WHEN EARTHWORK ACTIVITIES CEASE IN AN AREA FOR 14 DAYS OR MORE.
- ANY MUD INADVERTENTLY TRACKED ONTO ANY STREET SHALL BE CLEANED UP BY THE CONTRACTOR, AT THE END OF EACH DAY'S WORK, OR AS DIRECTED BY THE FIELD ENGINEER.
- CONTRACTOR TO FURNISH A TRUCK WASH-OUT PIT TO BE PLACED AT A CONVENIENT LOCATION THAT DOES NOT CONFLICT WITH CONSTRUCTION. CONTRACTOR SHALL CLEAN OUT AND BACKFILL PIT PRIOR TO FINAL INSPECTION. LOCATION SHALL BE APPROVED BY THE FIELD ENGINEER.

Saved: 08-04-2021 3:04:16 PM by: BILL SEASON  
Plot Scale: 1:1 08-04-2021 3:17:59 PM by: BJS  
U:\wchita-civil\2017\171395\001\muni-rems\Drawings\171395-001-54C-EROSION CONTROL PLAN

Revised Seeding Quantities		RJS	08-04-21
No.	Revision	By	Date
PAWNEE AVENUE FROM WEBB TO GREENWICH PAVING AND INCIDENTAL DRAINAGE IMPROVEMENTS			
<b>EROSION CONTROL PLAN</b>			
GARY JANZEN, P.E.-CITY ENGINEER CITY OF WICHITA PROJECT NO. 472-85434			
		PROFESSIONAL ENGINEERING CONSULTANTS, P.A. 303 SOUTH TOPEKA WICHITA, KS 67202 316-262-2891 www.pec1.com	
Designed by	RJS	Job No.	171395-002
Drawn by	BJS, CP	Date	APRIL 2021
			Sht. 54 of 134