

N: 1672906.1206, E: 1681605.1650
 PAWNEE STREET, STA. 14+93.12
 REPLACE EXISTING FIRE HYDRANT PER
 CITY STANDARDS.
 EXISTING TEE AND VALVE TO REMAIN.
 L= 4'
 TOP VALVE BOX EL.= 1387.1
 FH BURY LINE EL.= 1386.3

WATER SERVICE LINE RECONNECTION (TYPICAL)
 SEE DETAIL AND SCHEDULE, SHEET NO. 13

N: 1672914.9956, E: 1682142.2527
 PAWNEE STREET, Sta. 20+30.28
 REPLACE EXISTING FIRE HYDRANT PER
 CITY STANDARDS.
 EXISTING TEE AND VALVE TO REMAIN.
 L= 4'
 Top Valve Box El.= 1386.6
 FH Bury Line El.= 1385.7

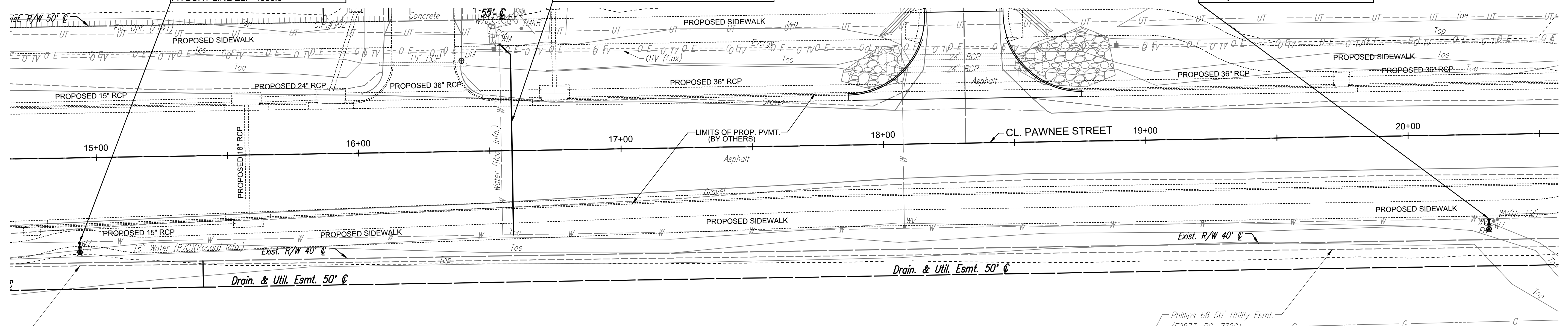

Saved: 04-09-2021 2:26:30 PM by KUPRISDEKAT
 Plot Scale: 1:1 07-07-2021 11:27:09 AM by BJS
 U:\Wichita-Civil\2017\171395-004\Drawings\171395-004-G-WATER SERVICE AND FIRE HYDRANT REPLACEMENT

No.	Revision	By	Date
PAWNEE AVENUE FROM WEBB TO GREENWICH PAVING AND INCIDENTAL DRAINAGE IMPROVEMENTS WL SERV. & FIRE HYD. REPLACEMENT GARY JANZEN, P.E.—CITY ENGINEER CITY OF WICHITA PROJECT NO. 472-85434			
		PEC PROFESSIONAL ENGINEERING CONSULTANTS, P.A. 303 SOUTH TOPEKA WICHITA, KS 67202 316-262-2891 www.pec1.com	
Designed by	TBK	Job No.	171395-004
Drawn by	KTD	Date	JANUARY 2021
			Sht. 6 of 15