

TREE STATIONING

STATION	NAME	OFFSET
5+73	Oklahoma Redbud	70' RT
5+79	Oklahoma Redbud	68' RT
5+87	Oklahoma Redbud	69' RT
5+94	Canaert Juniper	67' RT
6+02	Canaert Juniper	67' RT
6+08	Canaert Juniper	70' RT
6+14	Canaert Juniper	70' RT
6+22	Canaert Juniper	68' RT
6+29	Canaert Juniper	70' RT
6+37	Prairiefire Crabapple	69' RT
6+44	Prairiefire Crabapple	71' RT
6+53	Prairiefire Crabapple	69' RT
6+69	River Birch	68' RT
6+89	River Birch	73' RT
7+04	Bald Cypress	153' RT
7+12	River Birch	69' RT
7+21	Ivory Silk Lilac Tree	152' RT

TREE STATIONING

STATION	NAME	OFFSET
7+28	Ivory Silk Lilac Tree	149' RT
7+35	Ivory Silk Lilac Tree	152' RT
7+51	Winter King Hawthorn	153' RT
7+69	Winter King Hawthorn	148' RT
7+87	Winter King Hawthorn	150' RT
8+10	Bald Cypress	151' RT
8+38	Winterberry Euonymus	57' RT
8+48	Winterberry Euonymus	55' RT
8+56	Thornless Cockspur Hawthorn	53' RT
8+57	Southwestern White Pine	25' RT
8+65	Thornless Cockspur Hawthorn	52' RT
8+72	Thornless Cockspur Hawthorn	57' RT
8+73	Southwestern White Pine	10' RT
8+95	Southwestern White Pine	21' RT
9+11	Imperial Honeylocust	28' LT
9+90	Skyline Honeylocust	80' RT
10+12	Skyline Honeylocust	81' RT

TREE STATIONING

STATION	NAME	OFFSET
10+32	Skyline Honeylocust	79' RT
10+34	Imperial Honeylocust	12' RT
10+35	Oklahoma Redbud	8' RT
10+44	Oklahoma Redbud	12' RT
10+58	Oklahoma Redbud	12' RT
10+66	Oklahoma Redbud	14' RT

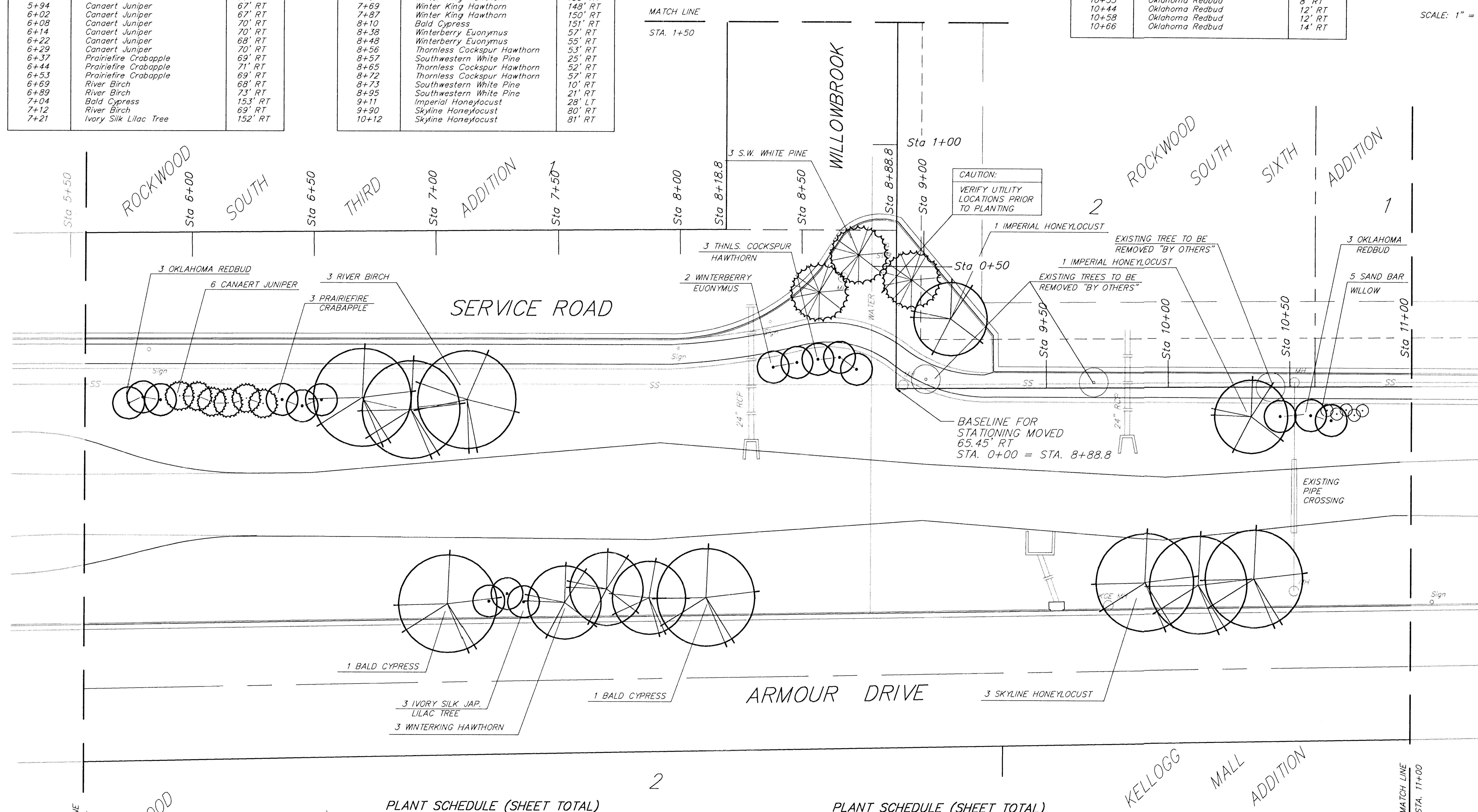
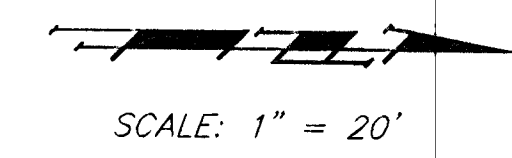

PLANT SCHEDULE (SHEET TOTAL)

QTY.	BOTANICAL NAME	COMMON NAME
3	<i>Betula nigra</i> 'Heritage'	River Birch
2	<i>Gleditsia triacanthos</i> var. <i>inermis</i> 'Imperial'	Imperial Honeylocust
3	<i>Gleditsia triacanthos</i> var. <i>inermis</i> 'Skyline'	Skyline Honeylocust
2	<i>Taxodium distichum</i>	Bald Cypress
6	<i>Juniperus virginiana</i> 'Canaert'	Canaert Juniper
3	<i>Pinus strobiformis</i>	Southwestern White Pine

PLANT SCHEDULE (SHEET TOTAL)

QTY.	BOTANICAL NAME	COMMON NAME
6	<i>Cercis reniformis</i> 'Oklahoma'	Oklahoma Redbud
3	<i>Crataegus crusgalli</i> var. <i>inermis</i>	Thornless Cockspur Hawthorn
3	<i>Crataegus viridis</i> 'Winter King'	Winter King Hawthorn
2	<i>Euonymus bungeanus</i>	Winterberry Euonymus
3	<i>Malus</i> 'Prairiefire'	Prairiefire Crabapple
3	<i>Syringa reticulata</i> 'Ivory Silk'	Ivory Silk Tree Lilac
5	<i>Salix interior</i>	Sandbar Willow

GYPSUM CREEK BICYCLE PATH
LANDSCAPE PLAN
 STATION 5+58 TO 11+00

BAUGHMAN COMPANY P. A.
 ENGINEERING, SURVEYING, & PLANNING
 316-262-7271 • 315 ELLIS • WICHITA, KANSAS 67211

PROJECT NUMBER
472-78-245-82572-000-000-001

DESIGN	DRAWN	APPROVED	DATE	SCALE
	BAM		5/96	1"=20'

SHEET **3** OF **11**