

**BENCHMARKS:**  
 RR spike in asphalt, SW COR., N1/2,  
 SW1/4, Sec. 34, TWP. 26-S, R-2-E.  
 Elev. = 1400.59 NAVD88

Square cut in top of curb  
 North side of Brookview Cir.  
 Approx. 14.5' south of the SE cor.  
 of Lot 55, Block E, Brookfield Addn.  
 Elev. = 1376.51 NAVD88

City of Wichita Benchmark Disk  
 in top of curb. North side of  
 Brookview Cir. adjacent to fire hydrant  
 Approx. 17.8' SW of the SE cor. of  
 Lot 58, Block E, Brookfield Addn.  
 Elev. = 1376.51 NAVD88

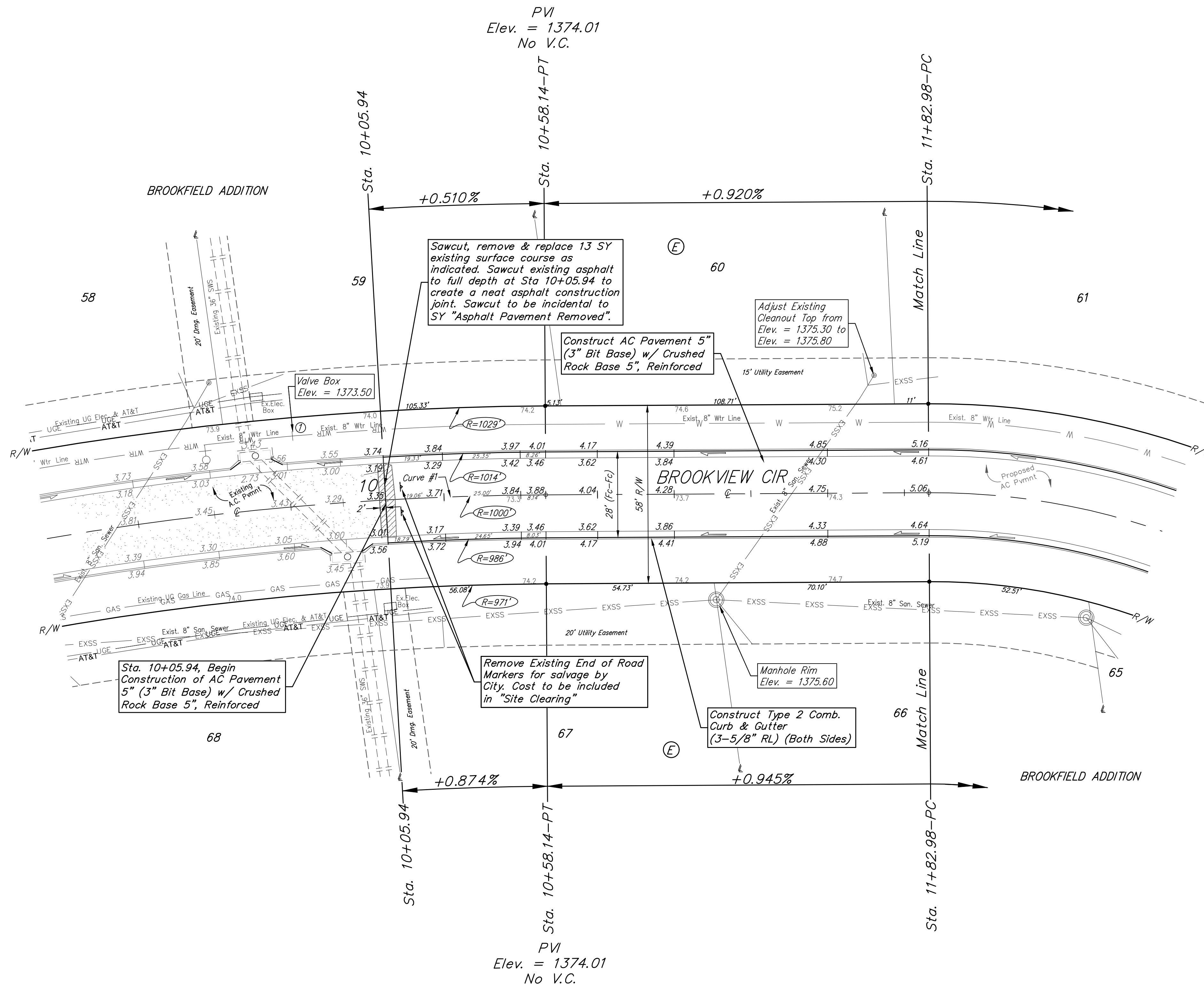
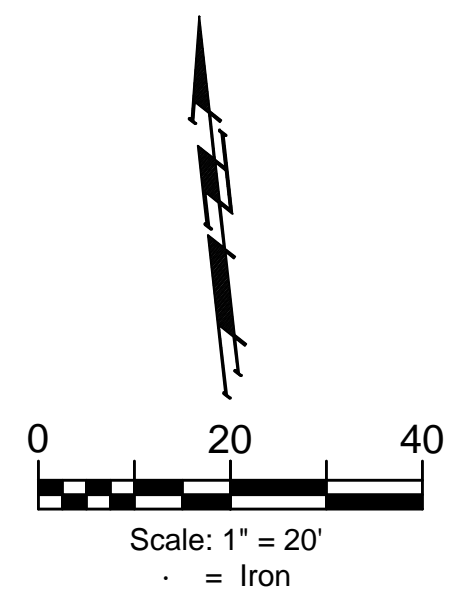

Sta. 10+05.94, Begin  
 Construction of AC Pavement  
 5" (3" Bit Base) w/ Crushed  
 Rock Base 5", Reinforced

Sawcut, remove & replace 13 SY  
 existing surface course as  
 indicated. Sawcut existing asphalt  
 to full depth at Sta 10+05.94 to  
 create a neat asphalt construction  
 joint. Sawcut to be incidental to  
 SY "Asphalt Pavement Removed".

Construct AC Pavement 5"  
 (3" Bit Base) w/ Crushed  
 Rock Base 5", Reinforced

Adjust Existing  
 Cleanout Top from  
 Elev. = 1375.30 to  
 Elev. = 1375.80

Remove Existing End of Road  
 Markers for salvage by  
 City. Cost to be included  
 in "Site Clearing"

Construct Type 2 Comb.  
 Curb & Gutter  
 (3-5/8" RL) (Both Sides)

Curve #1  
 Curve Data Based on Centerline  
 Rad. = 1000' Delta = 2°59'27" Tangent = 26.11'  
 Arc = 52.20' L.C. = 52.19' Def./Ft. = 1.71887 Min.

Station	Arc	Face Chord Lengths		Defl.	Total Defl.
		8' Left	8' Right		
10+05.94	-	-	-	0'00'00"	0'00'00"
10+25.00	19.06'	19.48'	18.64'	0'32'46"	0'32'46"
10+50.00	25.00'	25.55'	24.45'	0'42'58"	1'15'44"
10+58.14	8.14'	8.32'	7.96'	0'13'59"	1'29'43"

Roll type curb & gutter to  
 be constructed on the pavement  
 on this sheet.  
 Top of curb elevation are given  
 for full height curb.

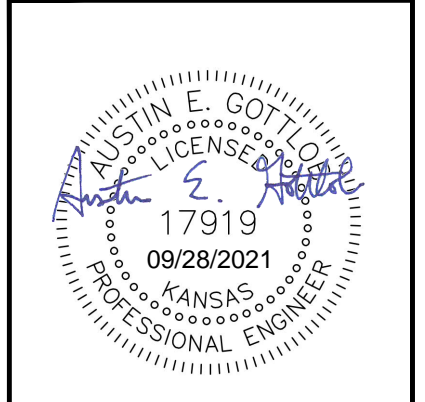

**BAUGHMAN  
 COMPANY**  
 315 Ellis St.  
 Wichita, KS 67211  
 316-262-7271  
 BaughmanCo.com

BROOKFIELD ADDITION  
 PHASE 3B  
**BROOKVIEW  
 CIRCLE**

Sta. 10+58.14 to Sta. 11+82.98  
 Street Paving Improvements  
 PROJECT NUMBER:  
 472-2020-085626  
 DESIGN: AEG DRAWN: JAK  
 DATE: Sep. 27, 2021  
 SHEET OF  
 4 24