

BENCHMARKS:
 RR spike in asphalt, SW COR., N1/2, SW1/4, Sec. 34, TWP. 26-S, R-2-E. Elev. = 1400.59 NAVD88
 Square cut in top of curb North side of Brookview Cir. Approx. 14.5' south of the SE cor. of Lot 55, Block E, Brookfield Addn. Elev. = 1376.51 NAVD88
 City of Wichita Benchmark Disk in top of curb. North side of Brookview Cir. adjacent to fire hydrant. Approx. 17.8' SW of the SE cor. of Lot 58, Block E, Brookfield Addn. Elev. = 1376.51 NAVD88

Existing trees shall be trimmed/removed ONLY with approval of the Developer. Trimming of overhanging limbs will be permitted only with chainsaws. Trees not in direct conflict with proposed new construction shall remain and be protected from damage. Prior to construction, an on-site meeting with the Developer will take place to determine tree clearing. All trimming or removal shall be included in bid item "Site Clearing"

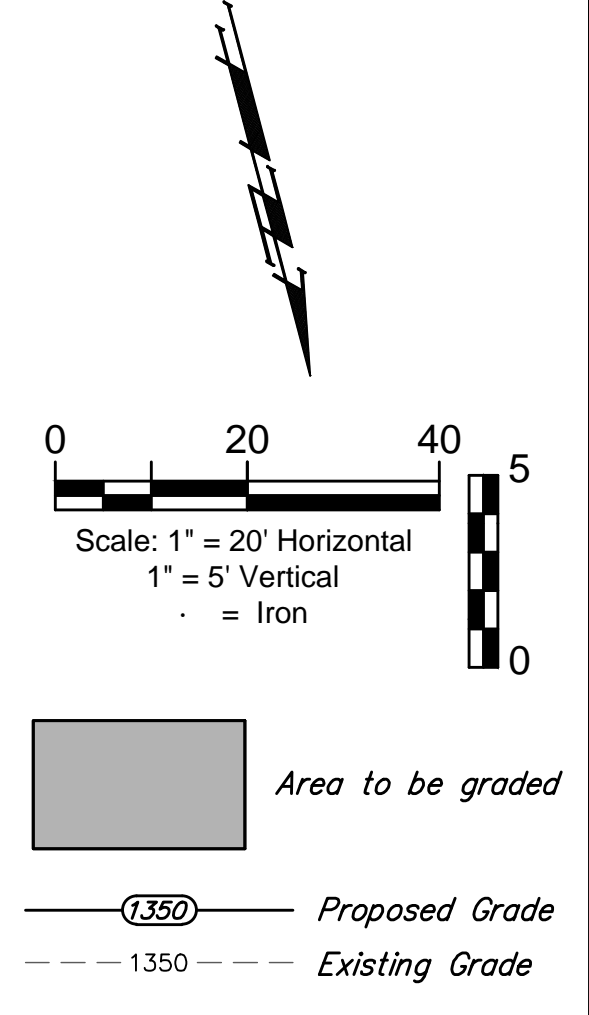

POND DATA:
 STATIC POOL ELEVATION: 1367.0
 BOTTOM ELEVATION: 1358.0
 100 YR DWS: 1371.0

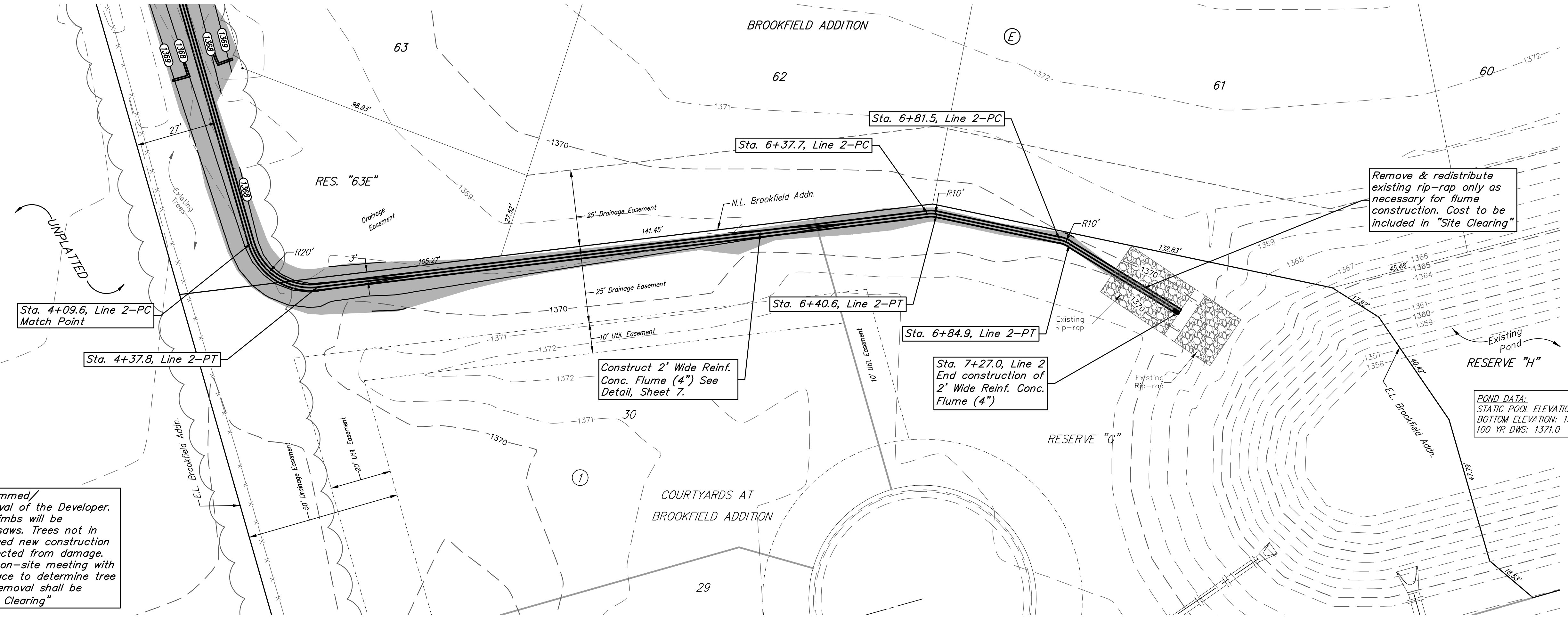
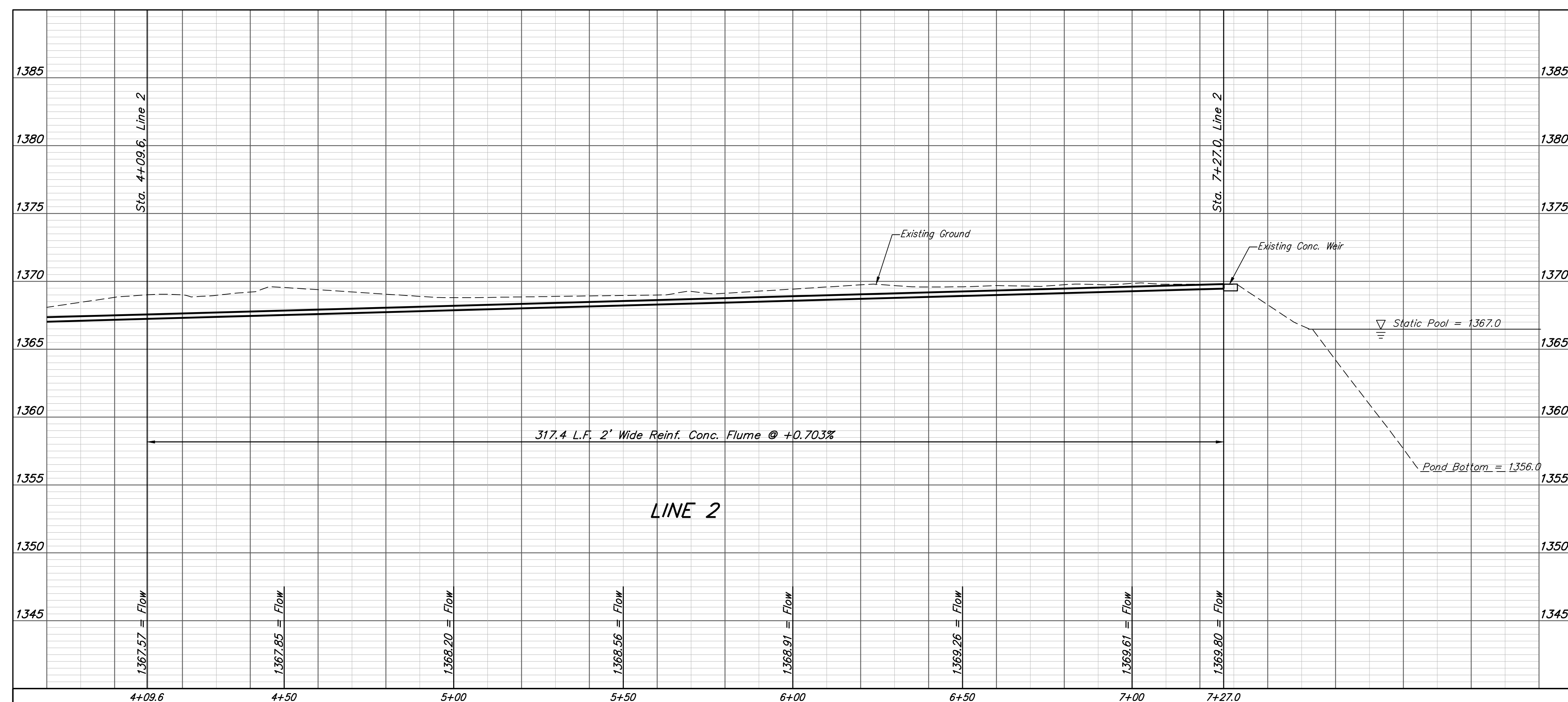

BAUGHMAN COMPANY
 315 Ellis St.
 Wichita, KS 67211
 316-262-7271
 BaughmanCo.com

**BROOKFIELD ADDITION
 PHASE 3B**

LINE 2

STORM WATER SEWER IMPROVEMENTS

PROJECT NUMBER:
472-2020-085626

DESIGN: AEG DRAWN: JAK

DATE: Sep. 27, 2021

SHEET **9** OF **24**

File: C:\Projects\Brookfield Addition - 16-04-P190\Engineering\Phase 3B\STR_21-05-E906.dwg